

BHL is located on topo map 5,899 feet south of Latitude: 39° 22' 30"  
 SHL is located on topo map 1,287 feet south of Latitude: 39° 22' 30"

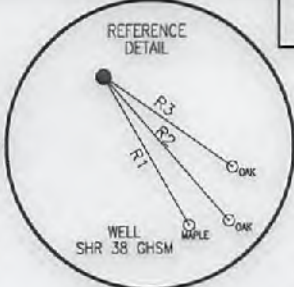

- NOTES:
1. There are no water wells or developed springs within 250' of proposed well.
  2. There are no existing buildings within 625' of proposed well.
  3. Proposed well is greater than 100' from perennial stream, wetland, pond, reservoir or lake.
  4. There are no native trout streams within 300' of proposed well.
  5. Proposed well is greater than 1000' from surface/groundwater intake or public water supply.
  6. It is not the purpose or intention of this plat to represent surveyed locations of the surface or mineral parcels depicted herein. The location of the boundary lines, as shown, are based on record deed descriptions, field evidence found and/or tax map position, unless otherwise noted.

**LEGEND**

- TOPO MAP POINT
- WELL
- ALL ARE POINTS UNLESS OTHERWISE NOTED.
- LEASE NUMBER
- MINERAL TRACT BOUNDARY
- PARCEL LINES
- LEASE BOUNDARY
- WELL REFERENCE
- PROPOSED HORIZONTAL WELL
- ROAD
- STREAM CENTER LINE

**GAS WELLS**

- EXISTING WELLS
- PLUGGED WELLS



**SURFACE HOLE LOCATION (SHL)**  
 UTM 17-NAD83  
 N:4358012.76  
 E:514193.05  
 NAD83, WV NORTH  
 N:320216.6490  
 E:1591044.1020  
 LAT/LON DATUM-NAD83  
 LAT:39°22'17.2755"  
 LON:80°50'06.8184"

**APPROX. LANDING POINT**  
 UTM 17-NAD83  
 N:4358018.28  
 E:514180.20  
 NAD83, WV NORTH  
 N:320235.4470  
 E:1591002.2380  
 LAT/LON DATUM-NAD83  
 LAT:39°22'17.4552"  
 LON:80°50'07.3550"

**BOTTOM HOLE LOCATION (BHL)**  
 UTM 17-NAD83  
 N:4356608.53  
 E:514680.47  
 NAD83, WV NORTH  
 N:315581.9270  
 E:1592566.6730  
 LAT/LON DATUM-NAD83  
 LAT:39°21'31.6946"  
 LON:80°49'46.5581"

SHL is located on topo map 535 feet west of Longitude: 80° 47' 30"  
 BHL is located on topo map 10,726 feet west of Longitude: 80° 50' 00"

LINE	BEARING	DISTANCE
R1	S 29°39'39" E	178.47'
R2	S 40°51'29" E	198.60'
R3	S 54°50'03" E	164.01'
R4	N 27°50'02" E	1515.66'
R5	S 74°30'42" E	1740.72'
R6	S 64°11'15" E	2099.29'

SEE PAGE 2 FOR SURFACE OWNERS AND LESSORS



FILE #: SHR38GHSM  
 DRAWING #: SHR38GHSM  
 SCALE: 1" = 2000'  
 MINIMUM DEGREE OF ACCURACY: 1/2500  
 PROVEN SOURCE OF ELEVATION: U.S.G.S. MONUMENT THOMAS 1498.81'

I, THE UNDERSIGNED, HEREBY CERTIFY THAT THIS PLAT IS CORRECT TO THE BEST OF MY KNOWLEDGE AND BELIEF AND SHOWS ALL THE INFORMATION REQUIRED BY LAW AND THE REGULATIONS ISSUED AND PRESCRIBED BY THE DEPARTMENT OF ENVIRONMENTAL PROTECTION.

Signed: George D. Six  
 R.P.E.: \_\_\_\_\_ L.L.S.: P.S. No. 2000



(+) DENOTES LOCATION OF WELL ON UNITED STATES TOPOGRAPHIC MAPS WVDEP  
 OFFICE OF OIL & GAS  
 601 57TH STREET  
 CHARLESTON, WV 25304



DATE: MAY 02, 2018  
 OPERATOR'S WELL #: SHR38GHSM  
 API WELL #: 47 95 02514  
 STATE COUNTY PERMIT

Well Type:  Oil  Waste Disposal  Production  Deep  
 Gas  Liquid Injection  Storage  Shallow

WATERSHED: HEADWATERS MIDDLE ISLAND CREEK ELEVATION: 1012±  
 COUNTY/DISTRICT: TYLER / CENTERVILLE QUADRANGLE: WEST UNION, WV 7.5'  
 SURFACE OWNER: JAMES E. ASH ET AL ACREAGE: 111±  
 OIL & GAS ROYALTY OWNER: JAMES E. ASH ET AL ACREAGE: 317.758±

DRILL  CONVERT  DRILL DEEPER  REDRILL  FRACTURE OR STIMULATE   
 PLUG OFF OLD FORMATION  PERFORATE NEW FORMATION  PLUG & ABANDON   
 CLEAN OUT & REPLUG  OTHER CHANGE  (SPECIFY): \_\_\_\_\_

TARGET FORMATION: MARCELLUS ESTIMATED DEPTH: TVD: 6,480'± TMD: 11,906'±  
 WELL OPERATOR CNX GAS COMPANY LLC DESIGNATED AGENT CHRIS TURNER  
 Address 1000 CONSOL ENERGY DRIVE Address 1 DOMINION DR.  
 City CANONSBURG State PA Zip Code 15317 City JANE LEW State WV Zip Code 26378

07/20/2018

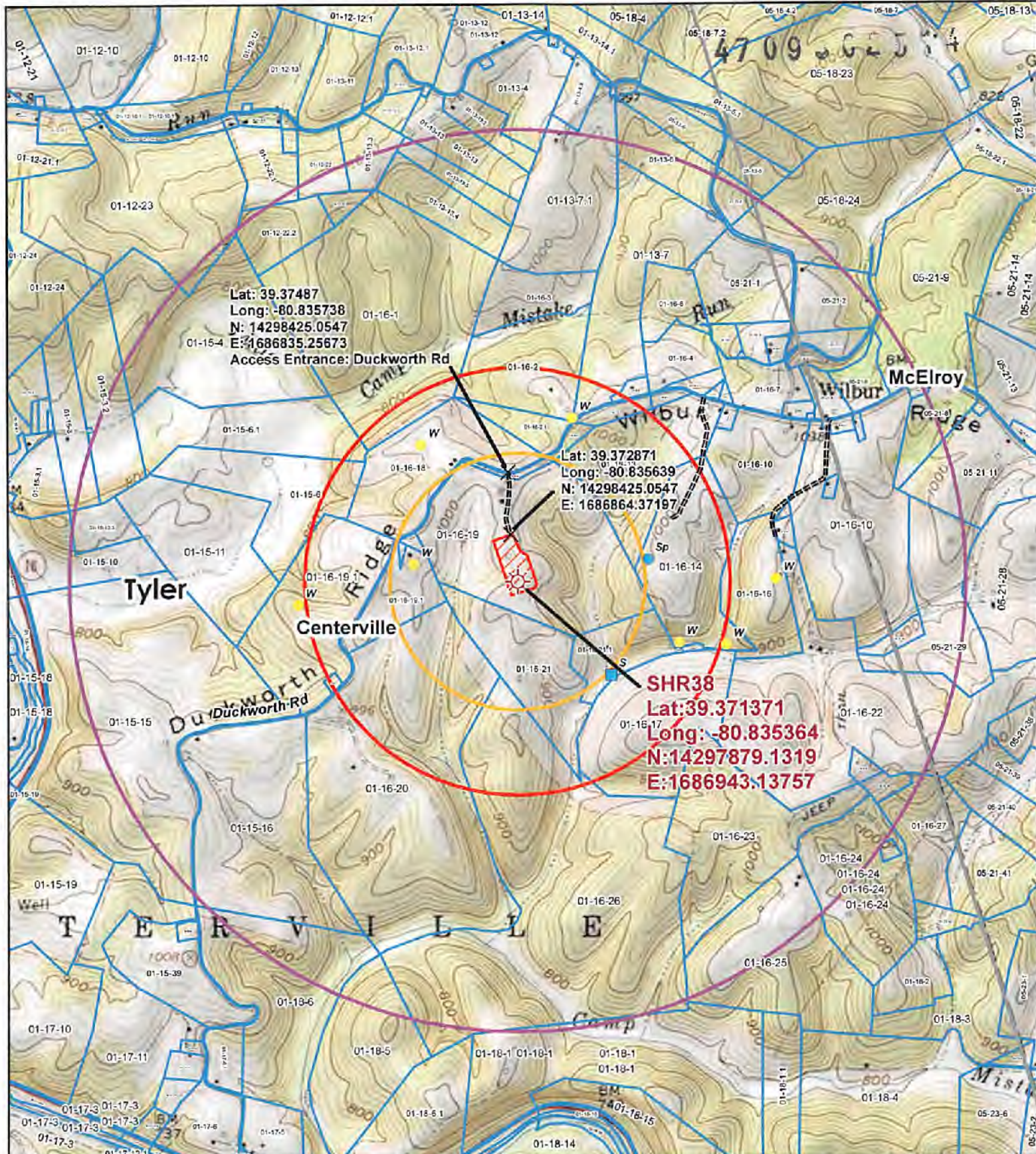

**Legend**

- Wellbore
- Access Points
- Sp
- St
- W
- Access Road
- Surface Parcel
- Well Pad
- 1,500 Foot Buffer
- 2,500 Foot Buffer
- 1 Mile Buffer

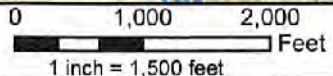

Original Date: 5/8/2018

Prepared By: GIS

Revision Date: 5/8/2018

Approved By: GIS

This map is property of CNX Land Resources Inc. and contains information that is proprietary and confidential in nature and may not be copied or reproduced without prior written consent.  
 © Copyright CNX Land Resources Inc. 2011



Topographic Well Map

**SHR38**  
**07/20/2018**