

LATITUDE 39°25'00"

11,288'

LATITUDE 39°25'00"

LONGITUDE 80°55'00"

LONGITUDE 80°55'00"

2H TOP HOLE

NO OCCUPIED DWELLINGS OR BUILDINGS TWO THOUSAND FIVE HUNDRED EIGHTY SEVEN FEET OR LARGER USED TO HOUSE CHILDREN DAILY COTTAGE OR POTENTIAL HAZARDOUS ARE LOCATED WITHIN SIX HUNDRED THIRTY FIVE (635) FEET OF THE CENTER OF THE WELL PAD.

NOTES: WELL 2H TOP HOLE INFORMATION: N: 336,618ft E: 1,588,477ft LAT: 39°24'54.20" LON: 80°57'23.83" BOTTOM HOLE INFORMATION: N: 326,543ft E: 1,591,946ft LAT: 39°23'15.19" LON: 80°56'37.57" WEST VIRGINIA COORDINATE SYSTEM OF 1927 NORTH ZONE. ZONE WAS DERIVED FROM MEASUREMENTS TAKEN WITH TRIMBLE GEOXT SUBMETER MAPPING GRADE GPS UNIT. PLAT ORIENTATION, CORNER, AND WELL REFERENCE TIE LINES ARE BASED ON GRID NORTH.

(NAD) 83 (UTM) ZONE 17 COORDS: WELL 2H TOP HOLE INFORMATION: N: 4,362,847m E: 503,749m BOTTOM HOLE INFORMATION: N: 4,359,795m E: 504,857m

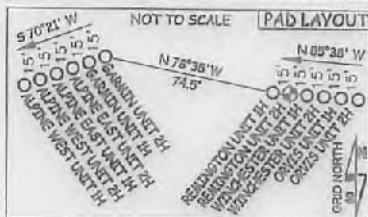

WV NORTH ZONE GRID NORTH

JAMES SINE ET AL W.B. 23 PG. 847 T.M. 08 PAR. 30 32,395 AC. ±

Antero Resources Corporation Well No. Remington Unit 2H

09/28/2018

SUGAR MARK A. KARI LEASE

JAMES L. SINE ET UX LEASE

CHRISTOPHER CARSE ET AL D.B. 330 PG. 092 T.M. 08 PAR. 25 160.5 AC. ±

TSAR-WV LLC LEASE CHARLA M. WALLACE ET AL D.B. 343 PG. 698 T.M. 08 PAR. 24 100 AC. ±

ROBERT S. CARSE ET AL D.B. 342 PG. 816 T.M. 08 PAR. 16 75 AC. ±

WILLIAM S. DENOON ET AL D.B. 336 PG. 626 T.M. 08 PAR. 31 73 AC. ±

THOMAS W. MOORE ET AL LEASE THOMAS W. MOORE ET AL D.B. 380 PG. 749 T.M. 08 PAR. 22 56.25 AC. ±

WILLIAM S. DENOON ET AL D.B. 336 PG. 626 T.M. 08 PAR. 32 282.2 AC. ±

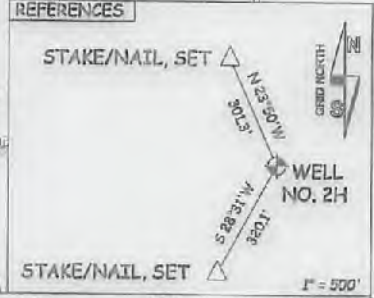

STATE COUNTY PERMIT 47 - 095 - 02535

(NAD) 27 (UTM) ZONE 17 COORDS: WELL 2H TOP HOLE INFORMATION: N: 14,313,060ft E: 1,652,659ft POINT OF ENTRY INFORMATION: N: 14,313,025ft E: 1,652,700ft BOTTOM HOLE INFORMATION: N: 14,303,048ft E: 1,656,304ft

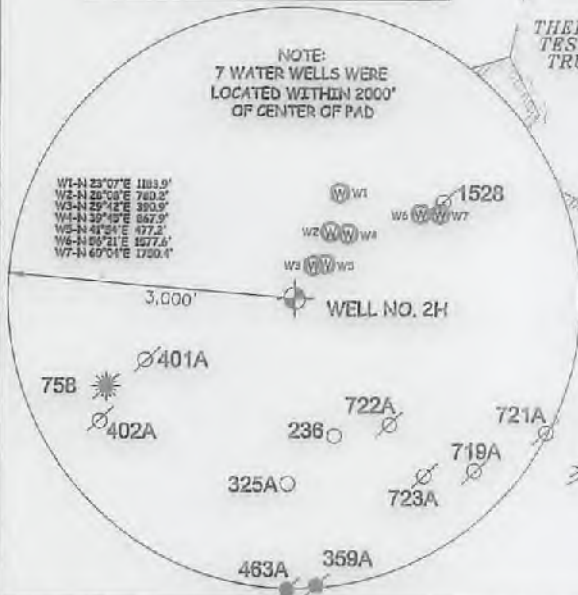

THELMA HADLEY TESTAMENTARY TRUST LEASE 747A

463A RANDY E. GODDARD ET AL D.B. 288 PG. 270 T.M. 08 PAR. 21 44.28 AC. ±

THOMAS W. MOORE ET AL D.B. 380 PG. 749 T.M. 11 PAR. 09 175.07 AC. ±

CARL JACK WILCOX LEASE MICHAEL R. FITZSIMMONS ET AL D.B. 318 PG. 218 T.M. 11 PAR. 08 129.86 AC. ±

THOMAS MOORE ET AL LEASE

CHARLES F. MOSSOR ET UX LEASE THOMAS W. MOORE ET AL D.B. 380 PG. 749 T.M. 11 PAR. 10 18.25 AC. ±

THOMAS W. MOORE ET AL LEASE THOMAS W. MOORE ET AL D.B. 380 PG. 747 T.M. 11 PAR. 09 3 AC. ±

THE JOELYNN FAMILY PRESERVATION TRUST LEASE

GARY BARNARD ET UX LEASE

RICHARD R. BARNARD ET AL D.B. 270 PG. 231 T.M. 11 PAR. 13 91.55 AC. ±

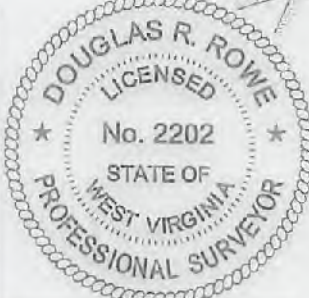

I THE UNDERSIGNED, HEREBY CERTIFY THAT THIS PLAT IS CORRECT TO THE BEST OF MY KNOWLEDGE AND BELIEF AND SHOWS ALL THE INFORMATION REQUIRED BY LAW AND THE RULES ISSUED AND PERSCRIBED BY THE DEPARTMENT OF ENVIRONMENTAL PROTECTION.



STATE OF WEST VIRGINIA, DIVISION OF ENVIRONMENTAL PROTECTION, OFFICE OF OIL AND GAS

WILLOW LAND SURVEYING PLLC 220 MASONIC AVE. PENNSBORO WEST VIRGINIA 26415

JOB # 17-001WA DRAWING # REMINGTON2H830 SCALE 1" = 1000' MINIMUM DEGREE OF ACCURACY SUBMETER PROVEN SOURCE OF ELEV. SUBMETER MAPPING GRADE GPS STATE OF WEST VIRGINIA DEPARTMENT OF ENERGY DIVISION OF OIL AND GAS

LEGEND: Surface Owner Boundary Lines +/- Interior Surface Tracts +/- Existing Fence Found monument, as noted DOUGLAS R. ROWE P.S. 2202 DATE 07/26/18 OPERATOR'S WELL# REMINGTON UNIT #2H

WELL TYPE: OIL GAS X LIQUID INJECTION WASTE DISPOSAL (IF "GAS") PRODUCTION X STORAGE DEEP SHALLOW X LOCATION: ELEVATION 799' AS BUILT WATERSHED OUTLET MIDDLE ISLAND CREEK QUADRANGLE MIDDLEBOURNE 7.5 DISTRICT MEADE COUNTY TYLER SURFACE OWNER JAMES SINE ET AL ACREAGE 32,395 ACRES +/-

OIL & GAS ROYALTY OWNER JAMES L. SINE ET UX; TSAR-WV LLC; THOMAS MOORE ET AL; LEASE ACREAGE 64.74 ACRES +/- 105 ACRES +/- 175.07 ACRES +/- THOMAS W. MOORE ET AL; CHARLES F. MOSSOR ET UX; THE JOELYNN FAMILY PRESERVATION TRUST; GARY BARNARD ET UX; JOE-DOM, INC. 3 ACRES +/- 10.25 ACRES +/- 200 ACRES +/- 91.55 ACRES +/- 380 ACRES +/- PROPOSED WORK: DRILL X CONVERT DRILL DEEPER REDRILL FRACTURE OR STIMULATE X PLUG OFF OLD FORMATION PERFORATE NEW FORMATION X OTHER PHYSICAL CHANGE IN WELL (SPECIFY) PLUG & ABANDON CLEAN OUT & REPLUG TARGET FORMATION MARCELLUS ESTIMATED DEPTH 6,600' TVD 17,800' MD WELL OPERATOR ANTERO RESOURCES CORP. DESIGNATED AGENT DIANNA STAMPER - CT CORPORATION SYSTEM ADDRESS 1615 WYNKOOP STREET ADDRESS 5400 D BIG TYLER ROAD CHARLESTON, WV 25313

09/28/2018

4703502535

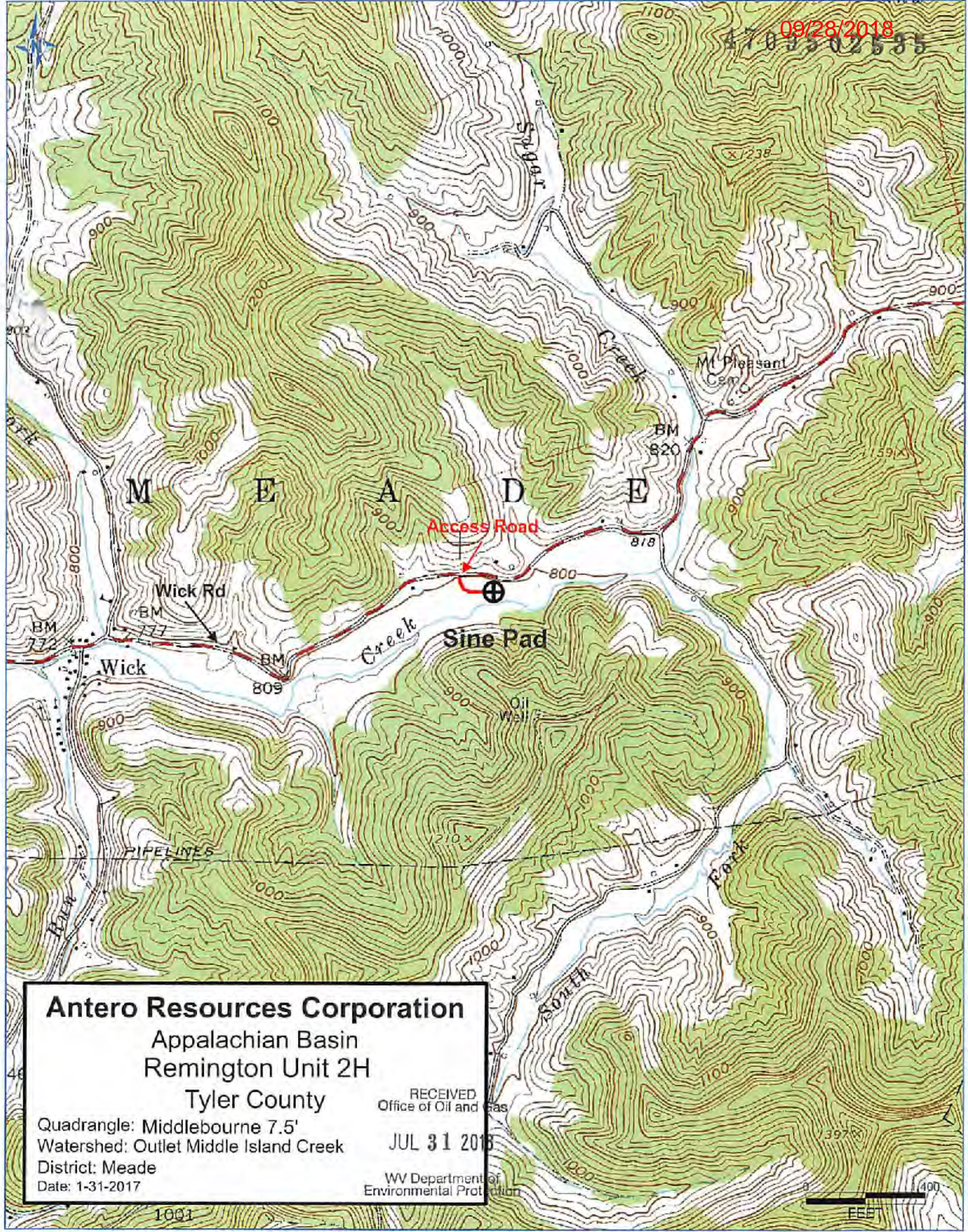

Antero Resources Corporation

Appalachian Basin
Remington Unit 2H
Tyler County

Quadrangle: Middlebourne 7.5'
Watershed: Outlet Middle Island Creek
District: Meade
Date: 1-31-2017

RECEIVED
Office of Oil and Gas
JUL 31 2018
WV Department of
Environmental Protection

