

**Antero Resources**  
**Well No. Treasury Unit 2H**  
**Antero Resources Corporation**

**Well Location**  
**References**  
 (Not to Scale)

5/8" Rebar

Proposed Well No. Treasury Unit 2H

Kirk Hadley Drill Pad

5/8" Rebar

GRID NORTH



I, the undersigned, hereby certify that this plat is correct to the best of my knowledge and belief and shows all the information required by law and the rules issued and prescribed by the Department of Environmental Protection.

*Bradley D. Miller*

**Bradley D. Miller, P.S. 2167**

**Legend**

- ⊙ Proposed gas well
- ⊗ Found corner, as noted
- ☀ Existing Well, as noted
- Creek or Drain
- - - Existing Road
- Surface boundary (approx.)
- - - Interior surface tracts (approx.)

**Notes:**

Well No. Treasury Unit 2H  
 UTM Zone 17, NAD 1927  
 Top Hole Coordinates  
 N: 14,330,648.79' E: 1,659,532.51'  
 Point of Entry Coordinates  
 N: 14,331,425.71' E: 1,661,754.70'  
 Bottom Hole Coordinates  
 N: 14,335,422.04' E: 1,660,381.91'

Note: It appears 5 water wells were found within 2000' of proposed well. No occupied dwellings or buildings 2,500 square feet or larger used to house or shelter dairy cattle or poultry husbandry are located within 625' of the center of the well pad.

47-095-0770A

Proposed Well No. Treasury Unit 2H

1 Gas Well

Water Well - none found. Location as per property owner.

47-095-0066

47-095-0076

Proposed Well No. Treasury Unit 2H

5/8" Rebar w/ cap

FILE NO: 101-54-E-18

DRAWING NO: Treasury 2H Well Plat

SCALE: 1" = 1000'

MINIMUM DEGREE OF ACCURACY: Submeter

PROVEN SOURCE OF ELEVATION: WVDOT, Harrisville, WV

**STATE OF WEST VIRGINIA**  
 DEPARTMENT OF ENVIRONMENTAL PROTECTION  
**OIL AND GAS DIVISION**

DATE: October 10 20 18

OPERATOR'S WELL NO. Treasury Unit 2H

API WELL NO

47 - 095 - 02557

STATE COUNTY PERMIT

WELL TYPE:  OIL  GAS  LIQUID INJECTION  WASTE DISPOSAL  
 (IF GAS) PRODUCTION:  STORAGE  DEEP  SHALLOW

LOCATION: ELEVATION: As-Built 912' WATERSHED: Outlet Middle Island Creek QUADRANGLE: Middlebourne  
 DISTRICT: Meade, Ellsworth COUNTY: Tyler  
 SURFACE OWNER: Kirk L. Hadley ACREAGE: 162  
 ROYALTY OWNER: Kirk Hadley; Richard L. Clark(3); LEASE NO: ACREAGE: 202; 63.4; 61.25; 66.84

PROPOSED WORK:  DRILL  CONVERT  DRILL DEEPER  FRACTURE OR STIMULATE  PLUG OFF OLD FORMATION  
 PERFORATE NEW FORMATION  OTHER PHYSICAL CHANGE IN WELL (SPECIFY) 6,600' TVD  
 PLUG AND ABANDON  CLEAN OUT AND REPLUG TARGET FORMATION: Marcellus Shale ESTIMATED DEPTH: 11,350' MD

WELL OPERATOR: Antero Resources Corporation DESIGNATED AGENT: Dianna Stamper - CT Corporation System  
 ADDRESS: 1615 Wynkoop Street ADDRESS: 5400 D Big Tyler Road  
 Denver, CO 80202 Charleston, WV 25313

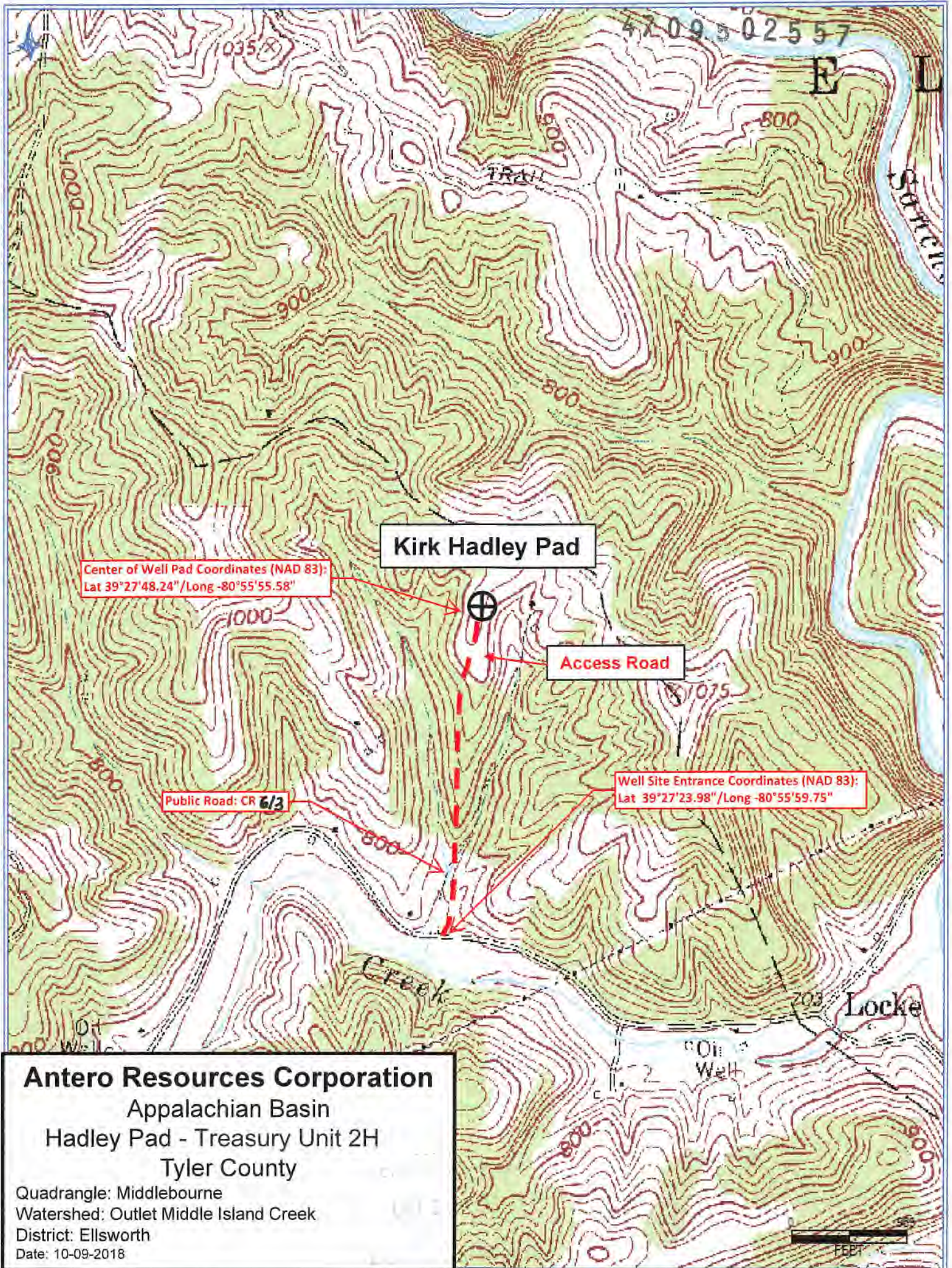

**Antero Resources Corporation**  
Appalachian Basin  
Hadley Pad - Treasury Unit 2H  
Tyler County

Quadrangle: Middlebourne  
Watershed: Outlet Middle Island Creek  
District: Ellsworth  
Date: 10-09-2018