

LATITUDE 39°25'00"

11,198'

6,242' TO BOTTOM HOLE

LATITUDE 39°22'30"

Antero Resources Corporation Well No. Gabitalalek Unit 2H

NOTES: WELL 2H TOP HOLE INFORMATION: N: 323,491ft E: 1,611,920ft ... BOTTOM HOLE INFORMATION: N: 312,770ft E: 1,616,717ft ...

(NAD) 83 (UTM) ZONE 17 COORDS: WELL 2H TOP HOLE INFORMATION: N: 4,358,967m E: 510,957m ...

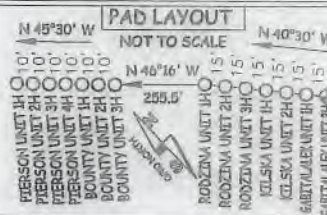

3 WATER WELLS WERE LOCATED WITHIN 2000' OF CENTER OF PAD

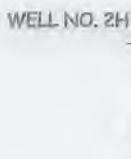

Table listing landowners in Clay District - Ritchie County, including names like Warren Sulter Jr., Gary Dawson, and Antero Resources Corp.

LONGITUDE 80°50'00"

13,343'

LONGITUDE 80°50'00"

I THE UNDERSIGNED, HEREBY CERTIFY THAT THIS PLAT IS CORRECT TO THE BEST OF MY KNOWLEDGE AND BELIEF AND SHOWS ALL THE INFORMATION REQUIRED BY LAW AND THE RULES ISSUED AND PERSCRIBED BY THE DEPARTMENT OF ENVIRONMENTAL PROTECTION.



STATE OF WEST VIRGINIA, DIVISION OF ENVIRONMENTAL PROTECTION, OFFICE OF OIL AND GAS

WILLOW LAND SURVEYING PLLC 220 MASONIC AVE. PENNSBORO WEST VIRGINIA 26415

NOTE: NO OCCUPIED DWELLINGS OR BUILDINGS TWO THOUSAND FIVE HUNDRED (2,500) SQUARE FEET OR LARGER USED TO HOUSE OR SHELTER DAIRY CATTLE OR POULTRY HUSBANDRY ARE LOCATED WITHIN SIX HUNDRED TWENTY-FIVE (625) FEET OF THE CENTER OF THE WELL PAD.

(NAD) 27 (UTM) ZONE 17 COORDS: WELL 2H TOP HOLE INFORMATION: N: 14,300,331ft E: 1,676,319ft ...

JOB # 18-032WA DRAWING # GABITALALEK2HR2 SCALE 1" = 2000' MINIMUM DEGREE OF ACCURACY SUBMETER ...

LEGEND: Surface Owner Boundary Lines +/- Interior Surface Tracts +/- Existing Fence Found monument, as noted ... DATE 4/10/19 OPERATOR'S WELL # GABITALALEK UNIT #2H

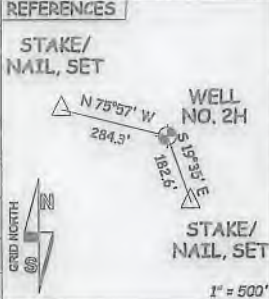

WELL TYPE: OIL GAS X LIQUID INJECTION WASTE DISPOSAL 47 095 02561 (IF "GAS") PRODUCTION X STORAGE DEEP SHALLOW X STATE COUNTY PERMIT LOCATION: ELEVATION 1,009' - AS BUILT WATERSHED HEADWATERS MIDDLE ISLAND CREEK QUADRANGLE SHIRLEY 7.5' (TH) WEST UNION 7.5' (BH) DISTRICT CENTERVILLE COUNTY TYLER SURFACE OWNER GARY D. DAWSON ET UX ACREAGE 104.27 ACRES +/- LEASE ACREAGE 104.27 AC +/- 0.54 AC +/- 2.8 AC +/- 2.08 AC +/- ...