

LATITUDE 39°25'00"

1,149'

LATITUDE 39°27'30"

LONGITUDE 80°27'30"

768' TO BOTTOM HOLE

NO OCCUPIED DWELLINGS OR BUILDINGS TWO THOUSAND FIVE HUNDRED (2,500) SQUARE FEET OR LARGER USED TO HOUSE OR STABLE DAILY CATTLE OR PASTURE HERDS ARE LOCATED WITHIN SIX HUNDRED TWENTY-FIVE (625) FEET OF THE CENTER OF THE WELL PAD.

NOTES:

WELL 1H TOP HOLE INFORMATION: N: 336,634ft E: 1,588,274ft LAT: 39°24'54.32" LON: 80°57'26.43" BOTTOM HOLE INFORMATION: N: 351,700ft E: 1,583,335ft LAT: 39°27'22.42" LON: 80°58'32.51" WEST VIRGINIA COORDINATE SYSTEM OF 1927 NORTH ZONE. ZONE WAS DERIVED FROM MEASUREMENTS TAKEN WITH TRIMBLE GEOXT SUBMETER MAPPING GRADE GPS UNIT. PLAT ORIENTATION, CORNER, AND WELL REFERENCE TIE LINES ARE BASED ON GRID NORTH.

(NAD) 83 (UTM) ZONE 17 COORDS: WELL 1H TOP HOLE INFORMATION: N: 4,362,851m E: 503,687m BOTTOM HOLE INFORMATION: N: 4,367,415m E: 502,105m

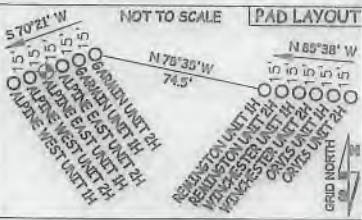

NOTE: 7 WATER WELLS WERE LOCATED WITHIN 2000' OF CENTER OF PAD

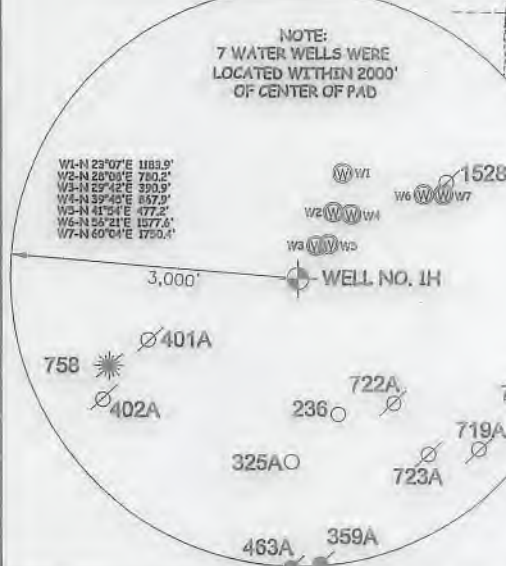

Antero Resources Corporation Well No. Alpine East Unit 1H

(NAD) 27 (UTM) ZONE 17 COORDS: WELL 1H TOP HOLE INFORMATION: N: 14,313,072ft E: 1,652,465ft POINT OF ENTRY INFORMATION: N: 14,313,149ft E: 1,652,663ft BOTTOM HOLE INFORMATION: N: 14,328,049ft E: 1,647,277ft

- A - SURFACE - RAYMOND L. MOORE D.B. 285 PG. 310 T.M. 08 PAR. 29.1 1.10 AC. ±
A - LEASE - RAYMOND L. MOORE ET UX
B - SURFACE - DESTRY B. NELSON ET AL D.B. 347 PG. 643 T.M. 08 PAR. 28.1 1.236 AC. ±
B - LEASE - DAVID E. BOWYER
C1, C2, C3 - SURFACE - DONALD R. ROBINSON ET AL D.B. 294 PG. 713 T.M. 03 PAR. 28 8.914 AC. ±
C1 - LEASE - LILLIAN LEE EDDY
C2 - LEASE - DONALD E. ROBINSON ET UX
C3 - LEASE - EARL G. GLENDENNING

I THE UNDERSIGNED, HEREBY CERTIFY THAT THIS PLAT IS CORRECT TO THE BEST OF MY KNOWLEDGE AND BELIEF AND SHOWS ALL THE INFORMATION REQUIRED BY LAW AND THE RULES ISSUED AND PRESCRIBED BY THE DEPARTMENT OF ENVIRONMENTAL PROTECTION.



STATE OF WEST VIRGINIA, DIVISION OF ENVIRONMENTAL PROTECTION, OFFICE OF OIL AND GAS
WILLOW LAND SURVEYING PLLC
220 MASONIC AVE. PENNSBORO WEST VIRGINIA 26415

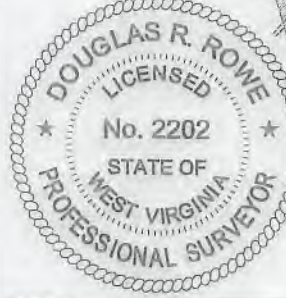

JOB # 17-005WA
DRAWING # ALPINEEAST1H830
SCALE 1" = 2000'
MINIMUM DEGREE OF ACCURACY SUBMETER
PROVEN SOURCE OF ELEV. SUBMETER MAPPING GRADE GPS
STATE OF WEST VIRGINIA DEPARTMENT OF ENERGY DIVISION OF OIL AND GAS

LEGEND table with symbols for Surface Owner Boundary Lines +/-, Interior Surface Tracts +/-, Existing Fence, Found monument, as noted. Includes signature of Douglas R. Rowe and date 06/08/18.

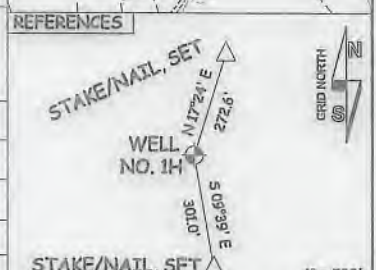

WELL TYPE: OIL GAS X LIQUID INJECTION WASTE DISPOSAL 47 - 095 - 02596
(IF "GAS") PRODUCTION X STORAGE DEEP SHALLOW X STATE COUNTY PERMIT
LOCATION: ELEVATION 799' AS BUILT WATERSHED OUTLET MIDDLE ISLAND CREEK
QUADRANGLE MIDDLEBOURNE 7.5' DISTRICT MEADE COUNTY TYLER
SURFACE OWNER JAMES SINE ET AL ACREAGE 32.395 ACRES +/-
LEASE ACREAGE 54.74 ACRES +/-; 41 ACRES +/-; 98.06 ACRES +/-; 204.88 ACRES +/-; 173.85 ACRES +/-; 73.23 ACRES +/-; 175.06 ACRES +/-; 04.07 ACRES +/-; 40.75 ACRES +/-; 138.50 ACRES +/-; 43.25 ACRES +/-; 110 ACRES +/-
PROPOSED WORK: DRILL X CONVERT DRILL DEEPER REDRILL FRACTURE OR STIMULATE X
PLUG OFF OLD FORMATION PERFORATE NEW FORMATION X OTHER PHYSICAL CHANGE IN WELL (SPECIFY) PLUG & ABANDON CLEAN OUT & REPLUG
TARGET FORMATION MARCELLUS ESTIMATED DEPTH 6,500' TVD 22,900' MD
WELL OPERATOR ANTERO RESOURCES CORP. DESIGNATED AGENT DIANNA STAMPER - CT CORPORATION SYSTEM
ADDRESS 1615 WYNKOOP STREET ADDRESS 5400 D BIG TYLER ROAD
FORM WW-6 DENVER, CO 80202 CHARLESTON, WV 25313

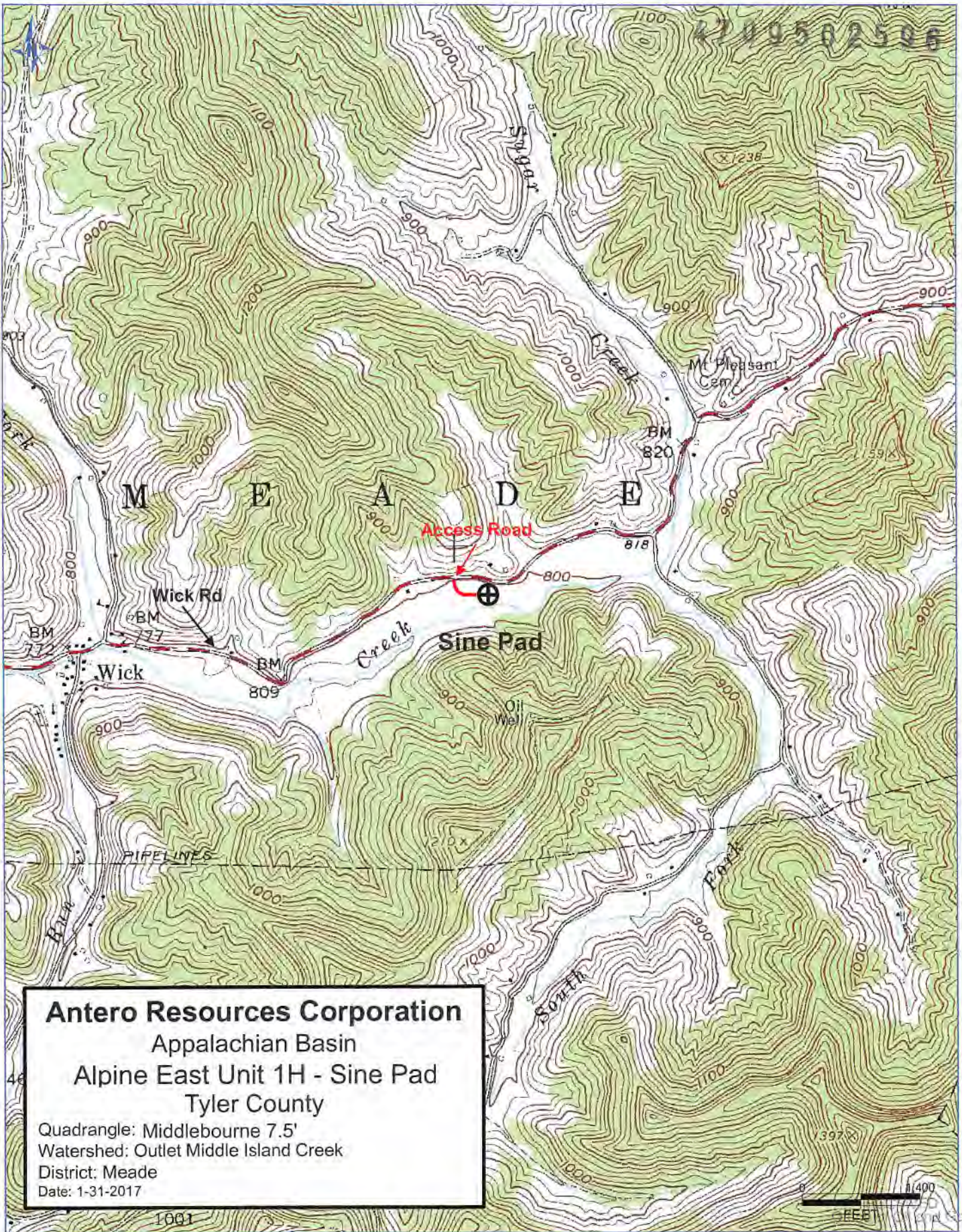

Antero Resources Corporation
Appalachian Basin
Alpine East Unit 1H - Sine Pad
Tyler County

Quadrangle: Middlebourne 7.5'
Watershed: Outlet Middle Island Creek
District: Meade
Date: 1-31-2017