

LATITUDE 39°25'00"

11,519'

5,657' TO BOTTOM HOLE  
LATITUDE 39°27'30"

LONGITUDE 80°57'30"

585' LONGITUDE 80°55'00"

1H TOP HOLE

1H BOTTOM HOLE

Antero Resources Corporation  
Well No. Alpine West Unit 1H

NOTE:  
NO OCCUPIED DWELLINGS OR BUILDINGS TWO THOUSAND FIVE HUNDRED (2,500) SQUARE FEET OR LARGER USED TO HOUSE OR SHELTER DAIRY CATTLE OR POULTRY HUSBANDRY ARE LOCATED WITHIN SIX HUNDRED TWENTY-FIVE (625) FEET OF THE CENTER OF THE WELL PAD.

AS DRILLED DATA:  
WELL 1H TOP HOLE INFORMATION:  
N: 336,624ft E: 1,588,246ft  
LAT: 39°24'54.22" LON: 80°57'26.78"  
BOTTOM HOLE INFORMATION:  
N: 351,434ft E: 1,582,576ft  
LAT: 39°27'19.67" LON: 80°58'42.13"  
WEST VIRGINIA COORDINATE SYSTEM OF 1927 NORTH ZONE. ZONE WAS DERIVED FROM MEASUREMENTS TAKEN WITH TRIMBLE GEOXT SUBMETER MAPPING GRADE GPS UNIT. PLAT ORIENTATION, CORNER, AND WELL REFERENCE TIE LINES ARE BASED ON GRID NORTH.

(NAD) 83 (UTM) ZONE 17 COORDS:  
WELL 1H TOP HOLE INFORMATION:  
N: 4,362,847m E: 503,678m  
BOTTOM HOLE INFORMATION:  
N: 4,367,331m E: 501,876m

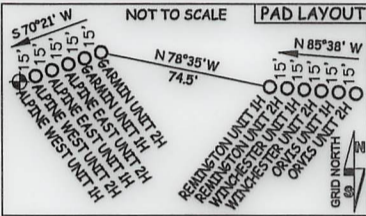

NOTE:  
7 WATER WELLS WERE LOCATED WITHIN 2000' OF CENTER OF PAD

W1-N 23°07'E 1183.9'  
W2-N 28°08'E 780.2'  
W3-N 29°42'E 390.9'  
W4-N 37°40'E 867.9'  
W5-N 47°54'E 472.3'  
W6-N 56°21'E 1577.6'  
W7-N 60°04'E 1750.4'

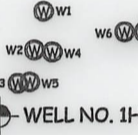

I THE UNDERSIGNED, HEREBY CERTIFY THAT THIS PLAT IS CORRECT TO THE BEST OF MY KNOWLEDGE AND BELIEF AND SHOWS ALL THE INFORMATION REQUIRED BY LAW AND THE RULES ISSUED AND PERSCRIBED BY THE DEPARTMENT OF ENVIRONMENTAL PROTECTION.



STATE OF WEST VIRGINIA, DIVISION OF ENVIRONMENTAL PROTECTION, OFFICE OF OIL AND GAS

WILLOW LAND SURVEYING PLLC  
220 MASONIC AVE. PENNSBORO WEST VIRGINIA 26415

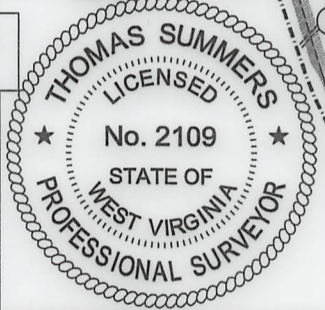

JOB # 17-005WA  
DRAWING # ALPINWEST1H830AD  
SCALE 1" = 2000'  
MINIMUM DEGREE OF ACCURACY SUBMETER  
PROVEN SOURCE OF ELEV. SUBMETER MAPPING GRADE GPS  
STATE OF WEST VIRGINIA DEPARTMENT OF ENERGY DIVISION OF OIL AND GAS

LEGEND  
----- Surface Owner Boundary Lines +/-  
----- Interior Surface Tracts +/-  
○----- Proposed Well Path  
○----- As Drilled Well Path  
THOMAS SUMMERS P.S. 2109  
DATE 01/19/21  
OPERATOR'S WELL# ALPINE WEST UNIT #1H

WELL 1H POINT OF ENTRY INFORMATION:  
N: 336,727ft E: 1,587,680ft  
LAT: 39°24'55.15" LON: 80°57'34.01"  
(NAD) 83 (UTM) ZONE 17 COORDS:  
N: 4,362,876m E: 503,505m

WELL TYPE: OIL GAS X LIQUID INJECTION WASTE DISPOSAL 47 095 02600  
(IF "GAS") PRODUCTION X STORAGE DEEP SHALLOW X STATE COUNTY PERMIT  
LOCATION: ELEVATION 799' - AS BUILT WATERSHED OUTLET MIDDLE ISLAND CREEK COUNTY NAME  
QUADRANGLE MIDDLEBOURNE 7.5' DISTRICT MEADE COUNTY TILER  
SURFACE OWNER JAMES SINE ET AL ACREAGE 32.395 ACRES +/-  
OIL & GAS ROYALTY OWNER JAMES SINE ET UX; MARK A. KARL; DONALD E. ROBINSON ET UX; LEASE ACREAGE 54.74 ACRES +/-; 73 ACRES +/-; 98.06 ACRES +/-;  
JAMES M. UTT; DONALD L. BAKER ET UX; CHESTER L. BAKER ET UX; NANCY LEE BRADFORD; DENNIS SOLE TRUST; 204.88 ACRES +/-; 173.65 ACRES +/-; 33.23 ACRES +/-; 59.05 ACRES +/-; 80.24 ACRES +/-;  
STAR FURNITURE CO.; STEVEN C. ANDERSON; GEORGE E. POST ET UX; GEORGE E. POST ET UX; EARL E. BLAIR ET UX 73.23 ACRES +/-; 175.66 ACRES +/-; 49.75 ACRES +/-; 43.25 ACRES +/-; 110 ACRES +/-  
PROPOSED WORK: DRILL CONVERT DRILL DEEPER REDRILL FRACTURE OR STIMULATE  
PLUG OFF OLD FORMATION PERFORATE NEW FORMATION OTHER PHYSICAL CHANGE IN WELL  
(SPECIFY) AS DRILLED PLUG & ABANDON CLEAN OUT & REPLUG  
TARGET FORMATION MARCELLUS ESTIMATED DEPTH 6,011' TVD 22,112' MD  
WELL OPERATOR ANTERO RESOURCES CORP. DESIGNATED AGENT DIANNA STAMPER - CT CORPORATION SYSTEM  
ADDRESS 1615 WYNKOOP STREET ADDRESS 5400 D BIG TYLER ROAD  
FORM WW-6 DENVER, CO 80202 CHARLESTON, WV 25313