

11,790' to Top Hole

758' to Bottom Hole
LATITUDE 39 - 32 - 30

Bottom Hole
7.5' Spot

Bearing	Dist.
L1 S 56°29' W	3,001.9'
L2 N 78°15' W	3,469.4'
L3 N 59°12' E	2,659.7'
L4 N 65°53' E	3,825.2'
L5 N 48°07' E	2,713.9'

Antero Resources
Well No. Sisterville Unit 2H

Antero Resources Corporation



Notes:
Well No. Sisterville Unit 2H
UTM Zone 17, NAD 1927
Top Hole Coordinates
N: 14,347,063.09'
E: 1,675,818.94'
Point of Entry Coordinates
N: 14,348,907.63'
E: 1,677,808.40'
Bottom Hole Coordinates
N: 14,357,307.25'
E: 1,674,930.49'

Well Location References

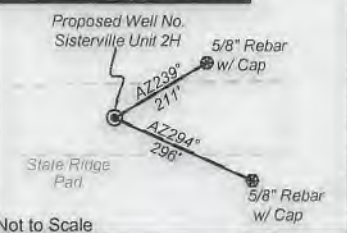

Note: 0 water wells or springs were found within 2000' of proposed well. No occupied dwellings or buildings 2,500 square feet or larger used to house or shelter dairy cattle or poultry husbandry are located within 625' of the center of the well pad.
Proposed Well Sisterville Unit 2H
3000'

I, the undersigned, hereby certify that this plat is correct to the best of my knowledge and belief and shows all the information required by law and the rules issued and prescribed by the Department of Environmental Protection.
Bradley D. Miller
Bradley D. Miller, P.S. 2167



Leases

A	Chris Folger
B	John W. Starkey, et ux
C	Richard A. Mercer

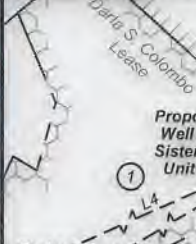

ID	TM/Par	Owner	Bk/Pg	Acres
1	15/17	David Mendenhall, et al	288/662	85.71
2	15/23	David Mendenhall, et al	326/13	97.25
3	15/15	David Mendenhall, et al	289/4	50.00
4	15/16	Robert M. Feldmeier	330/109	52.37
5	15/37	John D. Mendenhall & Jeffrey A. Davis	444/531	154.17
6	15/3	John W. Eddy Estate	77/319	40.33
7	15/14	John W. & Leah D. Starkey	345/93	80.71
8	15/5	Earl H. Jr. & Bernadette Warriner	306/14	58.56
9	15/4	Board of Education	86/145	0.334
10	15/2	John W. Eddy Estate	71/13	49.00
11	15/1	Martin L. Blair Jr. & Ronald K. Blair Sr.	WB18/361	47.00
12	10/62	Haesley Land & Timber, LLC.	334/833	268.91
13	10/65	Daniel R. Deetz & Kevin Richardson	321/713	131.94
14	10/35	Michael E. Neff	299/601	105.56
15	10/34	Oliver T. & Maxine M. Ankrom	265/399	11.00
16	10/33	Oliver T. & Maxine M. Ankrom	265/399	17.00
17	10/32	Ralph D. & Sylvia Harter	311/200	15.00
18	10/31	Ralph D. & Sylvia Harter	286/73	38.80
19	10/34.1	Robert P. & Sharon L. Thomas	542/657	2.21
20	10/26	John E. Roberts	WB30/108	4.00
21	10/27	John E. Roberts	WB30/108	4.00
22	10/24.1	Ralph D. & Sylvia Harter	334/277	18.44
23	10/24.2	Michael Van & Debra Kay Smith	400/612	0.15
24	10/25	Michael Van & Debra Kay Smith	400/612	0.29
25	10/24	Michael Van & Debra Kay Smith	400/612	1.25
26	10/23	Betty & Teresa J. Boggs	214/638	0.29
27	10/24.3	Tammy Sue & James R. Underwood Jr.	317/651	4.16
28	10/35.3	James H. & Mildred G. Bassett	273/538	0.39
29	10/35.4	Mary Jane Woolter	319/73	0.75
30	10/35.6	James H. & Mildred G. Bassett	281/543	0.76
31	10/20	James H. & Mildred G. Bassett	311/637	0.72
32	10/19	James H. & Mildred G. Bassett	264/548	29.52
33	10/21	Patricia Ann Heintzman	WB13/384	3.00
34	10/22	Michael V. & Debra K. Smith	335/619	59.42
35	10/28	John E. Roberts	WB30/142	38.99
36	10/1	Patricia Ann Heintzman	150/15	48.50
37	10/2	Patricia Ann Heintzman	WB13/384	73.26
38	10/64	John E. Roberts	WB30/108	100.00
39	6/40	Alan D. Wyke	WB40/195	42.25
40	9/13	Richard A. Mercer	321/197	16.00
41	6/41	Donald E. Forrester	125/421	20.05

TOP HOLE LONGITUDE 80 - 00 - 00
BOTTOM HOLE LONGITUDE 80 - 32 - 30
1,862' to Bottom Hole
11,946' to Top Hole

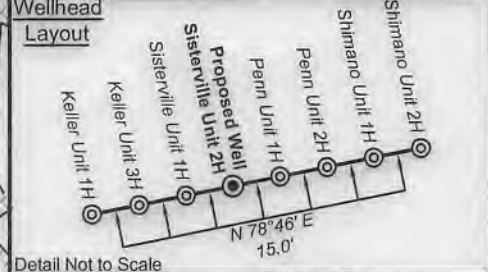

Legend

- Proposed gas well
- Found corner, as noted
- Existing Well, as noted
- Digitized Well
- Creek or Drain
- Existing Road
- Surface boundary (approx.)
- Interior surface tracts (approx.)

Notes:
West Virginia Coordinate System of 1927, North Zone based upon Differential GPS Measurements.
Well No. Sisterville Unit 2H Top Hole coordinates are
N: 370,241.50' Latitude: 39°30'30.19"
E: 1,612,200.08' Longitude: 80°52'28.15"
Bottom Hole coordinates are
N: 380,502.56' Latitude: 39°32'11.49"
E: 1,611,482.51' Longitude: 80°52'39.31"
UTM Zone 17, NAD 1983
Top Hole Coordinates Bottom Hole Coordinates
N: 4,373,211.300m N: 4,376,333.750m
E: 510,805.119m E: 510,534.417m
Plat orientation and corner and well references are based upon the grid north meridian.
Well location references are based upon the magnetic meridian.

FILE NO: 07-54-E-19
DRAWING NO: 07-19 Sisterville 2H Well Plat
SCALE: 1" = 1500'
MINIMUM DEGREE OF ACCURACY:
Submeter
PROVEN SOURCE OF ELEVATION:
WVDOT, Harrisville, WV

STATE OF WEST VIRGINIA
DEPARTMENT OF ENVIRONMENTAL PROTECTION
OIL AND GAS DIVISION

DATE: April 9 2019
OPERATOR'S WELL NO. Sisterville Unit 2H
API WELL NO
47 - 095 - 02619
STATE COUNTY PERMIT

WELL TYPE: OIL GAS LIQUID INJECTION WASTE DISPOSAL
(IF GAS) PRODUCTION: STORAGE DEEP SHALLOW
LOCATION: ELEVATION: Proposed 1,064' Existing 1,090' WATERSHED: Outlet Middle Island Creek QUADRANGLE: Paden City/Porter Falls
DISTRICT: Ellsworth COUNTY: Tyler
SURFACE OWNER: John D. Mendenhall Paul A. Marks, et ux; Patricia Ann Heintzman; ACREAGE: 154.17 40.33; 47; 131.94; & Jeffrey A. Davis Ronald K. & Martin L. Blair; Patsy J. Oliverio; Bob Christen; 49; 106.32; 84.0;
ROYALTY OWNER: Dianne T. Carpenter; Herbert Stephenson Boreman Jr.; Michael A. Eddy; Michael E. Neff LEASE NO: ACREAGE: 154.17; 52; 76.25;
PROPOSED WORK: DRILL CONVERT DRILL DEEPER FRACTURE OR STIMULATE PLUG OFF OLD FORMATION
 PERFORATE NEW FORMATION OTHER PHYSICAL CHANGE IN WELL (SPECIFY) 6,900' TVD
 PLUG AND ABANDON CLEAN OUT AND REPLUG TARGET FORMATION: Marcellus Shale ESTIMATED DEPTH: 17,200' MD

WELL OPERATOR: Antero Resources Corporation DESIGNATED AGENT: Dianna Stamper - CT Corporation System
ADDRESS: 1615 Wynkoop Street ADDRESS: 5400 D Big Tyler Road
Denver, CO 80202 Charleston, WV 25313

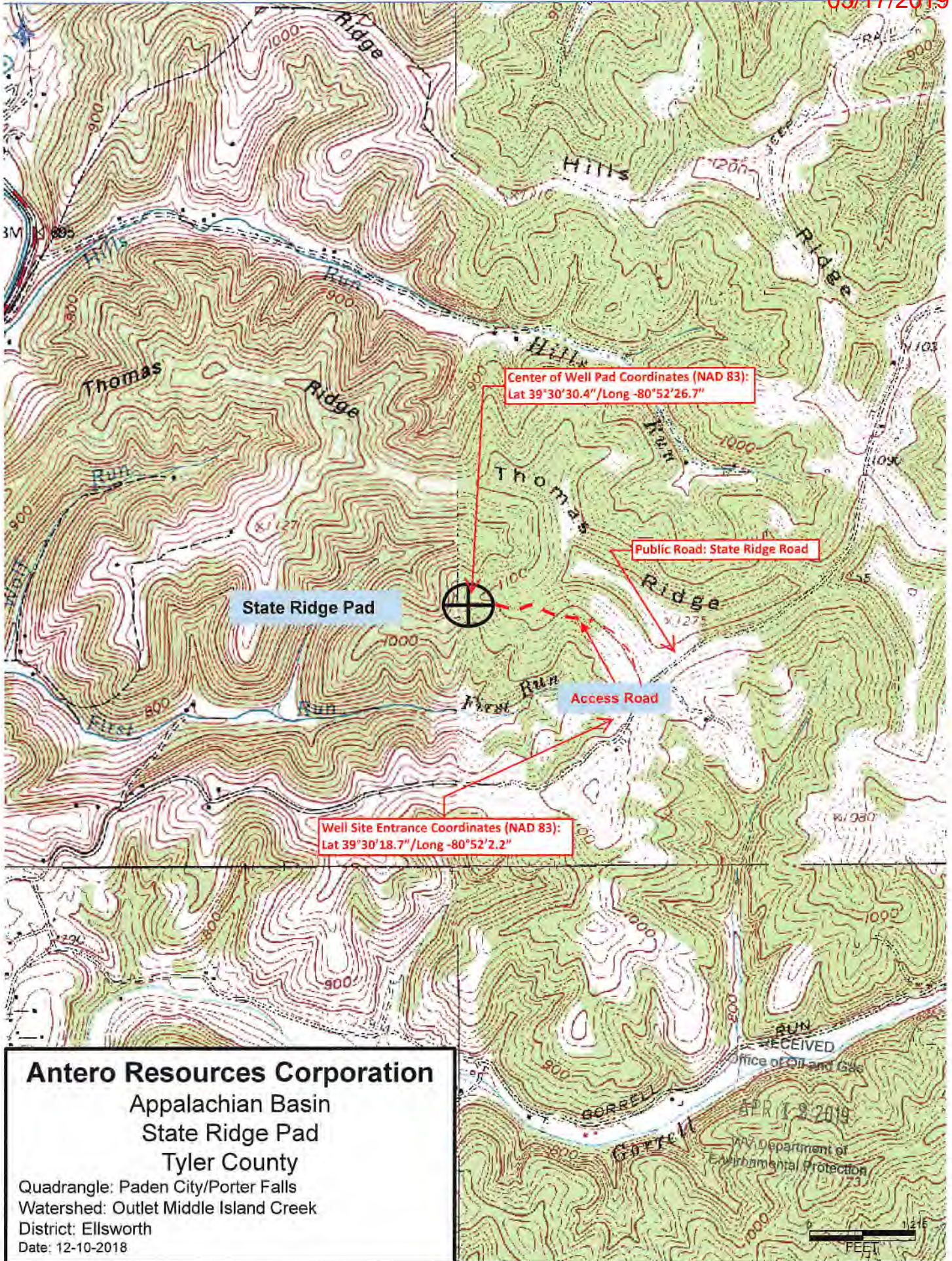

Center of Well Pad Coordinates (NAD 83):
 Lat 39°30'30.4"/Long -80°52'26.7"

Public Road: State Ridge Road

State Ridge Pad

Access Road

Well Site Entrance Coordinates (NAD 83):
 Lat 39°30'18.7"/Long -80°52'2.2"

Antero Resources Corporation

Appalachian Basin
 State Ridge Pad
 Tyler County

Quadrangle: Paden City/Porter Falls
 Watershed: Outlet Middle Island Creek
 District: Ellsworth
 Date: 12-10-2018

RECEIVED
 Office of Oil and Gas
 APR 18 2019
 WV Department of
 Environmental Protection

