

State of West Virginia
Department of Environmental Protection - Office of Oil and Gas
Well Operator's Report of Well Work

RECEIVED
Office of Oil and Gas
SEP 22 2022
WV Department of
Environmental Protection

API 47 - 095 - 02640 County Tyler District Ellsworth
Quad Paden City Pad Name Gamehenge Pad Field/Pool Name -----
Farm name Barbara Kay Turner Well Number Possum Unit 1H
Operator (as registered with the OOG) Antero Resources Corporation
Address 1615 Wynkoop Street City Denver State CO Zip 80202

As Drilled location NAD 83/UTM Attach an as-drilled plat, profile view, and deviation survey
Top hole Northing 4373348m Easting 509784m
Landing Point of Curve Northing 4373226.64m Easting 508878.91m
Bottom Hole Northing 4376359m Easting 507831m

Elevation (ft) 1,061' GL Type of Well New Existing Type of Report Interim Final
Permit Type Deviated Horizontal Horizontal 6A Vertical Depth Type Deep Shallow
Type of Operation Convert Deepen Drill Plug Back Redrilling Rework Stimulate
Well Type Brine Disposal CBM Gas Oil Secondary Recovery Solution Mining Storage Other _____
Type of Completion Single Multiple Fluids Produced Brine Gas NGL Oil Other _____
Drilled with Cable Rotary

Drilling Media Surface hole Air Mud Fresh Water Intermediate hole Air Mud Fresh Water Brine
Production hole Air Mud Fresh Water Brine
Mud Type(s) and Additive(s)
Air - Foam & 4% KCL
Mud - Polymer

Date permit issued 8/20/2019 Date drilling commenced 11/1/2019 Date drilling ceased 2/7/2020
Date completion activities began 6/30/2020 Date completion activities ceased 7/20/2020
Verbal plugging (Y/N) N/A Date permission granted N/A Granted by N/A

Please note: Operator is required to submit a plugging application within 5 days of verbal permission to plug

Freshwater depth(s) ft 363' Open mine(s) (Y/N) depths No
Salt water depth(s) ft 1093' Void(s) encountered (Y/N) depths No
Coal depth(s) ft 550' Cavern(s) encountered (Y/N) depths No
Is coal being mined in area (Y/N) No

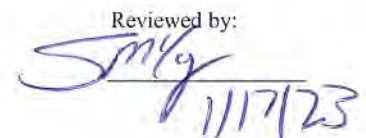
Reviewed by:

API 47- 095 - 02640 Farm name Barbara Kay Turner Well number Possum Unit 1H

CASING STRINGS	Hole Size	Casing Size	Depth	New or Used	Grade wt/ft	Basket Depth(s)	Did cement circulate (Y/ N) * Provide details below*
Conductor	24"	20"	80'	New	94#, H-40	N/A	Y
Surface	17-1/2"	13-3/8"	448'	New	54.5#, J-55	N/A	Y
Coal							
Intermediate 1	12-1/4"	9-5/8"	2715'	New	36#, J-55	N/A	Y
Intermediate 2							
Intermediate 3							
Production	8-3/4"/8-1/2"	5-1/2"	18507'	New	20#, P-110	N/A	Y
Tubing		2-3/8"	7346'		4.7#, P-110		
Packer type and depth set		N/A					

Comment Details _____

CEMENT DATA	Class/Type of Cement	Number of Sacks	Slurry wt (ppg)	Yield (ft ³ /sks)	Volume (ft ³)	Cement Top (MD)	WOC (hrs)
Conductor	Class A	204 sx	15.6	1.18	43	0'	8 Hrs.
Surface	Class A	398 sx	15.8	1.20	85	0'	8 Hrs.
Coal							
Intermediate 1	Class A	981 sx	15.8	1.17	213	0'	8 Hrs.
Intermediate 2							
Intermediate 3							
Production	Class H	792 sx (Lead) 3040 sx (Tail)	13.5 (Lead), 15.2(Tail)	1.4 (Lead), 1.26 (Tail)	268	-500' into Intermediate Casing	8 Hrs.
Tubing							

Drillers TD (ft) 18557' MD, 6373' TVD (BHL), 6459' (Deepest Point Drilled) Loggers TD (ft) 18557' MD
 Deepest formation penetrated Marcellus Plug back to (ft) N/A
 Plug back procedure N/A

Kick off depth (ft) 6296'

Check all wireline logs run caliper density deviated/directional induction
 neutron resistivity gamma ray temperature sonic

Well cored Yes No Conventional Sidewall Were cuttings collected Yes No

DESCRIBE THE CENTRALIZER PLACEMENT USED FOR EACH CASING STRING _____

Conductor - 0
 Surface - 1 above guide shoe, 1 above insert float, 1 every 4th joint to surface
 Intermediate - 1 above float joint, 1 above float collar, 1 every 4th joint to surface
 Production - 1 above float joint, 1 below float collar, 1 every 3rd joint to top of cement

WAS WELL COMPLETED AS SHOT HOLE Yes No DETAILS _____

WAS WELL COMPLETED OPEN HOLE? Yes No DETAILS _____

WERE TRACERS USED Yes No TYPE OF TRACER(S) USED N/A

SM
1/17/23

API 47- 095 - 02640 Farm name Barbara Kay Turner Well number Possum Unit 1H

<u>PRODUCING FORMATION(S)</u>	<u>DEPTHS</u>	
<u>Marcellus</u>	<u>6393' (TOP)</u> TVD	<u>7385' (TOP)</u> MD
_____	_____	_____
_____	_____	_____
_____	_____	_____

Please insert additional pages as applicable.

GAS TEST Build up Drawdown Open Flow OIL TEST Flow Pump

SHUT-IN PRESSURE Surface 2800 psi Bottom Hole --- psi DURATION OF TEST --- hrs

OPEN FLOW Gas 10187 mcfpd Oil 497 bpd NGL --- bpd Water 1 bpd GAS MEASURED BY Estimated Orifice Pilot

LITHOLOGY/ FORMATION	TOP DEPTH IN FT NAME TVD	BOTTOM DEPTH IN FT TVD	TOP DEPTH IN FT MD	BOTTOM DEPTH IN FT MD	DESCRIBE ROCK TYPE AND RECORD QUANTITY AND TYPE OF FLUID (FRESHWATER, BRINE, OIL, GAS, H ₂ S, ETC)
-------------------------	--------------------------------	------------------------------	--------------------------	-----------------------------	--

***PLEASE SEE ATTACHED EXHIBIT 3**

Please insert additional pages as applicable.

Drilling Contractor H & P Drilling
Address 912 N Eagle Valley Rd City Howard State PA Zip 16841

Logging Company Nine Energy Services
Address 6500 West Fwy City Fort Worth State TX Zip 76116

Cementing Company Halliburton Energy Services
Address 3000 W. Sam Houston Pkwy City Houston State TX Zip 76114

Stimulating Company Halliburton Energy Services
Address 3000 W. Sam Houston Pkwy City Houston State TX Zip 76114

Please insert additional pages as applicable.

Completed by Brandi Hopkins Telephone 304-842-9759
Signature [Signature] Title Completions Technician Date 9/10/22

Submittal of Hydraulic Fracturing Chemical Disclosure Information Attach copy of FRACFOCUS Registry

SM
11/17/23

API 47-095-02640 Farm Name Barbara Kay Turner Well Number Possum Unit 1H

Stage No.	Perforation Date	Perforated from MD ft.	Perforated to MD ft.	Number of Perforations	Formations
1	6/30/2020	18454.4	18410.8	36	Marcellus
2	6/30/2020	18371.74012	18204.4407	36	Marcellus
3	6/30/2020	18168.58086	18001.2815	36	Marcellus
4	7/1/2020	17965.4216	17798.1222	36	Marcellus
5	7/1/2020	17762.26235	17594.963	36	Marcellus
6	7/1/2020	17559.10309	17391.8037	36	Marcellus
7	7/1/2020	17355.94383	17188.6444	36	Marcellus
8	7/2/2020	17152.78457	16985.4852	36	Marcellus
9	7/2/2020	16949.62531	16782.3259	36	Marcellus
10	7/2/2020	16746.46605	16579.1667	36	Marcellus
11	7/2/2020	16543.30679	16376.0074	36	Marcellus
12	7/2/2020	16340.14753	16172.8481	36	Marcellus
13	7/3/2020	16136.98827	15969.6889	36	Marcellus
14	7/3/2020	15933.82901	15766.5296	36	Marcellus
15	7/3/2020	15730.66975	15563.3704	36	Marcellus
16	7/3/2020	15527.51049	15360.2111	36	Marcellus
17	7/4/2020	15324.35123	15157.0519	36	Marcellus
18	7/4/2020	15121.19198	14953.8926	36	Marcellus
19	7/4/2020	14918.03272	14750.7333	36	Marcellus
20	7/4/2020	14714.87346	14547.5741	36	Marcellus
21	7/4/2020	14511.7142	14344.4148	36	Marcellus
22	7/5/2020	14308.55494	14141.2556	36	Marcellus
23	7/5/2020	14105.39568	13938.0963	36	Marcellus
24	7/5/2020	13902.23642	13734.937	36	Marcellus
25	7/5/2020	13699.07716	13531.7778	36	Marcellus
26	7/5/2020	13495.9179	13328.6185	36	Marcellus
27	7/6/2020	13292.75864	13125.4593	36	Marcellus
28	7/6/2020	13089.59938	12922.3	36	Marcellus
29	7/6/2020	12886.44012	12719.1407	36	Marcellus
30	7/7/2020	12683.28086	12515.9815	36	Marcellus
31	7/7/2020	12480.1216	12312.8222	36	Marcellus
32	7/7/2020	12276.96235	12109.663	36	Marcellus
33	7/7/2020	12073.80309	11906.5037	36	Marcellus
34	7/7/2020	11870.64383	11703.3444	36	Marcellus
35	7/8/2020	11667.48457	11500.1852	36	Marcellus
36	7/8/2020	11464.32531	11297.0259	36	Marcellus
37	7/8/2020	11261.16605	11093.8667	36	Marcellus
38	7/8/2020	11058.00679	10890.7074	36	Marcellus
39	7/8/2020	10854.84753	10687.5481	36	Marcellus
40	7/9/2020	10651.68827	10484.3889	36	Marcellus
41	7/9/2020	10448.52901	10281.2296	36	Marcellus
42	7/9/2020	10245.36975	10078.0704	36	Marcellus
43	7/9/2020	10042.21049	9874.91111	36	Marcellus
44	7/9/2020	9839.051235	9671.75185	36	Marcellus
45	7/10/2020	9635.891975	9468.59259	36	Marcellus
46	7/10/2020	9432.732716	9265.43333	36	Marcellus
47	7/10/2020	9229.573457	9062.27407	36	Marcellus
48	7/10/2020	9026.414198	8859.11481	36	Marcellus
49	7/11/2020	8823.254938	8655.95556	36	Marcellus
50	7/11/2020	8620.095679	8452.7963	36	Marcellus
51	7/11/2020	8416.93642	8249.63704	36	Marcellus
52	7/11/2020	8213.77716	8046.47778	36	Marcellus
53	7/11/2020	8010.617901	7843.31852	36	Marcellus
54	7/12/2020	7807.458642	7640.15926	36	Marcellus
55	7/12/2020	7604.299383	7437	36	Marcellus

RECEIVED
Office of Oil and Gas
SEP 22 2022
WV Department of
Environmental Protection

SM

EXHIBIT 2

Stage No.	Stimulations Date	Avg Pump Rate	Avg Treatment Pressure (PSI)	Max Breakdown Pressure (PSI)	ISIP (PSI)	Amount of Proppant (lbs)	Amount of Water (bbls)	Amount of Nitrogen/ other (units)
1	6/30/2020	52.84	8322	8304	4002	184410	6496.952	N/A
2	6/30/2020	84.22	8407	5423	4121	265550	7596.762	N/A
3	6/30/2020	82.92	8446	5063	3688	265630	7136.286	N/A
4	7/1/2020	81.64	8434	5273	3625	263580	7179.31	N/A
5	7/1/2020	81.07	8320	4989	3882	265160	7333.595	N/A
6	7/1/2020	91.98	8349	4929	4317	264940	7229.405	N/A
7	7/1/2020	88.64	8225	4439	4151	264210	7176.667	N/A
8	7/2/2020	92.59	8547	5402	4386	263620	7087.881	N/A
9	7/2/2020	92.97	8705	4183	4037	264130	7127.381	N/A
10	7/2/2020	91.33	8382	5384	4346	265060	7357.524	N/A
11	7/2/2020	92.9	8157	5700	4317	265610	7253.952	N/A
12	7/2/2020	95.82	8619	5710	4150	264050	7059.238	N/A
13	7/3/2020	94.74	8621	5226	4028	263230	6993.714	N/A
14	7/3/2020	95.76	8545	4138	3829	263790	7213.143	N/A
15	7/3/2020	95.51	8824	5582	4100	266310	7165.571	N/A
16	7/3/2020	98.48	8543	4258	3988	265470	7190.429	N/A
17	7/4/2020	90.05	8613	5458	4025	266760	7126.333	N/A
18	7/4/2020	94.59	8391	5299	4103	265000	7133.262	N/A
19	7/4/2020	96.37	8602	5558	3947	266610	7184.595	N/A
20	7/4/2020	95.93	8312	5972	4522	267420	7059.619	N/A
21	7/4/2020	96.64	8668	5734	4057	264810	6971.214	N/A
22	7/5/2020	95.4	8424	5548	4100	266340	6984.071	N/A
23	7/5/2020	97.1	8576	6469	3869	264300	6957.833	N/A
24	7/5/2020	98.15	8586	5677	3944	264940	7015.786	N/A
25	7/5/2020	98.64	8661	4407	4120	265820	7048.452	N/A
26	7/5/2020	96.44	8572	5521	4104	264950	7004.81	N/A
27	7/6/2020	93.18	8493	5666	3812	264280	7147.952	N/A
28	7/6/2020	91.48	8344	5820	3791	264940	7027	N/A
29	7/6/2020	97.6	8389	4248	4200	262190	7013.857	N/A
30	7/7/2020	94.72	8516	6234	4040	264660	6964	N/A
31	7/7/2020	97.93	8529	6593	4025	265780	6964.357	N/A
32	7/7/2020	97.59	8490	5876	4182	264580	7007.881	N/A
33	7/7/2020	97.43	8543	5766	4165	264560	6991.857	N/A
34	7/7/2020	97.93	8416	4467	3928	263370	6970.524	N/A
35	7/8/2020	97.72	8379	8543	4234	264510	6925.857	N/A
36	7/8/2020	98	8421	5702	4213	263100	6880.262	N/A
37	7/8/2020	97.01	8111	4469	4022	264280	6896.286	N/A
38	7/8/2020	91.41	8206	6129	3700	266600	7002.69	N/A
39	7/8/2020	97.66	8469	5800	3921	267200	6939.452	N/A
40	7/9/2020	94.39	8024	5786	3860	264240	9241.905	N/A
41	7/9/2020	96.24	7973	5720	3988	263650	6928.095	N/A
42	7/9/2020	95.94	7933	5727	4025	267670	6828.595	N/A
43	7/9/2020	96.82	7879	5808	4150	266870	6911.714	N/A
44	7/9/2020	96.13	7690	5476	4185	265200	6858.452	N/A
45	7/10/2020	97.8	7970	5581	4051	264390	6717.262	N/A
46	7/10/2020	97.57	7852	5379	4126	265180	6781.357	N/A
47	7/10/2020	96.88	8234	5873	4366	266030	6914.095	N/A
48	7/10/2020	96.59	7983	5304	4012	264470	6725.167	N/A
49	7/11/2020	97.39	8185	5668	4220	265760	6817.881	N/A
50	7/11/2020	97.06	7984	5698	4167	263960	6763.024	N/A
51	7/11/2020	96.29	7846	5668	4142	265120	6794.69	N/A
52	7/11/2020	98.16	7987	5614	4162	264370	6759.214	N/A
53	7/11/2020	98.13	7919	5384	4211	265550	6724.214	N/A
54	7/12/2020	97.72	7394	6024	4221	264820	6736.833	N/A
55	7/12/2020	96.54	7415	5493	3716	265510	6773.286	N/A
	AVG=	94	8,299	5,548	4,065	14,494,540	387,092	TOTAL

RECEIVED
Office of Oil and Gas

SEP 22 2022

WV Department of
Environmental Protection

SM

EXHIBIT 3

LITHOLOGY/ FORMATION	TOP DEPTH (TVD)	BOTTOM DEPTH (TVD)	TOP DEPTH (MD)	BOTTOM DEPTH (MD)
	From Surface	From Surface	From Surface	From Surface
Siltstone	85	200	85	185
Shaly Siltstone	185	500	185	485
Siltstone w/ trace coal	485	660	485	645
Sandstone	565	720	565	705
Shaly Siltstone	645	720	645	705
Sandstone	705	780	705	765
Shaly Siltstone	765	980	765	965
Shale	965	1,160	965	1,145
Siltstone	1,145	1,280	1,145	1,265
Sandstone	1,265	1,440	1,265	1,425
Shaly Siltstone	1,425	1,480	1,425	1,465
Sandstone w/ trace coal	1,465	1,560	1,465	1,545
Siltstone	1,545	1,740	1,545	1,725
Silty Sandstone	1,725	1,800	1,725	1,785
Sandstone	1,785	1,950	1,785	2,019
Big Lime	1,950	2,605	2,004	2,759
Fifty Foot Sandstone	2,605	2,690	2,729	2,853
Gordon	2,690	2,990	2,823	3,189
Fifth Sandstone	2,990	3,071	3,159	3,281
Bayard	3,071	3,945	3,251	4,300
Speechley	3,945	4,222	4,270	4,624
Balltown	4,222	4,592	4,594	5,060
Bradford	4,592	5,029	5,030	5,573
Benson	5,029	5,247	5,543	5,830
Alexander	5,247	6,287	5,800	7,104
Sycamore	6,152	6,287	6,910	7,074
Middlesex	6,257	6,373	7,074	7,251
Burkett	6,343	6,391	7,251	7,293
Tully	6,361	6,423	7,293	7,385
Marcellus	6,393	NA	7,385	NA

RECEIVED
 Office of Oil and Gas
 WV Department of Environmental Protection
 SEP 29 2022

*Please note Antero determines formation tops based on mud logs that are only run on one well on a multi-well pad. The measured depth (MD) data on subsequent wells may be slightly different due to the well's

JM

Hydraulic Fracturing Fluid Product Component Information Disclosure

Job Start Date:	6/30/2020
Job End Date:	7/12/2020
State:	West Virginia
County:	Tyler
API Number:	47-095-02640-00-00
Operator Name:	Antero Resources Corporation
Well Name and Number:	Possum Unit 1H
Latitude:	39.50963000
Longitude:	-80.88636000
Datum:	NAD83
Federal Well:	NO
Indian Well:	NO
True Vertical Depth:	6,458
Total Base Water Volume (gal):	17,055,196
Total Base Non Water Volume:	0



Hydraulic Fracturing Fluid Composition:

Trade Name	Supplier	Purpose	Ingredients	Chemical Abstract Service Number (CAS #)	Maximum Ingredient Concentration in Additive (% by mass)**	Maximum Ingredient Concentration in HF Fluid (% by mass)**	Comments
Produced Water	Halliburton	Base Fluid					
			Water	7732-18-5	100.00000	86.53192	Density = 8.50
Ingredients	Listed Above	Listed Above					
			Water	7732-18-5	100.00000	0.14199	

WV Department of Environmental Protection
 Office of Resource Protection
 RECEIVED
 SEP 2 2020

[Handwritten signature]

Enviro Energy Solutions EES 2800	EnviroEnergy Solutions	Additive					
				Listed Below			
OPTIFLO-II DELAYED RELEASE BREAKER	Halliburton	Breaker					
				Listed Below			
WG-36 GELLING AGENT	Halliburton	Gelling Agent					
				Listed Below			
SAND-COMMON WHITE 40/70	Halliburton	Proppant					
				Listed Below			
MC B-8614	Halliburton	Biocide					
				Listed Below			
HYDROCHLORIC ACID, 22 BAUME	Halliburton	Solvent					
				Listed Below			
HAI-501	Halliburton	Acid Corrosion Inhibitor					
				Listed Below			
Legend LD-2555	MultiChem	Additive					
				Listed Below			

Hydraulic Fracturing Fluid Product Component Information Disclosure

Job Start Date:	6/30/2020
Job End Date:	7/12/2020
State:	West Virginia
County:	Tyler
API Number:	47-095-02640-00-00
Operator Name:	Antero Resources Corporation
Well Name and Number:	Possum Unit 1H
Latitude:	39.50963000
Longitude:	-80.88636000
Datum:	NAD83
Federal Well:	NO
Indian Well:	NO
True Vertical Depth:	6,458
Total Base Water Volume (gal):	17,055,196
Total Base Non Water Volume:	0



Hydraulic Fracturing Fluid Composition:

Trade Name	Supplier	Purpose	Ingredients	Chemical Abstract Service Number (CAS #)	Maximum Ingredient Concentration in Additive (% by mass)**	Maximum Ingredient Concentration in HF Fluid (% by mass)**	Comments
Produced Water	Halliburton	Base Fluid					
			Water	7732-18-5	100.00000	86.53192	Density = 8.50
Ingredients	Listed Above	Listed Above					
			Water	7732-18-5	100.00000	0.14199	

WV Department of Environmental Protection
 Office of Resource Conservation
 RECEIVED
 SEP 2 2020

Handwritten signature

Enviro Energy Solutions EES 2800	EnviroEnergy Solutions	Additive					
				Listed Below			
OPTIFLO-II DELAYED RELEASE BREAKER	Halliburton	Breaker					
				Listed Below			
WG-36 GELLING AGENT	Halliburton	Gelling Agent					
				Listed Below			
SAND-COMMON WHITE 40/70	Halliburton	Proppant					
				Listed Below			
MC B-8614	Halliburton	Biocide					
				Listed Below			
HYDROCHLORIC ACID, 22 BAUME	Halliburton	Solvent					
				Listed Below			
HAI-501	Halliburton	Acid Corrosion Inhibitor					
				Listed Below			
Legend LD-2555	MultiChem	Additive					
				Listed Below			

			Organic chloride compound	Proprietary	1.00000	0.00008	
			Mixture of dimer and trimer fatty acids of indefinite composition derived from tall oil	61790-12-3	30.00000	0.00007	
			Modified thiourea polymer	Proprietary	30.00000	0.00007	
			Oxylated phenolic resin	Proprietary	30.00000	0.00004	
			Propargyl alcohol	107-19-7	5.00000	0.00001	
			Hexadecene	629-73-2	5.00000	0.00001	
			Ethoxylated alcohols	Proprietary	5.00000	0.00001	
			Phosphoric acid	7664-38-2	0.10000	0.00001	
			Acrylamide	79-06-1	0.10000	0.00001	
			Organic salt #1	Proprietary	0.10000	0.00001	
			C.I. pigment Orange 5	3468-63-1	1.00000	0.00000	
			Sodium glycollate	2836-32-0	0.01000	0.00000	
			Sodium hydroxide	1310-73-2	0.01000	0.00000	
			Formaldehyde	50-00-0	0.01000	0.00000	
			Organic salt #2	Proprietary	0.01000	0.00000	
			Organic salt #3	Proprietary	0.01000	0.00000	
			Nitrated acetate salt	Proprietary	0.01000	0.00000	
			Ethylene oxide	75-21-8	0.01000	0.00000	

* Total Water Volume sources may include various types of water including fresh water, produced water, and recycled water

** Information is based on the maximum potential for concentration and thus the total may be over 100%

*** If you are calculating a percentage of total ingredients do not add the water volume below the green line to the water volume above the green line

Note: For Field Development Products (products that begin with FDP), MSDS level only information has been provided.

Ingredient information for chemicals subject to 29 CFR 1910.1200(i) and Appendix D are obtained from suppliers Material Safety Data Sheets (MSDS)

Antero Resources
Well No. Possum Unit 1H
 As-Drilled
 Antero Resources Corporation

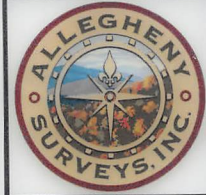

	Bearing	Dist.
L1	N 04°21' W	1,429.2'
L2	N 58°08' E	2,728.7'
L3	S 61°40' E	2,052.6'
L4	S 26°36' E	1,079.7'

Notes:
 West Virginia Coordinate System of 1927, North Zone based upon Differential GPS Measurements.
 Well No. Possum Unit 1H Top Hole coordinates are
 N: 370,746.26' Latitude: 39°30'34.67"
 E: 1,608,858.39' Longitude: 80°53'10.88"
 Bottom Hole coordinates are
 N: 380,733.76' Latitude: 39°32'12.41"
 E: 1,602,612.73' Longitude: 80°54'32.56"
 UTM Zone 17, NAD 1983
 Top Hole Coordinates Bottom Hole Coordinates
 N: 4,373,348.059m N: 4,376,359.000m
 E: 509,784.498m E: 507,831.025m
 Plat orientation and corner and well references are based upon the grid north meridian.
 Well location references are based upon the magnetic meridian.

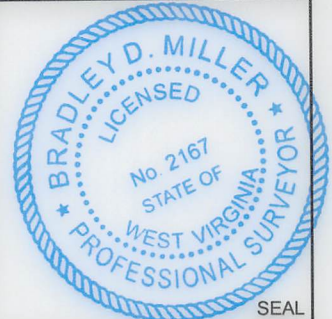

I, the undersigned, hereby certify that this plat is correct to the best of my knowledge and belief and shows all the information required by law and the rules issued and prescribed by the Department of Environmental Protection.
 Bradley D. Miller, P.S. 2167

Legend

- Proposed gas well
- Monument, as noted
- Existing Well, as noted
- Digitized Well, as noted
- Creek or Drain
- Surface boundary (approx.)
- Interior surface tracts (approx.)

Wellhead Layout (NTS)

- Maggie Unit 3H 47-095-02639
- Maggie Unit 2H 47-095-02638
- Maggie Unit 1H 47-095-02637
- Harpua Unit 2H 47-095-02641
- Harpua Unit 1H 47-095-02636
- Possum Unit 2H 47-095-02642
- As-Drilled Possum Unit 1H 47-095-02640

Note: 1 water wells and 2 springs were found within 2000' of proposed well. No occupied dwellings or buildings 2,500 square feet or larger used to house or shelter dairy cattle or poultry husbandry are located within 625' of the center of the well pad.

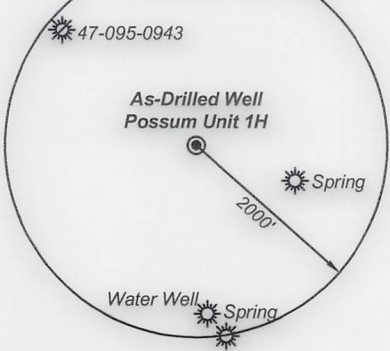

Top Hole Coordinates, As-drilled data, and information was provided by Antero Resources Corporation. Allegany Surveys Inc. (ASI) is not certifying the data and information provided. ASI is not responsible for any errors or inaccuracies with the data and information that has been provided.

FILE NO: 39-54-E-16
 DRAWING NO: Possum 1H Well Plat
 SCALE: 1" = 2000'
 MINIMUM DEGREE OF ACCURACY: Submeter
 PROVEN SOURCE OF ELEVATION: WVDOT, Harrisville, WV

STATE OF WEST VIRGINIA
 DEPARTMENT OF ENVIRONMENTAL PROTECTION
OIL AND GAS DIVISION

DATE: June 19, 2020
 OPERATOR'S WELL NO. Possum Unit 1H
 API WELL NO. 47-095-02640
 STATE COUNTY PERMIT

WELL TYPE: OIL GAS LIQUID INJECTION WASTE DISPOSAL
 (IF GAS) PRODUCTION: STORAGE DEEP SHALLOW

LOCATION: ELEVATION: As-Drilled 1,061' WATERSHED: Outlet Middle Island Creek QUADRANGLE: Paden City
 DISTRICT: Ellsworth COUNTY: Tyler
 SURFACE OWNER: Barbara Kay Turner ACREAGE: 26.18
 ROYALTY OWNER: Linda L. Newbrough; Naomi V. Beagle; Scott Denomme, et ux; Sarah A. Midcap (2) LEASE NO: ACREAGE: 93.63; 217.30;
 PROPOSED WORK: DRILL CONVERT DRILL DEEPER FRACTURE OR STIMULATE PLUG OFF OLD FORMATION
 PERFORATE NEW FORMATION OTHER PHYSICAL CHANGE IN WELL (SPECIFY) As-Drilled
 PLUG AND ABANDON CLEAN OUT AND REPLUG TARGET FORMATION: Marcellus Shale ESTIMATED DEPTH: 18,557' MD

WELL OPERATOR: Antero Resources Corporation DESIGNATED AGENT: Dianna Stamper - CT Corporation System
 ADDRESS: 1615 Wynkoop Street ADDRESS: 5400 D Big Tyler Road
 Denver, CO 80202 Charleston, WV 25313

ID	TM/Par	Owner	Bk/Pg	Acres
1	15-18	Barbara Kay Turner	398/670	26.18
2	15-19	David Mendenhall, et al	282/723	45.00
3	14-27	Ridgetop Capital LP	372/299	64.96
4	14-60.2	Douglas & Tricia Long	333/872	24.47
5	14-60	James A. Jr. & Angela K. Long	333/188	23.99
6	14-58	Linda Newbrough	WB 36/617	10.31
7	14-57	Danny Eugene Cochran	344/251	40.30
8	14-56.1	Boyd M. & Patricia L. Parr	358/643	35.33
9	14A-29	Victor A. & Lorraine Weekley	299/300	13.00
10	14A-29.1	Mensore J.C. Distributors	285/213	1.00
11	14-23	Jackie R. Brookover II	321/749	6.88
12	14-20.1	Jackie R. Brookover II	346/29	13.46
13	14-24	Ridgetop Capital LP	372/299	124.76
14	14-26	Barbara Kay Turner	398/670	26.34
15	114-25	Stanley M. & Irene E. Koterba, et al	331/32	126.05
16	14-18	Terry W. & Carolyn Sue Tracy	193/473	37.00
17	14-9	Robert L. Keller	299/379	116.90
18	14-8	Christine Connell, et al	---/---	37.00
19	14-25.2	Andrew B. & Angela M. Negie	489/577	3.00
20	14-25.1	Roy F. Gorrell	447/180	2.00
21	14-10	Sarah A. Midcap	342/568	40.00
22	14-9.1	John W. & Ida L. Murner	338/162	6.00
23	9-36.2	Ron & Charlene Vancamp	296/390	28.79
24	9-39	Tyler County Board of Education	290/88	65.00
25	9-40.1	Tyler County Board of Education	290/88	9.17
26	9-40	Sarah A. Midcap	168/3	16.83
27	9-31	Sarah A. Midcap	168/3	74.00
28	9-30	Heartwood Forestland Fund II LP	326/547	144.31
29	9-15	Heartwood Forestland Fund II LP	326/547	225.64
30	9-20	Heartwood Forestland Fund II LP	326/547	57.61
31	9-14	Leroy Kent Morris, et al	480/311	93.63
32	13-8	D.H. Jr., & Janice K. Lancaster	351/288	52.84
33	13-3	Mark E. Heintzman	221/635	51.96
34	13-4	William Franklin Ferrell	207/417	10.75
35	9-44	Diane W. Clark	WB 39/544	40.68
36	9-1	Linda L. Stemple	369/9	24.24
37	9-2	William & Margaret Garrett	284/41	22.19
38	9-36	Diane W. Clark	WB 39/544	59.00
39	9-28	Constance Heintzman	WB 43/505	104.50
40	9-29	Russell D. & Mary A. Adams	190/300	1.00
41	9-28.1	Ervin L. & Betty M. Bassett	299/158	4.35
42	9-30	Ervin L. & Betty M. Bassett	309/391	19.57
43	9-30.4	Ervin L. & Betty M. Bassett	337/119	0.34
44	9-30.5	Georgeanna & Scott Michael	414/470	1.53
45	9-30.6	Georgeanna & Scott Michael	423/709	0.58
46	9-30.3	Ervin L. & Betty M. Bassett	337/119	0.23
47	9-30.2	Mark B. Hubbard, Jr.	309/388	1.27
48	9-30.1	Mark B. Hubbard, Jr.	423/709	1.38
49	9-35	Mark E. Heintzman	246/532	19.75
50	9-31.2	Ralph & Sylvia Harter	347/178	4.57
51	9-31	Russell L. & Mary E. Myers	347/263	31.45
52	9-27	Robert Livio Bolner	226/593	59.00
53	9-31.1	Russell L. & Mary E. Myers	340/654	38.04
54	9-24	Ethan A. & Marsha L. Riffle	299/26	82.00
55	9-19	Russell L. & Mary E. Myers	337/26	93.17

Lessor	
A	Linda L. Newbrough
B	Jack Russell Folger, et ux
C	Naomi V. Beagle
D	Douglas H. Long, et ux
E	James A. Long, Jr., et ux
F	Linda L. Newbrough
G	Nathaniel Hendricks
H	Scott Denomme, et ux
I	Scott Denomme, et ux
J	Stanley M. & Irene E. Koterba
K	Sarah A. Midcap
L	Sarah A. Midcap
M	David E. Bowyer
N	Waco Oil & Gas Co. Inc.
O	BRC Appalachian Minerals I, LLC
P	Marilyn S. Parkinson
Q	Sandra L. Baumgardner
R	Donald Lancaster, Jr., et ux
S	Thomas Goodwin, et ux
T	Kathryn L. Watkins
U	Diane W. Kestle
V	Melodee Matheny
W	BRC Appalachian Minerals I, LLC
X	Jean Cline
Y	Mark E. Heintzman
Z	Martha Hayes, et vir
AA	Richard L. Clark
AB	Michael D. Reynolds
AC	Timothy L. Vancamp



FILE NO: 39-54-E-16
 DRAWING NO: Possum 1H Well Plat
 SCALE: 1" = 2000'
 MINIMUM DEGREE OF ACCURACY:
 Submeter
 PROVEN SOURCE OF ELEVATION:
 WVDOT, Harrisville, WV



DATE: June 19 20 20
 OPERATOR'S WELL NO. Possum Unit 1H
 API WELL NO
 47 - 095 - 02640
 STATE COUNTY PERMIT

WELL TYPE: OIL GAS LIQUID INJECTION WASTE DISPOSAL
 (IF GAS) PRODUCTION: STORAGE DEEP SHALLOW

LOCATION: ELEVATION: As-Drilled 1,061' WATERSHED: Outlet Middle Island Creek QUADRANGLE: Paden City
 DISTRICT: Ellsworth COUNTY: Tyler
 SURFACE OWNER: Barbara Kay Turner ACREAGE: 26.18 62.84375; 452.99125; 74.169; 64.18; 91.831;
 ROYALTY OWNER: Linda L. Newbrough; Naomi V. Beagle; Scott Denomme, et ux; Sarah A. Midcap (2) LEASE NO: ACREAGE: 93.63; 217.30;
 PROPOSED WORK: DRILL CONVERT DRILL DEEPER FRACTURE OR STIMULATE PLUG OFF OLD FORMATION
 PERFORATE NEW FORMATION OTHER PHYSICAL CHANGE IN WELL (SPECIFY) As-Drilled 6,373' TVD
 PLUG AND ABANDON CLEAN OUT AND REPLUG TARGET FORMATION: Marcellus Shale ESTIMATED DEPTH: 18,557' MD

WELL OPERATOR: Antero Resources Corporation DESIGNATED AGENT: Dianna Stamper - CT Corporation System
 ADDRESS: 1615 Wynkoop Street ADDRESS: 5400 D Big Tyler Road
 Denver, CO 80202 Charleston, WV 25313