

ANTERO RESOURCES CORPORATION

Location: Tyler County, WV
 Field: Tyler
 Facility: Gamehenge East Pad

Slot: Slot #01
 Well: Possum Unit 1H
 Wellbore: Possum Unit 1H PWB



API: 47-095-02640-0000
 BHI Job #: 110238614A
 Rig: H&P 519
 Duration: 02/03/2020-02/05/2020

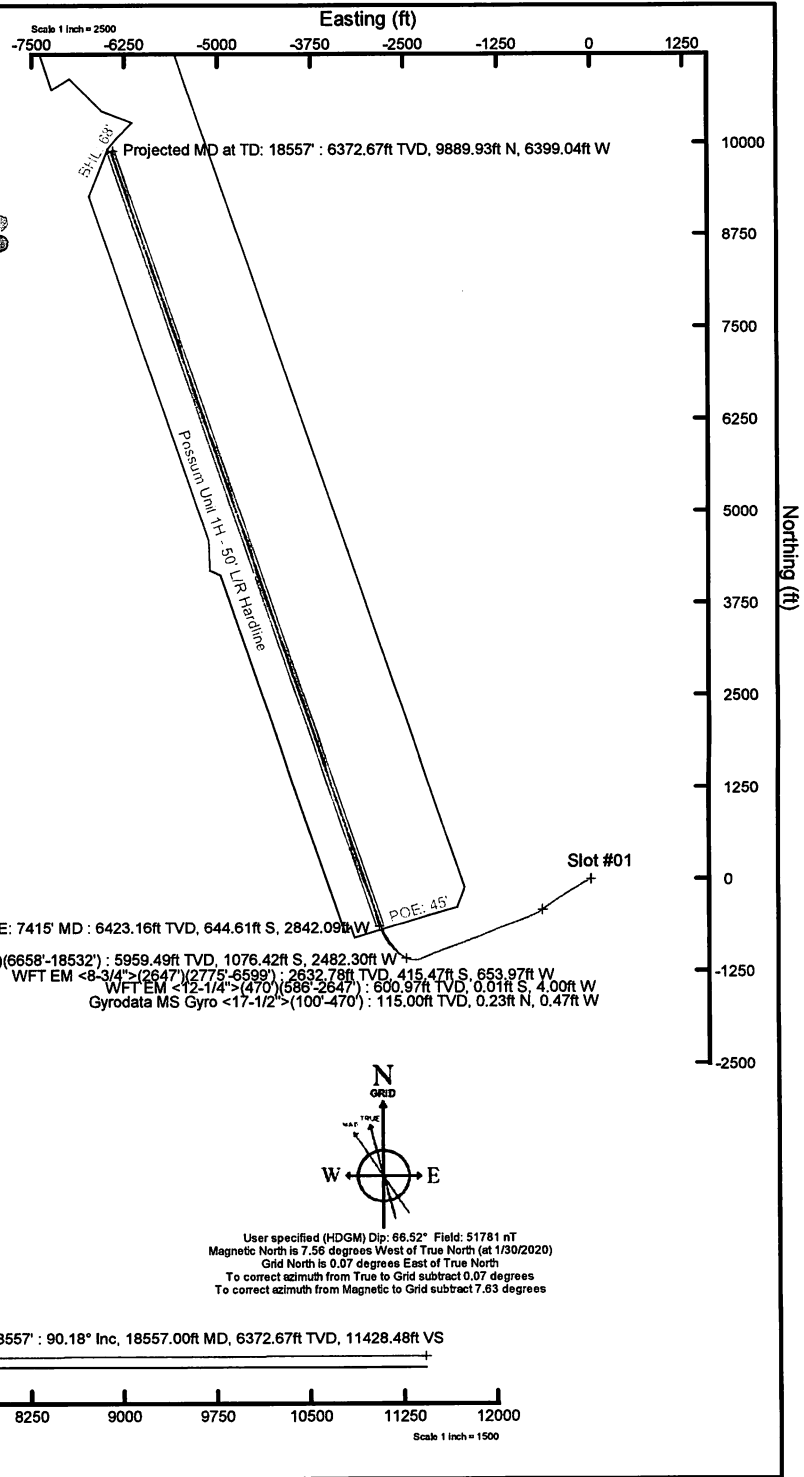

Plot reference wellpath is Possum Unit 1H PWP Rev-A.0	Grid System: NAD27 / UTM Zone 17 North, US feet
True vertical depths are referenced to H&P 519 (RKB)	North Reference: Grid north
Reference wellpath measured depths are referenced to H&P 519 (RKB)	Scale: True distance
H&P 519 (RKB) to Mean Sea Level: 1091 feet	Coordinates are in feet referenced to Slot
Mean Sea Level to Ground level (At Slot: Slot #01): -1091 feet	Depths are in feet
Offset wellpath MDs are referenced to each path's default MD datum	Created by: ddesmet on 2020-02-13; Database: WA_MPL_EasternUS_Defn

Location Information						
Facility Name	Grid East (US ft)	Grid North (US ft)	Latitude	Longitude		
Gamehenge East Pad	1672504.896	14347540.047	39°30'34.9460"N	80°53'10.4370"W		
Slot	Local N (ft)	Local E (ft)	Grid East (US ft)	Grid North (US ft)	Latitude	Longitude
Slot #01	-27.16	-35.86	1672469.050	14347512.900	39°30'34.6780"N	80°53'10.8950"W
H&P 519 (RKB) to Ground level (At Slot: Slot #01)						30ft
Mean Sea Level to Ground level (At Slot: Slot #01)						-1061ft
H&P 519 (RKB) to Mean Sea Level						1091ft

Well Profile Data								
Design Comment	MD (ft)	Inc (°)	Az (°)	TVD (ft)	Local N (ft)	Local E (ft)	DLS (*/100ft)	VS (ft)
Tie On	6614.00	30.760	289.770	5921.84	-1084.96	-2461.19	6.69	-230.18
Proj. To Bit	6689.00	32.390	297.050	5985.76	-1069.33	-2497.14	5.52	-203.75
End of 3D Arc	7261.14	63.891	330.605	6368.44	-763.67	-2770.58	6.89	173.94
POE	7419.58	92.014	341.116	6428.00	-629.87	-2830.12	8.00	319.81
Landing Pt.	7644.30	90.000	341.116	6463.00	-420.62	-2901.69	8.00	540.96
BHL	18531.20	90.000	341.116	6463.00	9880.42	-8425.23	0.00	11427.96

Well Data			
Slot	Well	Wellbore	Wellpath
Slot #01	Possum Unit 1H	Possum Unit 1H AWB	Possum Unit 1H PWP Proj: 18557'
Slot #01	Possum Unit 1H	Possum Unit 1H PWB	Possum Unit 1H PWP Rev-A.0

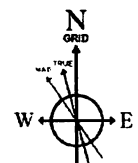

User specified (HDGM) Dip: 66.52° Field: 51781 nT
 Magnetic North is 7.56 degrees West of True North (at 1/30/2020)
 Grid North is 0.07 degrees East of True North
 To correct azimuth from True to Grid subtract 0.07 degrees
 To correct azimuth from Magnetic to Grid subtract 7.63 degrees

True Vertical Depth (ft)

Scale 1 Inch = 1500

Northing (ft)

Scale 1 Inch = 1500

Vertical Section (ft)

Scale 1 Inch = 1500

Azimuth 341.12° with reference 0.00 N, 0.00 E



Actual Wellpath Report

Possum Unit 1H AWP Proj: 18557'

Page 1 of 11



REFERENCE WELLPATH IDENTIFICATION			
Operator	ANTERO RESOURCES CORPORATION	Well	Possum Unit 1H
Field	Tyler	API	47-095-02640-0000
Facility	Gamehenge East Pad	Wellbore	Possum Unit 1H AWB
Slot	Slot #01		

REPORT SETUP INFORMATION			
Projection System	NAD27 / UTM Zone 17 North, US feet	Software System	WellArchitect® 6.0
North Reference	Grid	User	Delaset
Scale	0.999601	Report Generated	2/13/2020 at 3:17:25 PM
Convergence at slot	0.07° East	Database	WA_MPL_EasternUS_Defn

WELLPATH LOCATION						
	Local coordinates		Grid coordinates		Geographic coordinates	
	North[ft]	East[ft]	Easting[US ft]	Northing[US ft]	Latitude	Longitude
Slot Location	-27.16	-35.86	1672469.05	14347512.90	39°30'34.6780"N	80°53'10.8950"W
Facility Reference Pt			1672504.90	14347540.05	39°30'34.9460"N	80°53'10.4370"W
Field Reference Pt			0.00	0.00	0°00'0.0000"	85°29'19.3013"W

WELLPATH DATUM			
Calculation method	Minimum curvature	H&P 519 (RKB) to Facility Vertical Datum	1091.00ft
Horizontal Reference Pt	Slot	H&P 519 (RKB) to Mean Sea Level	1091.00ft
Vertical Reference Pt	H&P 519 (RKB)	H&P 519 (RKB) to Ground Level at Slot (Slot #01)	30.00ft
MD Reference Pt	H&P 519 (RKB)	Section Origin	N 0.00, E 0.00 ft
Field Vertical Reference	Mean Sea Level	Section Azimuth	341.12°



Actual Wellpath Report

Possum Unit 1H AWP Proj: 18557*
Page 2 of 11



REFERENCE WELLPATH IDENTIFICATION			
Operator	ANTERO RESOURCES CORPORATION	Well	Possum Unit 1H
Field	Tyler	API	47-095-02640-0000
Facility	Gamehenge East Pad	Wellbore	Possum Unit 1H AWB
Slot	Slot #01		

WELLPATH DATA (221 stations) † = interpolated, ‡ = extrapolated station																
MD (ft)	Inclination (°)	Azimuth (°)	TVD (ft)	Vert Sect (ft)	North (ft)	East (ft)	Grid East (US ft)	Grid North (US ft)	Latitude	Longitude	Closure Dist (ft)	Closure Dir (°)	DLS (°/100ft)	Build Rate (°/100ft)	Turn Rate (°/100ft)	Comments
0.00	0.00	295.800	0.00	0.00	0.00	0.00	1672469.05	14347512.90	39°30'34.6780"N	80°53'10.8950"W	0.00	0.000	0.00	0.00	0.00	
30.00	0.000	295.800	30.00	0.00	0.00	0.00	1672469.05	14347512.90	39°30'34.6780"N	80°53'10.8950"W	0.00	0.000	0.00	0.00	0.00	
115.00	0.700	295.800	115.00	0.37	0.23	-0.47	1672468.58	14347513.13	39°30'34.6803"N	80°53'10.9009"W	0.52	295.800	0.82	0.82	0.00	Gyrodata MS Gyro <17-1/2">(100'-470')
140.00	0.620	306.770	140.00	0.58	0.37	-0.71	1672468.34	14347513.27	39°30'34.6817"N	80°53'10.9041"W	0.81	297.632	0.60	-0.32	43.88	
165.00	0.580	295.230	164.99	0.80	0.52	-0.96	1672468.09	14347513.42	39°30'34.6832"N	80°53'10.9071"W	1.09	298.437	0.57	0.24	-46.16	
190.00	0.620	305.110	189.99	1.01	0.66	-1.20	1672467.85	14347513.56	39°30'34.6846"N	80°53'10.9103"W	1.37	298.747	0.51	-0.24	39.52	
215.00	0.490	299.310	214.99	1.20	0.79	-1.40	1672467.65	14347513.69	39°30'34.6858"N	80°53'10.9129"W	1.61	299.318	0.57	-0.52	-23.20	
240.00	0.440	293.950	239.99	1.35	0.88	-1.59	1672467.47	14347513.78	39°30'34.6868"N	80°53'10.9152"W	1.81	299.033	0.26	-0.20	-21.44	
265.00	0.540	297.920	264.99	1.50	0.97	-1.78	1672467.27	14347513.87	39°30'34.6877"N	80°53'10.9176"W	2.03	298.728	0.42	0.40	15.88	
290.00	0.510	301.080	289.99	1.67	1.09	-1.98	1672467.07	14347513.99	39°30'34.6888"N	80°53'10.9202"W	2.26	298.802	0.17	-0.12	12.84	
315.00	0.460	291.320	314.99	1.82	1.18	-2.17	1672466.89	14347514.08	39°30'34.6897"N	80°53'10.9226"W	2.47	298.601	0.39	-0.20	-39.04	
340.00	0.480	297.300	339.99	1.96	1.27	-2.35	1672466.70	14347514.16	39°30'34.6906"N	80°53'10.9249"W	2.67	298.277	0.21	0.08	23.92	
365.00	0.240	289.060	364.99	2.07	1.33	-2.49	1672466.56	14347514.23	39°30'34.6912"N	80°53'10.9268"W	2.83	298.071	0.98	-0.96	-32.96	
390.00	0.110	265.230	389.99	2.10	1.35	-2.57	1672466.48	14347514.24	39°30'34.6914"N	80°53'10.9277"W	2.90	297.652	0.59	-0.52	-95.32	
415.00	0.020	210.320	414.99	2.11	1.34	-2.58	1672466.46	14347514.24	39°30'34.6913"N	80°53'10.9280"W	2.92	297.314	0.40	-0.36	-219.64	
440.00	0.080	42.160	439.99	2.11	1.35	-2.58	1672466.47	14347514.25	39°30'34.6914"N	80°53'10.9279"W	2.92	297.560	0.40	0.24	-672.64	
465.00	0.040	79.780	464.99	2.12	1.36	-2.56	1672466.49	14347514.26	39°30'34.6915"N	80°53'10.9277"W	2.90	297.998	0.22	-0.16	150.48	
485.00	0.130	184.400	484.99	2.10	1.34	-2.56	1672466.49	14347514.24	39°30'34.6913"N	80°53'10.9276"W	2.89	297.672	0.73	0.49	523.10	
601.00	1.860	229.540	600.97	1.28	-0.01	-4.00	1672465.05	14347512.88	39°30'34.6780"N	80°53'10.9460"W	4.00	269.843	1.53	1.49	38.91	WFT EM <12-1/4">(470')(585'-2647')
631.00	3.070	236.510	630.94	0.90	-0.77	-5.04	1672464.01	14347512.13	39°30'34.6705"N	80°53'10.9593"W	5.10	261.315	4.15	4.03	23.23	
662.00	4.410	240.120	661.87	0.47	-1.82	-6.77	1672462.28	14347511.08	39°30'34.6601"N	80°53'10.9813"W	7.01	254.932	4.39	4.32	11.65	
693.00	5.480	244.290	692.75	0.06	-3.06	-9.14	1672459.92	14347509.84	39°30'34.6479"N	80°53'11.0116"W	9.83	251.492	3.64	3.45	13.45	
785.00	7.520	241.610	784.16	-1.45	-7.63	-18.39	1672450.67	14347505.08	39°30'34.6009"N	80°53'11.1297"W	19.99	246.946	2.24	2.22	-2.91	
878.00	10.770	238.670	875.95	-4.33	-15.24	-31.17	1672437.89	14347497.67	39°30'34.5278"N	80°53'11.2929"W	34.70	243.944	3.53	3.49	-3.16	
975.00	13.130	239.990	970.66	-8.42	-25.46	-48.45	1672420.62	14347487.45	39°30'34.4270"N	80°53'11.5136"W	54.74	242.275	2.45	2.43	1.36	
1070.00	15.180	241.580	1062.97	-12.56	-36.76	-68.74	1672400.34	14347476.13	39°30'34.3154"N	80°53'11.7726"W	77.96	241.849	2.20	2.18	1.67	
1165.00	16.720	240.420	1154.31	-17.16	-49.45	-91.56	1672377.52	14347463.47	39°30'34.1905"N	80°53'12.0640"W	104.06	241.629	1.66	1.62	-1.22	
1259.00	18.380	238.200	1243.93	-22.98	-63.93	-115.92	1672353.18	14347448.99	39°30'34.0476"N	80°53'12.3750"W	132.38	241.122	1.90	1.77	-2.36	
1354.00	21.730	237.820	1333.16	-30.98	-81.20	-143.54	1672325.57	14347431.74	39°30'33.8773"N	80°53'12.7276"W	164.92	240.505	3.53	3.53	-0.40	
1449.00	24.810	239.680	1420.42	-38.38	-100.63	-175.64	1672293.48	14347412.31	39°30'33.6857"N	80°53'13.1375"W	202.42	240.190	3.33	3.24	1.96	

RECEIVED
Office of Oil and Gas
SEP 22 2022
Department of
Environmental Protection

52



Actual Wellpath Report

Poosum Unit 1H AWP Proj: 18557'

Page 3 of 11



REFERENCE WELLPATH IDENTIFICATION			
Operator	ANTERO RESOURCES CORPORATION	Well	Poosum Unit 1H
Field	Tyler	API	47-095-02640-0000
Facility	Gamehenge East Pad	Wellbore	Poosum Unit 1H AWB
Slot	Slot #01		

WELLPATH DATA (221 stations)																
MD [ft]	Inclination [°]	Azimuth [°]	TVD [ft]	Vert Sect [ft]	North [ft]	East [ft]	Grid East [US ft]	Grid North [US ft]	Latitude	Longitude	Closure Dist [ft]	Closure Dir [°]	DLS [°/100ft]	Build Rate [°/100ft]	Turn Rate [°/100ft]	Comments
1544.00	24.730	240.020	1505.68	-46.16	-120.62	-210.06	1672259.08	14347392.33	39°30'33.4885"N	80°53'13.5769"W	242.23	240.134	0.17	-0.09	0.36	
1639.00	24.950	239.240	1592.89	-54.11	-140.80	-244.49	1672224.66	14347372.16	39°30'33.2895"N	80°53'14.0165"W	282.13	240.063	0.42	0.23	-0.82	
1734.00	25.530	237.670	1678.82	-63.00	-162.00	-279.01	1672190.16	14347350.97	39°30'33.0804"N	80°53'14.4572"W	322.62	239.860	0.93	0.61	-1.65	
1828.00	24.840	237.120	1763.89	-72.49	-183.55	-312.70	1672156.47	14347329.43	39°30'32.8679"N	80°53'14.8875"W	362.59	239.588	0.78	-0.73	-0.59	
1923.00	25.340	238.100	1849.92	-81.89	-205.12	-346.72	1672122.47	14347307.88	39°30'32.6550"N	80°53'15.3219"W	402.85	239.391	0.68	0.53	1.03	
2018.00	24.120	236.830	1936.21	-91.26	-226.49	-380.23	1672088.97	14347286.50	39°30'32.4443"N	80°53'15.7497"W	442.57	239.219	1.40	-1.28	-1.34	
2112.00	25.000	236.020	2021.70	-101.18	-248.10	-412.78	1672056.44	14347264.90	39°30'32.2311"N	80°53'16.1653"W	481.60	238.992	1.00	0.94	-0.86	
2207.00	25.850	237.640	2107.50	-111.24	-270.40	-446.92	1672022.31	14347242.61	39°30'32.0111"N	80°53'16.6013"W	522.35	238.824	1.16	0.89	1.71	
2302.00	26.620	235.720	2192.72	-121.72	-293.48	-482.00	1671987.24	14347219.54	39°30'31.7835"N	80°53'17.0492"W	564.32	238.664	1.21	0.81	-2.02	
2398.00	26.010	234.150	2278.98	-133.33	-317.41	-516.11	1671953.15	14347195.52	39°30'31.5474"N	80°53'17.4848"W	605.90	238.408	0.98	-0.65	-1.67	
2491.00	25.590	234.750	2362.51	-145.18	-341.45	-549.75	1671919.52	14347171.59	39°30'31.3102"N	80°53'17.9143"W	647.16	238.155	0.52	-0.44	0.63	
2586.00	26.010	234.950	2448.04	-156.77	-365.25	-583.56	1671885.73	14347147.79	39°30'31.0753"N	80°53'18.3460"W	688.44	237.957	0.45	0.44	0.21	
2682.00	25.370	234.800	2516.52	-165.99	-384.21	-610.50	1671858.79	14347128.84	39°30'30.8883"N	80°53'18.6901"W	721.34	237.816	0.85	-0.84	-0.20	
2790.00	24.090	233.730	2632.78	-181.50	-415.47	-653.97	1671815.34	14347097.59	39°30'30.5799"N	80°53'19.2452"W	774.79	237.572	1.06	-1.00	-0.84	WFT EM <8-3/4">(2647')(2775'-6599')
2853.00	25.480	234.850	2689.88	-189.14	-430.88	-675.42	1671793.90	14347082.19	39°30'30.4278"N	80°53'19.6191"W	801.16	237.484	2.33	2.21	1.78	
2948.00	26.430	238.500	2775.40	-199.49	-453.69	-710.16	1671759.18	14347059.39	39°30'30.2028"N	80°53'19.9627"W	842.71	237.427	1.96	1.00	3.84	
3043.00	25.940	243.350	2860.66	-206.92	-474.06	-746.76	1671722.59	14347039.03	39°30'30.0019"N	80°53'20.4300"W	884.53	237.592	2.31	-0.52	5.11	
3137.00	27.100	244.700	2944.77	-212.09	-492.44	-784.49	1671684.87	14347020.66	39°30'29.8208"N	80°53'20.9117"W	926.24	237.883	1.39	1.23	1.44	
3232.00	28.410	247.360	3028.84	-215.99	-510.38	-824.92	1671644.46	14347002.72	39°30'29.6439"N	80°53'21.4277"W	970.04	238.255	1.90	1.38	2.80	
3327.00	30.710	248.000	3111.47	-218.79	-528.17	-868.27	1671601.12	14346984.94	39°30'29.4686"N	80°53'21.9811"W	1016.30	238.688	2.44	2.42	0.67	
3425.00	32.720	249.190	3194.83	-221.05	-546.96	-916.24	1671553.18	14346968.16	39°30'29.2835"N	80°53'22.5933"W	1067.08	239.164	2.15	2.05	1.21	
3520.00	31.940	247.500	3275.11	-223.50	-565.70	-963.46	1671505.98	14346947.43	39°30'29.0989"N	80°53'23.1961"W	1117.26	239.581	1.26	-0.82	-1.78	
3615.00	30.700	247.870	3356.26	-226.46	-584.45	-1009.14	1671460.31	14346928.68	39°30'28.9141"N	80°53'23.7792"W	1166.17	239.922	1.32	-1.31	0.39	
3710.00	29.950	249.600	3438.27	-228.47	-601.85	-1053.83	1671415.64	14346911.29	39°30'28.7427"N	80°53'24.3496"W	1213.58	240.269	1.21	-0.79	1.62	
3805.00	30.420	248.260	3520.38	-230.29	-619.03	-1098.40	1671371.09	14346894.12	39°30'28.5734"N	80°53'24.9185"W	1260.82	240.598	0.86	0.49	-1.41	
3900.00	30.460	248.330	3602.29	-232.67	-636.83	-1143.12	1671326.39	14346876.33	39°30'28.3981"N	80°53'25.4893"W	1308.54	240.878	0.06	0.04	0.07	
3994.00	30.830	247.680	3683.16	-235.27	-654.77	-1187.54	1671281.98	14346858.39	39°30'28.2212"N	80°53'26.0564"W	1356.09	241.129	0.53	0.39	-0.69	
4089.00	31.510	247.650	3764.45	-238.23	-673.46	-1233.02	1671236.52	14346839.71	39°30'28.0371"N	80°53'26.6369"W	1404.95	241.357	0.72	0.72	-0.03	
4184.00	31.300	247.920	3845.53	-241.11	-692.17	-1278.85	1671190.71	14346821.00	39°30'27.8527"N	80°53'27.2219"W	1454.16	241.576	0.27	-0.22	0.28	
4279.00	31.050	248.030	3926.81	-243.81	-710.62	-1324.44	1671145.14	14346802.57	39°30'27.6709"N	80°53'27.8038"W	1503.04	241.785	0.27	-0.26	0.12	



Actual Wellpath Report

Poosum Unit 1H AWP Proj: 18557'

Page 4 of 11



REFERENCE WELLPATH IDENTIFICATION				
Operator	ANTERO RESOURCES CORPORATION		Well	Poosum Unit 1H
Field	Tyler		API	47-095-02640-0000
Facility	Gamehenge East Pad		Wellbore	Poosum Unit 1H AWP
Slot	Slot #01			

WELLPATH DATA (221 stations)																
MD (ft)	Inclination (°)	Azimuth (°)	TVD (ft)	Vert Sect (ft)	North (ft)	East (ft)	Grid East (US ft)	Grid North (US ft)	Latitude	Longitude	Closure Dist (ft)	Closure Dir (°)	DLS (ft/100ft)	Build Rate (ft/100ft)	Turn Rate (ft/100ft)	Comments
4374.00	31.460	247.880	4008.01	-246.54	-729.12	-1370.14	1671099.46	14346784.07	39°30'27.4886"N	80°53'28.3871"W	1552.06	241.980	0.46	0.45	-0.16	
4469.00	30.230	246.080	4089.57	-250.04	-748.16	-1414.98	1671054.63	14346765.04	39°30'27.3010"N	80°53'28.9595"W	1500.60	242.133	1.64	-1.32	-1.89	
4563.00	31.140	247.130	4170.41	-253.81	-767.20	-1459.01	1671010.63	14346746.01	39°30'27.1133"N	80°53'29.5215"W	1548.43	242.263	1.12	0.97	1.12	
4658.00	32.710	248.400	4251.04	-256.74	-786.20	-1505.51	1670964.14	14346727.02	39°30'26.9261"N	80°53'30.1151"W	1598.43	242.426	1.80	1.85	1.34	
4753.00	33.590	250.700	4330.58	-258.15	-804.33	-1564.18	1670915.49	14346708.89	39°30'26.7474"N	80°53'30.7383"W	1749.98	242.637	1.62	0.93	2.42	
4847.00	32.040	249.340	4409.58	-259.11	-821.73	-1602.06	1670867.63	14346691.50	39°30'26.5761"N	80°53'31.3474"W	1800.51	242.846	1.83	-1.65	-1.45	
4942.00	30.030	247.120	4490.97	-261.55	-839.86	-1647.54	1670822.17	14346673.37	39°30'26.3974"N	80°53'31.9280"W	1849.26	242.989	2.43	-2.12	-2.34	
5037.00	30.810	247.810	4572.90	-264.62	-858.29	-1691.97	1670777.78	14346654.95	39°30'26.2158"N	80°53'32.4951"W	1897.22	243.102	0.90	0.82	0.73	
5131.00	32.440	250.370	4652.94	-266.34	-875.86	-1738.01	1670731.73	14346637.39	39°30'26.0427"N	80°53'33.0828"W	1946.23	243.255	2.25	1.73	2.72	
5226.00	32.230	250.560	4733.21	-266.92	-892.85	-1785.90	1670683.86	14346620.41	39°30'25.8754"N	80°53'33.6940"W	1996.65	243.438	0.25	-0.22	0.20	
5321.00	30.790	248.740	4814.20	-268.18	-910.10	-1832.45	1670637.33	14346603.17	39°30'25.7054"N	80°53'34.2881"W	2046.01	243.588	1.82	-1.52	-1.92	
5415.00	31.500	250.520	4894.65	-269.43	-927.01	-1878.03	1670591.77	14346586.26	39°30'25.5386"N	80°53'34.8698"W	2094.36	243.729	1.24	0.76	1.89	
5510.00	32.270	250.440	4975.32	-269.99	-943.78	-1925.32	1670544.50	14346569.50	39°30'25.3736"N	80°53'35.4735"W	2144.20	243.886	0.81	0.81	-0.08	
5605.00	30.950	249.040	5056.22	-271.18	-961.01	-1972.04	1670497.80	14346552.28	39°30'25.2039"N	80°53'36.0697"W	2193.73	244.019	1.59	-1.39	-1.47	
5699.00	31.920	249.080	5136.42	-272.94	-978.53	-2017.82	1670452.04	14346534.76	39°30'25.0313"N	80°53'36.6541"W	2242.57	244.129	1.03	1.03	0.04	
5794.00	32.240	249.280	5216.92	-274.65	-996.46	-2064.98	1670404.89	14346516.84	39°30'24.8546"N	80°53'37.2561"W	2292.84	244.240	0.35	0.34	0.21	
5889.00	31.160	247.480	5297.75	-277.02	-1014.84	-2111.39	1670358.51	14346498.46	39°30'24.6735"N	80°53'37.8484"W	2342.62	244.329	1.51	-1.14	-1.89	
5984.00	32.220	247.140	5378.58	-280.34	-1034.10	-2157.43	1670312.48	14346479.22	39°30'24.4837"N	80°53'38.4361"W	2392.46	244.391	1.13	1.12	-0.36	
6078.00	33.520	248.020	5457.53	-283.49	-1053.55	-2204.59	1670266.34	14346459.78	39°30'24.2920"N	80°53'39.0381"W	2443.40	244.457	1.47	1.38	0.94	
6173.00	31.680	246.240	5537.56	-287.03	-1073.42	-2251.76	1670218.20	14346439.91	39°30'24.0962"N	80°53'39.6400"W	2494.52	244.513	2.18	-1.94	-1.87	
6267.00	29.000	250.120	5618.69	-289.52	-1091.11	-2295.79	1670174.19	14346422.22	39°30'23.9218"N	80°53'40.2020"W	2541.88	244.580	3.53	-2.85	4.13	
6330.00	28.040	258.430	5674.06	-287.91	-1099.28	-2324.67	1670145.32	14346414.06	39°30'23.8414"N	80°53'40.5706"W	2571.48	244.692	6.47	-1.52	13.19	
6362.00	28.190	264.350	5702.29	-285.22	-1101.53	-2339.56	1670130.43	14346411.81	39°30'23.8193"N	80°53'40.7607"W	2585.91	244.788	8.73	0.47	18.50	
6393.00	28.320	268.600	5729.60	-281.33	-1102.43	-2354.20	1670115.80	14346410.91	39°30'23.8106"N	80°53'40.9474"W	2599.54	244.907	6.50	0.42	13.71	
6456.00	29.360	274.820	5784.80	-270.68	-1101.66	-2384.54	1670085.47	14346411.79	39°30'23.8196"N	80°53'41.3345"W	2626.68	245.205	4.89	1.65	9.56	
6519.00	29.600	281.310	5839.66	-256.70	-1097.26	-2415.20	1670054.82	14346416.08	39°30'23.8624"N	80°53'41.7256"W	2652.76	245.567	5.24	0.38	10.62	
6583.00	30.250	285.810	5895.13	-239.57	-1089.77	-2446.21	1670023.82	14346423.57	39°30'23.9368"N	80°53'42.1212"W	2677.97	245.987	3.65	1.02	7.03	
6614.00	30.760	289.770	5921.84	-230.18	-1084.96	-2461.19	1670008.85	14346428.38	39°30'23.9846"N	80°53'42.3121"W	2689.72	246.211	6.69	1.65	12.77	
6658.00	31.640	294.220	5959.49	-217.26	-1076.42	-2482.30	1669987.74	14346436.92	39°30'24.0692"N	80°53'42.5814"W	2705.64	246.557	5.61	2.00	10.11	BH AT Curve <8-1/2">(6614')(6658'-18532')
6758.00	35.340	300.620	6042.90	-177.32	-1050.91	-2531.15	1669938.82	14346462.41	39°30'24.3219"N	80°53'43.2042"W	2740.64	247.452	5.11	3.70	6.40	

RECEIVED
Office of Oil and Gas
Environmental Protection
SEP 22 2022

5



Actual Wellpath Report

Possum Unit 1H AWP Proj: 18557'

Page 5 of 11



REFERENCE WELLPATH IDENTIFICATION			
Operator	ANTERO RESOURCES CORPORATION	Well	Possum Unit 1H
Field	Tyler	API	47-095-02640-0000
Facility	Gamehenge East Pad	Wellbore	Possum Unit 1H AWE
Slot	Slot #01		

WELLPATH DATA (221 stations) † = interpolated, ‡ = extrapolated station																
MD (ft)	Inclination (°)	Azimuth (°)	TVD (ft)	Vert Sect (ft)	North (ft)	East (ft)	Grid East (US ft)	Grid North (US ft)	Latitude	Longitude	Closure Dist (ft)	Closure Dir (°)	DLS (°/100ft)	Build Rate (°/100ft)	Turn Rate (°/100ft)	Comments
6854.00	40.540	306.810	6118.61	-128.39	-1018.04	-2560.07	1669890.02	14346495.27	39°30'24.6473"N	80°53'43.8278"W	2773.65	248.467	6.71	5.42	6.45	
6948.00	45.010	314.720	6187.64	-73.31	-976.29	-2628.21	1669841.90	14346537.00	39°30'25.0604"N	80°53'44.4413"W	2803.68	249.622	7.43	4.76	8.41	
7043.00	50.740	318.420	6251.35	-9.23	-925.09	-2676.53	1669793.59	14346588.18	39°30'25.5670"N	80°53'45.0572"W	2831.89	250.933	6.69	6.03	3.89	
7104.00†	55.200	322.081	6288.08	36.27	-887.64	-2707.62	1669762.52	14346625.61	39°30'25.9375"N	80°53'45.4532"W	2849.41	251.849	8.74	7.31	6.00	Middlesex: 7104' MD
7138.00	57.730	323.950	6306.86	63.20	-865.00	-2724.66	1669745.48	14346648.24	39°30'26.1615"N	80°53'45.6703"W	2858.67	252.387	8.74	7.44	5.50	
7232.00	63.420	328.180	6353.04	142.23	-797.08	-2770.26	1669699.90	14346716.14	39°30'26.8333"N	80°53'46.2511"W	2882.65	253.948	7.21	6.05	4.50	
7281.00†	65.577	331.839	6374.14	185.61	-758.78	-2792.35	1669677.82	14346754.43	39°30'27.2121"N	80°53'46.5323"W	2893.61	254.798	8.05	4.40	7.47	Burkett: 7281' MD
7323.00†	67.494	334.875	6390.87	223.78	-724.35	-2809.62	1669660.56	14346788.84	39°30'27.5528"N	80°53'46.7521"W	2901.49	255.543	8.05	4.56	7.23	Tully: 7323' MD
7327.00	67.680	335.160	6392.39	227.46	-720.99	-2811.18	1669659.00	14346792.20	39°30'27.5857"N	80°53'46.7720"W	2902.17	255.615	8.05	4.64	7.12	
7374.00	69.500	338.300	6409.55	271.08	-680.80	-2828.46	1669641.73	14346832.37	39°30'27.9832"N	80°53'46.9918"W	2909.24	256.467	7.33	3.87	6.88	
7415.00†	71.740	340.415	6423.16	309.73	-644.61	-2842.09	1669628.10	14346868.55	39°30'28.3410"N	80°53'47.1652"W	2914.27	257.221	7.32	5.46	5.16	Marcellus POE: 7415' MD
7421.00	72.070	340.720	6425.02	315.44	-639.23	-2843.98	1669626.21	14346873.92	39°30'28.3942"N	80°53'47.1893"W	2914.94	257.332	7.32	5.50	5.08	
7516.00	79.570	343.650	6448.28	407.45	-551.60	-2872.10	1669598.10	14346961.52	39°30'29.2605"N	80°53'47.5468"W	2924.59	259.128	8.44	7.89	3.08	
7609.00	88.490	345.360	6457.95	499.58	-462.56	-2886.78	1669573.44	14347050.52	39°30'30.1409"N	80°53'47.8602"W	2933.47	260.928	9.76	9.59	1.84	
7704.00	90.370	343.130	6458.89	594.53	-371.15	-2922.57	1669547.85	14347141.90	39°30'31.0447"N	80°53'48.1860"W	2946.04	262.763	3.07	1.98	-2.35	
7798.00	90.800	339.660	6457.93	688.51	-282.08	-2952.55	1669517.68	14347230.94	39°30'31.9253"N	80°53'48.5692"W	2965.99	264.543	3.72	0.46	-3.69	
7892.00	90.310	338.340	6457.02	782.44	-194.33	-2986.23	1669484.01	14347318.65	39°30'32.7930"N	80°53'48.9977"W	2992.55	266.277	1.50	-0.52	-1.40	
7987.00	90.310	339.230	6456.51	877.36	-105.77	-3020.61	1669449.65	14347407.18	39°30'33.6686"N	80°53'49.4350"W	3022.46	267.995	0.94	0.00	0.94	
8081.00	90.710	336.570	6455.67	971.19	-18.68	-3055.97	1669414.30	14347494.22	39°30'34.5297"N	80°53'49.8848"W	3056.03	269.650	2.86	0.43	-2.83	
8176.00	90.370	339.210	6454.77	1066.03	69.32	-3001.72	1669378.57	14347582.19	39°30'35.3988"N	80°53'50.3397"W	3092.50	271.284	2.80	-0.36	2.78	
8270.00	90.370	336.430	6454.17	1159.86	156.35	-3127.21	1669343.10	14347669.19	39°30'36.2604"N	80°53'50.7911"W	3131.11	272.862	2.96	0.00	-2.96	
8364.00	90.490	338.760	6453.46	1253.68	243.25	-3163.03	1669307.29	14347756.05	39°30'37.1196"N	80°53'51.2470"W	3172.37	274.398	2.48	0.13	2.48	
8459.00	90.250	343.240	6452.85	1348.65	333.05	-3193.95	1669276.38	14347845.81	39°30'38.0075"N	80°53'51.6402"W	3211.27	275.953	4.72	-0.25	4.72	
8553.00	90.520	348.250	6452.22	1442.31	424.12	-3217.09	1669253.25	14347936.85	39°30'38.9079"N	80°53'51.9341"W	3244.93	277.510	5.34	0.29	5.33	
8647.00	90.370	346.630	6451.49	1535.73	515.87	-3237.83	1669232.82	14348028.56	39°30'39.8149"N	80°53'52.1925"W	3279.37	279.063	1.73	-0.16	-1.72	
8742.00	90.520	345.350	6450.75	1630.39	608.04	-3260.53	1669209.83	14348120.69	39°30'40.7261"N	80°53'52.4856"W	3316.74	280.563	1.36	0.16	-1.35	
8837.00	90.430	343.870	6449.96	1725.21	699.62	-3285.74	1669184.63	14348212.24	39°30'41.6315"N	80°53'52.8059"W	3359.40	282.020	1.56	-0.09	-1.56	
8931.00	90.460	341.470	6449.23	1819.16	789.35	-3313.73	1669156.64	14348301.93	39°30'42.5186"N	80°53'53.1619"W	3406.45	283.398	2.55	0.03	-2.55	
9026.00	90.310	342.420	6448.59	1914.15	879.67	-3343.18	1669127.21	14348392.21	39°30'43.4116"N	80°53'53.5362"W	3456.97	284.742	1.01	-0.16	1.00	
9121.00	80.580	340.080	6447.85	2009.14	969.62	-3373.71	1669096.69	14348482.13	39°30'44.3009"N	80°53'53.9245"W	3510.28	286.035	2.45	0.28	-2.45	



Actual Wellpath Report

Poosum Unit 1H AWP Proj: 18557'
Page 6 of 11



REFERENCE WELLPATH IDENTIFICATION			
Operator	ANTERO RESOURCES CORPORATION	Well	Poosum Unit 1H
Field	Tyler	API	47-095-02640-0000
Facility	Gamehenge East Pad	Wellbore	Poosum Unit 1H AWB
Slot	Slot #01		

WELLPATH DATA (221 stations)																
MD (ft)	Inclination (°)	Azimuth (°)	TVD (ft)	Vert Sect (ft)	North (ft)	East (ft)	Grid East (US ft)	Grid North (US ft)	Latitude	Longitude	Closure Dist (ft)	Closure Dir (°)	DLS (°/100ft)	Build Rate (°/100ft)	Turn Rate (°/100ft)	Comments
9216.00	90.250	340.110	6447.17	2104.12	1058.94	-3406.05	1669064.36	14348571.41	39°30'45.1841"N	80°53'54.3359"W	3566.87	287.270	0.35	-0.35	0.03	
9310.00	90.220	340.700	6446.78	2198.11	1147.49	-3437.58	1669032.85	14348659.93	39°30'46.0597"N	80°53'54.7368"W	3624.04	288.459	0.63	-0.03	0.63	
9404.00	90.430	341.470	6446.25	2292.11	1236.41	-3468.05	1669002.39	14348748.82	39°30'46.9389"N	80°53'55.1243"W	3681.86	289.622	0.85	0.22	0.82	
9498.00	90.220	340.480	6445.71	2386.11	1325.28	-3498.69	1668971.76	14348837.65	39°30'47.8175"N	80°53'55.5140"W	3741.28	290.746	1.08	-0.22	-1.05	
9592.00	90.430	344.160	6445.18	2480.07	1414.82	-3527.23	1668943.23	14348927.15	39°30'48.7028"N	80°53'55.8789"W	3800.41	291.856	3.92	0.22	3.91	
9686.00	90.620	346.150	6444.32	2573.83	1505.67	-3551.31	1668919.16	14349017.97	39°30'49.6010"N	80°53'56.1828"W	3857.32	292.976	2.13	0.20	2.12	
9781.00	90.520	345.260	6443.37	2668.52	1597.73	-3574.77	1668895.71	14349109.99	39°30'50.5110"N	80°53'56.4808"W	3915.57	294.082	0.94	-0.11	-0.94	
9875.00	90.890	344.720	6442.22	2762.29	1688.51	-3599.11	1668871.38	14349200.74	39°30'51.4085"N	80°53'56.7901"W	3975.51	295.133	0.70	0.39	-0.57	
9970.00	90.950	345.750	6440.69	2857.04	1780.36	-3623.32	1668847.18	14349292.55	39°30'52.3166"N	80°53'57.0977"W	4037.10	296.168	1.09	0.06	1.08	
10064.00	91.080	344.940	6439.03	2950.77	1871.29	-3647.10	1668823.41	14349383.44	39°30'53.2155"N	80°53'57.3988"W	4099.15	297.162	0.87	0.14	-0.86	
10159.00	91.230	343.530	6437.11	3045.60	1962.70	-3672.90	1668797.82	14349474.81	39°30'54.1192"N	80°53'57.7277"W	4164.42	298.119	1.49	0.16	-1.48	
10254.00	91.230	340.000	6435.07	3140.56	2052.89	-3702.62	1668767.92	14349564.97	39°30'55.0109"N	80°53'58.1056"W	4233.64	299.006	3.71	0.00	-3.72	
10349.00	90.830	336.910	6433.36	3235.43	2141.23	-3737.49	1668733.05	14349653.27	39°30'55.8844"N	80°53'58.5493"W	4307.40	299.809	3.28	-0.42	-3.25	
10444.00	90.890	336.170	6431.94	3330.12	2228.36	-3775.31	1668695.25	14349740.37	39°30'56.7460"N	80°53'59.0306"W	4383.90	300.551	0.78	0.06	-0.78	
10538.00	90.740	337.560	6430.80	3423.85	2314.79	-3812.24	1668658.34	14349828.77	39°30'57.6008"N	80°53'59.5006"W	4459.98	301.268	1.49	-0.16	1.48	
10633.00	90.860	339.160	6429.27	3518.72	2403.09	-3847.27	1668623.32	14349915.02	39°30'58.4736"N	80°53'59.9463"W	4536.11	301.990	1.69	0.13	1.68	
10728.00	90.920	342.290	6427.80	3613.70	2492.74	-3878.62	1668591.99	14350004.64	39°30'59.3601"N	80°54'0.3451"W	4610.58	302.728	3.29	0.06	3.29	
10823.00	90.830	343.620	6426.35	3708.64	2583.55	-3906.46	1668564.15	14350095.42	39°31'0.2579"N	80°54'0.6990"W	4683.50	303.479	1.40	-0.09	1.40	
10918.00	90.850	344.510	6424.96	3803.50	2674.89	-3932.54	1668538.09	14350186.72	39°31'1.1609"N	80°54'1.0305"W	4756.04	304.223	0.94	0.03	0.94	
11012.00	90.800	341.840	6423.58	3897.42	2764.85	-3958.74	1668510.89	14350276.54	39°31'2.0503"N	80°54'1.3753"W	4829.49	304.924	2.84	-0.06	-2.84	
11107.00	91.080	340.190	6422.03	3992.40	2854.67	-3990.64	1668480.01	14350366.42	39°31'2.9383"N	80°54'1.7694"W	4905.56	305.578	1.76	0.29	-1.74	
11202.00	90.950	340.020	6420.34	4087.37	2943.88	-4022.97	1668447.70	14350455.70	39°31'3.8214"N	80°54'2.1805"W	4985.11	306.196	0.23	-0.14	-0.18	
11296.00	90.890	338.920	6418.83	4181.32	3032.00	-4055.93	1668414.75	14350543.69	39°31'4.6917"N	80°54'2.5999"W	5063.95	306.780	1.17	-0.06	-1.17	
11391.00	90.890	336.400	6417.36	4276.13	3119.85	-4092.03	1668378.66	14350631.50	39°31'5.5604"N	80°54'3.0593"W	5145.70	307.323	2.65	0.00	-2.65	
11485.00	90.830	336.560	6415.95	4369.81	3208.03	-4129.54	1668341.17	14350717.65	39°31'6.4125"N	80°54'3.5367"W	5227.98	307.825	0.19	-0.06	0.17	
11580.00	90.800	336.970	6414.60	4464.53	3293.32	-4167.01	1668303.71	14350804.90	39°31'7.2756"N	80°54'4.0137"W	5311.30	308.320	0.43	-0.03	0.43	
11674.00	90.800	338.060	6413.28	4558.33	3380.16	-4202.96	1668267.78	14350891.71	39°31'8.1343"N	80°54'4.4711"W	5393.55	308.807	1.16	0.00	1.16	
11768.00	90.830	338.920	6411.93	4653.22	3466.54	-4237.79	1668232.96	14350980.05	39°31'9.0081"N	80°54'4.9143"W	5476.28	309.300	0.91	0.03	0.91	
11864.00	90.890	339.040	6410.51	4748.14	3557.21	-4271.86	1668198.90	14351068.88	39°31'9.8848"N	80°54'5.3478"W	5559.00	309.784	0.14	0.06	0.13	
11958.00	90.770	337.940	6409.14	4842.03	3644.65	-4306.32	1668164.45	14351158.09	39°31'10.7494"N	80°54'5.7864"W	5641.62	310.243	1.18	-0.13	-1.17	

RECEIVED
Office of Oil and Gas
SEP 22 2022
NY Department of
Environmental Protection

5



Actual Wellpath Report

Possum Unit 1H AWP Proj: 18557'

Page 7 of 11



REFERENCE WELLPATH IDENTIFICATION			
Operator	ANTERO RESOURCES CORPORATION	Well	Possum Unit 1H
Field	Tyler	API	47-095-02640-0000
Facility	Gamehenge East Pad	Wellbore	Possum Unit 1H AWB
Slot	Slot #01		

WELLPATH DATA (221 stations)																
MD (ft)	Inclination (°)	Azimuth (°)	TVD (ft)	Vert Sect (ft)	North (ft)	East (ft)	Grid East (US ft)	Grid North (US ft)	Latitude	Longitude	Closure Dist (ft)	Closure Dir (°)	DLS (°/100ft)	Build Rate (°/100ft)	Turn Rate (°/100ft)	Comments
12053.00	90.770	339.960	6407.87	4936.95	3733.30	-4340.44	1668130.35	14351244.70	39°31'11.6259"N	80°54'6.2205"W	5725.11	310.699	2.13	0.00	2.13	
12147.00	90.830	340.720	6406.56	5030.93	3821.81	-4372.06	1668098.74	14351333.18	39°31'12.5010"N	80°54'6.6228"W	5806.99	311.158	0.81	0.06	0.81	
12241.00	90.280	338.410	6405.64	5124.89	3909.88	-4404.88	1668065.94	14351421.21	39°31'13.3719"N	80°54'7.0403"W	5889.83	311.593	2.53	-0.59	-2.46	
12336.00	90.340	340.050	6405.13	5219.83	3998.70	-4438.56	1668032.27	14351510.00	39°31'14.2501"N	80°54'7.4689"W	5974.15	312.016	1.73	0.06	1.73	
12430.00	90.490	343.430	6404.45	5313.81	4087.85	-4468.01	1668002.83	14351599.22	39°31'15.1325"N	80°54'7.8434"W	6055.95	312.457	3.60	0.16	3.60	
12525.00	90.490	345.520	6403.64	5408.84	4179.48	-4493.44	1667977.41	14351690.70	39°31'16.0373"N	80°54'8.1666"W	6136.70	312.927	2.20	0.00	2.20	
12619.00	90.430	347.830	6402.88	5502.19	4270.94	-4515.10	1667955.76	14351782.13	39°31'16.9415"N	80°54'8.4418"W	6215.07	313.408	2.46	-0.06	2.46	
12713.00	90.430	349.440	6402.18	5595.37	4363.09	-4533.62	1667937.25	14351874.24	39°31'17.8525"N	80°54'8.6769"W	6292.08	313.902	1.71	0.00	1.71	
12809.00	90.620	345.930	6401.30	5690.72	4456.86	-4554.09	1667916.78	14351967.98	39°31'18.7795"N	80°54'8.9368"W	6372.08	314.382	3.66	0.20	-3.66	
12903.00	90.580	341.960	6400.31	5784.59	4547.17	-4580.08	1667890.80	14352058.25	39°31'19.6723"N	80°54'9.2672"W	6453.99	314.793	4.22	-0.04	-4.22	
12997.00	90.550	337.680	6399.38	5878.53	4635.38	-4612.50	1667858.40	14352146.42	39°31'20.5444"N	80°54'9.6797"W	6539.26	315.142	4.55	-0.03	-4.55	
13091.00	90.430	335.900	6398.56	5972.26	4721.77	-4649.54	1667821.37	14352232.77	39°31'21.3986"N	80°54'10.1512"W	6626.71	315.442	1.90	-0.13	-1.89	
13186.00	90.430	337.680	6397.87	6066.98	4809.07	-4686.98	1667783.95	14352320.04	39°31'22.2618"N	80°54'10.6277"W	6715.28	315.737	1.87	0.00	1.87	
13280.00	90.460	340.710	6397.14	6160.91	4896.93	-4720.36	1667750.58	14352407.87	39°31'23.1305"N	80°54'11.0525"W	6801.60	316.052	3.22	0.03	3.22	
13375.00	90.310	343.140	6396.50	6255.90	4987.23	-4749.84	1667721.12	14352498.13	39°31'24.0233"N	80°54'11.4273"W	6887.19	316.397	2.56	-0.16	2.56	
13470.00	90.460	343.910	6395.86	6350.81	5078.93	-4776.78	1667694.19	14352589.19	39°31'24.9240"N	80°54'11.7699"W	6971.87	316.753	0.83	0.16	0.81	
13564.00	90.430	345.850	6395.13	6444.60	5169.07	-4801.29	1667669.68	14352679.90	39°31'25.8210"N	80°54'12.0815"W	7054.90	317.112	2.06	-0.03	2.06	
13659.00	90.620	345.900	6394.26	6539.27	5261.19	-4824.48	1667646.51	14352771.98	39°31'26.7318"N	80°54'12.3761"W	7138.33	317.479	0.21	0.20	0.05	
13754.00	90.460	346.550	6393.36	6633.89	5353.45	-4847.10	1667623.90	14352864.21	39°31'27.6439"N	80°54'12.6635"W	7221.76	317.842	0.70	-0.17	0.68	
13848.00	90.340	345.870	6392.71	6727.51	5444.74	-4869.50	1667601.50	14352955.46	39°31'28.5463"N	80°54'12.9481"W	7304.61	318.192	0.73	-0.13	-0.72	
13943.00	90.400	342.810	6392.09	6822.35	5536.20	-4895.14	1667575.87	14353046.88	39°31'29.4505"N	80°54'13.2741"W	7389.99	318.517	3.22	0.06	-3.22	
14038.00	90.370	338.830	6391.46	6917.33	5625.91	-4926.35	1667544.68	14353136.55	39°31'30.3375"N	80°54'13.6711"W	7477.95	318.793	4.19	-0.03	-4.19	
14133.00	90.430	336.850	6390.79	7012.17	5713.89	-4962.18	1667508.98	14353224.50	39°31'31.2073"N	80°54'14.1271"W	7567.81	319.028	2.09	0.06	-2.08	
14227.00	90.370	336.230	6390.14	7106.86	5800.11	-4999.60	1667471.46	14353310.89	39°31'32.0599"N	80°54'14.6035"W	7657.50	319.239	0.66	-0.06	-0.66	
14322.00	90.120	335.260	6389.73	7200.44	5886.72	-5038.62	1667432.45	14353397.27	39°31'32.9164"N	80°54'15.1003"W	7748.63	319.439	1.05	-0.26	-1.02	
14416.00	90.150	335.200	6389.51	7293.95	5972.08	-5078.01	1667393.08	14353482.58	39°31'33.7603"N	80°54'15.6018"W	7839.12	319.626	0.07	0.03	-0.06	
14511.00	90.060	335.930	6389.33	7388.50	6058.57	-5117.30	1667353.82	14353569.04	39°31'34.6156"N	80°54'16.1021"W	7930.51	319.814	0.77	-0.09	0.77	
14604.00	90.150	335.700	6389.16	7481.10	6143.40	-5155.40	1667315.71	14353653.84	39°31'35.4544"N	80°54'16.5872"W	8019.95	319.997	0.27	0.10	-0.25	
14698.00	90.430	338.000	6388.69	7574.83	6229.83	-5192.36	1667278.78	14353740.23	39°31'36.3090"N	80°54'17.0576"W	8109.95	320.190	2.46	0.30	2.45	
14793.00	90.280	340.950	6388.10	7669.78	6318.79	-5225.66	1667245.48	14353829.15	39°31'37.1885"N	80°54'17.4814"W	8199.87	320.409	3.11	-0.16	3.11	



Actual Wellpath Report

Possum Unit 1H AWP Proj: 18557'

Page 8 of 11



REFERENCE WELLPATH IDENTIFICATION				
Operator	ANTERO RESOURCES CORPORATION		Well	Possum Unit 1H
Field	Tyler		API	47-095-02640-0000
Facility	Gamehenge East Pad		Wellbore	Possum Unit 1H AWB
Slot	Slot #01			

WELLPATH DATA (221 stations)																
MD (ft)	Inclination (°)	Azimuth (°)	TVD (ft)	Vert Sect (ft)	North (ft)	East (ft)	Grid East (US ft)	Grid North (US ft)	Latitude	Longitude	Closure Dist (ft)	Closure Dir (°)	DLS (°/100ft)	Build Rate (°/100ft)	Turn Rate (°/100ft)	Comments
14887.00	90.490	341.030	6387.47	7763.78	6407.66	-5256.28	1667214.88	14353917.99	39°31'38.0672"N	80°54'17.8709"W	8287.73	320.638	0.24	0.22	0.09	
14982.00	90.520	341.080	6386.63	7858.77	6497.51	-5287.12	1667184.05	14354007.80	39°31'38.9555"N	80°54'18.2633"W	8376.83	320.864	0.06	0.03	0.05	
15075.00	90.520	341.710	6385.79	7951.77	6585.64	-5316.79	1667154.39	14354095.90	39°31'39.8269"N	80°54'18.6408"W	8463.98	321.085	0.68	0.00	0.68	
15170.00	90.460	345.590	6384.97	8046.65	6676.78	-5343.53	1667127.67	14354187.00	39°31'40.7279"N	80°54'18.9807"W	8551.76	321.329	4.08	-0.06	4.08	
15264.00	90.490	343.220	6384.19	8140.49	6767.31	-5368.79	1667102.41	14354277.50	39°31'41.6229"N	80°54'19.3020"W	8638.31	321.574	2.52	0.03	-2.52	
15358.00	90.460	343.060	6383.42	8234.43	6857.27	-5396.06	1667075.16	14354367.42	39°31'42.5123"N	80°54'19.6487"W	8725.80	321.800	0.17	-0.03	-0.17	
15453.00	90.090	343.340	6382.96	8329.36	6948.21	-5423.51	1667047.71	14354458.33	39°31'43.4114"N	80°54'19.9979"W	8814.31	322.026	0.49	-0.39	0.29	
15548.00	90.150	344.730	6382.76	8424.24	7039.54	-5449.64	1667021.59	14354549.62	39°31'44.3143"N	80°54'20.3301"W	8902.46	322.255	1.46	0.06	1.46	
15643.00	90.280	345.470	6382.40	8519.01	7131.35	-5474.07	1666997.17	14354641.39	39°31'45.2219"N	80°54'20.6407"W	8990.08	322.490	0.79	0.14	0.78	
15737.00	90.180	344.630	6382.03	8612.79	7222.16	-5498.32	1666972.93	14354732.17	39°31'46.1197"N	80°54'20.9469"W	9076.96	322.718	0.90	-0.11	-0.89	
15832.00	90.120	340.570	6381.78	8707.73	7312.80	-5526.72	1666944.54	14354822.77	39°31'47.0158"N	80°54'21.3102"W	9166.33	322.919	4.27	-0.06	-4.27	
15928.00	90.150	339.100	6381.55	8803.71	7402.91	-5559.82	1666911.46	14354912.84	39°31'47.9067"N	80°54'21.7313"W	9258.22	323.092	1.53	0.03	-1.53	
16022.00	90.150	340.300	6381.31	8897.68	7491.07	-5592.43	1666878.87	14355000.97	39°31'48.7784"N	80°54'22.1463"W	9348.34	323.257	1.28	0.00	1.28	
16117.00	90.280	341.330	6380.95	8992.67	7580.79	-5623.64	1666847.66	14355090.65	39°31'49.6655"N	80°54'22.5436"W	9438.95	323.431	1.09	0.14	1.08	
16211.00	90.280	341.660	6380.49	9086.67	7669.93	-5653.48	1666817.84	14355179.76	39°31'50.5467"N	80°54'22.9231"W	9528.36	323.606	0.35	0.00	0.35	
16306.00	90.180	339.510	6380.11	9181.66	7759.52	-5685.06	1666786.27	14355269.31	39°31'51.4325"N	80°54'23.3249"W	9619.25	323.771	2.27	-0.11	-2.26	
16401.00	90.220	338.040	6379.78	9276.58	7848.08	-5719.45	1666751.90	14355357.83	39°31'52.3081"N	80°54'23.7627"W	9711.04	323.917	1.55	0.04	-1.55	
16495.00	89.970	338.630	6379.62	9370.47	7935.44	-5754.15	1666717.21	14355445.15	39°31'53.1718"N	80°54'24.2044"W	9802.11	324.053	0.68	-0.27	0.63	
16590.00	90.180	335.140	6379.50	9465.19	8022.80	-5791.44	1666679.93	14355532.48	39°31'54.0356"N	80°54'24.6792"W	9894.75	324.176	3.68	0.22	-3.67	
16685.00	90.030	336.840	6379.32	9559.81	8109.57	-5830.09	1666641.29	14355619.22	39°31'54.8937"N	80°54'25.1713"W	9987.75	324.287	1.80	-0.16	1.79	
16779.00	90.250	340.760	6379.09	9653.71	8197.19	-5864.08	1666607.32	14355706.81	39°31'55.7600"N	80°54'25.6039"W	10078.76	324.421	4.18	0.23	4.17	
16874.00	90.250	343.000	6378.68	9748.70	8287.47	-5893.62	1666577.79	14355797.05	39°31'56.6526"N	80°54'25.9798"W	10169.42	324.582	2.36	0.00	2.36	
16969.00	90.310	345.320	6378.21	9843.55	8378.86	-5919.55	1666551.87	14355888.40	39°31'57.5560"N	80°54'26.3095"W	10258.97	324.759	2.44	0.06	2.44	
17064.00	90.090	343.400	6377.88	9938.40	8470.34	-5945.16	1666526.27	14355979.84	39°31'58.4604"N	80°54'26.6352"W	10348.50	324.936	2.03	-0.23	-2.02	
17159.00	90.120	341.890	6377.71	10033.36	8561.01	-5973.50	1666497.95	14356070.48	39°31'59.3568"N	80°54'26.9956"W	10439.04	325.094	1.59	0.03	-1.59	
17255.00	90.150	339.960	6377.48	10129.36	8651.73	-6004.87	1666466.59	14356161.17	39°32'0.2538"N	80°54'27.3948"W	10531.43	325.237	2.01	0.03	-2.01	
17350.00	90.060	338.580	6377.31	10224.30	8740.58	-6038.49	1666432.98	14356249.98	39°32'1.1322"N	80°54'27.8228"W	10623.61	325.361	1.46	-0.09	-1.45	
17445.00	90.090	339.760	6377.18	10319.25	8829.37	-6072.28	1666399.21	14356338.73	39°32'2.0101"N	80°54'28.2528"W	10715.89	325.482	1.24	0.03	1.24	
17541.00	90.150	342.010	6376.98	10415.24	8920.07	-6103.71	1666367.79	14356429.40	39°32'2.9069"N	80°54'28.6528"W	10808.47	325.617	2.34	0.06	2.34	
17637.00	90.220	344.000	6376.67	10511.18	9011.87	-6131.77	1666339.74	14356521.16	39°32'3.8144"N	80°54'29.0097"W	10900.11	325.768	2.07	0.07	2.07	

RECEIVED
 Office of Oil and Gas
 Environmental Protection
 MW Department of
 SEP 22 2022

SM



Actual Wellpath Report

Possum Unit 1H AWP Proj: 18557'
Page 9 of 11



REFERENCE WELLPATH IDENTIFICATION			
Operator	ANTERO RESOURCES CORPORATION	Well	Possum Unit 1H
Field	Tyler	API	47-095-02640-0000
Facility	Gamehenge East Pad	Wellbore	Possum Unit 1H AWB
Slot	Slot #01		

WELLPATH DATA (221 stations) † = interpolated, ‡ = extrapolated station																
MD (ft)	Inclination (°)	Azimuth (°)	TVD (ft)	Vert Sect (ft)	North (ft)	East (ft)	Grid East (US ft)	Grid North (US ft)	Latitude	Longitude	Closure Dist (ft)	Closure Dir (°)	DLS (°/100ft)	Build Rate (°/100ft)	Turn Rate (°/100ft)	Comments
17732.00	90.310	345.090	6376.23	10606.01	9103.44	-6157.08	1666314.43	14356612.69	39°32'4.7196"N	80°54'29.3316"W	10990.10	325.928	1.15	0.09	1.15	
17827.00	90.120	346.690	6375.88	10700.68	9195.57	-6180.24	1666291.29	14356704.78	39°32'5.6304"N	80°54'29.6260"W	11079.43	326.095	1.70	-0.20	-1.68	
17921.00	90.180	349.100	6375.63	10794.01	9287.47	-6199.95	1666271.58	14356796.65	39°32'6.5389"N	80°54'29.8764"W	11166.76	326.274	2.56	0.06	2.56	
18016.00	90.280	346.880	6375.25	10888.32	9380.38	-6219.72	1666251.82	14356889.52	39°32'7.4574"N	80°54'30.1275"W	11255.07	326.453	2.34	0.11	-2.34	
18111.00	90.090	342.910	6374.94	10983.10	9472.08	-6244.47	1666227.08	14356981.19	39°32'8.3640"N	80°54'30.4422"W	11345.21	326.605	4.18	-0.20	-4.18	
18206.00	90.370	342.380	6374.56	11078.06	9562.76	-6272.81	1666198.76	14357071.82	39°32'9.2604"N	80°54'30.8027"W	11436.54	326.737	0.63	0.29	-0.56	
18301.00	90.460	341.120	6373.87	11173.05	9652.97	-6302.56	1666169.02	14357162.00	39°32'10.1523"N	80°54'31.1812"W	11528.32	326.859	1.33	0.09	-1.33	
18396.00	90.250	338.820	6373.28	11268.03	9742.22	-6335.09	1666136.50	14357251.21	39°32'11.0347"N	80°54'31.5953"W	11620.85	326.965	2.43	-0.22	-2.42	
18491.00	90.220	336.270	6372.89	11362.83	9830.01	-6371.37	1666100.23	14357338.97	39°32'11.9027"N	80°54'32.0573"W	11714.24	327.050	2.68	-0.03	-2.68	
18582.00	90.180	334.740	6372.75	11403.64	9867.32	-6388.37	1666083.24	14357376.28	39°32'12.2716"N	80°54'32.2738"W	11754.80	327.080	3.73	-0.10	-3.73	
18557.00‡	90.180	334.740	6372.67	11428.48	9889.93	-6399.04	1666072.57	14357398.86	39°32'12.4952"N	80°54'32.4096"W	11779.57	327.096	0.00	0.00	0.00	Projected MD at TD: 18557'

HOLE & CASING SECTIONS - Ref Wellbore: Possum Unit 1H AWB Ref Wellpath: Possum Unit 1H AWP Proj: 18557'									
String/Diameter	Start MD (ft)	End MD (ft)	Interval (ft)	Start TVD (ft)	End TVD (ft)	Start N/S (ft)	Start E/W (ft)	End N/S (ft)	End E/W (ft)
20in Conductor	30.00	110.00	80.00	30.00	110.00	0.00	0.00	0.20	-0.41
17.5in Open Hole	110.00	478.00	368.00	110.00	477.99	0.20	-0.41	1.35	-2.56
13.375in Casing Surface	30.00	478.00	448.00	30.00	477.99	0.00	0.00	1.35	-2.56
12.25in Open Hole	478.00	2745.00	2267.00	477.99	2591.77	1.35	-2.56	-404.56	-639.00
9.625in Casing Intermediate	30.00	2745.00	2715.00	30.00	2591.77	0.00	0.00	-404.56	-639.00
8.75in Open Hole	2745.00	6689.00	3944.00	2591.77	5985.72	-404.56	-639.00	-1069.36	-2497.23
8.5in Open Hole	8889.00	18557.00	11868.00	5985.72	6372.67	-1069.36	-2497.23	9889.93	-6399.04
5.5in Casing Production	30.00	18557.00	18527.00	30.00	6372.67	0.00	0.00	9889.93	-6399.04



Actual Wellpath Report

Possum Unit 1H AWP Proj: 18557'

Page 10 of 11



REFERENCE WELLPATH IDENTIFICATION			
Operator	ANTERO RESOURCES CORPORATION	Well	Possum Unit 1H
Field	Tyler	API	47-095-02640-0000
Facility	Gamehenge East Pad	Wellbore	Possum Unit 1H AWB
Slot	Slot #01		

TARGETS								
Name	TVD [ft]	North [ft]	East [ft]	Grid East [US ft]	Grid North [US ft]	Latitude	Longitude	Shape
Possum Unit 1H - POE - Rev-3	6428.00	-629.87	-2830.12	1669640.07	14346883.28	39°30'28.4865"N	80°53'47.0123"W	point
Possum Unit 1H - BHL - Rev-4	6463.00	9880.42	-6425.23	1666046.40	14357389.36	39°32'12.4015"N	80°54'32.7440"W	point
Possum Unit 1H - LP - Rev-3	6463.00	-420.62	-2901.69	1669568.52	14347092.45	39°30'30.5554"N	80°53'47.9224"W	point
Possum Unit 1H - 50' L/R Hardline	6500.00	4625.27	-4627.67	1667843.24	14352136.32	39°31'20.4447"N	80°54'9.8734"W	rectangle
2D Rectangle 11111.8 x 100.								

WELLPATH COMPOSITION - Ref Wellbore: Possum Unit 1H AWB Ref Wellpath: Possum Unit 1H AWP Proj: 18557'					
Start MD [ft]	End MD [ft]	Positional Uncertainty Model	Log Name/Comment	Wellbore	Survey Date
30.00	485.00	Gyrodata 2015 - GC+WVR+DPIPE	01 Gyrodata MS Gyro <17-1/2">(100'-470')	Possum Unit 1H AWB	1/3/2020
485.00	2662.00	OWSG MWD rev2 + HRGM	02 WFT EM <12-1/4">(470')(586'-2647')	Possum Unit 1H AWB	1/3/2020
2662.00	6614.00	OWSG MWD rev2 + HRGM	03 WFT EM <8-3/4">(2647')(2775'-6599')	Possum Unit 1H AWB	1/3/2020
6614.00	18557.00	BH AutoTrak Curve (2019) (Short spacing)	04 BH AT Curve <8-1/2">(6614')(6658'-18532')	Possum Unit 1H AWB	1/30/2020

RECEIVED
 Office of Oil and Gas
 SEP 22 2022
 WV Department of
 Environmental Protection

SM



Actual Wellpath Report

Possum Unit 1H AWP Proj: 18557'

Page 11 of 11



REFERENCE WELLPATH IDENTIFICATION

Operator	ANTERO RESOURCES CORPORATION	Well	Possum Unit 1H
Field	Tyler	API	47-095-02640-0000
Facility	Gamehenge East Pad	Wellbore	Possum Unit 1H AWB
Slot	Slot #01		

COMMENTS

Wellpath general comments

API: 47-095-02640-0000

BHI Job #: 110238614A

Rig: H&P 519

Duration: 02/03/2020-02/05/2020

Gyrodatta MS Gyro <17-1/2">(100'-470')

WFT EM <12-1/4">(470')(586'-2647')

WFT EM <8-3/4">(2647')(2775'-6599')

BH AT Curve <8-1/2">(6614')(6658'-18532')

Middlesex: 7104' MD

Burkett: 7281' MD

Tully: 7323' MD

Marcellus POE: 7415' MD

Projected MD at TD: 18557'