

**Antero Resources
Well No. Reba Unit 3H
BHL MOD
Antero Resources Corporation**

Notes:
Well No. Reba Unit 3H
UTM Zone 17, NAD 1927
Top Hole Coordinates
N: 14,347,215.88'
E: 1,671,958.85'
Point of Entry Coordinates
N: 14,348,035.32'
E: 1,673,881.06'
Bottom Hole Coordinates
N: 14,340,359.30'
E: 1,676,548.83'

Legend

- Proposed gas well
- Monument, as noted
- Existing Well, as noted
- Digitized Well, as noted
- Creek or Drain
- Surface boundary (approx.)
- Interior surface tracts (approx.)

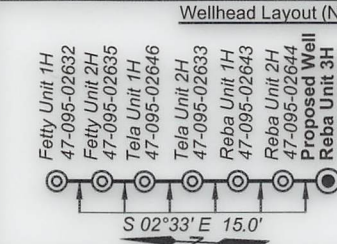

ID	TM/Par	Owner	Bk/Pg	Acres
1	14/27	Ridgetop Capital LP	372/299	64.96
2	14/26	Turner	398/670	26.34
3	15/37	Mendenhall & Davis	444/531	154.17
4	15/18	Turner	398/670	26.18
5	15/19	Mendenhall, et al	282/723	45.00
6	15/17	Mendenhall, et al	288/662	85.71
7	15/23	Mendenhall, et al	326/13	97.25
8	15/22	MacNaughtan	366/289	99.56
9	15/20	Folger	WB 37/622	21.60
10	14/60.2	Long	333/872	24.47
11	14/61	Folger	396/506	4.00
12	15/21.2	Long	287/267	1.79
13	15/21.4	Long	WB 32/551	9.00
14	14/92	White	369/389	1.58
15	15/21.5	Long	WB 32/551	44.55
16	15/24	Fruner	300/342	97.50
17	21/2	Baker	WB 36/545	130.45
18	15/21.1	Baker	WB 36/545	72.00
19	21/1.1	Fritz	357/660	134.28
20	21/1	Pierce	394/517	55.72
21	21/2.1	Baker	233/258	34.55
22	21/3	Copper	287/390	60.46
23	21/20	Conaway	WB 17/354	95.50
24	21/23	Robinson	138/390	72.75
25	21/25.4	Eastham	287/69	44.57
26	21/25	Eastham	330/726	11.47
27	21/27	Leasure & Gilmore	207/260	40.00
28	21/25.3	Davis	356/431	5.465
29	21/25.1	Travis	358/522	2.81
30	21/25.2	Stewart	312/305	2.717
31	21/24	Spencer	270/198	2.25
32	21/43	Crumrine	WB 17/655	231.04
33	21/22	4H Camp	118/239	8.00

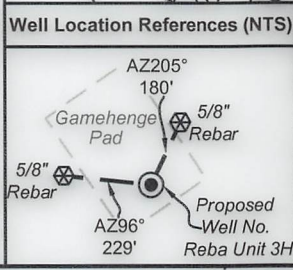

Notes:
West Virginia Coordinate System of 1927, North Zone
based upon Differential GPS Measurements.
Well No. Reba Unit 3H Top Hole coordinates are
N: 370,458.77' Latitude: 39°30'31.75"
E: 1,608,341.76' Longitude: 80°53'17.41"
Bottom Hole coordinates are
N: 363,524.16' Latitude: 39°29'23.89"
E: 1,612,818.17' Longitude: 80°52'18.95"
UTM Zone 17, NAD 1983
Top Hole Coordinates Bottom Hole Coordinates
N: 4,373,257.841m N: 4,371,167.978m
E: 509,628.565m E: 511,027.557m
Plat orientation and corner and well references are based upon the grid north meridian.
Well location references are based upon the magnetic meridian.



	Bearing	Dist.
L1	N 28°47' W	1,298.0'
L2	N 57°22' E	2,138.4'
L3	S 45°38' E	1,804.5'
L4	S 01°31' W	1,253.3'
L5	N 67°52' E	2,090.3'

Lease

- A Naomi V. Beagle
- B Jack Russell Folger, et ux
- C Linda L. Newbrough
- D Douglas H. Long, et ux
- E Andrew Hrynczyn
- F Blackrock Enterprises
- G Gia Pastors
- H Lisa Ann Gilmore, et vir
- I Cathy J. Eastham
- J Gary R. Davis
- K Joseph Travis, et ux
- L Harley G. & Connie L. Stewart
- M Gary N. & Christine L. Spencer

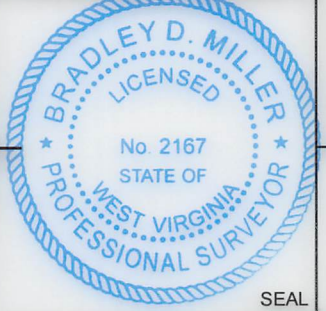

I, the undersigned, hereby certify that this plat is correct to the best of my knowledge and belief and shows all the information required by law and the rules issued and prescribed by the Department of Environmental Protection.

Bradley D. Miller
Bradley D. Miller, P.S. 2167

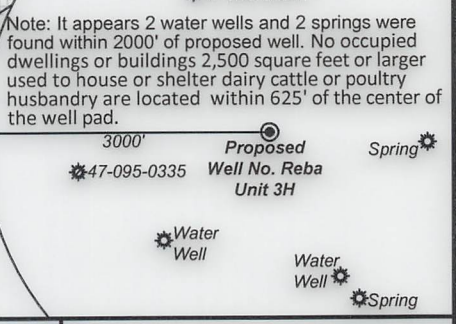

FILE NO: 40-54-E-16
DRAWING NO: Reba 3H Well Plat
SCALE: 1" = 1500'
MINIMUM DEGREE OF ACCURACY: Submeter
PROVEN SOURCE OF ELEVATION: WVDOT, Harrisville, WV

STATE OF WEST VIRGINIA
DEPARTMENT OF ENVIRONMENTAL PROTECTION
OIL AND GAS DIVISION

DATE: October 30 2019
OPERATOR'S WELL NO. Reba Unit 3H
API WELL NO
47 - 095 - 02645
STATE COUNTY PERMIT

WELL TYPE: OIL GAS LIQUID INJECTION WASTE DISPOSAL
(IF GAS) PRODUCTION: STORAGE DEEP SHALLOW
Proposed 1026'

LOCATION: ELEVATION: Existing 1052' WATERSHED: Outlet Middle Island Creek QUADRANGLE: Btm - Shirley
DISTRICT: Ellsworth COUNTY: Tyler

SURFACE OWNER: Ridgetop Capital LP Jeffery A. & Debra J. Baker; Antero Resources Corporation; Piney Holdings, Inc.; Donald MacNaughtan, Jr.; ACREAGE: 64.96
ROYALTY OWNER: Naomi V. Beagle; Linda L. Newbrough; Darla S. Colombo; Donald K. Baker LEASE NO: ACREAGE: 62.84375; 64.18

PROPOSED WORK: DRILL CONVERT DRILL DEEPER FRACTURE OR STIMULATE PLUG OFF OLD FORMATION
 PERFORATE NEW FORMATION OTHER PHYSICAL CHANGE IN WELL (SPECIFY) BHL MOD ESTIMATED DEPTH: 17,700' MD
 PLUG AND ABANDON CLEAN OUT AND REPLUG TARGET FORMATION: Marcellus Shale ESTIMATED DEPTH: 7,000' TVD

WELL OPERATOR: Antero Resources Corporation DESIGNATED AGENT: Dianna Stamper - CT Corporation System
ADDRESS: 1615 Wynkoop Street ADDRESS: 5400 D Big Tyler Road
Denver, CO 80202 Charleston, WV 25313