

LATITUDE 39°25'00"

10,800'

LATITUDE 39°22'30" 7,895' TO BOTTOM HOLE

1,074' TO BOTTOM HOLE

4,990'

LONGITUDE 80°45'00"

LONGITUDE 80°45'00"

Antero Resources Corporation  
Well No. Stampede Unit 3H

AS DRILLED DATA:  
WELL 3H TOP HOLE INFORMATION:  
N: 331,489ft E: 1,635,986ft  
LAT: 39°24'10.68" LON: 80°47'17.59"  
BOTTOM HOLE INFORMATION:  
N: 320,189ft E: 1,638,735ft  
LAT: 39°22'19.40" LON: 80°46'40.54"  
WEST VIRGINIA COORDINATE SYSTEM OF 1927 NORTH ZONE. ZONE WAS DERIVED FROM MEASUREMENTS TAKEN WITH TRIMBLE GEOXT SUBMETER MAPPING GRADE GPS UNIT. PLAT ORIENTATION, CORNER, AND WELL REFERENCE TIE LINES ARE BASED ON GRID NORTH.

(NAD) 83 (UTM) ZONE 17 COORDS:  
WELL 3H TOP HOLE INFORMATION:  
N: 4,361,526m E: 518,249m  
BOTTOM HOLE INFORMATION:  
N: 4,358,098m E: 519,144m

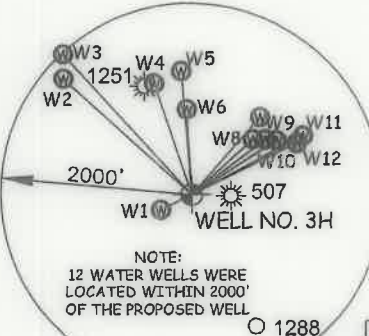
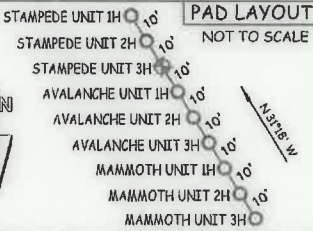

NOTE:  
12 WATER WELLS WERE LOCATED WITHIN 2000' OF THE PROPOSED WELL

W1	S 63°23' W	359.2'
W2	N 47°45' W	1801.9'
W3	N 42°23' W	1983.8'
W4	N 18°18' W	1224.0'
W5	N 04°30' W	1295.6'
W6	N 02°57' W	893.2'
W7	N 41°39' E	1085.6'
W8	N 48°02' E	866.0'
W9	N 53°22' E	966.3'
W10	N 57°24' E	1057.5'
W11	N 62°09' E	1320.5'
W12	N 63°56' E	1228.5'

McElroy District - Tyler County	
TM-Par	Surface Owner
16-08	June Griffin
16-8.1	Roger Griffin
16-8.2	Roger Griffin
16-16	Harry Vanna
16-17	Charles Straight
16-17.3	Charles Kimball
16-18	Albert Bebee
16-19	Todd Orr
19-02	Antero Resources Corp.
19-03	Larry Stevens
19-04	John Owens
19-05	Paul Weekley
19-06	Paul Weekley
19-07	Patricia Montgomery
19-08	John Lewis Jr.
19-09	Robert Walsh
19-10	Judith Malloy
19-27	Harvey Burns
19-42	Anna Barola
19-45	Terrence Fraser
19-46	Terrence Fraser
19-47	Ronnie Wilson Jr.
19-48	Lloyd Talkington
19-50	Ronald Cumberland
19-51	Randall Anderson
19-52	Harold Yost
19-53.1	Larry Marable
19-61	Kenneth Mason
19-63	Jacqueline Wichman Trust
19-64	Kenneth Mason
19-64.1	Michael Kimball
19-65	Bobby Griffin
19-66	Matthew March
19-67	Smith Morris Trust
19-68	Randall Clugston
19-69	Randall Clugston
19-70	Ronald Cumberland
19-73	Dena Pratt
19-74	Randall Clugston
22-04	Jacqueline Wichman Trust
22-05	William Middleton
22-06	Thomas Allen
22-07	Thomas Allen
22-08	George Kithau
22-10	Thomas Allen
22-12	Terry Dotson
22-12.1	Margaret Dotson
22-13	Warren Putnam
22-13.1	Jacqueline Wichman
01-01	Grant District - Doddridge County
01-01	Steven Reed
04-01	Warren Putnam

I THE UNDERSIGNED, HEREBY CERTIFY THAT THIS PLAT IS CORRECT TO THE BEST OF MY KNOWLEDGE AND BELIEF AND SHOWS ALL THE INFORMATION REQUIRED BY LAW AND THE RULES ISSUED AND PERSCRIBED BY THE DEPARTMENT OF ENVIRONMENTAL PROTECTION.



STATE OF WEST VIRGINIA, DIVISION OF ENVIRONMENTAL PROTECTION, OFFICE OF OIL AND GAS  
WILLOW LAND SURVEYING PLLC  
220 MASONIC AVE. PENNSBORO WEST VIRGINIA 26415

JOB # 19-001WA  
DRAWING # STAMPEDE3HAD  
SCALE 1" = 2000'  
MINIMUM DEGREE OF ACCURACY SUBMETER  
PROVEN SOURCE OF ELEV. SUBMETER MAPPING GRADE GPS  
STATE OF WEST VIRGINIA DEPARTMENT OF ENERGY DIVISION OF OIL AND GAS

LEGEND  
--- Surface Owner Boundary Lines +/-  
--- Interior Surface Tracts +/-  
o Proposed Well Path  
o As Drilled Well Path  
DOUGLAS R. ROWE P.S. 2202  
DATE 09/03/20  
OPERATOR'S WELL# STAMPEDE UNIT #3H

NOTE  
1. NO OCCUPIED DWELLINGS OR BUILDINGS TWO THOUSAND FIVE HUNDRED (2,500) SQUARE FEET OR LARGER USED TO HOUSE OR SHELTER DAIRY CATTLE OR POULTRY HUSBANDRY ARE LOCATED WITHIN SIX HUNDRED TWENTY-FIVE (625) FEET OF THE CENTER OF THE WELL PAD.  
2. TOP HOLE DATA SHOWN HEREON WAS PROVIDED BY ANTERO RESOURCES CORPORATION.  
3. AS DRILLED DATA WAS PROVIDED BY ANTERO RESOURCES CORPORATION.  
4. WLS IS NOT CERTIFYING THE DATA AND INFORMATION PROVIDED LISTED IN NOTES 2 AND 3, ONLY THE RELATIONSHIP TO THE DATA AND INFORMATION PROVIDED TO THE LEASE BOUNDARIES.  
5. WLS IS BY NO MEANS RESPONSIBLE FOR ANY ERRORS OR INACCURACIES WITH THE DATA AND INFORMATION THAT HAS BEEN PROVIDED.

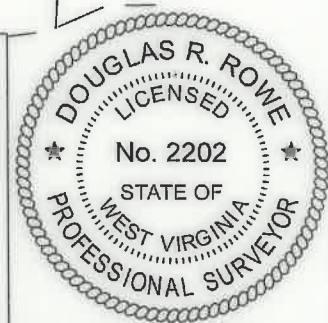

WELL TYPE: OIL    GAS X LIQUID INJECTION    WASTE DISPOSAL    47 - 095 - 02647  
(IF "GAS") PRODUCTION X STORAGE    DEEP    SHALLOW X STATE COUNTY PERMIT  
LOCATION: ELEVATION 743' - AS BUILT WATERSHED McELROY CREEK  
QUADRANGLE TH-SHIRLEY 7.5' BH - WEST UNION 7.5' DISTRICT McELROY COUNTY TYLER  
SURFACE OWNER ANTERO RESOURCES CORPORATION ACREAGE 127.86 ACRES +/-  
OIL & GAS ROYALTY OWNER B.F. REED ET UX; KENNETH ORR ET AL; VICTOR I. KESTOR ET AL; LEASE ACREAGE 130 AC.±; 85 AC.±; 50 AC.±;  
KENNETH ORR ET AL; FANNY D. DAVIS ET AL; ENID McCULLOUGH ET VIR; 70 AC.±; 74 AC.±; 103 AC.±;  
W.S. WRIGHT ET AL; CATHERINE DOTSON 73 AC.±; 157.75 AC.±

PROPOSED WORK: DRILL    CONVERT    DRILL DEEPER    REDRILL    FRACTURE OR STIMULATE     
PLUG OFF OLD FORMATION    PERFORATE NEW FORMATION    OTHER PHYSICAL CHANGE IN WELL     
(SPECIFY) AS DRILLED PLUG & ABANDON CLEAN OUT & REPLUG  
TARGET FORMATION MARCELLUS ESTIMATED DEPTH 6.425' TVD 18.390' MD  
WELL OPERATOR ANTERO RESOURCES CORP. DESIGNATED AGENT DIANNA STAMPER - CT CORPORATION SYSTEM  
ADDRESS 1615 WYNKOOP ST. ADDRESS 5400 D BIG TYLER ROAD  
FORM WW-6 DENVER, CO 80202 CHARLESTON, WV 25313

COUNTY NAME PERMIT

LATITUDE 39°25'00"

10,800'

LATITUDE 39°22'30" 7,895' TO BOTTOM HOLE

Antero Resources Corporation Well No. Stampede Unit 3H

AS DRILLED DATA: WELL 3H TOP HOLE INFORMATION: N: 331,489ft E: 1,635,986ft LAT: 39°24'10.68" LON: 80°47'17.59" BOTTOM HOLE INFORMATION: N: 320,189ft E: 1,638,735ft LAT: 39°22'19.40" LON: 80°46'40.54" WEST VIRGINIA COORDINATE SYSTEM OF 1927 NORTH ZONE. ZONE WAS DERIVED FROM MEASUREMENTS TAKEN WITH TRIMBLE GEOXT SUBMETER MAPPING GRADE GPS UNIT. PLAT ORIENTATION, CORNER, AND WELL REFERENCE TIE LINES ARE BASED ON GRID NORTH.

(NAD) 83 (UTM) ZONE 17 COORDS: WELL 3H TOP HOLE INFORMATION: N: 4,361,526m E: 518,249m BOTTOM HOLE INFORMATION: N: 4,358,098m E: 519,144m

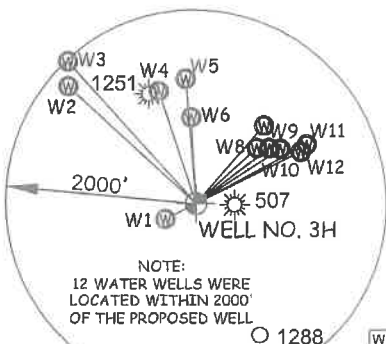
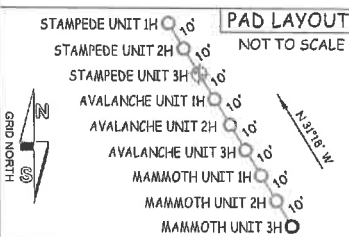

NOTE: 12 WATER WELLS WERE LOCATED WITHIN 2000' OF THE PROPOSED WELL

Table with 4 columns: Well ID, Northing, Easting, and Distance. Lists wells W1 through W12 with their coordinates and distances from the proposed well.

I, THE UNDERSIGNED, HEREBY CERTIFY THAT THIS PLAT IS CORRECT TO THE BEST OF MY KNOWLEDGE AND BELIEF AND SHOWS ALL THE INFORMATION REQUIRED BY LAW AND THE RULES ISSUED AND PERSCRIBED BY THE DEPARTMENT OF ENVIRONMENTAL PROTECTION.



STATE OF WEST VIRGINIA, DIVISION OF ENVIRONMENTAL PROTECTION, OFFICE OF OIL AND GAS

WILLOW LAND SURVEYING PLLC 220 MASONIC AVE. PENNSBORO WEST VIRGINIA 26415

JOB # 19-001WA DRAWING # STAMPEDE3HAD SCALE 1" = 2000' MINIMUM DEGREE OF ACCURACY SUBMETER PROVEN SOURCE OF ELEV. SUBMETER MAPPING GRADE GPS

LEGEND: Surface Owner Boundary Lines +/- Interior Surface Tracts +/- Proposed Well Path As Drilled Well Path

DATE 09/03/20 OPERATOR'S WELL# STAMPEDE UNIT #3H

NOTE: 1. NO OCCUPIED DWELLINGS OR BUILDINGS TWO THOUSAND FIVE HUNDRED (2,500) SQUARE FEET OR LARGER USED TO HOUSE OR SHELTER DAIRY CATTLE OR POULTRY HUSBANDRY ARE LOCATED WITHIN SIX HUNDRED TWENTY-FIVE (625) FEET OF THE CENTER OF THE WELL PAD. 2. TOP HOLE DATA SHOWN HEREON WAS PROVIDED BY ANTERO RESOURCES CORPORATION. 3. AS DRILLED DATA WAS PROVIDED BY ANTERO RESOURCES CORPORATION. 4. WLS IS NOT CERTIFYING THE DATA AND INFORMATION PROVIDED LISTED IN NOTES 2 AND 3, ONLY THE RELATIONSHIP TO THE DATA AND INFORMATION PROVIDED TO THE LEASE BOUNDARIES. 5. WLS IS BY NO MEANS RESPONSIBLE FOR ANY ERRORS OR INACCURACIES WITH THE DATA AND INFORMATION THAT HAS BEEN PROVIDED.

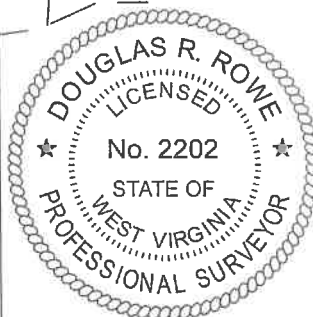

WELL TYPE: OIL GAS X LIQUID INJECTION WASTE DISPOSAL 47 095 02647 (IF "GAS") PRODUCTION X STORAGE DEEP SHALLOW X LOCATION: ELEVATION 743' - AS BUILT WATERSHED McELROY CREEK QUADRANGLE TH - SHIRLEY 7.5' BH - WEST UNION 7.5' DISTRICT McELROY COUNTY TYLER

SURFACE OWNER ANTERO RESOURCES CORPORATION ACREAGE 127.86 ACRES +/- OIL & GAS ROYALTY OWNER B.F. REED ET UX; KENNETH ORR ET AL; VICTOR I. KESTOR ET AL; KENNETH ORR ET AL; FANNY D. DAVIS ET AL; ENID McCULLOUGH ET VIR; W.S. WRIGHT ET AL; CATHERINE DOTSON LEASE ACREAGE 130 AC.± 85 AC.± 50 AC.± 70 AC.± 74 AC.± 103 AC.± 73 AC.± 157.75 AC.±

PROPOSED WORK: DRILL CONVERT DRILL DEEPER REDRILL FRACTURE OR STIMULATE PLUG OFF OLD FORMATION PERFORATE NEW FORMATION OTHER PHYSICAL CHANGE IN WELL (SPECIFY) AS DRILLED PLUG & ABANDON CLEAN OUT & REPLUG TARGET FORMATION MARCELLUS ESTIMATED DEPTH 6,425' TVD 18,390' MD WELL OPERATOR ANTERO RESOURCES CORP. DESIGNATED AGENT DIANNA STAMPER - CT CORPORATION SYSTEM ADDRESS 1615 WYNKOOP ST. ADDRESS 5400 D BIG TYLER ROAD DENVER, CO 80202 CHARLESTON, WV 25313

McElroy District - Tyler County. Table listing well numbers, surface owners, and lease information for various wells in the area.

1,074' TO BOTTOM HOLE LONGITUDE 80°45'00"

COUNTY NAME PERMIT