

WW-7
8-30-06



West Virginia Department of Environmental Protection
Office of Oil and Gas
WELL LOCATION FORM: GPS

API: 4709502648-00 WELL NO.: SHR37IHSM

FARM NAME: _____

RESPONSIBLE PARTY NAME: CNX Gas Company

COUNTY: Tyler DISTRICT: Centerville

QUADRANGLE: West Union

SURFACE OWNER: Robert Bruce Ash

ROYALTY OWNER: _____

UTM GPS NORTHING: 4355993.93

UTM GPS EASTING: 513310.94 GPS ELEVATION: 1011 ft

The Responsible Party named above has chosen to submit GPS coordinates in lieu of preparing a new well location plat for a plugging permit or assigned API number on the above well. The Office of Oil and Gas will not accept GPS coordinates that do not meet the following requirements:

1. Datum: NAD 1983, Zone: 17 North, Coordinate Units: meters, Altitude: height above mean sea level (MSL) – meters.
2. Accuracy to Datum – 3.05 meters
3. Data Collection Method:

Survey grade GPS _____: Post Processed Differential _____
Real-Time Differential _____

Mapping Grade GPS X: Post Processed Differential X
Real-Time Differential _____

RECEIVED
Office of Oil and Gas
JAN 16 2020
WV Department of
Environmental Protection

4. **Letter size copy of the topography map showing the well location.**

I the undersigned, hereby certify this data is correct to the best of my knowledge and belief and shows all the information required by law and the regulations issued and prescribed by the Office of Oil and Gas.

[Signature]
Signature

PM
Title

1-10-2020
Date

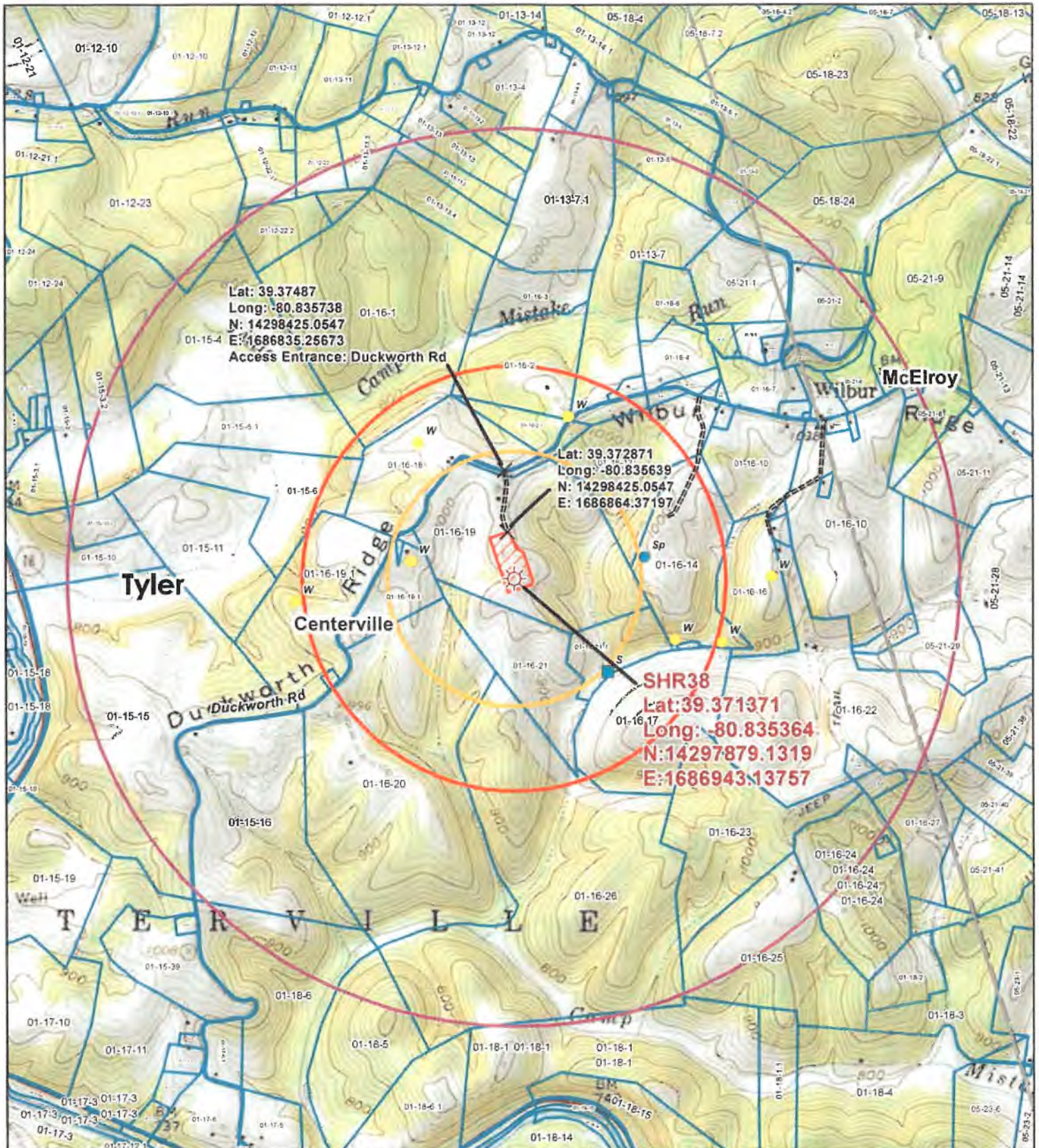

Lat: 39.37487
 Long: -80.835738
 N: 14298425.0547
 E: 1686835.25673
 Access Entrance: Duckworth Rd

Lat: 39.372871
 Long: -80.835639
 N: 14298425.0547
 E: 1686864.37197

SHR38
 Lat: 39.371371
 Long: -80.835364
 N: 14297879.1319
 E: 1686943.13757

Legend

- Wellbore
- Access Points
- Sp
- St
- W
- Access Road
- Surface Parcel
- Well Pad
- 1,500 Foot Buffer
- 2,500 Foot Buffer
- 1 Mile Buffer

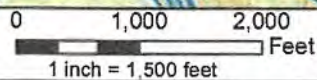

Original Date: 5/8/2018	Prepared By: GIS
Revision Date: 5/8/2018	Approved By: GIS
This map is property of CNX Land Resources Inc. and contains information that is proprietary and confidential in nature and may not be copied or reproduced without prior written consent.	
© Copyright CNX Land Resources Inc. 2011	



Topographic Well Map
SHR38