

LATITUDE 39°25'00"

11,170'

11,490' TO BOTTOM HOLE

LATITUDE 39°27'30"

Antero Resources Corporation
Well No. Bronco Unit 2H

AS DRILLED DATA:
WELL 2H TOP HOLE INFORMATION:
N: 331,232ft E: 1,635,613ft
LAT: 39°24'08.09" LON: 80°47'22.30"
BOTTOM HOLE INFORMATION:
N: 341,637ft E: 1,634,438ft
LAT: 39°25'50.90" LON: 80°47'26.44"
WEST VIRGINIA COORDINATE SYSTEM OF 1927 NORTH ZONE. ZONE WAS DERIVED FROM MEASUREMENTS TAKEN WITH TRIMBLE GEOXT SUBMETER MAPPING GRADE GPS UNIT. PLAT ORIENTATION, CORNER, AND WELL REFERENCE TIE LINES ARE BASED ON GRID NORTH.

(NAD) 83 (UTM) ZONE 17 COORDS:
WELL 2H TOP HOLE INFORMATION:
N: 4,361,446m E: 518,136m
BOTTOM HOLE INFORMATION:
N: 4,364,615m E: 518,030m

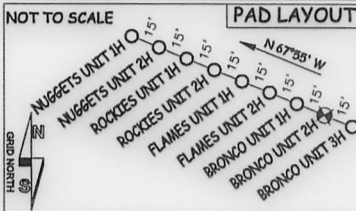

TM-Par	Surface Owner	15-29	Mitchell Herrick	16-08	Jane Griffin	16-20.5	Susan Spencer
10-14	Charlene Garrison	15-31	Roger Weese	16-8.1	Roger Griffin	16-20.6	Timothy Spencer
10-20	Kenneth Mason	15-43	Robert Kocher	16-8.2	Roger Griffin	16-20.7	Timothy Spencer
10-21	Kenneth Mason	16-01	Donald Vandine Jr.	16-8.3	Brian Eddy	19-01	Susan Spencer
11-24	Bobby Thomas	16-07	Robert Kocher	16-09	Jamie Straight	19-02	Antero Resources Corp.
11-46	Alva Spencer Est.	16-7.1	Donald Moore	16-17	Charles Straight	19-03	Larry Stevens
11-47	Jay Bee Oil & Gas Inc.	16-7.2	Donna Brumbaugh	16-17.1	Charles Straight	19-04	John Owens
11-47.1	James Cantor Sr.	16-7.3	Mary Blattner	16-17.2	Rodney Tippins	19-05	Paul Weekley
11-47.2	Everett Stanley	16-7.4	Donald Moore	16-17.3	Charles Kimball	19-06	Paul Weekley
15-21	Robert Jennings	16-7.5	Robert Kocher	16-20	Susan Spencer	19-07	Patricia Montgomery
15-22	Joe Kimball	16-7.6	Robert Kocher	16-20.1	Susan Spencer	19-08	John Lewis Jr.
15-23	Kenneth Kline	16-7.7	Robert Kocher	16-20.2	Gary Nichols	19-09	Robert Walsh
15-25	William Roberts	16-7.8	Blattner & Howard LLC	16-20.3	Gary Nichols	19-48	Lloyd Talkington
15-28.4	George Hamilton	16-7.9	Mary Blattner				

WV NORTH ZONE
GRID NORTH

10,027' TO BOTTOM HOLE

5,252'

LONGITUDE 80°45'00"

LONGITUDE 80°45'00"

NOTE:
12 WATER WELLS WERE LOCATED WITHIN 2000' OF THE PROPOSED WELL

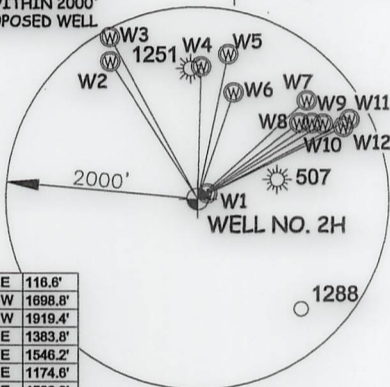

Well	N	E	Dist
W1	N 58°50'E	116.6'	
W2	N 32°31'W	1698.8'	
W3	N 28°31'W	1919.4'	
W4	N 01°31'E	1383.8'	
W5	N 11°55'E	1546.2'	
W6	N 18°37'E	1174.6'	
W7	N 47°54'E	1539.8'	
W8	N 63°04'E	1332.1'	
W9	N 66°18'E	1437.9'	
W10	N 58°55'E	1531.8'	
W11	N 62°11'E	1796.0'	
W12	N 63°28'E	1703.7'	

I THE UNDERSIGNED, HEREBY CERTIFY THAT THIS PLAT IS CORRECT TO THE BEST OF MY KNOWLEDGE AND BELIEF AND SHOWS ALL THE INFORMATION REQUIRED BY LAW AND THE RULES ISSUED AND PERSCRIBED BY THE DEPARTMENT OF ENVIRONMENTAL PROTECTION.



STATE OF WEST VIRGINIA, DIVISION OF ENVIRONMENTAL PROTECTION, OFFICE OF OIL AND GAS

WILLOW LAND SURVEYING PLLC
220 MASONIC AVE. PENNSBORO
WEST VIRGINIA 26415

JOB # 19-006WA

DRAWING # BRONCO2HAD

SCALE 1" = 2000'

MINIMUM DEGREE OF ACCURACY SUBMETER

PROVEN SOURCE OF ELEV. SUBMETER MAPPING GRADE GPS

STATE OF WEST VIRGINIA DEPARTMENT OF ENERGY DIVISION OF OIL AND GAS

LEGEND

- Surface Owner Boundary Lines +/-
- Interior Surface Tracts +/-
- Proposed Well Path
- As Drilled Well Path

DOUGLAS R. ROWE P.S. 2202

DATE 06/09/21

OPERATOR'S WELL# BRONCO UNIT #2H

- NOTE
- NO OCCUPIED DWELLINGS OR BUILDINGS TWO THOUSAND FIVE HUNDRED (2,500) SQUARE FEET OR LARGER USED TO HOUSE OR SHELTER DAIRY CATTLE OR POULTRY HUSBANDRY ARE LOCATED WITHIN SIX HUNDRED TWENTY-FIVE (625) FEET OF THE CENTER OF THE WELL PAD.
 - TOP HOLE DATA SHOWN HEREON WAS PROVIDED BY ANTERO RESOURCES CORPORATION.
 - AS DRILLED DATA WAS PROVIDED BY ANTERO RESOURCES CORPORATION.
 - WLS IS NOT CERTIFYING THE DATA AND INFORMATION PROVIDED LISTED IN NOTES 2 AND 3, ONLY THE RELATIONSHIP TO THE DATA AND INFORMATION PROVIDED TO THE LEASE BOUNDARIES.
 - WLS IS BY NO MEANS RESPONSIBLE FOR ANY ERRORS OR INACCURACIES WITH THE DATA AND INFORMATION THAT HAS BEEN PROVIDED.

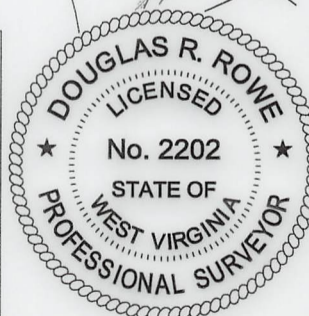

WELL TYPE: OIL ___ GAS LIQUID INJECTION ___ WASTE DISPOSAL ___ 47 - 095 - 02661

(IF "GAS") PRODUCTION STORAGE ___ DEEP ___ SHALLOW STATE COUNTY PERMIT

LOCATION: ELEVATION 749' - AS BUILT WATERSHED McELROY CREEK QUADRANGLE SHIRLEY 7.5' DISTRICT McELROY COUNTY TYLER

SURFACE OWNER ANTERO RESOURCES CORPORATION ACREAGE 127.86 ACRES +/-

OIL & GAS ROYALTY OWNER B.F. REED ET UX; MARK A. BURNETT; K & D HOLDINGS, LLC; LEASE ACREAGE 130 AC.±; 256 AC.±; 219.39 AC.±;

JIMMY J. GRIFFIN ET UX; LOREN E. BAGLEY ET AL; BRC APPALACHIAN I, LLC; TROY SPENCER UNDERWOOD 236 AC.±; 502.8 AC.±; 70 AC.±; 257 AC.±;

PROPOSED WORK: DRILL ___ CONVERT ___ DRILL DEEPER ___ REDRILL ___ FRACTURE OR STIMULATE ___

PLUG OFF OLD FORMATION ___ PERFORATE NEW FORMATION ___ OTHER PHYSICAL CHANGE IN WELL (SPECIFY) AS DRILLED PLUG & ABANDON CLEAN OUT & REPLUG

TARGET FORMATION MARCELLUS ESTIMATED DEPTH 6,460' TVD 17,194' MD

WELL OPERATOR ANTERO RESOURCES CORP. DESIGNATED AGENT DIANNA STAMPER - CT CORPORATION SYSTEM

ADDRESS 1615 WYNKOOP ST. ADDRESS 5400 D BIG TYLER ROAD

FORM WW-6 DENVER, CO 80202 CHARLESTON, WV 25313

COUNTY NAME

PERMIT