

8,135' to Bottom Hole

6,650' to Top Hole

TOP HOLE LATITUDE 39 - 30 - 00
BTM HOLE LATITUDE 39 - 32 - 30

LONGITUDE 80 - 52 - 30

10,234' to Top Hole

14,453' to Bottom Hole

Antero Resources
Well No. Kramer Unit 1H
BHL MOD
Antero Resources Corporation



See Detail 2 Page 2

Kramer Unit 1H Bottom Hole

Notes:
West Virginia Coordinate System of 1927, North Zone based upon Differential GPS Measurements.
Well No. Kramer Unit 1H Top Hole coordinates are
N: 356,955.94' Latitude: 39°28'17.84"
E: 1,605,358.02' Longitude: 80°53'52.79"
Bottom Hole coordinates are
N: 367,911.71' Latitude: 39°30'05.93"
E: 1,604,105.05' Longitude: 80°54'10.95"
UTM Zone 17, NAD 1983
Top Hole Coordinates Bottom Hole Coordinates
N: 4,369,128.939m N: 4,372,460.279m
E: 508,788.207m E: 508,350.768m
Plat orientation and corner and well references are based upon the grid north meridian.
Well location references are based upon the magnetic meridian.

Notes:
Well No. Kramer Unit 1H
UTM Zone 17, NAD 1927
Top Hole Coordinates
N: 14,333,669.76'
E: 1,669,201.87'
Point of Entry Coordinates
N: 14,333,325.35'
E: 1,671,677.01'
Bottom Hole Coordinates
N: 14,344,599.34'
E: 1,667,766.69'

- Legend**
- ⊙ Proposed gas well
 - ⊙ Monument, as noted
 - ⊙ Existing Well, as noted
 - ⊙ Existing Well, as noted
 - Creek or Drain
 - Existing Road
 - Surface boundary (approx.)
 - Interior surface tracts (approx.)
 - Corporation Line

Well Location References

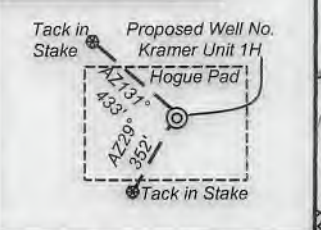

Bearing	Dist.
L1 S 49°48' E	1,404.1'
L2 S 28°29' E	1,520.4'
L3 N 71°13' W	887.9'
L4 N 06°38' W	1,473.5'
L5 S 81°07' E	2,499.8'

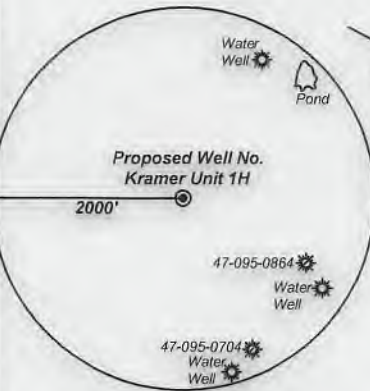
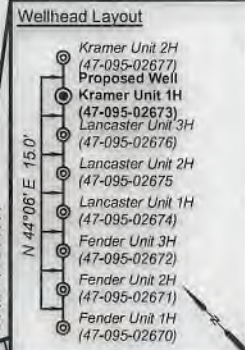

Note: 3 water wells and 1 pond were found within 2000' of proposed well. No occupied dwellings or buildings 2,500 square feet or larger used to house or shelter dairy cattle or poultry husbandry are located within 625' of the center of the well pad.



I, the undersigned, hereby certify that this plat is correct to the best of my knowledge and belief and shows all the information required by law and the rules issued and prescribed by the Department of Environmental Protection.

Bradley D. Miller
Bradley D. Miller, P.S. 2167

FILE NO: 15-54-E-19
DRAWING NO: Kramer Unit 1H Well Plat
SCALE: 1" = 2000'
MINIMUM DEGREE OF ACCURACY: Submeter
PROVEN SOURCE OF ELEVATION: WVDOT, Harrisville, WV

STATE OF WEST VIRGINIA
DEPARTMENT OF ENVIRONMENTAL PROTECTION
OIL AND GAS DIVISION

DATE: March 12 2019
OPERATOR'S WELL NO. Kramer 1H
API WELL NO
47 - 095 - 02673
STATE COUNTY PERMIT

WELL TYPE: OIL GAS LIQUID INJECTION WASTE DISPOSAL
(IF GAS) PRODUCTION: STORAGE DEEP SHALLOW
Proposed 1,014.5'
LOCATION: ELEVATION: Existing 1,033' WATERSHED: Outlet Middle Island Creek QUADRANGLE: Middlebourne
DISTRICT: Ellsworth COUNTY: Tyler
SURFACE OWNER: Michael J. & Melinda R. Hogue ACREAGE: 192.0
ROYALTY OWNER: Michael J. & Melinda R. Hogue; James F. Doan, et ux (2); Ridgetop Capital, LP; Robert J. Kocher, et ux; REOP, LLC; Jerry R. Brown, et ux; WV Dept. of Transportation, DOH; Boyd M. Parr, et ux; Charles R. Wince, et ux; Karen S. Hunt; Grace M. Stackpole; Ryan L. Walton, et ux; Map2012-OK; WV Division of Natural Resources; Middlebourne Cemetery Association; John T. Burr, et ux; Rosalee J. Forrester (3); Jerry Todd Williams; William M. Baker, et ux; Brian D. Carpenter, et ux; Barbara J. Davis (2); Perry L. Weekley, et ux; Nina Wise; Richard A. Fonner, et ux; Barbara K. Davis; LEASE NO: ACREAGE: 6.95064, 19.518, 13.35
PROPOSED WORK: DRILL CONVERT DRILL DEEPER FRACTURE OR STIMULATE PLUG OFF OLD FORMATION
 PERFORATE NEW FORMATION OTHER PHYSICAL CHANGE IN WELL (SPECIFY) BHL MOD
 PLUG AND ABANDON CLEAN OUT AND REPLUG TARGET FORMATION: Marcellus Shale ESTIMATED DEPTH: 22,400' MD 6,900' TVD

WELL OPERATOR: Antero Resources Corporation DESIGNATED AGENT: Dianna Stamper - CT Corporation System
ADDRESS: 1615 Wynkoop Street ADDRESS: 5400 D Big Tyler Road
Denver, CO 80202 Charleston, WV 25313

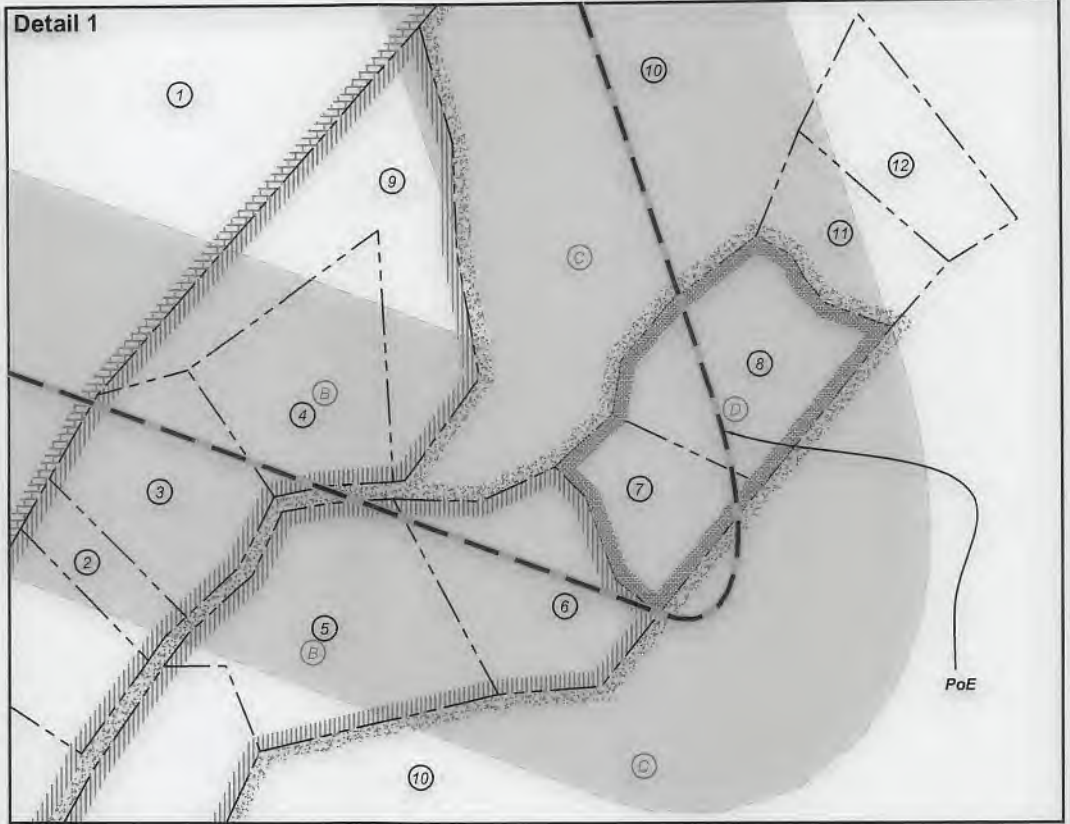

FILE NO: 15-54-E-19
 DRAWING NO: Kramer Unit 1H Well Plat
 SCALE: 1" = 2000'
 MINIMUM DEGREE OF ACCURACY:
Submeter
 PROVEN SOURCE OF ELEVATION:
WVDOT, Harrisville, WV

STATE OF WEST VIRGINIA
 DEPARTMENT OF ENVIRONMENTAL PROTECTION
OIL AND GAS DIVISION

DATE: March 12 2019
 OPERATOR'S WELL NO. Kramer 1H
 API WELL NO MDJ
47 - 095 - 02673
 STATE COUNTY PERMIT

WELL TYPE: OIL GAS LIQUID INJECTION WASTE DISPOSAL
 (IF GAS) PRODUCTION: STORAGE DEEP SHALLOW

LOCATION: ELEVATION: Existing 1,033' Proposed 1,014.5' WATERSHED: Outlet Middle Island Creek QUADRANGLE: Middlebourne

DISTRICT: Ellsworth COUNTY: Tyler

SURFACE OWNER: Michael J. & Melinda R. Hogue ACREAGE: 192.0

ROYALTY OWNER: Michael J. & Melinda R. Hogue; James F. Doan, et ux (2); Ridgeloop Capital, LP; Robert J. Kocher; LEASE NO: _____ ACREAGE: _____

PROPOSED WORK: DRILL CONVERT DRILL DEEPER FRACTURE OR STIMULATE PLUG OFF OLD FORMATION
 PERFORATE NEW FORMATION OTHER PHYSICAL CHANGE IN WELL (SPECIFY) BHL MOD

PLUG AND ABANDON CLEAN OUT AND REPLUG TARGET FORMATION: Marcellus Shale ESTIMATED DEPTH: 22,400' MD

WELL OPERATOR: Antero Resources Corporation DESIGNATED AGENT: Dianna Stamper - CT Corporation System
 ADDRESS: 1615 Wynkoop Street ADDRESS: 5400 D Big Tyler Road
Denver, CO 80202 Charleston, WV 25313

93.225;
 191.5; 81.33; 310.393;
 9.178; 1.46; 2.235; 4;
 4.34737; 1.97387; 0.40818;
 1.50; 4.24; 102.33; 0.47;
 0.40818; 100.45; 28.54;
 0.45; 25.629; 0.13; 8.62;
 0.91; 0.88; 5.73254;
 6.95064; 19.518; 13.35



FILE NO: 15-54-E-19
 DRAWING NO: Kramer Unit 1H Well Plat
 SCALE: 1" = 2000'
 MINIMUM DEGREE OF ACCURACY:
Submeter
 PROVEN SOURCE OF ELEVATION:
WVDOT, Harrisville, WV



DATE: March 12 2019
 OPERATOR'S WELL NO. Kramer 1H
 API WELL NO MOD
47 - 095 - 02673
 STATE COUNTY PERMIT

WELL TYPE: OIL GAS LIQUID INJECTION WASTE DISPOSAL
 (IF GAS) PRODUCTION: STORAGE DEEP SHALLOW
 Proposed 1,014.5'
 LOCATION: ELEVATION: Existing 1,033' WATERSHED: Outlet Middle Island Creek QUADRANGLE: Middlebourne
 DISTRICT: Ellsworth COUNTY: Tyler
 SURFACE OWNER: Michael J. & Melinda R. Hogue ACREAGE: 192.0
 ROYALTY OWNER: Michael J. & Melinda R. Hogue; James F. Doan, et ux (2); Ridgetop Capital, LP; Robert J. Kocher; LEASE NO: _____ ACREAGE: _____
 PROPOSED WORK: DRILL CONVERT DRILL DEEPER FRACTURE OR STIMULATE PLUG OFF OLD FORMATION
 PERFORATE NEW FORMATION OTHER PHYSICAL CHANGE IN WELL (SPECIFY) BHL MOD
 PLUG AND ABANDON CLEAN OUT AND REPLUG TARGET FORMATION: Marcellus Shale ESTIMATED DEPTH: 22,400' MD
 6,900' TVD

WELL OPERATOR: Antero Resources Corporation DESIGNATED AGENT: Dianna Stamper - CT Corporation System
 ADDRESS: 1615 Wynkoop Street ADDRESS: 5400 D Big Tyler Road
Denver, CO 80202 Charleston, WV 25313



FILE NO: 15-54-E-19
 DRAWING NO: Kramer Unit 1H Well Plat
 SCALE: 1" = 2000'
 MINIMUM DEGREE OF ACCURACY:
Submeter
 PROVEN SOURCE OF ELEVATION:
WVDOT, Harrisville, WV



DATE: March 12 20 19
 OPERATOR'S WELL NO. Kramer 1H
 API WELL NO
47 - 095 - 02673
 STATE COUNTY PERMIT

WELL TYPE: OIL GAS LIQUID INJECTION WASTE DISPOSAL
 (IF GAS) PRODUCTION: STORAGE DEEP SHALLOW
 Proposed 1,014.5'
 LOCATION: ELEVATION: Existing 1,033' WATERSHED: Outlet Middle Island Creek QUADRANGLE: Middlebourne
 DISTRICT: Ellsworth COUNTY: Tyler
 SURFACE OWNER: Michael J. & Melinda R. Hogue ACREAGE: 192.0
 ROYALTY OWNER: Michael J. & Melinda R. Hogue; James F. Doan, et ux (2); Ridgetop Capital, LP; Robert J. Kocher; LEASE NO: _____ ACREAGE: _____
 PROPOSED WORK: DRILL CONVERT DRILL DEEPER FRACTURE OR STIMULATE PLUG OFF OLD FORMATION
 PERFORATE NEW FORMATION OTHER PHYSICAL CHANGE IN WELL (SPECIFY) BHL MOD
 PLUG AND ABANDON CLEAN OUT AND REPLUG TARGET FORMATION: Marcellus Shale ESTIMATED DEPTH: 22,400' MD
 6,900' TVD

WELL OPERATOR: Antero Resources Corporation DESIGNATED AGENT: Dianna Stamper - CT Corporation System
 ADDRESS: 1615 Wynkoop Street ADDRESS: 5400 D Big Tyler Road
Denver, CO 80202 Charleston, WV 25313

Antero Resources
Well No. Kramer Unit 1H
BHL MOD
Antero Resources Corporation

Leases

A	Michael J. & Melinda R. Hogue
B	James F. Doan, et ux
C	Ridgetop Capital LP
D	James F. Doan, et ux
E	WV Division of Natural Resources
F	James S. Suter
G	James S. Suter
H	Jeff T. Hoover
I	WV Dept. of Transportation, DOH
J	Nancy Ann Villers
K	Mary Alice Hickman Estate
L	Nancy J. Villers
M	James S. Suter, et ux
N	Steven L. Conrad, et ux
O	Kendra K. Cottrill Wyke
P	Stephen D. Ashley, et ux
Q	Randy Murray, et ux
R	Dylan Shane Murray, et ux
S	Lance M. Hickman
T	Mary A. Hickman
U	Mary A. Hickman
V	Norman C. Twyman
W	Ricky W. Morris, et ux
X	Barbara K. Davis
Y	John T. Burr, et ux
Z	Perry L. Weekley, et ux
AA	Nina Naomi Wise
AB	Jerry Todd Williams
AC	Barbara J. Davis
AD	William M. Baker, et ux
AE	Rosalee J. Forrester
AF	Rosalee J. Forrester
AG	Rosalee J. Forrester
AH	Robert J. Kocher
AI	William M. Baker, et ux
AJ	Bradley Baker
AK	Clara Jane Glover
AL	Brian D. Carpenter, et ux
AM	Richard A. Fonner, et ux
AN	Connie L. Hickman
AO	Michael A. Lenz, et ux
AP	Jeffery D. McKinney
AQ	Homer L. Matthews
AR	Michael Hickman, et ux
AS	Marvin Gene Franklin
AT	Tommy L. Williams
AU	Jerry R. Brown, et ux
AV	Jerry R. Brown
AW	Jerry R. Brown
AY	Karen S. Hunt
AZ	Grace M. Stackpole
BA	Charles R. Wince, et ux
BB	Ryan L. Walton, et ux
BC	Bradley R. Crawford, et ux
BD	Gary M. Patterson, et ux
BE	Brian K. Doak, et ux
BF	Thomas Jack Carpenter
BG	Map2012-OK
BJ	Roger Carl Ferrell
BK	Rose E. White
BL	Middlebourne Cemetery Association
BM	REOP, LLC
BN	Town of Middlebourne
BO	Boyd M. Parr, et ux
BP	Town of Middlebourne
BQ	Scott Denomme
BR	Scott Denomme
BS	Jessica L. Dotson

ID	TM/Par	Owner	Bk/Pg	Acres
1	20/108	Michael J. & Melinda R. Hogue	348/404	192.00
2	26/46.6	Camille Patera	296/247	1.702
3	26/46.9	Eugene B. Jr. & Carol A. Johnson	351/60	5.00
4	26/46.2	Robert E. Lee II & Chasity L. Pittman	408/122	5.14
5	26/46.7	Camille Patera	296/247	7.32
6	26/46.3	Timothy Kanz	440/24	5.40
7	26/46.12	Charles R. & Bertha A. Holliday	306/665	3.24
8	26/46.13	Charles R. & Bertha A. Holliday	306/665	5.94
9	26/46.14	Jay-Bee Production Company	420/97	8.69
10	26-46	Jay-Bee Production Company	420/97	286.04
11	26/46.22	Eugene B. Johnson, Sr., et ux	351/247	2.92
12	26/46.23	Eugene B. Johnson, Sr., et ux	351/247	3.60
13	20-65.1	James S. & Ghislaine S. Suter	273/557	1.58
14	21-63	James S. & Ghislaine S. Suter	229/658	0.44
15	20-82	James S. & Ghislaine S. Suter	211/449	0.70
16	20-62.1	James S. & Ghislaine S. Suter	287/509	0.83
17	20-66	Jeff T. Hoover	313/120	1.00
18	20-62	Nancy Villers & Sara Fay Eskew	WB44/598	67.67
19	20/65.1	James S & Ghislaine Suter	273/557	1.58
20	20/79	Tamara Wilcox & Steven L Conrad	361/205	0.68
21	20/77	Joseph C. Snyder Jr.	397/838	1.27
22	20/78	Joseph C. Snyder Jr.	397/838	0.85
23	20/65	Kathy Sue Archer	336/138	6.85
24	20/64	Randy Murray & Julia A. Murray	WB37/376	0.99
25	20/64.1	Dylan Shane Murray	385/472	3.23
26	20-56.2	Lance M. & Tina R. Hickman	438/814	2.95
27	20-56.1	Lance M. Hickman	393/65	16.405
28	20/63	Kimberly & George Eidel	353/298	4.79
29	20/63.1	Mary A. Hickman	WB37/376	0.48
30	20/61	Mark Duane Hickman, et al	WB54/1	2.22
31	20/76	Stephen D. & Brenda J. Ashley	211/429	2.74
32	20/75	Ricky J. & Sharon S. Morris	285/17	1.47
33	20/74	Barbara K. Davis	AR43/791	1.46
34	20/73	John T. & Catherine L. Burr	378/27	1.11
35	20/72	John T. & Catherine L. Burr	378/27	1.13
36	20/71	Perry L. & Jackie L. Weekley	370/145	4.00
37	20-56	Mary Alice Hickman	152/16	14.96
38	20-55	Mary Alice Hickman	AR36/289	71.34
39	20/59	Robert Kocher	358/343	4.19
40	20/59.1	Robert R. & Rosalee J. Forrester	335/826	0.05
41	20/58	Robert R. & Rosalee J. Forrester	321/129	0.46
42	20/60	Robert R. & Rosalee J. Forrester	321/129	0.38
43	20/60.1	Robert Kocher	358/343	0.05
44	20/70	Nina Wise	WB25/700	3.91
45	20/69	Jerry, Michelle, & Justin Williams	440/471	1.10
46	20/68	Barbara J. Davis	WB30/311	2.09
47	20-67	William M. & Janet S. Baker	175/391	2.10
48	20-54	William M. & Janet S. Baker	175/391	100.45
49	20/54.1	Bradley Baker	356/823	2.00
50	20/53	Clara Negle	344/51	8.00
51	20/51.6	Brian & Sarah Carpenter	342/467	24.92
52	20-33	Lance M. & Tina R. Hickman	396/561	77.84
53	20-10	Connie L. Hickman, et al	341/209	41.00
54	20/23	Michael & Chris Lenz	313/216	4.60
55	20/23.1	Michael & Chris Lenz	323/732	5.52
56	20/25	Marshal McKinney	208/650	0.92
57	20/33.2	Homer Matthews	284/375	0.28
58	20/32	Homer Lee Matthews	176/216	0.34
59	20/31	Larry & Barbara Lee	211/179	0.34
60	20/21	Nancy Mercer	WB32/425	0.34
61	20/27	Earl P. & Crucita Kendle	331/341	0.32
62	20/29.1	James Bembry	331/43	0.25
63	20/33.3	Richard Fonner	415/796	18.5
64	20/29	Maurine Hadley	167/69	0.34
65	20/30	Donald & Susan Smith	321/165	0.26
66	20/28	Victor & Lorraine Weekley	280/422	0.23
67	20/20	Melinda Sue George	351/520	0.14
68	4-38	Michael K. Smith, et ux	377/179	0.07
69	4-39	Diana Lynn Slider	250/397	0.79
70	20-19	Jerry R. Brown	222/177	0.18
71	4-41	Jerry R. Brown	WB26/707	0.42
72	4-42	Donald K. Baker, et ux	532/595	0.20
73	20-18	Donald K. Baker, et ux	532/595	0.11
74	20-5.1	Charles R. & Martha J. Wince	356/22	0.18
75	4-43	Charles R. & Martha J. Wince	353/228	0.44
76	20-5	Grace M. Stackpole	373/11	0.88
77	20-7	Jerry & Jacqueline Brown	340/217	0.62
78	20-33.1	Jerry & Jacqueline Brown	340/215	8.00

ID	TM/Par	Owner	Bk/Pg	Acres
79	20-9	Marvin Gene Franklin	WB57/256	2.77
80	20B-29	Connie Lee & Michael D. Hickman	251/264	0.41
81	14-67	Tommy L. & Carolyn Williams	169/472	3.00
82	14-67.1	Gary M. & Amber D. Patterson	538/721	0.35
83	14-66	Bradley R. & Frances K. Crawford	206/698	2.70
84	20-8	Jessica L. Dotson, et al	359/727	5.94
85	20-6	Ryan L. & Melinda J. Walton	388/217	0.68
86	2-38	Patsy Fletcher	WB35/614	0.66
87	2-37	Sadie T. Weekley Irrevocable Trust	373/542	0.26
88	2-33	Scott A. Holmes	424/386	0.12
89	2-32	Scott A. Holmes	326/679	0.34
90	2-34	Janice E. Licht	321/477	0.51
91	14-62	Patsy Fletcher	WB35/614	14.50
92	2-35	Patsy Fletcher	WB35/614	4.25
93	2-36	WV Dept. of Highways	---	0.30
94	14-63	Wells Cemetery	67/69	0.21
95	14-65	Brian Kim & Pamela J. Doak	309/491	7.11
96	14-64	Boyd M. & Patricia L. Parr	181/549	3.04
97	14-55	Boyd M. & Patricia L. Parr	214/725	0.70
98	14-54	Boyd & Patricia Parr	164/170	2.30
99	14-53	Rosa E. White	284/317	0.69
100	14-52	Middlebourne Cemetery Association	144/234	12.36
101	2-47	Witschey's Market Inc.	280/93	0.42
102	14-50	Barry Harter	WB38/64	0.80
103	14-51.1	Barry Harter	WB38/64	0.27
104	14-51	Barry Harter	590/268	4.66
105	14-90	Town of Middlebourne	222/301	1.00
106	14-51	Boyd M. & Patricia L. Parr	222/349	47.29
107	14-56.1	Boyd M. & Patricia L. Parr	358/643	35.33
108	14-91	Town of Middlebourne	377/97	2.32
109	14A-29.4	David B. Shriver	463/753	1.00
110	14A-29.2	Ren Realty DBA David Shriver	337/105A	1.00
111	14A-29.3	David B. Shriver	456/435	1.75
112	14A-29	Victor A & Lorraine Weekley	299/300	13.00
113	14A-22	Julia A. Smith	98/92	0.25
114	14A-21.1	Unknown	---	0.60
115	14A-21	Jack L. & Donna Lea Boggs	233/636	0.29
116	14A-24	Diane Lynn Glover	386/430	0.72
117	14A-26	Robert Wells	336/686	0.28
118	14A-27	Long Reach Employees Federal Credit Union	328/140	0.43
119	14A-27.1	Federal Credit Union	328/140	0.11
120	14A-27.2	Sharon Stackpole & Tabatha Welch	349/660	0.03
121	14A-28	Sharon Stackpole & Tabatha Welch	349/660	0.337
122	14A-28.1	Conrad E. Costlow	330/925	0.28
123	14A-29	Victor A & Lorraine Weekley	299/300	13.00
124	14A-30	Conrad E. Costlow	330/923	0.57
125	14A-31	Brian & Lisa Wiley	318/380	0.29
126	14A-32	Brian & Lisa Wiley	306/297	0.22
127	14A-17	Robert P. Wells	339/668	0.72
128	14A-17.1	Robert P. Wells	347/733	0.29
129	14A-18	David L. & Misty J. Stoller	383/222	0.43
130	14A-19	Raymond E. & Eva June Brightwell	304/380	0.25
131	14A-20	Jack L. & Donna Lea Boggs	231/725	0.30
132	14A-19.1	Raymond E. & Eva June Brightwell	304/380	0.19
133	14A-19.2	Raymond E. & Eva June Brightwell	336/522	0.13
134	14A-15	Douglas Carson	379/507	0.14
135	14A-16.1	Douglas Carson	379/507	0.14
136	14A-16	Allen E. Jr & Rebecca A. Henderson	346/579	0.14
137	14A-16.2	Allen E. Jr & Rebecca A. Henderson	346/579	0.43
138	14A-33	Michael J. & Christine H. Farhatt	331/376	0.29
139	14A-34	Michael J. & Christine H. Farhatt	331/376	0.29
140	14A-40	Ray N. & Gladys R. Gorrell	WB32/38	0.57
141	14A-44	Rebecca Ann Henderson	351/836	0.31
142	14A-45	Rebecca Ann Henderson	351/836	0.71
143	14A-13	David R. & Corey Helen Wilcox	420/722	1.12
144	14A-12	Lloyd E. & Donna A. Shepreth	321/106	0.64
145	14A-11	Robert D. Wetzel	402/591	1.19
146	14A-43	Rebecca J. Ruble	306/293	1.11
147	14A-42	Dominic Yost	426/605	0.26
148	14A-41	Phillip R. & Dorothy M. Wilcox	286/307	0.28
149	14-22	Sherry Carroll	294/535	5.02
150	14-21	Arnold L. & Melba J. Templeton	346/507	14.95
151	14A-3	Sandra Sue Snider	217/325	6.00
152	14A-4	Sandra S Snider	367/10	0.26
153	14A-10	Richard Daniel & Judith Ann Bowen	349/296	0.19
154	14A-9	Richard Daniel & Judith Ann Bowen	371/429	1.46
155	14A-8	Glenn & Starlin Hissam	343/801	0.33
156	14-42	Anne L. Spencer	273/368	33.00

FILE NO: 15-54-E-19
 DRAWING NO: Kramer Unit 1H Well Plat
 SCALE: 1" = 2000'
 MINIMUM DEGREE OF ACCURACY:
 Submeter
 PROVEN SOURCE OF ELEVATION:
 WVDOT, Harrisville, WV

STATE OF WEST VIRGINIA
 DEPARTMENT OF ENVIRONMENTAL PROTECTION
OIL AND GAS DIVISION

DATE: March 12 2019
 OPERATOR'S WELL NO. Kramer 1H
 API WELL NO
 47 - 095 - 02673
 STATE COUNTY PERMIT

WELL TYPE: OIL GAS LIQUID INJECTION WASTE DISPOSAL
 (IF GAS) PRODUCTION: STORAGE DEEP SHALLOW
 Proposed 1,014.5'
 LOCATION: ELEVATION: Existing 1,033' WATERSHED: Outlet Middle Island Creek QUADRANGLE: Middlebourne
 DISTRICT: Ellsworth REOP, LLC; Jerry R. Brown, et ux; WV Dept. of Transportation, DOH; Boyd M. Parr, et ux; Charles R. Wince, et ux; Karen S. Hunt; Grace M. Stackpole; Ryan L. Walton, et ux; Map2012-OK; COUNTY: Tyler
 SURFACE OWNER: Michael J. & Melinda R. Hogue WV Division of Natural Resources; Middlebourne Cemetery Association; John T. Burr, et ux; Rosalee J. Forrester (3); Jerry Todd Williams; William M. Baker, et ux; Brian D. Carpenter, et ux; ACREAGE: 192.0
 ROYALTY OWNER: Michael J. & Melinda R. Hogue; James F. Doan, et ux (2); Ridgetop Capital, LP; Robert J. Kocher; LEASE NO: ACREAGE:
 PROPOSED WORK: DRILL CONVERT DRILL DEEPER FRACTURE OR STIMULATE PLUG OFF OLD FORMATION
 PERFORATE NEW FORMATION OTHER PHYSICAL CHANGE IN WELL (SPECIFY) BHL MOD
 PLUG AND ABANDON CLEAN OUT AND REPLUG TARGET FORMATION: Marcellus Shale ESTIMATED DEPTH: 22,400' MD

WELL OPERATOR: Antero Resources Corporation DESIGNATED AGENT: Dianna Stamper - CT Corporation System
 ADDRESS: 1615 Wynkoop Street ADDRESS: 5400 D Big Tyler Road
 Denver, CO 80202 Charleston, WV 25313