

LATITUDE 39°32'30"

10,704'

LATITUDE 39°35'00"

11,437' TO BOTTOM HOLE

Antero Resources Corporation Well No. Lemon Unit 2H

LINE	BEARING	DISTANCE
L1	N 72°40' W	1638.0'
L2	N 64°54' W	1582.1'
L3	N 61°22' W	1537.8'
L4	N 34°54' W	1512.5'
L5	N 27°19' W	1636.7'
L6	N 21°11' W	1650.6'
L7	N 06°24' W	1392.9'
L8	N 05°00' W	1521.3'
L9	N 00°15' W	1911.8'
L10	N 03°26' E	1913.5'
L11	N 25°08' E	1338.5'
L12	N 49°41' E	1592.6'

NOTES:
 WELL 2H TOP HOLE INFORMATION:
 N: 373,284ft E: 1,624,909ft
 LAT: 39°31'02.15" LON: 80°49'46.58"
 BOTTOM HOLE INFORMATION:
 N: 385,374ft E: 1,624,349ft
 LAT: 39°33'01.54" LON: 80°49'56.01"
 WEST VIRGINIA COORDINATE SYSTEM OF 1927 NORTH ZONE. ZONE WAS DERIVED FROM MEASUREMENTS TAKEN WITH TRIMBLE GEOXT SUBMETER MAPPING GRADE GPS UNIT. PLAT ORIENTATION, CORNER, AND WELL REFERENCE TIE LINES ARE BASED ON GRID NORTH.

(NAD) 83 (UTM) ZONE 17 COORDS:
 WELL 2H TOP HOLE INFORMATION:
 N: 4,374,203m E: 514,662m
 BOTTOM HOLE INFORMATION:
 N: 4,377,883m E: 514,430m

WV NORTH ZONE GRID NORTH

1,985' TO BOTTOM HOLE

LONGITUDE 80°47'30"

LONGITUDE 80°47'30"

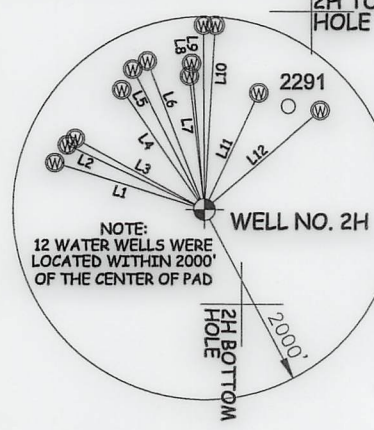
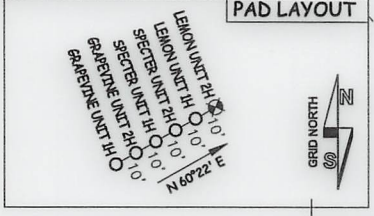

A	JERRY R. BROWN	14.5 ACRES±
C	STAR FURNITURE CO. OF WEST UNION INC.	80.5 ACRES±
D	LINDA K. LOEHR	82 ACRES±
E	BOUNTY MINERALS, LLC	38.5 ACRES±
G	RYAN GREENLEE ET UX	27.49 ACRES±
H	RICHARD MOORE	111.52 ACRES±
I	BOUNTY MINERALS, LLC	28.47 ACRES±
J	CLARENCE DUANE CLARK ET UX	25 ACRES±
K	BRC APPALACHIAN MINERALS I LLC	39.29 ACRES±
L	RALPH D. THACKER	35 ACRES±
M	JUDITH A. ASH	59.69 ACRES±
N	HERITAGE RESOURCES-MARCELLUS MINERALS, LLC	39.41 ACRES±
O	GARY A. SOLE	92.5 ACRES±
P	GARY A. SOLE	60 ACRES±
Q	GARY A. SOLE	45.34 ACRES±
R	RIDGETOP CAPITAL IV, LP	43.5 ACRES±
S	NILE DEAN HARRIS	53.75 ACRES±
T	RIDGETOP CAPITAL LP	69.06 ACRES±
U	BRC APPALACHIAN MINERALS I LLC	58.56 ACRES±
V	RIDGETOP CAPITAL IV, LP	16.5 ACRES±
W	ANTERO RESOURCES CORP.	40 ACRES±
X	DOUGLAS SCOTT FUNK SR.	11.5 ACRES±
Y	BRC APPALACHIAN MINERALS I LLC	61.73 ACRES±

I THE UNDERSIGNED, HEREBY CERTIFY THAT THIS PLAT IS CORRECT TO THE BEST OF MY KNOWLEDGE AND BELIEF AND SHOWS ALL THE INFORMATION REQUIRED BY LAW AND THE RULES ISSUED AND PERSCRIBED BY THE DEPARTMENT OF ENVIRONMENTAL PROTECTION.



STATE OF WEST VIRGINIA, DIVISION OF ENVIRONMENTAL PROTECTION, OFFICE OF OIL AND GAS
 WILLOW LAND SURVEYING PLLC
 220 MASONIC AVE. PENNSBORO WEST VIRGINIA 26415

NOTE
 NO OCCUPIED DWELLINGS OR BUILDINGS TWO THOUSAND FIVE HUNDRED (2,500) SQUARE FEET OR LARGER USED TO HOUSE OR SHELTER DAIRY CATTLE OR POULTRY HUSBANDRY ARE LOCATED WITHIN SIX HUNDRED TWENTY-FIVE (625) FEET OF THE CENTER OF THE WELL PAD.

JOB # 20-008WA
 DRAWING # LEMON2HAD
 SCALE 1" = 2000'
 MINIMUM DEGREE OF ACCURACY SUBMETER
 PROVEN SOURCE OF ELEV. SUBMETER MAPPING GRADE GPS

LEGEND
 - - - Surface Owner Boundary Lines +/-
 - - - Interior Surface Tracts +/-
 O Proposed Well Path
 O As Drilled Well Path

STATE OF WEST VIRGINIA DEPARTMENT OF ENERGY DIVISION OF OIL AND GAS

DATE 06/09/21
 OPERATOR'S WELL# LEMON UNIT #2H

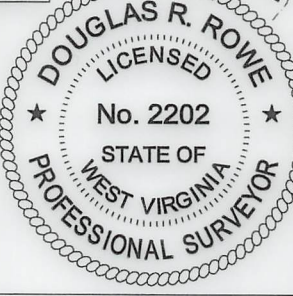

NOTES
 1. NO OCCUPIED DWELLINGS OR BUILDINGS TWO THOUSAND FIVE HUNDRED (2,500) SQUARE FEET OR LARGER USED TO HOUSE OR SHELTER DAIRY CATTLE OR POULTRY HUSBANDRY ARE LOCATED WITHIN SIX HUNDRED TWENTY-FIVE (625) FEET OF THE CENTER OF THE WELL PAD.
 2. TOP HOLE DATA SHOWN HEREON WAS PROVIDED BY ANTERO RESOURCES CORPORATION.
 3. AS DRILLED DATA WAS PROVIDED BY ANTERO RESOURCES CORPORATION.
 4. WLS IS NOT CERTIFYING THE DATA AND INFORMATION PROVIDED LISTED IN NOTES 2 AND 3, ONLY THE RELATIONSHIP TO THE DATA AND INFORMATION PROVIDED TO THE LEASE BOUNDARIES.
 5. WLS IS BY NO MEANS RESPONSIBLE FOR ANY ERRORS OR INACCURACIES WITH THE DATA AND INFORMATION THAT HAS BEEN PROVIDED.

WELL TYPE: OIL GAS X LIQUID INJECTION WASTE DISPOSAL 47 - 095 - 02704
 (IF "GAS") PRODUCTION X STORAGE DEEP SHALLOW X STATE COUNTY PERMIT
 LOCATION: ELEVATION 1,042' AS BUILT WATERSHED OUTLET MIDDLE ISLAND CREEK
 QUADRANGLE PORTER FALLS 7.5' DISTRICT ELLSWORTH COUNTY TYLER
 SURFACE OWNER KAYLA LEEK ACREAGE 69.06 ACRES +/-
 OIL & GAS ROYALTY OWNER RIDGETOP CAPITAL LP; BRC APPALACHIAN MINERALS I LLC LEASE ACREAGE 69.06 AC.±; 58.56 AC.±;
 RIDGETOP CAPITAL IV LP; RIDGETOP CAPITAL IV LP; DOUGLAS SCOTT FUNK SR.; ANTERO RESOURCES CORP.; NILE DEAN HARRIS; 43.5 AC.±; 16.5 AC.±; 11.5 AC.±; 40 AC.±; 53.75 AC.±;
 GARY A. SOLE; GARY A. SOLE; JUDITH A. ASH; BRC APPALACHIAN MINERALS I LLC; RALPH D. THACKER; CLARENCE DUANE 45.34 AC.±; 60 AC.±; 59.69 AC.±; 39.29 AC.±; 35 AC.±;
 CLARK ET UX; RICHARD MOORE; RYAN GREENLEE ET UX; LINDA K. LOEHR; STAR FURNITURE CO. OF WEST UNION INC.; JERRY R. BROWN 25 AC.±; 111.52 AC.±; 27.49 AC.±; 82 AC.±; 80.5 AC.±; 25 AC.±
 PROPOSED WORK: DRILL CONVERT DRILL DEEPER REDRILL FRACTURE OR STIMULATE
 PLUG OFF OLD FORMATION PERFORATE NEW FORMATION OTHER PHYSICAL CHANGE IN WELL
 (SPECIFY) AS DRILLED PLUG & ABANDON CLEAN OUT & REPLUG
 TARGET FORMATION MARCELLUS ESTIMATED DEPTH 6,571' TVD 19,464' MD
 WELL OPERATOR ANTERO RESOURCES CORP. DESIGNATED AGENT DIANNA STAMPER - CT CORPORATION SYSTEM
 ADDRESS 1615 WYNKOOP ST. ADDRESS 5400 D BIG TYLER ROAD
 DENVER, CO 80202 CHARLESTON, WV 25313