

LATITUDE 39°32'30"

10,769'

LATITUDE 39°35'00"

3,633' TO BOTTOM HOLE

Antero Resources Corporation Well No. Grapevine Unit 1H

NOTES: WELL 1H TOP HOLE INFORMATION: N: 373,247ft E: 1,624,843ft LAT: 39°31'01.77" LON: 80°49'47.42" BOTTOM HOLE INFORMATION: N: 384,141ft E: 1,620,385ft LAT: 39°32'48.78" LON: 80°50'46.38" WEST VIRGINIA COORDINATE SYSTEM OF 1927 NORTH ZONE. ZONE WAS DERIVED FROM MEASUREMENTS TAKEN WITH TRIMBLE GEOXT SUBMETER MAPPING GRADE GPS UNIT. PLAT ORIENTATION, CORNER, AND WELL REFERENCE TIE LINES ARE BASED ON GRID NORTH.

(NAD) 83 (UTM) ZONE 17 COORDS: WELL 1H TOP HOLE INFORMATION: N: 4,374,191m E: 514,642m BOTTOM HOLE INFORMATION: N: 4,377,488m E: 513,228m

Table listing land parcels A through AA with owner names and acreage. Includes owners like Helen M. Karcinski et al, Rose Enterprises LLC, Waco Oil and Gas Co., Inc., etc.

(NAD) 27 (UTM) ZONE 17 COORDS: WELL 1H TOP HOLE INFORMATION: N: 14,350,278ft E: 1,688,406ft POINT OF ENTRY INFORMATION: N: 14,350,144ft E: 1,687,504ft BOTTOM HOLE INFORMATION: N: 14,361,033ft E: 1,683,768ft

Table with columns: LINE, BEARING, DISTANCE. Lists lines L1 through L12 with bearings and distances.

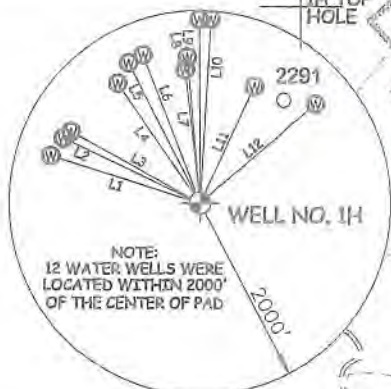
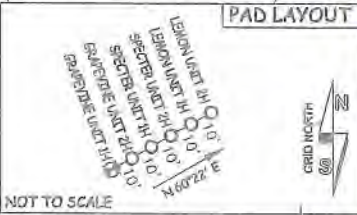

I THE UNDERSIGNED, HEREBY CERTIFY THAT THIS PLAT IS CORRECT TO THE BEST OF MY KNOWLEDGE AND BELIEF AND SHOWS ALL THE INFORMATION REQUIRED BY LAW AND THE RULES ISSUED AND PERSCRIBED BY THE DEPARTMENT OF ENVIRONMENTAL PROTECTION.



STATE OF WEST VIRGINIA, DIVISION OF ENVIRONMENTAL PROTECTION, OFFICE OF OIL AND GAS. WILLLOW LAND SURVEYING PLLC, 220 MASONIC AVE. PENNSBORO WEST VIRGINIA 26415

JOB # 20-006WA, DRAWING # GRAPEVINE1HR3, SCALE 1"=2000', MINIMUM DEGREE OF ACCURACY SUBMETER, PROVEN SOURCE OF ELEV. SUBMETER MAPPING GRADE GPS, STATE OF WEST VIRGINIA DEPARTMENT OF ENERGY DIVISION OF OIL AND GAS

LEGEND: Surface Owner Boundary Lines +/-, Adjoining Surface Tracts +/-, Found monument as noted. Includes signature of Thomas Summers and date 09/29/20.

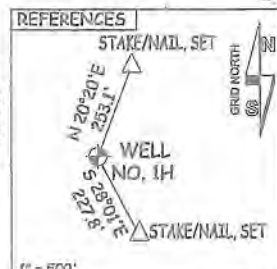
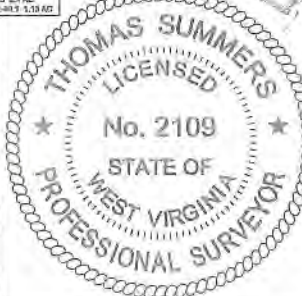

Well information form including: WELL TYPE (Oil, Gas, Liquid Injection), PRODUCTION (Storage, Deep, Shallow), LOCATION (Elevation, Proposed, Watershed, Outlet, Middle Island Creek), QUADRANGLE (Porter Falls 7.5'), SURFACE OWNER (Kayla Leek), OIL & GAS ROYALTY OWNER (Ridgetop Capital LP, David Leek, Richard J. Ferrell, et al), PROPOSED WORK (Drill, Convert, Drill Deeper, Redrill, Fracture or Stimulate, Plug off old formation, Perforate new formation, Other physical change in well), TARGET FORMATION (Marcellus), ESTIMATED DEPTH (7,000' TVD, 21,000' MD), WELL OPERATOR (Antero Resources Corp.), ADDRESS (1615 Wynkoop St., Denver, CO 80202).

8,927' TO BOTTOM HOLE, LONGITUDE 80°47'30", LONGITUDE 80°50'00"