

LATITUDE 39°32'30"

10,768'

LATITUDE 39°35'00"

3,623' TO BOTTOM HOLE

Antero Resources Corporation Well No. Grapevine Unit 1H

Table with 3 columns: LINE, BEARING, DISTANCE. Lists well path coordinates from L1 to L12.

PAD LAYOUT

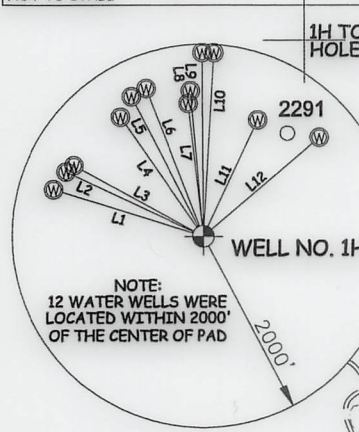
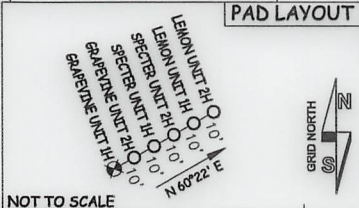

NOTES: WELL 1H TOP HOLE INFORMATION: N: 373,247ft E: 1,624,844ft LAT: 39°31'01.77" LON: 80°49'47.41" BOTTOM HOLE INFORMATION: N: 384,120ft E: 1,620,395ft LAT: 39°32'48.57" LON: 80°50'46.25" WEST VIRGINIA COORDINATE SYSTEM OF 1927 NORTH ZONE...

(NAD) 83 (UTM) ZONE 17 COORDS: WELL 1H TOP HOLE INFORMATION: N: 4,374,191m E: 514,642m BOTTOM HOLE INFORMATION: N: 4,377,481m E: 513,231m

Table listing land parcels A through AA with owner names and acreage.

I THE UNDERSIGNED, HEREBY CERTIFY THAT THIS PLAT IS CORRECT TO THE BEST OF MY KNOWLEDGE AND BELIEF AND SHOWS ALL THE INFORMATION REQUIRED BY LAW AND THE RULES ISSUED AND PERSCRIBED BY THE DEPARTMENT OF ENVIRONMENTAL PROTECTION.



STATE OF WEST VIRGINIA, DIVISION OF ENVIRONMENTAL PROTECTION, OFFICE OF OIL AND GAS. WILLOW LAND SURVEYING PLLC, 220 MASONIC AVE. PENNSBORO WEST VIRGINIA 26415

- List of survey points and bearings: A1-LEE ROY HOWELL, D.B. 170409 TM 11-41 1.87 AC; A2-ROBERT D. MILLER, D.B. 208401 TM 11-42 2.707 AC; etc.

Form with fields for JOB # (20-006WA), DRAWING # (GRAPEVINE1HAD), SCALE (1" = 2000'), MINIMUM DEGREE OF ACCURACY (SUBMETER), PROVEN SOURCE OF ELEV. (SUBMETER MAPPING GRADE GPS), STATE OF WEST VIRGINIA DEPARTMENT OF ENERGY DIVISION OF OIL AND GAS.

LEGEND: Surface Owner Boundary Lines +/-, Interior Surface Tracts +/-, Proposed Well Path, As Drilled Well Path. Includes signature of Douglas R. Rowe, P.S. 2202, DATE 06/09/21, OPERATOR'S WELL # GRAPEVINE UNIT #1H.

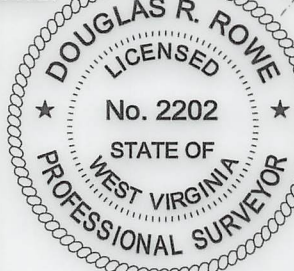

- NOTES: 1. NO OCCUPIED DWELLINGS OR BUILDINGS TWO THOUSAND FIVE HUNDRED (2,500) SQUARE FEET OR LARGER USED TO HOUSE OR SHELTER DAIRY CATTLE OR POULTRY HUSBANDRY ARE LOCATED WITHIN SIX HUNDRED TWENTY-FIVE (625) FEET OF THE CENTER OF THE WELL PAD.

WELL TYPE: OIL GAS X LIQUID INJECTION WASTE DISPOSAL 47 095 02707 (IF "GAS") PRODUCTION X STORAGE DEEP SHALLOW X STATE COUNTY PERMIT LOCATION: ELEVATION 1,042' AS BUILT WATERSHED OUTLET MIDDLE ISLAND CREEK QUADRANGLE PORTER FALLS 7.5' DISTRICT ELLSWORTH COUNTY TYLER SURFACE OWNER KAYLA LEEK ACREAGE 69.06 ACRES +/- OIL & GAS ROYALTY OWNER RIDGETOP CAPITAL LP; DAVID LEEK; RICHARD J. FERRELL ET UX LEASE ACREAGE 69.06 AC +/-; 34.38 AC +/-; 15.08 AC +/-; DAVID LEEK; RICHARD J. FERRELL; ROBERT PITTMAN ET UX; REITA JANE HALL; JERRY R. BRIGHTWELL ET UX; 2.25 AC +/-; 1.69 AC +/-; 2.4 AC +/-; 21.39 AC +/-; 31.74 AC +/-; PATHFINDER RESOURCES II, LLC; DARWIN MARTIN ET UX; RIDGETOP CAPITAL II LP; HELEN M. KARCINSKI ET AL; HELEN M. KARCINSKI ET AL; LINDA K. LOEHR; WACO OIL AND GAS CO., INC; BRC APPALACHIAN MINERALS I LLC 50.5 AC +/-; 24.47 AC +/-; 50.25 AC +/-; 28.77 AC +/- PROPOSED WORK: DRILL CONVERT DRILL DEEPER REDRILL FRACTURE OR STIMULATE PLUG OFF OLD FORMATION PERFORATE NEW FORMATION OTHER PHYSICAL CHANGE IN WELL (SPECIFY) AS DRILLED PLUG & ABANDON CLEAN OUT & REPLUG TARGET FORMATION MARCELLUS ESTIMATED DEPTH 6,535' TVD 18,477' MD WELL OPERATOR ANTERO RESOURCES CORP. DESIGNATED AGENT DIANNA STAMPER - CT CORPORATION SYSTEM ADDRESS 1615 WYNKOOP ST. ADDRESS 5400 D BIG TYLER ROAD FORM WW-6 DENVER, CO 80202 CHARLESTON, WV 25313

13,298' TO BOTTOM HOLE LONGITUDE 80°47'30" LONGITUDE 80°50'00"