

9,154' to Top Hole

11,708' to Bottom Hole

LATITUDE 39 - 27 - 30

LONGITUDE 80 - 57 - 30

# Antero Resources Well No. Hodge Unit 1H

Antero Resources Corporation

Page 1 of 2



Legend	
	Proposed gas well
	Monument, as noted
	Existing Well, as noted
	Digitized Well
	Creek or Drain
	Road
	Surface boundary (approx.)
	Interior surface tracts (approx.)
	District Line

**Notes:**  
West Virginia Coordinate System of 1927, North Zone  
based upon Differential GPS Measurements.  
Well No. Hodge Unit 1H Top Hole coordinates are  
N: 337,924.08'    Latitude: 39°25'05.55"  
E: 1,578,858.84'    Longitude: 80°59'26.65"  
Bottom Hole coordinates are  
N: 351,916.93'    Latitude: 39°27'23.45"  
E: 1,576,531.48'    Longitude: 80°59'59.28"  
**UTM Zone 17, NAD 1983**  
Top Hole Coordinates    Bottom Hole Coordinates  
N: 4,363,195.816m    N: 4,367,446.924m  
E: 500,811.990m    E: 500,031.769m  
Plat orientation and corner and well references are based upon the grid north meridian.  
Well location references are based upon the magnetic meridian.

**Notes:**  
Well No. Hodge Unit 1H  
**UTM Zone 17, NAD 1927**  
Top Hole Coordinates  
N: 14,314,204.91'  
E: 1,643,033.14'  
Point of Entry Coordinates  
N: 14,314,907.67'  
E: 1,645,276.09'  
Bottom Hole Coordinates  
N: 14,328,152.12'  
E: 1,640,473.37'

	Bearing	Dist.
L1	S 87°33' E	439.4'
L2	S 27°26' E	2,236.6'
L3	N 47°13' W	2,524.9'
L4	N 02°13' W	2,178.7'
L5	N 73°34' E	2,351.3'

I, the undersigned, hereby certify that this plat is correct to the best of my knowledge and belief and shows all the information required by law and the rules issued and prescribed by the Department of Environmental Protection.

Bradley D. Miller, P.S. 2167

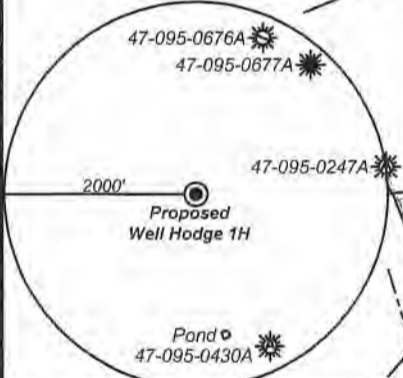
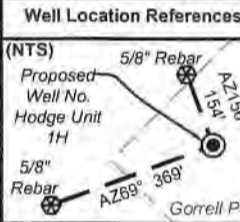
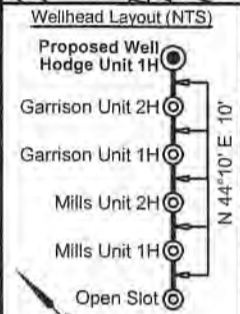

FILE NO: 219-54-M-17  
DRAWING NO: Hodge 1H Well Plat  
SCALE: 1" = 2000'  
MINIMUM DEGREE OF ACCURACY: Submeter  
PROVEN SOURCE OF ELEVATION: WVDOT, Harrisville, WV

**STATE OF WEST VIRGINIA**  
DEPARTMENT OF ENVIRONMENTAL PROTECTION  
**OIL AND GAS DIVISION**

DATE: August 26 20 20  
OPERATOR'S WELL NO. Hodge Unit 1H  
API WELL NO  
47 - 095 - 02711  
STATE COUNTY PERMIT

WELL TYPE:  OIL  GAS  LIQUID INJECTION  WASTE DISPOSAL  
(IF GAS) PRODUCTION:  STORAGE  DEEP  SHALLOW

LOCATION: ELEVATION: As-Built 1045'    WATERSHED: Outlet Middle Island Creek    QUADRANGLE: BTM: Bens Run    Top: Middlebourne  
DISTRICT: Union & Meade    COUNTY: Tyler  
SURFACE OWNER: Elizabeth Gorrell    ACREAGE: 242.5  
ROYALTY OWNER: Elizabeth Gorrell, et al; Kerr-McGee Oil & Gas Onshore LP; Antero Resources Corp.;    LEASE NO:    ACREAGE: 20.41; 62.5; 106.8

PROPOSED WORK:  DRILL  CONVERT  DRILL DEEPER  FRACTURE OR STIMULATE  PLUG OFF OLD FORMATION  
 PERFORATE NEW FORMATION  OTHER PHYSICAL CHANGE IN WELL (SPECIFY) \_\_\_\_\_ 6,700' TVD  
 PLUG AND ABANDON  CLEAN OUT AND REPLUG    TARGET FORMATION: Marcellus Shale    ESTIMATED DEPTH: 23,900' MD

WELL OPERATOR: Antero Resources Corporation    DESIGNATED AGENT: Dianna Stamper - CT Corporation System  
ADDRESS: 1615 Wynkoop Street    ADDRESS: 5400 D Big Tyler Road  
Denver, CO 80202    Charleston, WV 25313



**Antero Resources**  
**Well No. Hodge Unit 1H**

Antero Resources Corporation



Lease
A Elizabeth Gorrell, et al
B Janet Sue Baker
C Mary E. Clymer
D Kerr-McGee Oil & Gas Onshore LP
E Wilma Jane Benefield
F Rita G. Jarvis
G Tony E. & Ellen L. Wince
H Michael A. Domino
I John M. Garrison
J Betty M. Knowlton Starkey
K Charles H. & Deborah L. Weekley
L Ronald Cooper, et ux
M BRC Appalachian Minerals I LLC
N Charles & Deborah Weekley
O The Thelma E. Hadley Testamentary Trust
P RMH Trust
Q Kerr-McGee Oil & Gas Onshore LP
R Roger L. & Dawn E. Billiter
S Ridgewood Development, LLC
T Ridgewood Development, LLC
U Roger Billiter & Dawn E. Billiter
V Ridgewood Development, LLC
W Antero Resources Corp.
X BRC Appalachian Minerals I LLC
Y WV Division of Natural Resources
Z I.L. Morris
AA George E. & Ardele J. Post
AB Geraldine Moses
AC J&N Management Enterprises, LLC

ID	TM/Par	Owner	Bk/Pg	Acres
1	7-15	Elizabeth Gorrell	321/360	242.50
2	7-14	Russell G. & Ruth M. Smith Family Trust	541/608	50.00
3	7-16	Seven Spirits Farms, LLC	381/67	175.11
4	7-10	Michael R. & Linda Fritzsimmmons	336/764	161.63
5	7-5	Coastal Forest Resources Co.	301/131	74.30
6	7-6	Joseph K. Turbish	390/22	75.00
7	4-30	Tony E. & Ellen L. Wince	246/25	97.15
8	4-27	Stanley M. & Shelba J. Shultz	202/438	271.29
9	4-29	Michael A. Domino	378/751	42.73
10	4-24	Betty M. Starkey	263/622	49.24
11	4-23.2	Stanley N. & Shelba J. Shultz and Charles H. & Deborah Weekley	335/958	2.00
12	4-23	Stanley N. & Shelba J. Shultz, and Charles H. & Deborah Weekley	335/958	41.27
13	4-16.1	Charles H. & Deborah L. Weekley	249/627	5.38
14	4-16.2	Ronald & Linda Cooper	362/510	0.55
15	4-23.3	William R. & Ruth R. Erlewine	335/958	17.00
16	4-16	Charles H. & Deborah L. Weekley	248/44	14.45
17	4-15	Sharon O. McGrew	WB14/516	38.66
18	4-14	Roger L. & Dawn Billiter	290/155	26.03
19	4-5	Sharon O. McGrew	WB14/516	31.00
20	4-3.4	Roger L. H. & Dawn Ellen Billiter	369/541	13.50
21	4-3	Janice K. Brooks	521/333	31.71
22	4-3.1	Roger L. H. & Dawn E. Billiter	354/118	7.54
23	4-3.2	Roger L. H. & Dawn Ellen Billiter	334/310	1.87
24	15-38	Roger L. H. & Dawn E. Billiter	340/643	21.00
25	4-2	Flossie Arvilla Cline	AR46/1	33.50
26	15-4	Stephen P. Racer	301/595	60.00
27	1-4	Randall W. & Diane R. Hayes	285/27	28.42
28	13-76	Robert Lawson	359/392	17.50
29	1-1.3	George E. & Ardele J. Post	322/485	15.25
30	13-57	Charles S. Sapp	366/484	1.50
31	13-56	Charles S. Sapp	366/484	0.50
32	13-55.1	Charles S. Sapp	271/309	1.00
33	13-55	Steven P. Racer	213/412	61.50
34	13-74.2	Roger Lee & Sara Lee Hall	358/110	22.48
35	13-74.13	Amanda J. Pardine	390/753	2.20
36	13-74.3	Bobbin E. Pardine	358/115	22.88
37	13-54	Linda L. Jones	304/241	28.0

RECEIVED  
Office of Oil and Gas

SEP 03 2020

WV Department of  
Environmental Protection

FILE NO: 219-54-M-17  
DRAWING NO: Hodge 1H Well Plat  
SCALE: 1" = 2000'  
MINIMUM DEGREE OF ACCURACY:  
Submeter  
PROVEN SOURCE OF ELEVATION:  
WVDOT, Harrisville, WV



DATE: August 26 20 20  
OPERATOR'S WELL NO. Hodge Unit 1H  
API WELL NO  
47 - 095 - 02711  
STATE COUNTY PERMIT

WELL TYPE:  OIL  GAS  LIQUID INJECTION  WASTE DISPOSAL  
(IF GAS) PRODUCTION:  STORAGE  DEEP  SHALLOW

LOCATION: ELEVATION: As-Built 1045' WATERSHED: Outlet Middle Island Creek QUADRANGLE: BTM: Bens Run Top: Middlebourne  
DISTRICT: Union & Meade Ridgewood Development, LLC (2); J&N Management Enterprises, LLC; WV Division of Natural Resources; COUNTY: Tyler 234.74; 185; 201.8;  
SURFACE OWNER: Elizabeth Gorrell Charles & Deborah Weekley; Thelma E. Haley Testamentary Trust; RMH Trust; Roger L. & Dawn E. Billiter; 81; 72.92; 94.35;  
ROYALTY OWNER: Elizabeth Gorrell, et al; Kerr-McGee Oil & Gas Onshore LP; Antero Resources Corp.; LEASE NO: ACREAGE: 242.5 5.4; 166.5625; 42.73;  
PROPOSED WORK:  DRILL  CONVERT  DRILL DEEPER  FRACTURE OR STIMULATE  PLUG OFF OLD FORMATION 78.6625; 25.53;  
 PERFORATE NEW FORMATION  OTHER PHYSICAL CHANGE IN WELL (SPECIFY) ACREAGE: 20.41; 62.5; 106.8  
 PLUG AND ABANDON  CLEAN OUT AND REPLUG TARGET FORMATION: Marcellus Shale ESTIMATED DEPTH: 6,700' TVD 13.5; 93.83; 17.5;  
 CLEAN OUT AND REPLUG TARGET FORMATION: Marcellus Shale ESTIMATED DEPTH: 23,900' MD

WELL OPERATOR: Antero Resources Corporation DESIGNATED AGENT: Dianna Stamper - CT Corporation System  
ADDRESS: 1615 Wynkoop Street ADDRESS: 5400 D Big Tyler Road  
Denver, CO 80202 Charleston, WV 25313