

1,027' to Bottom Hole

Antero Resources
Well No. Wade 1H
BHL MOD
Antero Resources Corporation



Wellhead Layout

- Pechora Unit 2H
47-095-02725
- Pechora Unit 1H
47-095-02724
- Whitmore Unit 2H
47-095-02727
- Whitmore Unit 1H
47-095-02726
- Wade Unit 2H
47-095-02728
Proposed
- Wade Unit 1H
47-095-02729



I, the undersigned, hereby certify that this plat is correct to the best of my knowledge and belief and shows all the information required by law and the rules issued and prescribed by the Department of Environmental Protection.

Bradley D. Miller

Bradley D. Miller, P.S. 2167

Note: 8 water wells and 2 springs were found within 2000' of proposed well. No occupied dwellings or buildings 2,500 square feet or larger used to house or shelter dairy cattle or poultry husbandry are located within 625' of the center of the well pad.

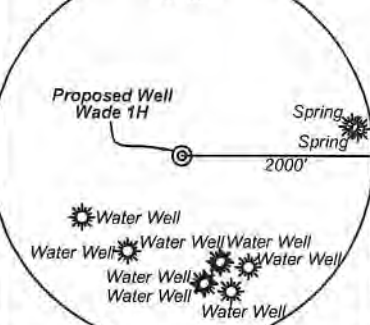

Legend

- Proposed gas well
- Found corner, as noted
- Existing Well, as noted
- Digitized Well
- Existing Road
- Existing Road
- Surface boundary (approx.)
- Interior surface tracts (approx.)

Top Hole 7.5' Spot
5,036' to Top Hole
BTM Hole 7.5' Spot
TOP HOLE LATITUDE 39 - 30 - 30
BTM HOLE LATITUDE 39 - 27 - 30

Notes:

West Virginia Coordinate System of 1927, North Zone based upon Differential GPS Measurements.
Well No. Wade Unit 1H Top Hole coordinates are
N: 366,498.23' Latitude: 39°29'54.17"
E: 1,618,720.00' Longitude: 80°51'04.25"
Bottom Hole coordinates are
N: 350,790.56' Latitude: 39°27'19.49"
E: 1,622,496.29' Longitude: 80°50'13.10"
UTM Zone 17, NAD 1983
Top Hole Coordinates Bottom Hole Coordinates
N: 4,372,104.105m N: 4,367,337.928m
E: 512,810.442m E: 514,040.781m
Plat orientation and corner and well references are based upon the grid north meridian.
Well location references are based upon the magnetic meridian.

Notes:

Well No. Wade Unit 1H
UTM Zone 17, NAD 1927
Top Hole Coordinates
N: 14,343,430.42'
E: 1,682,398.19'
Point of Entry Coordinates
N: 14,343,215.95'
E: 1,681,108.38'
Bottom Hole Coordinates
N: 14,327,793.31'
E: 1,686,434.75'

Well Location References

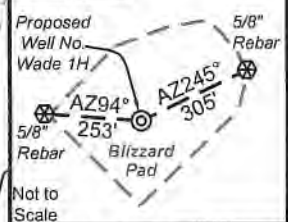

| | Bearing | Dist. |
|----|------------|----------|
| L1 | S 20°26' E | 1,001.4' |
| L2 | N 37°13' W | 1,607.8' |
| L3 | N 41°19' E | 1,121.9' |
| L4 | N 75°05' E | 936.6' |
| L5 | S 81°31' W | 1,308.0' |

FILE NO: 97-54-E-19
DRAWING NO: Wade 1H Well Plat
SCALE: 1" = 2000'
MINIMUM DEGREE OF ACCURACY: Submeter
PROVEN SOURCE OF ELEVATION: WVDOT, Harrisville, WV

STATE OF WEST VIRGINIA
DEPARTMENT OF ENVIRONMENTAL PROTECTION
OIL AND GAS DIVISION

DATE: April 22 20 21
OPERATOR'S WELL NO. Wade 1H
API WELL NO
47 - 095 - 02729
STATE COUNTY PERMIT

WELL TYPE: OIL GAS LIQUID INJECTION WASTE DISPOSAL
(IF GAS) PRODUCTION: STORAGE DEEP SHALLOW

LOCATION: ELEVATION: As-Built 1,004' WATERSHED: Outlet Middle Island Creek QUADRANGLE: Shirley
DISTRICT: Ellsworth COUNTY: Tyler
SURFACE OWNER: Roger D. Blizzard & Ruth E. Spencer
ROYALTY OWNER: Heritage Resources - Marcellus Minerals, LLC; B. Fred Hill Jr.; Keith C. & Phyllis J. Smith. LEASE NO: ACREAGE: 28.009; 168.175; 24;

PROPOSED WORK: DRILL CONVERT DRILL DEEPER FRACTURE OR STIMULATE PLUG OFF OLD FORMATION
 PERFORATE NEW FORMATION OTHER PHYSICAL CHANGE IN WELL (SPECIFY) BHL MOD
 PLUG AND ABANDON CLEAN OUT AND REPLUG TARGET FORMATION: Marcellus Shale ESTIMATED DEPTH: 7,000' TVD 26,100' MD

WELL OPERATOR: Antero Resources Corporation DESIGNATED AGENT: Dianna Stamper - CT Corporation System
ADDRESS: 1615 Wynkoop Street ADDRESS: 5400 D Big Tyler Road
Denver, CO 80202 Charleston, WV 25313

05/28/2021



| Leases | | | |
|--------|---|----|--------------------------------|
| A | Heritage Resources - Marcellus Minerals, LLC | S | Patrick Lewis Smith |
| | | T | WVDNR |
| B | Heritage Resources - Marcellus Minerals, LLC | U | Danny L. & Terri E. Botkins |
| | | V | Lloyd E. & Nancy J. Wade |
| C | B. Fred Hill Jr. | W | James R. Pinney |
| D | Clifford and Virginia Perkins Irrevocable Trust | X | ATX Mineral Holdings, LLC |
| | | Y | Edward H. Estep, et ux |
| E | Carl E. Taylor, et ux | Z | Brian M. Weigle |
| F | The Swan Living Trust | AA | Lloyd Carl Seckman |
| G | Charles T. White Jr. | AB | David E. Bowyer |
| H | Ridgetop Capital II, LP | AC | ATX Mineral Holdings, LLC |
| I | Elmer Earl Bowser Jr. | AD | Brian M. Glover |
| J | Kenneth R. & Jennifer L. Mason | AE | Robert O'Neil Dotson, et ux |
| K | Haessly Land & Timber, LLC | AF | AMP Fund II, LP |
| L | Bradley J. Carpenter | AG | Brian M. Weigle |
| M | WVDNR | AH | Rheba McMichael |
| N | Ronald E. Thompson, et ux | AI | Kenneth R. & Jennifer L. Mason |
| O | Kathy Ann Seago | AJ | Keith C. Smith, et ux |
| P | Roger D. Wade | AK | Keith C. Smith, et ux |
| Q | E. Lorna Howard Testamentary Trust | AL | Mount Aris Cemetery |
| | | AM | Triple Haught Trust |
| R | Alf Smith Cemetery | AN | Ronald L. Hoover, et ux |
| | | AO | WVDNR |

| ID | TM/Par | Owner | DB/PG | Acres |
|----|---------|--|-----------|--------|
| 1 | 15-33 | Roger D. Blizzard & Ruth E. Spencer | 340/170 | 102.62 |
| 2 | 15-30 | Thomas C. & Jeudeann L. Grinage | 458/73 | 124.08 |
| 3 | 15-34 | Michael & Bente H. Biddle | 294/537 | 82.34 |
| 4 | 15-34.1 | Randy & Pamela L. Lancaster | 370/776 | 11.42 |
| 5 | 21-6 | Carl E. & Elsie M. Taylor | 391/181 | 63.50 |
| 6 | 21-7 | Gary O. & Anita K. Bennett | 332 / 605 | 1.75 |
| 7 | 21-14 | Carl E. & Elsie M. Taylor | 391/181 | 67.91 |
| 8 | 21-16 | Stephanie & Joseph W. Havranek | 254/153 | 4.50 |
| 9 | 21-17 | Stephanie & Joseph W. Havranek | 254/153 | 10.38 |
| 10 | 21-18 | Ridgetop Capital II, LP | 385/781 | 83.68 |
| 11 | 21-15 | Stephanie & Joseph W. Havranek | 254/153 | 45.48 |
| 12 | 21-52 | Jennifer L. & Kenneth Mason | 345/743 | 81.0 |
| 13 | 21-53 | Haessly Land & Timber, LLC | 337/101A | 89.88 |
| 14 | 27-10 | Kathy Ann Seago, et al | WB 41/119 | 31.18 |
| 15 | 21-55 | Ronald & Janet Thompson | 400/552 | 12.50 |
| 16 | 21-54 | Sybill Gorby | WB 34/343 | 70.00 |
| 17 | 22-42 | Sharon Christenson, et al | 635/420 | 144.26 |
| 18 | 21-57 | ALF Smith Cemetery | 107/393 | 3.00 |
| 19 | 21-56 | Roger D. Wade | 485/486 | 26.68 |
| 20 | 21-60 | Danny & Terri Botkins | 342/556 | 0.86 |
| 21 | 21-61 | Danny & Terri Botkins | 342/556 | 1.51 |
| 22 | 21-59 | Travis O. Baker | 617/620 | 3.72 |
| 23 | 21-62 | Lewis Timmons Estate | 332/1 | 1.8 |
| 24 | 28-1 | Lois J. Estep & Edward E. Estep | 359/613 | 1.11 |
| 25 | 27-12 | Joan Estep & Edward H. Estep | 556/513 | 0.47 |
| 26 | 27-13 | Joan Estep & Edward H. Estep | 556/513 | 2.40 |
| 27 | 21-56.1 | Nancy Wade | 336/127 | 4.48 |
| 28 | 27-11 | Kathy Ann Seago, et al | WB 41/119 | 35.08 |
| 29 | 28-2 | Mary Ladene Lemasters | 299/548 | 2.37 |
| 30 | 27-14 | James & Naomi Baker | 644/632 | 1.50 |
| 31 | 28-3 | Lloyd C. & Kathen G. Seckman | 184/296 | 2.88 |
| 32 | 28-13 | David E. Bowyer | 481/234 | 3.97 |
| 33 | 27-15 | John Helt | 448/274 | 0.49 |
| 34 | 27-16 | David Newbrough Revocable Family Trust | 369/370 | 0.94 |
| 35 | 28-4.6 | Brian M. Glover | 397/415 | 0.83 |
| 36 | 28-14 | Robert & Sandra Dotson | 213/445 | 0.87 |
| 37 | 27-17 | David & Diana Weekley | 575/9 | 1.94 |
| 38 | 28-10 | Carol Knapp Rev. Trust | 435/461 | 9.20 |
| 39 | 28-17 | Kathy Ann Seago, et al | WB 41/119 | 12.11 |
| 40 | 28-16.1 | Brian Weigle | 353/776 | 2.36 |
| 41 | 28-16 | Kathy Ann Seago, et al | WB 41/119 | 4.54 |
| 42 | 28-15.1 | Keith & Phyllis Smith | 350/565 | 2.40 |
| 43 | 27-19 | Lynda Spellman, et al | 119/512 | 86.00 |
| 44 | 28-15 | Troy & Kelly Smith | 337/393 | 6.60 |
| 45 | 28-25 | Ripley Alma Methodist Church | 199/1 | 0.86 |
| 46 | 28-24 | Mt. Aris Union Church & Cemetery | 246/47 | 0.97 |
| 47 | 27-20 | Kenneth & Jennifer Mason | 332/960 | 269.00 |
| 48 | 28-29 | Keith C. Smith | WB 35/228 | 116.72 |
| 49 | 28-27 | Kenneth & Jennifer Mason | 353/389 | 72.00 |
| 50 | 4-5 | Roger & Sandy Weese | 312/203 | 182.74 |
| 51 | 28-28 | Ronald & Linda Hoover | 184/383 | 136.22 |
| 52 | 2-1 | Larry & Betty Fletcher | 312/200 | 120.00 |
| 53 | 27-16.1 | John Helt | 448/274 | 0.15 |

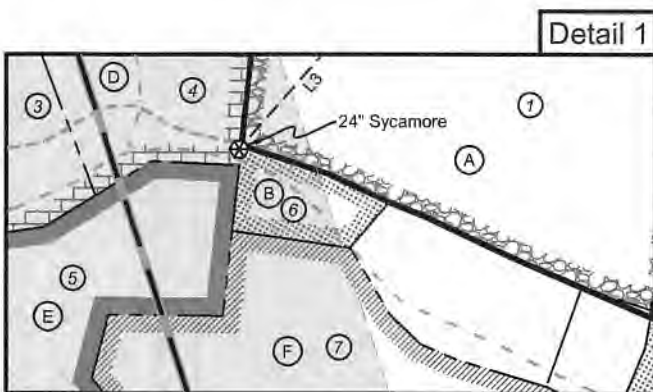

FILE NO: 97-54-E-19
 DRAWING NO: Wade 1H Well Plat
 SCALE: 1" = 2000'
 MINIMUM DEGREE OF ACCURACY:
 Submeter
 PROVEN SOURCE OF ELEVATION:
 WVDOT, Harrisville, WV

STATE OF WEST VIRGINIA
 DEPARTMENT OF ENVIRONMENTAL PROTECTION
OIL AND GAS DIVISION

DATE: April 22, 20 21
 OPERATOR'S WELL NO. Wade 1H
 API WELL NO
 47 - 095 - 02729
 STATE COUNTY PERMIT

WELL TYPE: OIL GAS LIQUID INJECTION WASTE DISPOSAL
 (IF GAS) PRODUCTION: STORAGE DEEP SHALLOW

LOCATION: ELEVATION: As-Built 1,004' WATERSHED: Outlet Middle Island Creek QUADRANGLE: Shirley
 DISTRICT: Ellsworth COUNTY: Tyler
 SURFACE OWNER: Roger D. Blizzard & Ruth E. Spencer ACREAGE: 102.62
 ROYALTY OWNER: Heritage Resources - Marcellus Minerals, LLC; B. Fred Hill Jr.; Keith C. & Phyllis J. Smith; LEASE NO: ACREAGE: 28.009; 168.175; 24;

PROPOSED WORK: DRILL CONVERT DRILL DEEPER FRACTURE OR STIMULATE PLUG OFF OLD FORMATION
 PERFORATE NEW FORMATION OTHER PHYSICAL CHANGE IN WELL (SPECIFY) BHL MOD
 PLUG AND ABANDON CLEAN OUT AND REPLUG TARGET FORMATION: Marcellus Shale ESTIMATED DEPTH: 7,000' TVD
 26,100' MD

WELL OPERATOR: Antero Resources Corporation DESIGNATED AGENT: Dianna Stamper - CT Corporation System
 ADDRESS: 1615 Wynkoop Street ADDRESS: 5400 D Big Tyler Road
 Denver, CO 80202 Charleston, WV 25313

13,8488;
 136.22;102.62;
 119.578; 93.757;
 83.5; 67.90625;
 75.25; 70; 7.94; 12.5;
 26.684; 10.74; 19.46;
 2.4; 6.905; 17.401;
 05/28/2021

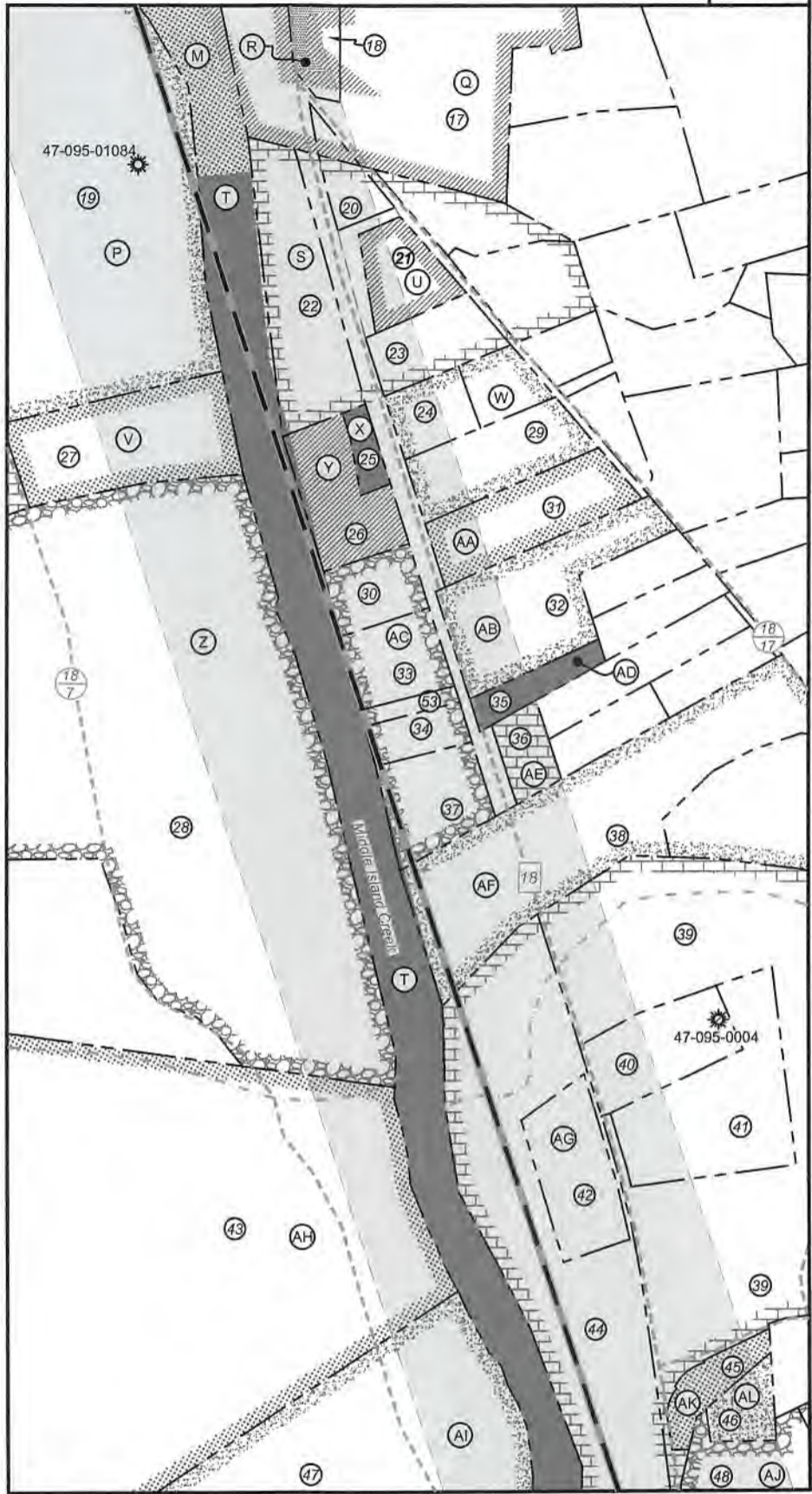

FILE NO: 97-54-E-19
 DRAWING NO: Wade 1H Well Plat
 SCALE: 1" = 2000'
 MINIMUM DEGREE OF ACCURACY:
Submeter
 PROVEN SOURCE OF ELEVATION:
WVDOT, Harrisville, WV

STATE OF WEST VIRGINIA
 DEPARTMENT OF ENVIRONMENTAL PROTECTION
OIL AND GAS DIVISION

DATE: April 22 20 21
 OPERATOR'S WELL NO. Wade 1H
 API WELL NO
47 - 095 - 02729
 STATE COUNTY PERMIT

WELL TYPE: OIL GAS LIQUID INJECTION WASTE DISPOSAL
 (IF GAS) PRODUCTION: STORAGE DEEP SHALLOW

LOCATION: ELEVATION: As-Built 1,004' WATERSHED: Outlet Middle Island Creek QUADRANGLE: Shirley
 DISTRICT: Ellsworth COUNTY: Tyler
 SURFACE OWNER: Roger D. Blizzard & Ruth E. Spencer ACREAGE: 102.62
 ROYALTY OWNER: Heritage Resources - Marcellus Minerals, LLC; B. Fred Hill Jr.; Keith C. & Phyllis J. Smith; LEASE NO: _____ ACREAGE: 28.009; 168.175; 24;
 PROPOSED WORK: DRILL CONVERT DRILL DEEPER FRACTURE OR STIMULATE PLUG OFF OLD FORMATION
 PERFORATE NEW FORMATION OTHER PHYSICAL CHANGE IN WELL (SPECIFY) BHL MOD
 PLUG AND ABANDON CLEAN OUT AND REPLUG TARGET FORMATION: Marcellus Shale ESTIMATED DEPTH: 7,000' TVD; 26,100' MD

WELL OPERATOR: Antero Resources Corporation DESIGNATED AGENT: Dianna Stamper - CT Corporation System
 ADDRESS: 1615 Wynkoop Street ADDRESS: 5400 D Big Tyler Road
Denver, CO 80202 Charleston, WV 25313

13.8488;
 136.22;102.62;
 119.578; 93.757;
 63.5; 67.90625;
 7.525; 7.0; 7.34; 12.5;
 26.684; 10.74; 19.46;
 2.4; 5.905; 17.401;
 28.009; 168.175; 24;

05/28/2021

1,027' to Bottom Hole

Top Hole 7.5' Spot

5,036' to Top Hole

BTM Hole 7.5' Spot

TOP HOLE LATITUDE 39 - 30 - 30
BTM HOLE LATITUDE 39 - 27 - 30

Antero Resources
Well No. Wade 1H
BHL MOD
Antero Resources Corporation



Wellhead Layout

- Pechora Unit 2H 47-095-02725
- Pechora Unit 1H 47-095-02724
- Whitmore Unit 2H 47-095-02727
- Whitmore Unit 1H 47-095-02726
- Wade Unit 2H 47-095-02728
- Proposed Wade Unit 1H 47-095-02729



I, the undersigned, hereby certify that this plat is correct to the best of my knowledge and belief and shows all the information required by law and the rules issued and prescribed by the Department of Environmental Protection.

Bradley D. Miller, P.S. 2187

Note: 8 water wells and 2 springs were found within 2000' of proposed well. No occupied dwellings or buildings 2,500 square feet or larger used to house or shelter dairy cattle or poultry husbandry are located within 625' of the center of the well pad.

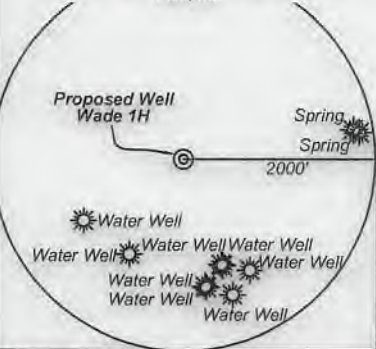

Legend

- Proposed gas well
- Found corner, as noted
- Existing Well, as noted
- Digitized Well
- Existing Road
- Existing Road
- Surface boundary (approx.)
- Interior surface tracts (approx.)

Notes:
West Virginia Coordinate System of 1927, North Zone based upon Differential GPS Measurements.
Well No. Wade Unit 1H Top Hole coordinates are
N: 366,498.23' Latitude: 39°29'54.17"
E: 1,618,720.00' Longitude: 80°51'04.25"
Bottom Hole coordinates are
N: 350,790.56' Latitude: 39°27'19.49"
E: 1,622,496.29' Longitude: 80°50'13.10"
UTM Zone 17, NAD 1983
Top Hole Coordinates Bottom Hole Coordinates
N: 4,372,104.105m N: 4,367,337.928m
E: 512,810.442m E: 514,040.781m
Plat orientation and corner and well references are based upon the grid north meridian.
Well location references are based upon the magnetic meridian.

Notes:
Well No. Wade Unit 1H
UTM Zone 17, NAD 1927
Top Hole Coordinates
N: 14,343,430.42'
E: 1,682,398.19'
Point of Entry Coordinates
N: 14,343,215.95'
E: 1,681,108.38'
Bottom Hole Coordinates
N: 14,327,793.31'
E: 1,686,434.75'

Well Location References

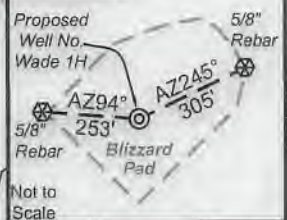

| Bearing | Dist. |
|---------------|----------|
| L1 S 20°26' E | 1,001.4' |
| L2 N 37°13' W | 1,607.8' |
| L3 N 41°19' E | 1,121.9' |
| L4 N 75°05' E | 936.6' |
| L5 S 81°31' W | 1,308.0' |

FILE NO: 97-54-E-19
DRAWING NO: Wade 1H Well Plat
SCALE: 1" = 2000'
MINIMUM DEGREE OF ACCURACY: Submeter
PROVEN SOURCE OF ELEVATION: WVDOT, Harrisville, WV

STATE OF WEST VIRGINIA
DEPARTMENT OF ENVIRONMENTAL PROTECTION
OIL AND GAS DIVISION

DATE: April 22, 20 21
OPERATOR'S WELL NO. Wade 1H
API WELL NO
47 - 095 - 02729
STATE COUNTY PERMIT

WELL TYPE: OIL GAS LIQUID INJECTION WASTE DISPOSAL
(IF GAS) PRODUCTION: STORAGE DEEP SHALLOW

LOCATION: ELEVATION: As-Built 1,004' WATERSHED: Outlet Middle Island Creek QUADRANGLE: Shirley
DISTRICT: Ellsworth COUNTY: Tyler
SURFACE OWNER: Roger D. Blizzard & Ruth E. Spencer ACREAGE: 102.62
ROYALTY OWNER: Heritage Resources - Marcellus Minerals, LLC; B. Fred Hill Jr.; Keith C. & Phyllis J. Smith; LEASE NO: ACREAGE: 28.009; 168.175; 24;

PROPOSED WORK: DRILL CONVERT DRILL DEEPER FRACTURE OR STIMULATE PLUG OFF OLD FORMATION
 PERFORATE NEW FORMATION OTHER PHYSICAL CHANGE IN WELL (SPECIFY) BHL MOD
 PLUG AND ABANDON CLEAN OUT AND REPLUG TARGET FORMATION: Marcellus Shale ESTIMATED DEPTH: 7,000' TVD, 26,100' MD

WELL OPERATOR: Antero Resources Corporation DESIGNATED AGENT: Dianna Stamper - CT Corporation System
ADDRESS: 1615 Wynkoop Street ADDRESS: 5400 D Big Tyler Road
Denver, CO 80202 Charleston, WV 25313

05/28/2021



| Leases | | | |
|--------|---|----|--------------------------------|
| A | Heritage Resources - Marcellus Minerals, LLC | S | Patrick Lewis Smith |
| | | T | WVDNR |
| B | Heritage Resources - Marcellus Minerals, LLC | U | Danny L. & Terri E. Botkins |
| | | V | Lloyd E. & Nancy J. Wade |
| C | B. Fred Hill Jr. | W | James R. Pinney |
| D | Clifford and Virginia Perkins Irrevocable Trust | X | ATX Mineral Holdings, LLC |
| | | Y | Edward H. Estep, et ux |
| E | Carl E. Taylor, et ux | Z | Brian M. Weigle |
| F | The Swan Living Trust | AA | Lloyd Carl Seckman |
| G | Charles T. White Jr. | AB | David E. Bowyer |
| H | Ridgetop Capital II, LP | AC | ATX Mineral Holdings, LLC |
| I | Elmer Earl Bowser Jr. | AD | Brian M. Glover |
| J | Kenneth R. & Jennifer L. Mason | AE | Robert O'Neil Dotson, et ux |
| K | Haessly Land & Timber, LLC | AF | AMP Fund II, LP |
| L | Bradley J. Carpenter | AG | Brian M. Weigle |
| M | WVDNR | AH | Rheba McMichael |
| N | Ronald E. Thompson, et ux | AI | Kenneth R. & Jennifer L. Mason |
| O | Kathy Ann Seago | AJ | Keith C. Smith, et ux |
| P | Roger D. Wade | AK | Keith C. Smith, et ux |
| Q | E. Lorna Howard Testamentary Trust | AL | Mount Aris Cemetery |
| | | AM | Triple Haught Trust |
| R | Alf Smith Cemetery | AN | Ronald L. Hoover, et ux |
| | | AO | WVDNR |

| ID | TM/Par | Owner | DB/PG | Acres |
|----|---------|--|-----------|--------|
| 1 | 15-33 | Roger D. Blizzard & Ruth E. Spencer | 340/170 | 102.62 |
| 2 | 15-30 | Thomas C. & Judeann L. Grinage | 458/73 | 124.08 |
| 3 | 15-34 | Michael & Bente H. Biddle | 294/537 | 82.34 |
| 4 | 15-34.1 | Randy & Pamela L. Lancaster | 370/776 | 11.42 |
| 5 | 21-6 | Carl E. & Elsie M. Taylor | 391/181 | 63.50 |
| 6 | 21-7 | Gary O. & Anita K. Bennett | 332 / 605 | 1.75 |
| 7 | 21-14 | Carl E. & Elsie M. Taylor | 391/181 | 67.91 |
| 8 | 21-16 | Stephanie & Joseph W. Havranek | 254/153 | 4.50 |
| 9 | 21-17 | Stephanie & Joseph W. Havranek | 254/153 | 10.38 |
| 10 | 21-18 | Ridgetop Capital II, LP | 385/781 | 83.68 |
| 11 | 21-15 | Stephanie & Joseph W. Havranek | 254/153 | 45.48 |
| 12 | 21-52 | Jennifer L. & Kenneth Mason | 345/743 | 81.0 |
| 13 | 21-53 | Haessly Land & Timber, LLC | 337/101A | 89.88 |
| 14 | 27-10 | Kathy Ann Seago, et al | WB 41/119 | 31.18 |
| 15 | 21-55 | Ronald & Janet Thompson | 400/552 | 12.50 |
| 16 | 21-54 | Sybil Gorby | WB 34/343 | 70.00 |
| 17 | 22-42 | Sharon Christenson, et al | 635/420 | 144.26 |
| 18 | 21-57 | ALF Smith Cemetery | 107/393 | 3.00 |
| 19 | 21-56 | Roger D. Wade | 485/486 | 26.68 |
| 20 | 21-60 | Danny & Terri Botkins | 342/556 | 0.86 |
| 21 | 21-61 | Danny & Terri Botkins | 342/556 | 1.51 |
| 22 | 21-59 | Travis O. Baker | 617/620 | 3.72 |
| 23 | 21-62 | Lewis Timmons Estate | 332/1 | 1.8 |
| 24 | 28-1 | Lois J. Estep & Edward E. Estep | 359/613 | 1.11 |
| 25 | 27-12 | Joan Estep & Edward H. Estep | 556/513 | 0.47 |
| 26 | 27-13 | Joan Estep & Edward H. Estep | 556/513 | 2.40 |
| 27 | 21-56.1 | Nancy Wade | 336/127 | 4.48 |
| 28 | 27-11 | Kathy Ann Seago, et al | WB 41/119 | 35.08 |
| 29 | 28-2 | Mary Ladene Lemasters | 299/548 | 2.37 |
| 30 | 27-14 | James & Naomi Baker | 644/632 | 1.50 |
| 31 | 28-3 | Lloyd C. & Kathen G. Seckman | 184/296 | 2.88 |
| 32 | 28-13 | David E. Bowyer | 481/234 | 3.97 |
| 33 | 27-15 | John Helt | 448/274 | 0.49 |
| 34 | 27-16 | David Newbrough Revocable Family Trust | 369/370 | 0.94 |
| 35 | 28-4.6 | Brian M. Glover | 397/415 | 0.83 |
| 36 | 28-14 | Robert & Sandra Dotson | 213/445 | 0.87 |
| 37 | 27-17 | David & Diana Weekley | 575/9 | 1.94 |
| 38 | 28-10 | Carol Knapp Rev. Trust | 435/461 | 9.20 |
| 39 | 28-17 | Kathy Ann Seago, et al | WB 41/119 | 12.11 |
| 40 | 28-16.1 | Brian Weigle | 353/776 | 2.36 |
| 41 | 28-16 | Kathy Ann Seago, et al | WB 41/119 | 4.54 |
| 42 | 28-15.1 | Keith & Phyllis Smith | 350/565 | 2.40 |
| 43 | 27-19 | Lynda Spellman, et al | 119/512 | 86.00 |
| 44 | 28-15 | Troy & Kelly Smith | 337/393 | 6.60 |
| 45 | 28-25 | Ripley Alma Methodist Church | 199/1 | 0.86 |
| 46 | 28-24 | Mt. Ans Union Church & Cemetery | 246/47 | 0.97 |
| 47 | 27-20 | Kenneth & Jennifer Mason | 332/960 | 269.00 |
| 48 | 28-29 | Keith C. Smith | WB 35/228 | 116.72 |
| 49 | 28-27 | Kenneth & Jennifer Mason | 353/389 | 72.00 |
| 50 | 4-5 | Roger & Sandy Weese | 312/203 | 182.74 |
| 51 | 28-28 | Ronald & Linda Hoover | 184/383 | 136.22 |
| 52 | 2-1 | Larry & Betty Fletcher | 312/200 | 120.00 |
| 53 | 27-16.1 | John Helt | 448/274 | 0.15 |

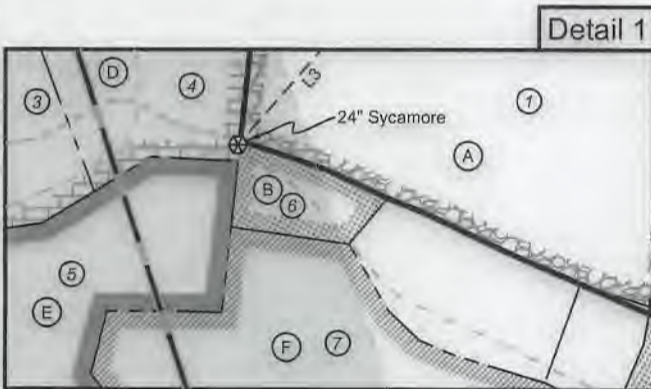

FILE NO: 97-54-E-19
 DRAWING NO: Wade 1H Well Plat
 SCALE: 1" = 2000'
 MINIMUM DEGREE OF ACCURACY:
 Submeter
 PROVEN SOURCE OF ELEVATION:
 WVDOT, Harrisville, WV



DATE: April 22 20 21
 OPERATOR'S WELL NO. Wade 1H
 API WELL NO
 47 - 095 - 02729
 STATE COUNTY PERMIT

WELL TYPE: OIL GAS LIQUID INJECTION WASTE DISPOSAL
 (IF GAS) PRODUCTION: STORAGE DEEP SHALLOW

LOCATION: ELEVATION: As-Built 1,004' WATERSHED: Outlet Middle Island Creek QUADRANGLE: Shirley

DISTRICT: Ellsworth COUNTY: Tyler

SURFACE OWNER: Roger D. Blizzard & Ruth E. Spencer ACREAGE: 102.62

ROYALTY OWNER: Heritage Resources - Marcellus Minerals, LLC, B. Fred Hill Jr., Keith C. & Phyllis J. Smith; LEASE NO: ACREAGE: 28.009; 168.175; 24;

PROPOSED WORK: DRILL CONVERT DRILL DEEPER FRACTURE OR STIMULATE PLUG OFF OLD FORMATION
 PERFORATE NEW FORMATION OTHER PHYSICAL CHANGE IN WELL (SPECIFY) BHL MOD

PLUG AND ABANDON CLEAN OUT AND REPLUG TARGET FORMATION: Marcellus Shale ESTIMATED DEPTH: 7,000' TVD 26,100' MD

WELL OPERATOR: Antero Resources Corporation DESIGNATED AGENT: Dianna Stamper - CT Corporation System
 ADDRESS: 1615 Wynkoop Street ADDRESS: 5400 D Big Tyler Road
 Denver, CO 80202 Charleston, WV 25313

05/28/2021

Antero Resources
Well No. Wade 1H
BHL MOD
Antero Resources Corporation

Detail 2



FILE NO: 97-54-E-19
 DRAWING NO: Wade 1H Well Plat
 SCALE: 1" = 2000'
 MINIMUM DEGREE OF ACCURACY:
 Submeter
 PROVEN SOURCE OF ELEVATION:
 WVDOT, Harrisville, WV

STATE OF WEST VIRGINIA
 DEPARTMENT OF ENVIRONMENTAL PROTECTION
OIL AND GAS DIVISION

DATE: April 22 20 21
 OPERATOR'S WELL NO. Wade 1H
 API WELL NO
 47 - 095 - 02729
 STATE COUNTY PERMIT

WELL TYPE: OIL GAS LIQUID INJECTION WASTE DISPOSAL
 (IF GAS) PRODUCTION: STORAGE DEEP SHALLOW

LOCATION: ELEVATION: As-Built 1,004' WATERSHED: Outlet Middle Island Creek QUADRANGLE: Shirley
 DISTRICT: Ellsworth COUNTY: Tyler
 SURFACE OWNER: Roger D. Blizzard & Ruth E. Spencer
 ROYALTY OWNER: Heritage Resources - Marcellus Minerals, LLC; B. Fred Hill Jr.; Keith C. & Phyllis J. Smith; LEASE NO: ACREAGE: 102.62
 PROPOSED WORK: DRILL CONVERT DRILL DEEPER FRACTURE OR STIMULATE PLUG OFF OLD FORMATION
 PERFORATE NEW FORMATION OTHER PHYSICAL CHANGE IN WELL (SPECIFY) BHL MOD
 PLUG AND ABANDON CLEAN OUT AND REPLUG TARGET FORMATION: Marcellus Shale ESTIMATED DEPTH: 7,000' TVD
 26,100' MD

WELL OPERATOR: Antero Resources Corporation DESIGNATED AGENT: Dianna Stamper - CT Corporation System
 ADDRESS: 1615 Wynkoop Street ADDRESS: 5400 D Big Tyler Road
 Denver, CO 80202 Charleston, WV 25313

05/28/2021