

LATITUDE 39°32'30"

10,543'

LATITUDE 39°32'30"

3,912' TO BOTTOM HOLE

### Antero Resources Corporation Well No. Glamdring Unit 1H

**NOTES:**  
**WELL 1H TOP HOLE INFORMATION:**  
 N: 373,385ft E: 1,625,072ft  
 LAT: 39°31'03.17" LON: 80°49'44.53"  
**BOTTOM HOLE INFORMATION:**  
 N: 360,622ft E: 1,631,520ft  
 LAT: 39°28'57.97" LON: 80°48'19.89"  
 WEST VIRGINIA COORDINATE SYSTEM OF 1927 NORTH ZONE. ZONE WAS DERIVED FROM MEASUREMENTS TAKEN WITH TRIMBLE GEOXT SUBMETER MAPPING GRADE GPS UNIT. PLAT ORIENTATION, CORNER, AND WELL REFERENCE TIE LINES ARE BASED ON GRID NORTH.

**(NAD) 83 (UTM) ZONE 17 COORDS:**  
**WELL 1H TOP HOLE INFORMATION:**  
 N: 4,374,235m E: 514,710m  
**BOTTOM HOLE INFORMATION:**  
 N: 4,370,379m E: 516,740m

#### PAD LAYOUT NOT TO SCALE

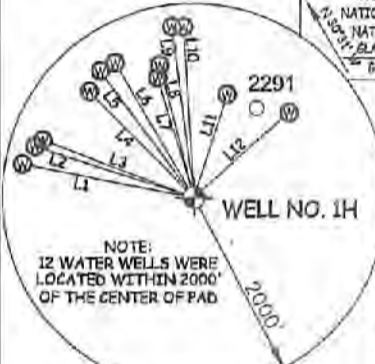
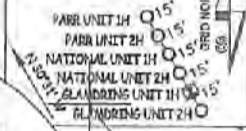

NOTE:  
12 WATER WELLS WERE LOCATED WITHIN 2000' OF THE CENTER OF PAD

LINE	BEARING	DIST.	LINE	BEARING	DIST.
L1	N 79°23' W	1820.64'	L7	N 17°11' W	1289.39'
L2	N 72°38' W	1737.73'	L8	N 14°44' W	1409.38'
L3	N 69°39' W	1680.54'	L9	N 07°39' W	1774.92'
L4	N 49°05' W	1540.95'	L10	N 03°37' W	1761.12'
L5	N 36°53' W	1627.55'	L11	N 17°55' E	1113.35'
L6	N 30°40' W	1612.05'	L12	N 48°24' E	1322.09'

I, THE UNDERSIGNED, HEREBY CERTIFY THAT THIS PLAT IS CORRECT TO THE BEST OF MY KNOWLEDGE AND BELIEF AND SHOWS ALL THE INFORMATION REQUIRED BY LAW AND THE RULES ISSUED AND PERSCRIBED BY THE DEPARTMENT OF ENVIRONMENTAL PROTECTION.



STATE OF WEST VIRGINIA, DIVISION OF ENVIRONMENTAL PROTECTION, OFFICE OF OIL AND GAS  
 WILLOW LAND SURVEYING PLLC  
 220 MASONIC AVE. PENNSBORO WEST VIRGINIA 26415

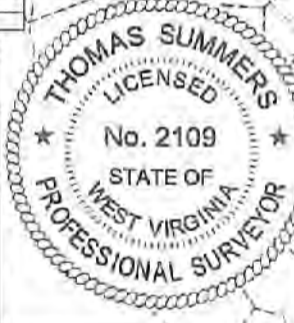

JOB # 21-008WA  
 DRAWING # GLAMDING1HR  
 SCALE 1" = 2000'  
 MINIMUM DEGREE OF ACCURACY SUBMETER  
 PROVEN SOURCE OF ELFV. SUBMETER MAPPING GRADE GPS  
 STATE OF WEST VIRGINIA DEPARTMENT OF ENERGY DIVISION OF OIL AND GAS

**LEGEND**  
 — Surface Owner Boundary Lines +/-  
 - - - Adjoining Surface Tracts +/-  
 ⊕ Found monument, as noted  
 THOMAS SUMMERS P.S. 2109  
 DATE 08/23/21  
 OPERATOR'S WELL# GLAMDING UNIT #1H

WELL TYPE: OIL \_\_\_ GAS X LIQUID INJECTION \_\_\_ WASTE DISPOSAL \_\_\_ API WELL # 47 - 095 - 02742  
 (IF "GAS") PRODUCTION X STORAGE \_\_\_ DEEP \_\_\_ SHALLOW X STATE COUNTY PERMIT  
 LOCATION: ELEVATION AS BUILT - 1,041' WATERSHED OUTLET MIDDLE ISLAND CREEK  
 QUADRANGLE PORTER FALLS 7.5' DISTRICT ELLSWORTH COUNTY TYLER  
 SURFACE OWNER KAYLA LEEK ACREAGE 69.06 ACRES +/-  
 OIL & GAS ROYALTY OWNER RIDGETOP CAPITAL LP; RIDGETOP CAPITAL IV LP; LEASE ACREAGE 69.06 AC.±; 43.5 AC.±;  
 RIDGETOP CAPITAL IV LP; DOUGLAS SCOTT FUNK, SR.; ANTERO RESOURCES CORP.; JOHN E. VALENTOUR ET UX; 16.5 AC.±; 10 AC.±; 40 AC.±; 80 AC.±;  
 BRC APPALACHIAN MINERALS I LLC; S.A. SMITH & C.B. MORRIS HEIRS TRUST; BRC APPALACHIAN MINERALS I LLC; 55.13 AC.±; 304.5 AC.±; 10.10 AC.±; 2024  
 BOUNTY MINERALS LLC; BETTY MOREHEAD ET VIR; DAVID E. BOWYER; LAURA MAY; BRENDA CUIIC; KAREN J. WOLF 82.25 AC.±; 68.88 AC.±; 75 AC.±; 48.37 AC.±; 114 AC.±; 28.28 AC.±  
 PROPOSED WORK: DRILL \_\_\_ CONVERT \_\_\_ DRILL DEEPER X REDRILL \_\_\_ FRACTURE OR STIMULATE X  
 PLUG OFF OLD FORMATION \_\_\_ PERFORATE NEW FORMATION \_\_\_ OTHER PHYSICAL CHANGE IN WELL  
 (SPECIFY) MOD-BHL PLUG & ABANDON CLEAN OUT & REPLUG  
 TARGET FORMATION MARCELLUS ESTIMATED DEPTH 7,100' TVD 24,100' MD  
 WELL OPERATOR ANTERO RESOURCES CORP. DESIGNATED AGENT DIANNA STAMPER - CT CORPORATION SYSTEM  
 ADDRESS 1615 WYNKOOP ST. ADDRESS 5400 D BIG TYLER ROAD  
 FORM WW-6 DENVER, CO 80202 CHARLESTON, WV 25313

Ellsworth District - Tyler County	
11-51	Bear Knob Holdings LLC
16-0	David Leek
16-5.1	Richard Ferrall
16-6	Kayla Leek
16-7	John Thomas
16-7.1	Lianne Wilson
16-8	Juan Neal Et Al
16-9	Bear Knob Holdings LLC
16-10	Juan Neal Et Al
16-11	Juan Neal Et Al
16-15	Harvey Miller Et Al
16-16	Harvey Miller Et Al
16-16.1	Barbara Kirtle
16-17	Alfred Steele
16-18	Juan Neal Et Al
16-19	Juan Neal Et Al
16-20	Juan Neal Et Al
16-21	Kayla Leek
16-24	James Eastham
16-25	Nancy Fowler
16-26	Barbara Kirtle
16-27	Gilbert Eddy
16-28	Kenneth Tomblin Et Al
16-36	George Korbetta
16-37	Roseella Murner
16-38	EQT Production Company
16-39	Richard Pyles
16-39.1	Len Wilter
16-40	Gary Weakley
16-42	Richard Pyles
16-42.3	Richard Pyles
16-55	Ameria Energy Marcellus Minerals LLC
22-6	EQT Production Company
22-7	Kenneth Baker
22-8	EQT Production Company
22-9	Steven Wright
22-10	Leslie Henderson
22-13	Debra Blake
22-14	Leslie Weakley
22-15	Lannie Wade Et Al
22-16	Darlene Stephens
22-16.1	Juan McSwain
22-16.2	Samh Bassett

NOTE  
NO OCCUPIED DWELLINGS OR BUILDINGS TWO THOUSAND FIVE HUNDRED (2,500) SQUARE FEET OR LARGER USED TO HOUSE OR SHELTER DAIRY CATTLE OR POULTRY HUSBANDRY ARE LOCATED WITHIN SIX HUNDRED TWENTY-FIVE (625) FEET OF THE CENTER OF THE WELL PAD.

6,276' TO BOTTOM HOLE  
 LONGITUDE 80°47'30"  
 LONGITUDE 80°47'30"

8,785'  
 COUNTY TYLER PERMIT