

LATITUDE 39°32'30"

10,558'

LATITUDE 39°32'30"

5,399' TO BOTTOM HOLE

Antero Resources Corporation Well No. National Unit 1H

NOTES:
WELL 1H TOP HOLE INFORMATION:
 N: 373,411ft E: 1,625,056ft
 LAT: 39°31'03.42" LON: 80°49'44.73"
BOTTOM HOLE INFORMATION:
 N: 359,826ft E: 1,630,021ft
 LAT: 39°28'49.89" LON: 80°48'38.85"
 WEST VIRGINIA COORDINATE SYSTEM OF 1927 NORTH ZONE. ZONE WAS DERIVED FROM MEASUREMENTS TAKEN WITH TRIMBLE 6EOXT SUBMETER MAPPING GRADE GPS UNIT. PLAT ORIENTATION, CORNER, AND WELL REFERENCE TIE LINES ARE BASED ON GRID NORTH.

(NAD) 83 (UTM) ZONE 17 COORDS:
WELL 1H TOP HOLE INFORMATION:
 N: 4,374,242m E: 514,706m
BOTTOM HOLE INFORMATION:
 N: 4,370,129m E: 516,287m

PAD LAYOUT

NOT TO SCALE



22-16.3	Charles Stevens
22-17	Dorothy Stevens Revocable Trust
22-18	Clara Baker
22-18.1	Dorothy Stevens Revocable Trust
22-21	Paul Baker
22-22	Paul Baker
22-23	Anthony Parr
22-23.1	Raymond Parr
22-23.2	Anthony Parr
22-24	Ruth Weekley Est.
22-25	Paul Baker
22-26	John Sole
22-27	Carol Knapp Revocable Trust
22-28	WSD Properties LLC
22-29	WSD Properties LLC
22-30	WSD Properties LLC
22-31	Richard Gradsky Et Al
22-32	Richard Gradsky Et Al
22-33	Wilma Weekley
22-34	Raymond Parr Et Al
22-38	Bruce Parr
22-40	Ronald Webb

LINE	BEARING	DIST.	LINE	BEARING	DIST.
L1	N 79°23' W	1820.64' L7	N 17°11' W	1289.39'	
L2	N 72°38' W	1737.73' L8	N 14°44' W	1409.38'	
L3	N 69°39' W	1680.54' L9	N 07°35' W	1774.82'	
L4	N 45°05' W	1540.95' L10	N 03°37' W	1761.12'	
L5	N 36°53' W	1627.55' L11	N 17°55' E	1113.36'	
L6	N 30°40' W	1612.05' L12	N 48°24' E	1322.09'	

I, THE UNDERSIGNED, HEREBY CERTIFY THAT THIS PLAT IS CORRECT TO THE BEST OF MY KNOWLEDGE AND BELIEF AND SHOWS ALL THE INFORMATION REQUIRED BY LAW AND THE RULES ISSUED AND PRESCRIBED BY THE DEPARTMENT OF ENVIRONMENTAL PROTECTION.



STATE OF WEST VIRGINIA, DIVISION OF ENVIRONMENTAL PROTECTION, OFFICE OF OIL AND GAS
 WILLOW LAND SURVEYING PLLC
 220 MASONIC AVE. PENNSBORO WEST VIRGINIA 26415

JOB # 21-007WA
 DRAWING # NATIONAL 1H
 SCALE 1" = 2000'
 MINIMUM DEGREE OF ACCURACY SUBMETER
 PROVEN SOURCE OF ELEV. SUBMETER MAPPING GRADE GPS

LEGEND
 - - - Surface Owner Boundary Lines +/-
 - - - Adjoining Surface Tracts +/-
 ⊕ Found monument, as noted

Thomas Summers
 THOMAS SUMMERS P.S. 2109

STATE OF WEST VIRGINIA DEPARTMENT OF ENERGY DIVISION OF OIL AND GAS

DATE 08/23/21
 OPERATOR'S WELL# NATIONAL UNIT#1H

WELL TYPE: OIL ___ GAS X LIQUID INJECTION ___ WASTE DISPOSAL ___ API WELL # 47 - 095 - 02744
 (IF "GAS") PRODUCTION X STORAGE ___ DEEP ___ SHALLOW X STATE COUNTY PERMIT
 LOCATION: ELEVATION AS BUILT - 1,041' WATERSHED OUTLET MIDDLE ISLAND CREEK
 QUADRANGLE PORTER FALLS 7.5' DISTRICT ELLSWORTH COUNTY TYLER

SURFACE OWNER KAYLA LEEK ACREAGE 69.06 ACRES +/-
 OIL & GAS ROYALTY OWNER RIDGETOP CAPITAL LP; BRC APPALACHIAN MINERALS I LLC; LEASE ACREAGE 69.06 AC. ±; 373.47 AC. ±;
 BOUNTY MINERALS LLC; ROSELLA MAY MURNER SHEPHERD; 92.25 AC. ±; 30 AC. ±; 10/01/2021
 BRC APPALACHIAN MINERALS I LLC; KAY F. HAIN REVOCABLE LIVING TRUST; DAVID E. BOWYER; DAVID E. BOWYER; 35 AC. ±; 37 AC. ±; 60 AC. ±; 75 AC. ±;
 BRENDA CUIC; CLARA SUE BAKER; PAUL RICHARD BAKER 114 AC. ±; 13.56 AC. ±; 39.96 AC. ±;

PROPOSED WORK: DRILL ___ CONVERT ___ DRILL DEEPER X REDRILL ___ FRACTURE OR STIMULATE X
 PLUG OFF OLD FORMATION ___ PERFORATE NEW FORMATION ___ OTHER PHYSICAL CHANGE IN WELL
 (SPECIFY) MOD-BHL PLUG & ABANDON CLEAN OUT & REPLUG
 TARGET FORMATION MARCELLUS ESTIMATED DEPTH 7,100' TVD 22,800' MD
 WELL OPERATOR ANTERO RESOURCES CORP. DESIGNATED AGENT DIANNA STAMPER - CT CORPORATION SYSTEM
 ADDRESS 1615 WYNKOOP ST. ADDRESS 5400 D BIG TYLER ROAD
 FORM WW-6 DENVER, CO 80202 ADDRESS CHARLESTON, WV 25313

Ellsworth District - Tyler County	
11-01	Bear Knob Holdings LLC
16-5	David Leek
16-8.1	Richard Ferrell
16-6	Kayla Leek
16-7	John Thomas
16-7.1	Lianne Wilson
16-8	Jean Neel Et Al
16-9	Bear Knob Holdings LLC
16-10	Jean Neel Et Al
16-11	Jean Neel Et Al
16-15	Harvey Miller Et Al
16-16	Harvey Miller Et Al
16-16.1	Barbara Kittle
16-17	Alfred Steele
16-18	Alfred Steele
16-19	Jean Neel Et Al
16-20	Jean Neel Et Al
16-21	Kayla Leek
16-24	James Eastham
16-25	Nancy Fowler
16-26	Barbara Kittle
16-27	Gilbert Eddy
16-28	Kenneth Tomblin Et Al
16-36	George Harbette
16-37	Rosella Murner
16-38	EQT Production Company
16-39	Richard Pyles
16-39.1	Leo Wilker
16-40	Gary Weekley
16-42	Richard Pyles
16-42.3	Richard Pyles
16-58	American Energy Minerals LLC
22-6	EQT Production Company
22-7	Kenneth Baker
22-8	EQT Production Company
22-9	Steven Wright
22-10	Leslie Henderson
22-13	Debra Blake
22-14	Leslie Weekley
22-15	Lannie Wade Et Al
22-16	Darlene Stephens
22-16.1	Jean McSwain
22-16.2	Sarah Bassett

NOTE: NO OCCUPIED DWELLINGS OR BUILDINGS TWO THOUSAND FIVE HUNDRED (2000) SQUARE FEET OR LARGER USED TO HOUSE OR SHELTER DAIRY CATTLE OR PASTURE HUSBANDRY ARE LOCATED WITHIN SIX HUNDRED TWENTY-FIVE (625) FEET OF THE CENTER OF THE WELL PAD.

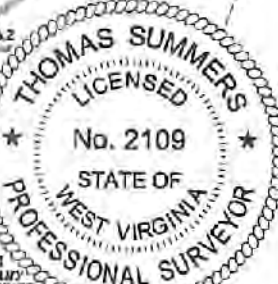

REFERENCES
 STAKE/NAIL, SET
 N 57°59' W 210.7'
 S 15°17' W 280.7'
 WELL NO. 1H
 STAKE/NAIL, SET
 1" = 500'

7,094' TO BOTTOM HOLE
 LONGITUDE 80°47'30"
 LONGITUDE 80°47'30"

COUNTY NAME PERMIT