

LATITUDE 39°32'30"

10,550'

LATITUDE 39°32'30"

4,690' TO BOTTOM HOLE

Antero Resources Corporation Well No. National Unit 2H

AS DRILLED DATA:
WELL 2H TOP HOLE INFORMATION:
 N: 373,398ft E: 1,625,064ft
 LAT: 39°31'03.30" LON: 80°49'44.63"
BOTTOM HOLE INFORMATION:
 N: 360,247ft E: 1,630,735ft
 LAT: 39°28'54.14" LON: 80°48'29.82"
 WEST VIRGINIA COORDINATE SYSTEM OF 1927 NORTH ZONE. ZONE WAS DERIVED FROM MEASUREMENTS TAKEN WITH TRIMBLE GEOXT SUBMETER MAPPING GRADE GPS UNIT. PLAT ORIENTATION, CORNER, AND WELL REFERENCE TIE LINES ARE BASED ON GRID NORTH.

(NAD) 83 (UTM) ZONE 17 COORDS:
WELL 2H TOP HOLE INFORMATION:
 N: 4,374,239m E: 514,708m
BOTTOM HOLE INFORMATION:
 N: 4,370,261m E: 516,503m

PAD LAYOUT NOT TO SCALE

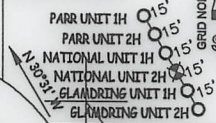

2H TOP HOLE

22-16.3	Charles Stevens
22-17	Dorothy Stevens Revocable Trust
22-18	Clara Baker
22-18.1	Dorothy Stevens Revocable Trust
22-21	Paul Baker
22-22	Paul Baker
22-23	Anthony Parr
22-23.1	Raymond Parr
22-23.2	Anthony Parr
22-24	Ruth Weekley Est.
22-25	Paul Baker
22-26	John Sale
22-27	Carol Knapp Revocable Trust
22-28	WSD Properties LLC
22-29	WSD Properties LLC
22-30	WSD Properties LLC
22-31	Richard Grodsky Et Al
22-32	Richard Grodsky Et Al
22-33	Wilma Weekley
22-34	Raymond Parr Et Al
22-38	Bruce Parr
22-40	Ronald Webb

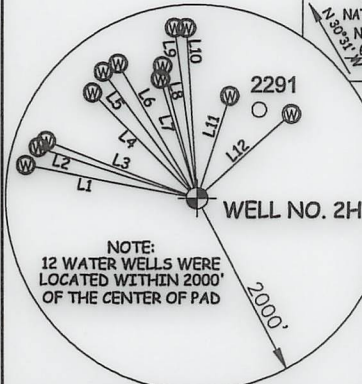

NOTE:
12 WATER WELLS WERE LOCATED WITHIN 2000' OF THE CENTER OF PAD

LINE	BEARING	DIST.	LINE	BEARING	DIST.
L1	N 79°23' W	1820.64'	L7	N 17°11' W	1289.39'
L2	N 72°38' W	1737.73'	L8	N 14°44' W	1409.38'
L3	N 69°39' W	1680.54'	L9	N 07°35' W	1774.82'
L4	N 45°05' W	1540.95'	L10	N 03°37' W	1761.12'
L5	N 36°53' W	1627.55'	L11	N 17°55' E	1113.36'
L6	N 30°40' W	1612.05'	L12	N 48°24' E	1322.09'

I THE UNDERSIGNED, HEREBY CERTIFY THAT THIS PLAT IS CORRECT TO THE BEST OF MY KNOWLEDGE AND BELIEF AND SHOWS ALL THE INFORMATION REQUIRED BY LAW AND THE RULES ISSUED AND PERSCRIBED BY THE DEPARTMENT OF ENVIRONMENTAL PROTECTION.



STATE OF WEST VIRGINIA, DIVISION OF ENVIRONMENTAL PROTECTION, OFFICE OF OIL AND GAS

WILLOW LAND SURVEYING PLLC
220 MASONIC AVE. PENNSBORO WEST VIRGINIA 26415

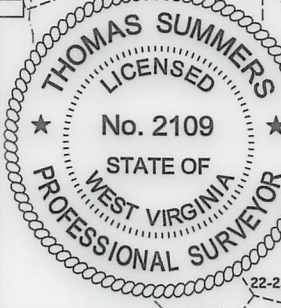

JOB # 21-007WA
DRAWING # NATIONAL2HAD
SCALE 1" = 2000'
MINIMUM DEGREE OF ACCURACY SUBMETER
PROVEN SOURCE OF ELEV. SUBMETER MAPPING GRADE GPS

LEGEND
 - - - - - Surface Owner Boundary Lines +/-
 - - - - - Interior Surface Tracts +/-
 ○ Proposed Well Path
 ⊗ As Drilled Well Path

Thomas Summers
THOMAS SUMMERS P.S. 2109

STATE OF WEST VIRGINIA DEPARTMENT OF ENERGY DIVISION OF OIL AND GAS

DATE 04/07/22
OPERATOR'S WELL # NATIONAL UNIT #2H

WELL 2H POINT OF ENTRY INFORMATION:
 WV STATE PLANE NAD '27 (NORTH ZONE):
 N: 373,658ft E: 1,626,282ft
 GEOGRAPHIC (NAD) 27:
 LAT: 39°31'06.04" LON: 80°49'29.13"
 (NAD) 83 (UTM) ZONE 17 COORDS:
 N: 4,374,324m E: 515,078m

- NOTES**
1. NO OCCUPIED DWELLINGS OR BUILDINGS TWO THOUSAND FIVE HUNDRED (2,500) SQUARE FEET OR LARGER USED TO HOUSE OR SHELTER DAIRY CATTLE OR POULTRY HUSBANDRY ARE LOCATED WITHIN SIX HUNDRED TWENTY-FIVE (625) FEET OF THE CENTER OF THE WELL PAD.
 2. TOP HOLE DATA SHOWN HEREON WAS PROVIDED BY ANTERO RESOURCES CORPORATION.
 3. AS DRILLED DATA WAS PROVIDED BY ANTERO RESOURCES CORPORATION.
 4. WLS IS NOT CERTIFYING THE DATA AND INFORMATION PROVIDED LISTED IN NOTES 2 AND 3, ONLY THE RELATIONSHIP TO THE DATA AND INFORMATION PROVIDED TO THE LEASE BOUNDARIES.
 5. WLS IS BY NO MEANS RESPONSIBLE FOR ANY ERRORS OR INACCURACIES WITH THE DATA AND INFORMATION THAT HAS BEEN PROVIDED.

WELL TYPE: OIL GAS LIQUID INJECTION WASTE DISPOSAL API WELL # 47 - 095 - 02745
 (IF "GAS") PRODUCTION STORAGE DEEP SHALLOW
 LOCATION: ELEVATION AS BUILT - 1,040' WATERSHED OUTLET MIDDLE ISLAND CREEK STATE COUNTY PERMIT

QUADRANGLE PORTER FALLS 7.5' DISTRICT ELLSWORTH COUNTY TYLER

SURFACE OWNER KAYLA LEEK ACREAGE 69.06 ACRES +/-
 OIL & GAS ROYALTY OWNER RIDGETOP CAPITAL LP; BRC APPALACHIAN MINERALS I LLC; LEASE ACREAGE 69.06 AC.±; 373.47 AC.±;
 BRC APPALACHIAN MINERALS I LLC; BOUNTY MINERALS LLC; S.A. SMITH & C.B. MORRIS HEIRS TRUST; 55.13 AC.±; 92.25 AC.±; 304.5 AC.±;
 BRC APPALACHIAN MINERALS I LLC; DAVID E. BOWYER; DAVID E. BOWYER; 35 AC.±; 60 AC.±; 75 AC.±;
 BRENDA CUIC; BETTY MOREHEAD ET VIR; PAUL RICHARD BAKER 114 AC.±; 68.88 AC.±; 39.96 AC.±;

PROPOSED WORK: DRILL CONVERT DRILL DEEPER REDRILL FRACTURE OR STIMULATE
 PLUG OFF OLD FORMATION PERFORATE NEW FORMATION OTHER PHYSICAL CHANGE IN WELL (SPECIFY) AS DRILLED PLUG & ABANDON CLEAN OUT & REPLUG
 TARGET FORMATION MARCELLUS ESTIMATED DEPTH 6,658' TVD 21,151' MD
 WELL OPERATOR ANTERO RESOURCES CORP. DESIGNATED AGENT DIANNA STAMPER - CT CORPORATION SYSTEM
 ADDRESS 1615 WYNKOOP ST. ADDRESS 5400 D BIG TYLER ROAD
 FORM WW-6 DENVER, CO 80202 CHARLESTON, WV 25313

Ellsworth District - Tyler County	
11-51	Bear Knob Holdings LLC
16-5	David Leek
16-5.1	Richard Ferrell
16-6	Kayla Leek
16-7	John Thomas
16-7.1	Lianne Wilson
16-8	Jean Neel Et Al
16-9	Bear Knob Holdings LLC
16-10	Jean Neel Et Al
16-11	Jean Neel Et Al
16-15	Harvey Miller Et Al
16-16	Harvey Miller Et Al
16-16.1	Barbara Kittle
16-17	Alfred Steele
16-18	Alfred Steele
16-19	Jean Neel Et Al
16-20	Jean Neel Et Al
16-21	Kayla Leek
16-24	James Eastham
16-25	Nancy Fowler
16-26	Barbara Kittle
16-27	Gilbert Eddy
16-28	Kenneth Tomblin Et Al
16-36	George Karabetis
16-37	Rosella Murner
16-38	EQT Production Company
16-39	Richard Pyles
16-39.1	Leo Wiker
16-40	Gary Weekley
16-42	Richard Pyles
16-42.3	Richard Pyles
16-58	American Energy Marcellus Minerals LLC
22-6	EQT Production Company
22-7	Kenneth Baker
22-8	EQT Production Company
22-9	Steven Wright
22-10	Leslie Henderson
22-13	Debra Blake
22-14	Leslie Weekley
22-15	Lannie Wade Et Al
22-16	Darlene Stephens
22-16.1	Joann McSwegin
22-16.2	Sarah Bassett

6,653' TO BOTTOM HOLE
8,773'
LONGITUDE 80°47'30"
LONGITUDE 80°47'30"

COUNTY TYLER
NAME
PERMIT