

LATITUDE 39°32'30"

5,428'

LATITUDE 39°30'00" 1,539' TO BOTTOM HOLE

### Antero Resources Corporation Well No. Toroweap 1H

**AS DRILLED DATA:**  
**WELL 1H TOP HOLE INFORMATION:**  
 N: 369,695ft E: 1,630,134ft  
 LAT: 39°30'27.44" LON: 80°48'39.25"  
**BOTTOM HOLE INFORMATION:**  
 N: 358,696ft E: 1,633,865ft  
 LAT: 39°28'39.26" LON: 80°47'49.62"  
 WEST VIRGINIA COORDINATE SYSTEM OF 1927 NORTH ZONE. ZONE WAS DERIVED FROM MEASUREMENTS TAKEN WITH TRIMBLE GEOXT SUBMETER MAPPING GRADE GPS UNIT. PLAT ORIENTATION, CORNER, AND WELL REFERENCE TIE LINES ARE BASED ON GRID NORTH.

**(NAD) 83 (UTM) ZONE 17 COORDS:**  
**WELL 1H TOP HOLE INFORMATION:**  
 N: 4,373,136m E: 516,271m  
**BOTTOM HOLE INFORMATION:**  
 N: 4,369,804m E: 517,464m

WV NORTH ZONE GRID NORTH

Ellsworth District - Tyler County	
16-14	James Barnhart
16-15	Harvey Miller Et Al
16-28	Kenneth Tomblin Et Al
16-29	Michael Tomblin
16-30	Christopher Investments Inc.
16-31	Christopher Investments Inc.
16-33	J. A. Weekley Hrs.
16-34	J. A. Weekley Hrs.
16-35	Jay Wright
17-56	J. A. Weekley Hrs.
22-9	Steven Wright
22-10	Leslie Henderson
22-11	Angela DeGuelle
22-13	Christopher Blake
22-14	Susan Delsordo
22-14.1	Sheryl Hayes
22-27	C. W. Weekley Hrs.
22-28	WSD Properties LLC
23-02	Dale Parr
23-03	Jack Hair
23-04	Jack Hair
McElroy District - Tyler County	
2-01	Jack Hair
2-02	Jack Hair
2-15	Leo Wiker
2-28	Jay Bee Oil & Gas Inc.
2-29	Cecil Nichols

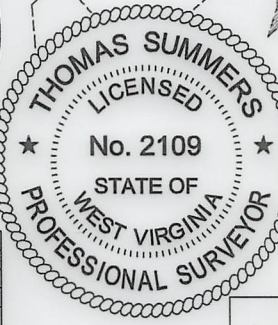
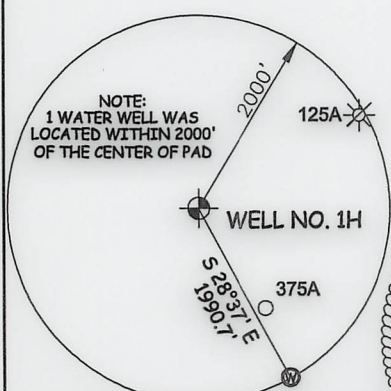

LINE	BEARING	DIST.	LINE	BEARING	DIST.
L1	N 79°23' W	1820.64'	L7	N 17°11' W	1289.39'
L2	N 72°38' W	1737.73'	L8	N 14°44' W	1409.38'
L3	N 69°39' W	1680.54'	L9	N 07°35' W	1774.82'
L4	N 45°05' W	1540.95'	L10	N 03°37' W	1761.12'
L5	N 36°53' W	1627.55'	L11	N 17°55' E	1113.36'
L6	N 30°40' W	1612.05'	L12	N 48°24' E	1322.09'

I THE UNDERSIGNED, HEREBY CERTIFY THAT THIS PLAT IS CORRECT TO THE BEST OF MY KNOWLEDGE AND BELIEF AND SHOWS ALL THE INFORMATION REQUIRED BY LAW AND THE RULES ISSUED AND PERSCRIBED BY THE DEPARTMENT OF ENVIRONMENTAL PROTECTION.



STATE OF WEST VIRGINIA, DIVISION OF ENVIRONMENTAL PROTECTION, OFFICE OF OIL AND GAS

WILLOW LAND SURVEYING PLLC  
 220 MASONIC AVE. PENNSBORO WEST VIRGINIA 26415

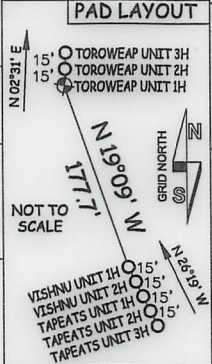

JOB # 21-011WA  
 DRAWING # TOROWEAP1HAD  
 SCALE 1" = 2000'  
 MINIMUM DEGREE OF ACCURACY SUBMETER  
 PROVEN SOURCE OF ELEV. SUBMETER MAPPING GRADE GPS  
 STATE OF WEST VIRGINIA DEPARTMENT OF ENERGY DIVISION OF OIL AND GAS

**LEGEND**  
 - - - Surface Owner Boundary Lines +/-  
 - - - Interior Surface Tracts +/-  
 O - Proposed Well Path  
 O - As Drilled Well Path

THOMAS SUMMERS P.S. 2109  
 DATE 10/11/22  
 OPERATOR'S WELL # TOROWEAP UNIT #1H

**(NAD) 27 (UTM) ZONE 17 COORDS:**  
**WELL 1H TOP HOLE INFORMATION:**  
 N: 14,346,816ft E: 1,693,753ft  
**POINT OF ENTRY INFORMATION:**  
 N: 14,346,702ft E: 1,693,885ft  
**BOTTOM HOLE INFORMATION:**  
 N: 14,335,884ft E: 1,697,666ft

- NOTES**
- NO OCCUPIED DWELLINGS OR BUILDINGS TWO THOUSAND FIVE HUNDRED (2,500) SQUARE FEET OR LARGER USED TO HOUSE OR SHELTER DAIRY CATTLE OR POULTRY HUSBANDRY ARE LOCATED WITHIN SIX HUNDRED TWENTY-FIVE (625) FEET OF THE CENTER OF THE WELL PAD.
  - TOP HOLE DATA SHOWN HEREON WAS PROVIDED BY ANTERO RESOURCES CORPORATION.
  - AS DRILLED DATA WAS PROVIDED BY ANTERO RESOURCES CORPORATION.
  - WLS IS NOT CERTIFYING THE DATA AND INFORMATION PROVIDED LISTED IN NOTES 2 AND 3, ONLY THE RELATIONSHIP TO THE DATA AND INFORMATION PROVIDED TO THE LEASE BOUNDARIES.
  - WLS IS BY NO MEANS RESPONSIBLE FOR ANY ERRORS OR INACCURACIES WITH THE DATA AND INFORMATION THAT HAS BEEN PROVIDED.

WELL TYPE: OIL \_\_\_ GAS X LIQUID INJECTION \_\_\_ WASTE DISPOSAL \_\_\_ API WELL # 47 - 095 - 02765  
 (IF "GAS") PRODUCTION X STORAGE \_\_\_ DEEP \_\_\_ SHALLOW X STATE COUNTY PERMIT  
 LOCATION: ELEVATION AS BUILT - 1,243.5' WATERSHED OUTLET MIDDLE ISLAND CREEK  
 QUADRANGLE PORTER FALLS 7.5' DISTRICT ELLSWORTH COUNTY TYLER  
 SURFACE OWNER KENNETH TOMBLIN ET AL ACREAGE 290.32 ACRES +/-  
 OIL & GAS ROYALTY OWNER S. A. SMITH AND C. B. MORRIS HEIRS TRUST; BETTY MOREHEAD ET VIR; LEASE ACREAGE 290.32 AC.±; 68.88 AC.±;  
 JAY A. WRIGHT ET UX; MORRIS MOUNTAINEER OIL & GAS LLC; CAROL J. KNAPP; 40.81 AC.±; 45.98 AC.±; 77.5 AC.±;  
 BERNICE BAKER; JAMES A. WEEKLEY ET AL; JANIE DENOON TRUST; MICHAEL SHERWOOD 45 AC.±; 58.5 AC.±; 20 AC.±; 32.5 AC.±

PROPOSED WORK: DRILL \_\_\_ CONVERT \_\_\_ DRILL DEEPER \_\_\_ REDRILL \_\_\_ FRACTURE OR STIMULATE \_\_\_  
 PLUG OFF OLD FORMATION \_\_\_ PERFORATE NEW FORMATION \_\_\_ OTHER PHYSICAL CHANGE IN WELL \_\_\_  
 (SPECIFY) AS DRILLED PLUG & ABANDON \_\_\_ CLEAN OUT & REPLUG \_\_\_  
 TARGET FORMATION MARCELLUS ESTIMATED DEPTH 6,887' TVD 18,567' MD  
 WELL OPERATOR ANTERO RESOURCES CORP. DESIGNATED AGENT DIANNA STAMPER - CT CORPORATION SYSTEM  
 ADDRESS 1615 WYNKOOP ST. DENVER, CO 80202 ADDRESS 5400 D BIG TYLER ROAD CHARLESTON, WV 25313

8,169' TO BOTTOM HOLE

LONGITUDE 80°47'30"

12,401'

LONGITUDE 80°47'30"

COUNTY TYLER PERMIT

07/21/2023