

LATITUDE 39°32'30"

5,428'

LATITUDE 39°30'00" 592' TO BOTTOM HOLE

Antero Resources Corporation Well No. Toroweap 2H

AS DRILLED DATA:
 WELL 2H TOP HOLE INFORMATION:
 N: 369,710ft E: 1,630,134ft
 LAT: 39°30'27.60" LON: 80°48'39.25"
 BOTTOM HOLE INFORMATION:
 N: 358,628ft E: 1,634,811ft
 LAT: 39°28'38.73" LON: 80°47'37.55"
 WEST VIRGINIA COORDINATE SYSTEM OF 1927 NORTH ZONE.
 ZONE WAS DERIVED FROM MEASUREMENTS TAKEN WITH TRIMBLE GEOXT SUBMETER MAPPING GRADE GPS UNIT. PLAT ORIENTATION, CORNER, AND WELL REFERENCE TIE LINES ARE BASED ON GRID NORTH.

(NAD) 83 (UTM) ZONE 17 COORDS:
 WELL 2H TOP HOLE INFORMATION:
 N: 4,373,141m E: 516,272m
 BOTTOM HOLE INFORMATION:
 N: 4,369,788m E: 517,753m

WV NORTH ZONE GRID NORTH

Ellsworth District - Tyler County	
16-14	James Barnhart
16-15	Harvey Miller Et Al
16-28	Kenneth Tomblin Et Al
16-29	Michael Tomblin
16-30	Christopher Investments Inc.
16-31	Christopher Investments Inc.
16-33	J. A. Weekley Hrs.
16-34	J. A. Weekley Hrs.
16-35	Jay Wright
17-56	J. A. Weekley Hrs.
22-9	Steven Wright
22-10	Leslie Henderson
22-11	Angela DeGuelle
22-13	Christopher Blake
22-14	Susan Delsorda
22-14.1	Siveryl Hayes
22-27	C. W. Weekley Hrs.
22-28	WSD Properties LLC
23-02	Dale Parr
23-03	Jack Hair
23-04	Jack Hair
McElroy District - Tyler County	
2-01	Jack Hair
2-02	Jack Hair
2-15	Leo Wiker
2-28	Jay Bee Oil & Gas Inc.
2-29	Cecil Nichols

8,223' TO BOTTOM HOLE

12,386'

LONGITUDE 80°47'30"

LONGITUDE 80°47'30"

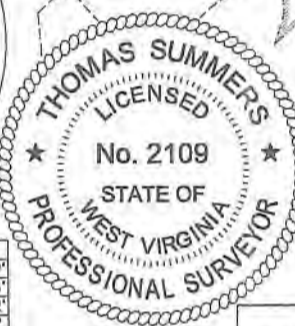
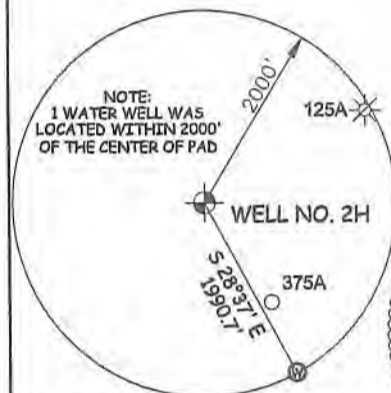

LINE	BEARING	DIST.	LINE	BEARING	DIST.
L1	N 79°23' W	1820.64'	L7	N 17°11' W	1289.39'
L2	N 72°38' W	1737.73'	L8	N 14°44' W	1409.38'
L3	N 69°39' W	1680.54'	L9	N 07°35' W	1774.02'
L4	N 45°05' W	1540.95'	L10	N 03°37' W	1761.12'
L5	N 36°53' W	1627.55'	L11	N 17°55' E	1113.36'
L6	N 30°40' W	1612.05'	L12	N 48°24' E	1322.09'

I THE UNDERSIGNED, HEREBY CERTIFY THAT THIS PLAT IS CORRECT TO THE BEST OF MY KNOWLEDGE AND BELIEF AND SHOWS ALL THE INFORMATION REQUIRED BY LAW AND THE RULES ISSUED AND PERSCRIBED BY THE DEPARTMENT OF ENVIRONMENTAL PROTECTION.



STATE OF WEST VIRGINIA, DIVISION OF ENVIRONMENTAL PROTECTION, OFFICE OF OIL AND GAS

WILLOW LAND SURVEYING PLLC
 220 MASONIC AVE. PENNSBORO
 WEST VIRGINIA 26415

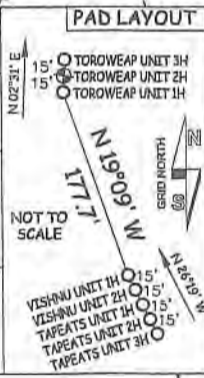

JOB # 21-011WA
 DRAWING # TOROWEAP2HAD
 SCALE 1" = 2000'
 MINIMUM DEGREE OF ACCURACY SUBMETER
 PROVEN SOURCE OF ELEV. SUBMETER MAPPING GRADE GPS

STATE OF WEST VIRGINIA DEPARTMENT OF ENERGY DIVISION OF OIL AND GAS

LEGEND

- Surface Owner Boundary Lines +/-
- Interior Surface Tracts +/-
- Proposed Well Path
- As Drilled Well Path

THOMAS SUMMERS P.S. 2109

DATE 10/11/22

OPERATOR'S WELL# TOROWEAP UNIT #2H

(NAD) 27 (UTM) ZONE 17 COORDS:
 WELL 2H TOP HOLE INFORMATION:
 N: 14,346,831ft E: 1,693,753ft
 POINT OF ENTRY INFORMATION:
 N: 14,346,702ft E: 1,693,885ft
 BOTTOM HOLE INFORMATION:
 N: 14,335,832ft E: 1,698,612ft

- NOTES
- NO OCCUPIED DWELLINGS OR BUILDINGS TWO THOUSAND FIVE HUNDRED (2,500) SQUARE FEET OR LARGER USED TO HOUSE OR SHELTER DAIRY CATTLE OR POULTRY HUSBANDRY ARE LOCATED WITHIN SIX HUNDRED TWENTY-FIVE (625) FEET OF THE CENTER OF THE WELL PAD.
 - TOP HOLE DATA SHOWN HEREON WAS PROVIDED BY ANTERO RESOURCES CORPORATION.
 - AS DRILLED DATA WAS PROVIDED BY ANTERO RESOURCES CORPORATION.
 - WLS IS NOT CERTIFYING THE DATA AND INFORMATION PROVIDED LISTED IN NOTES 2 AND 3, ONLY THE RELATIONSHIP TO THE DATA AND INFORMATION PROVIDED TO THE LEASE BOUNDARIES.
 - WLS IS BY NO MEANS RESPONSIBLE FOR ANY ERRORS OR INACCURACIES WITH THE DATA AND INFORMATION THAT HAS BEEN PROVIDED.

Wv Department Environmental Protection

APR 07 2023

WELL TYPE: OIL GAS LIQUID INJECTION WASTE DISPOSAL 47 - 095 - 02766

(IF "GAS") PRODUCTION STORAGE DEEP SHALLOW STATE COUNTY PERMIT

LOCATION: ELEVATION AS BUILT - 1,243.5' WATERSHED OUTLET MIDDLE ISLAND CREEK

QUADRANGLE PORTER FALLS 7.5' DISTRICT ELLSWORTH COUNTY TYLER

SURFACE OWNER KENNETH TOMBLIN ET AL ACREAGE 290.32 ACRES +/-

OIL & GAS ROYALTY OWNER S. A. SMITH AND C. B. MORRIS HEIRS TRUST; MICHAEL LEE TOMBLYN; LEASE ACREAGE 290.32 AC. ±; 55 AC. ±;
 BETTY MOREHEAD ET VIR; JAY A. WRIGHT ET UX; MORRIS MOUNTAINEER OIL & GAS LLC; 58 AC. ±; 40.81 AC. ±; 45.98 AC. ±;
 MARGARET LEMASTERS; CAROL J. KNAPP; BERNICE BAKER; BRC APPALACHIAN MINERALS 1 LLC; 18.93 AC. ±; 77.5 AC. ±; 75 AC. ±; 107 AC. ±;
 MICHAEL SHERWOOD 156.25 AC. ±;

PROPOSED WORK: DRILL CONVERT DRILL DEEPER REDRILL FRACTURE OR STIMULATE
 PLUG OFF OLD FORMATION PERFORATE NEW FORMATION OTHER PHYSICAL CHANGE IN WELL
 (SPECIFY) AS DRILLED PLUG & ABANDON CLEAN OUT & REPLUG

TARGET FORMATION MARCELLUS ESTIMATED DEPTH 6,910' TVD 18,829' MD

WELL OPERATOR ANTERO RESOURCES CORP. DESIGNATED AGENT DIANNA STAMPER - CT CORPORATION SYSTEM

ADDRESS 1615 WYNKOOP ST. ADDRESS 5400 D BIG TYLER ROAD
 DENVER, CO 80202 CHARLESTON, WV 25313

FORM WW-6

COUNTY NAME PERMIT