

LATITUDE 39°32'30"

5,427'

LATITUDE 39°30'00"

11,572' TO BOTTOM HOLE

Antero Resources Corporation Well No. Toroweap 3H

NOTES:
 WELL 3H TOP HOLE INFORMATION:
 N: 369,725ft E: 1,630,135ft
 LAT: 39°30'27.73" LON: 80°48'39.24"
 BOTTOM HOLE INFORMATION:
 N: 358,514ft E: 1,635,591ft
 LAT: 39°28'37.72" LON: 80°47'27.58"
 WEST VIRGINIA COORDINATE SYSTEM OF 1927 NORTH ZONE. ZONE WAS DERIVED FROM MEASUREMENTS TAKEN WITH TRIMBLE GEOXT SUBMETER MAPPING GRADE GPS UNIT. PLAT ORIENTATION, CORNER AND WELL REFERENCE TIE LINES ARE BASED ON GRID NORTH.

(NAD) 83 (UTM) ZONE 17 COORDS:
 WELL 3H TOP HOLE INFORMATION:
 N: 4,373,145m E: 516,272m
 BOTTOM HOLE INFORMATION:
 N: 4,369,758m E: 517,991m

WV NORTH ZONE GRID NORTH

Ellsworth District - Tyler County	
16-14	James Barnhart
16-15	Harvey Miller Et Al
16-28	Kenneth Tomblin Et Al
16-29	Michael Tomblin
16-30	Christopher Investments Inc.
16-31	Christopher Investments Inc.
16-33	J. A. Weekley Hrs.
16-34	J. A. Weekley Hrs.
16-35	Jay Wright
17-26	J. A. Weekley Hrs.
22-9	Steven Wright
22-10	Leslie Henderson
22-11	Ansel DeGuelle
22-13	Christopher Blake
22-14	Susan Delozado
22-14.1	Sheryl Hayes
22-27	C. W. Weekley Hrs.
22-28	WSD Properties LLC
23-02	Dale Parr
23-03	Jack Hair
23-04	Jack Hair
McInroy District - Tyler County	
2-01	Jack Hair
2-02	Jack Hair
2-15	Leo Wiker
2-28	Jay Bee Oil & Gas Inc.
2-29	Cecil Nichols

8,325' TO BOTTOM HOLE

12,401'

LONGITUDE 80°45'00"

LONGITUDE 80°47'30"

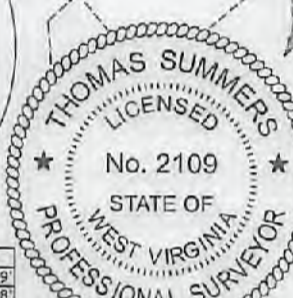
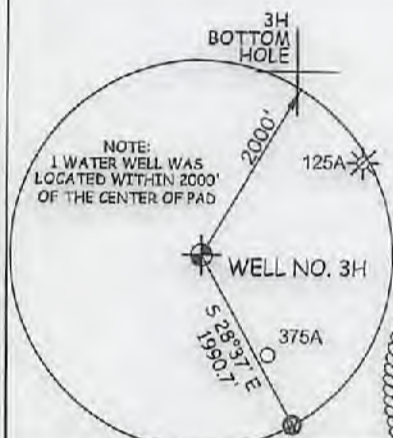

LINE BEARING	DIST.	LINE BEARING	DIST.
L1 N 79°23' W	1820.64' L7	N 17°11' W	1289.39'
L2 N 72°38' W	1737.73' L8	N 14°44' W	1409.38'
L3 N 69°39' W	1680.54' L9	N 07°35' W	1774.82'
L4 N 45°05' W	1540.95' L10	N 03°37' W	1751.12'
L5 N 36°53' W	1627.55' L11	N 17°55' E	1113.36'
L6 N 30°40' W	1612.05' L12	N 48°24' E	1322.09'

I THE UNDERSIGNED, HEREBY CERTIFY THAT THIS PLAT IS CORRECT TO THE BEST OF MY KNOWLEDGE AND BELIEF AND SHOWS ALL THE INFORMATION REQUIRED BY LAW AND THE RULES ISSUED AND PERSCRIBED BY THE DEPARTMENT OF ENVIRONMENTAL PROTECTION.



STATE OF WEST VIRGINIA, DIVISION OF ENVIRONMENTAL PROTECTION, OFFICE OF OIL AND GAS

WILLOW LAND SURVEYING PLLC
 220 MASONIC AVE. PENNSBORO WEST VIRGINIA 26415

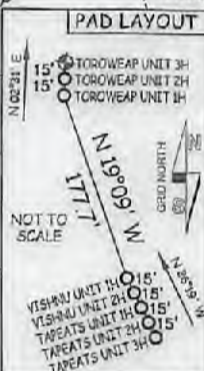

JOB # 21-011WA
 DRAWING # TOROWEAP3HR
 SCALE 1" = 2000'
 MINIMUM DEGREE OF ACCURACY SUBMETER
 PROVEN SOURCE OF ELEV. SUBMETER MAPPING GRADE GPS
 STATE OF WEST VIRGINIA DEPARTMENT OF ENERGY DIVISION OF OIL AND GAS

LEGEND
 - - - Surface Owner Boundary Lines +/-
 - - - Adjoining Surface Tracts +/-
 ⊕ Found monument, as noted
 THOMAS SUMMERS P.S. 2109
 DATE 01/26/22
 OPERATOR'S WELL# TOROWEAP UNIT #3H

(NAD) 27 (UTM) ZONE 17 COORDS:
 WELL 3H TOP HOLE INFORMATION:
 N: 14,346,846ft E: 1,693,754ft
 POINT OF ENTRY INFORMATION:
 N: 14,347,195ft E: 1,695,470ft
 BOTTOM HOLE INFORMATION:
 N: 14,335,732ft E: 1,699,394ft

REFERENCES

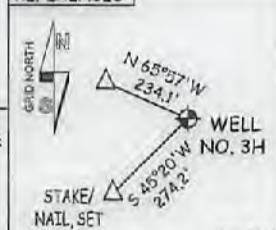

WELL TYPE: OIL GAS LIQUID INJECTION WASTE DISPOSAL 47 096 02767 MOD

(IF "GAS") PRODUCTION STORAGE DEEP SHALLOW STATE COUNTY PERMIT

LOCATION: ELEVATION AS BUILT -1,243.5' WATERSHED OUTLET MIDDLE ISLAND CREEK

QUADRANGLE PORTER FALLS 7.5' DISTRICT ELLSWORTH COUNTY TYLER

SURFACE OWNER KENNETH TOMBLIN ET AL ACREAGE 290.32 ACRES +/-

OIL & GAS ROYALTY OWNERS: A. SMITH AND C. B. MORRIS HEIRS TRUST; MICHAEL LEE TOMBLYN; LEASE ACREAGE 290.32 AC +/- 55 AC +/-
 GREENBRIER ROYALTY FUND II, LLC; BETTY MOREHEAD ET VIR; BETTY MOREHEAD; 40 AC +/- 58 AC +/- 16.5 AC +/-
 BETTY MOREHEAD ET VIR; JAY A. WRIGHT ET UX; MORRIS MOUNTAINEER OIL & GAS LLC; 15 AC +/- 40.81 AC +/- 45.98 AC +/-
 BETTY MOREHEAD ET VIR; DALE H. PARR ET UX; JOSEPHINE CALVIN; BRC APPALACHIAN MINERALS 1 LLC; MICHAEL SHERWOOD 49.81 +/- 70 AC +/- 21 AC +/- 107 AC +/- 156.25 AC +/-

PROPOSED WORK: DRILL CONVERT DRILL DEEPER REDRILL FRACTURE OR STIMULATE
 PLUG OFF OLD FORMATION PERFORATE NEW FORMATION OTHER PHYSICAL CHANGE IN WELL
 (SPECIFY) MOD-BHL PLUG & ABANDON CLEAN OUT & REPLUG

TARGET FORMATION MARCELLUS ESTIMATED DEPTH 7,400' TVD 22,200' MD

WELL OPERATOR ANTERO RESOURCES CORP. DESIGNATED AGENT DIANNA STAMPER - CT CORPORATION SYSTEM

ADDRESS 1815 WYNKOOP ST. ADDRESS 5400 D BIG TYLER ROAD
 FORM WW-6 DENVER, CO 80202 CHARLESTON, WV 25313

03/18/2022

COUNTY NAME PERMIT