

Antero Resources
Well No. Clutter 1H
BHL MOD
 Antero Resources Corporation

11,134' to Top Hole
 3,728' to Bottom Hole
 TOP HOLE LATITUDE 39 - 30 - 00
 BTM HOLE LATITUDE 39 - 32 - 30



Notes
 West Virginia Coordinate System of 1927, North Zone based upon Differential GPS Measurements. Well No. Clutter Unit 1H Top Hole coordinates are
 N: 365,225.90' Latitude: 39°29'37.02"
 E: 1,569,082.04' Longitude: 80°57'22.03"
 Bottom Hole coordinates are
 N: 371,041.90' Latitude: 39°30'33.81"
 E: 1,584,822.96' Longitude: 80°58'17.57"
 UTM Zone 17, NAD 1983
 Top Hole Coordinates Bottom Hole Coordinates
 N: 4,371,565.499m N: 4,373,315.676m
 E: 503,787.622m E: 502,460.522m
 Plat orientation and corner and well references are based upon the grid north meridian.
 Well location references are based upon the magnetic meridian.

TOP HOLE LONGITUDE 80 - 55 - 00
 BTM HOLE LONGITUDE 80 - 57 - 30

2,325' to Top Hole
 11,756' to Bottom Hole



I, the undersigned, hereby certify that this plat is correct to the best of my knowledge and belief and shows all the information required by law and the rules issued and prescribed by the Department of Environmental Protection.

Bradley D. Miller
 Bradley D. Miller, P.S. 2167

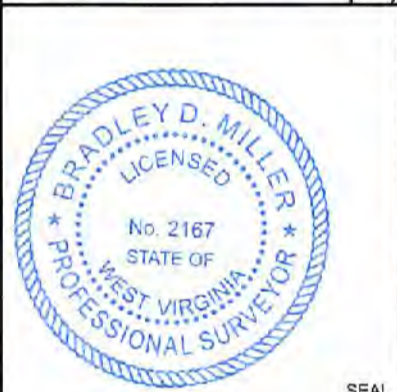

Notes:
 Well No. Clutter Unit 1H UTM Zone 17, NAD 1927
 Top Hole Coordinates
 N: 14,341,664.12'
 E: 1,652,795.74'
 Point of Entry Coordinates
 N: 14,341,001.25'
 E: 1,650,656.98'
 Bottom Hole Coordinates
 N: 14,347,406.23'
 E: 1,648,441.65'

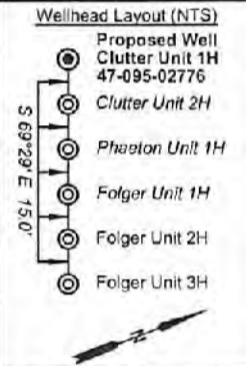

	Bearing	Dist.
L1	S 07°44' E	867.5'
L2	N 43°17' E	1,097.1'
L3	N 66°24' E	1,141.4'
L4	N 70°53' E	1,831.2'
L5	S 73°44' W	2,239.9'

- Legend**
- Proposed gas well
 - ⊗ Monument, as noted
 - ⊙ Existing Well, as noted
 - ⊛ Digitized Well, as noted
 - Creek or Drain
 - Road
 - Surface boundary (approx.)
 - Interior surface tracts (approx.)
 - District Line

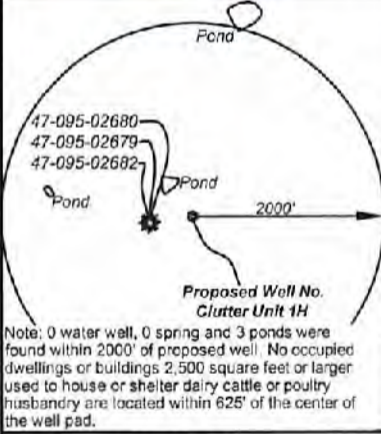

FILE NO: 268-54-E-21
 DRAWING NO: Clutter Unit 1H Well Plat
 SCALE: 1" = 1000'
 MINIMUM DEGREE OF ACCURACY: Submeter
 PROVEN SOURCE OF ELEVATION: WVDOT, Harrisville, WV

STATE OF WEST VIRGINIA
 DEPARTMENT OF ENVIRONMENTAL PROTECTION
OIL AND GAS DIVISION

DATE: February 9 2022
 OPERATOR'S WELL NO. Clutter Unit 1H
 API WELL NO
 47 - 095 - 02776 M
 STATE COUNTY PERMIT

WELL TYPE: OIL GAS LIQUID INJECTION WASTE DISPOSAL
 (IF GAS) PRODUCTION: STORAGE DEEP SHALLOW

LOCATION: ELEVATION: As-Built 880' WATERSHED: Outlet Middle Island Creek QUADRANGLE: Top Hole: Middleboure Btm Hole: Paden City
 DISTRICT: Ellsworth Union Elsdon J. & COUNTY: Tyler **03/18/2022**
 SURFACE OWNER: Ruth A. Helman David S. Clough; ACREAGE: 61.83 61.83; 186.008; 53; 57.23; 25.05;
 ROYALTY OWNER: Elsdon J. & Ruth A. Helman; Lora Keller Thomas (2); Richard Keith McCollum; LEASE NO: ACREAGE: 83.13; 190; 78.49;
 PROPOSED WORK: DRILL CONVERT DRILL DEEPER FRACTURE OR STIMULATE PLUG OFF OLD FORMATION
 PERFORATE NEW FORMATION OTHER PHYSICAL CHANGE IN WELL (SPECIFY) BHL MOD
 PLUG AND ABANDON CLEAN OUT AND REPLUG TARGET FORMATION: Marcellus Shale ESTIMATED DEPTH: 6,400' TVD 15,600' MD

WELL OPERATOR: Antero Resources Corporation DESIGNATED AGENT: Dianna Stamper - CT Corporation System
 ADDRESS: 1615 Wynkoop Street ADDRESS: 5400 D Big Tyler Road
 Denver, CO 80202 Charleston, WV 25313



ID	TM/Par	Owner	Bk/Pg	Acres
1	19-1	Eldon J. & Ruth A. Helman	383/761	61.83
2	19-42	Carol J. Cox	334/298	142.00
3	10-10	Lora K. Thomas	201/359	307.05
4	10-1	Lora K. Thomas	175/19	53.00
5	6-2	Eldon J. & Ruth A. Helman	383/761	83.13
6	6-1	Eldon J. & Ruth A. Helman	383/761	169.00
7	6-6.14	Arlen G. Wells, Jr.	339/611	15.00
8	6-6.13	David S. Clough	351/752	12.25
9	6-6.12	David S. Clough	351/752	12.95
10	6-6.11	David S. Clough	351/752	12.40
11	6-6.10	Jeffrey M. & Jill S. Mennillo	368/770	9.90
12	6-6.9	David S. Clough	351/712	24.54
13	6-6.7	David S. Clough	351/752	16.35
14	6-6.8	Alan B. & Traci L. Clough	354/306	18.30
15	6-6.3	Eathan P. Wells	445/727	9.55
16	6-6.6	Richard Keith McCollum	362/348	25.05
17	6-6.5	Crystal R. & Charles J. Young, Jr.	345/211	25.65
18	6-6.4	Crystal R. & Charles J. Young, Jr.	368/773	25.35

Leases	
A	Eldon J. & Ruth A. Helman
B	Carol J. Cox
C	Lora Keller Thomas
D	Lora Keller Thomas
E	Gary C. & Maryjane Richards
F	Norma R. Spencer
G	WVDNR
H	Arlen G. Jr. & Marsha A. Wells
I	OPEN
J	Jeffrey M. Mennillo, et ux
K	David S. Clough
L	Alan B. Clough, et ux
M	Richard Keith McCollum
N	Everett E. & Melissa D. Higgins

FILE NO: 268-54-E-21
DRAWING NO: Clutter Unit 1H Well Plat
SCALE: 1" = 1000'
MINIMUM DEGREE OF ACCURACY:
Submeter
PROVEN SOURCE OF ELEVATION:
WVDOT, Harrisville, WV

STATE OF WEST VIRGINIA
DEPARTMENT OF ENVIRONMENTAL PROTECTION
OIL AND GAS DIVISION

DATE: February 9 2022
OPERATOR'S WELL NO. Clutter Unit 1H
API WELL NO
47 - 095 - 02776
STATE COUNTY PERMIT

WELL TYPE: OIL GAS LIQUID INJECTION WASTE DISPOSAL
(IF GAS) PRODUCTION: STORAGE DEEP SHALLOW

LOCATION: ELEVATION: As-Built 880' WATERSHED: Middle Island Creek QUADRANGLE: Btm Hole: Paden City
DISTRICT: Union Elsworth COUNTY: Tyler 03/18/2022
SURFACE OWNER: Ruth A. Helman David S. Clough; ACREAGE: 61.83 61.83; 186.008;
ROYALTY OWNER: Eldon J. & Ruth A. Helman; Lora Keller Thomas (2); Richard Keith McCollum; WVDNR: Gary C. & Maryjane Richards; Norma R. Spencer; 53; 57.23; 25.05;
PROPOSED WORK: DRILL CONVERT DRILL DEEPER FRACTURE OR STIMULATE PLUG OFF OLD FORMATION
 PERFORATE NEW FORMATION OTHER PHYSICAL CHANGE IN WELL (SPECIFY) BHL MOD
 PLUG AND ABANDON CLEAN OUT AND REPLUG TARGET FORMATION: Marcellus Shale ESTIMATED DEPTH: 6,400' TVD 83.13; 190; 78.49;

WELL OPERATOR: Antero Resources Corporation DESIGNATED AGENT: Dianna Stamper - CT Corporation System
ADDRESS: 1615 Wynkoop Street ADDRESS: 5400 D Big Tyler Road
Denver, CO 80202 Charleston, WV 25313