

**Antero Resources**  
**Well No. Jed 1H**  
**BHL MOD**  
 Antero Resources Corporation

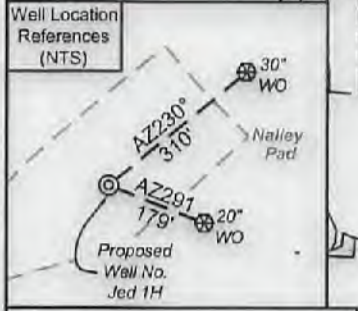

I, the undersigned, hereby certify that this plat is correct to the best of my knowledge and belief and shows all the information required by law and the rules issued and prescribed by the Department of Environmental Protection.

*Bradley D. Miller*

Bradley D. Miller, P.S. 2167

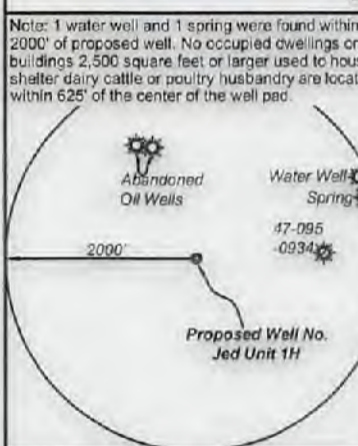

	Bearing	Dist.
L1	N 68°17' E	810.6'
L2	N 81°50' E	1,864.9'
L3	S 73°15' W	1,340.7'
L4	N 25°18' W	1,602.6'
L5	S 75°12' W	1,189.5'

- Legend**
- Proposed gas well
  - Monument, as noted
  - Existing Well, as noted
  - Digitized Well, as noted
  - Creek or Drain
  - Road
  - Surface boundary (approx.)
  - Interior surface tracks (approx.)

10,776' to Top Hole  
 7,093' to Bottom Hole  
**TOP HOLE LATITUDE 39 - 35 - 00**  
**BTM HOLE LATITUDE 39 - 32 - 30**

**Notes**  
 West Virginia Coordinate System of 1927, North Zone based upon Differential GPS Measurements.  
 Well No. Jed Unit 1H Top Hole coordinates are  
 N: 383,726.33' Latitude: 39°32'39.96"  
 E: 1,589,732.24' Longitude: 80°57'17.56"  
 Bottom Hole coordinates are  
 N: 369,147.02' Latitude: 39°30'16.42"  
 E: 1,593,185.76' Longitude: 80°56'30.50"  
 UTM Zone 17, NAD 1983  
 Top Hole Coordinates Bottom Hole Coordinates  
 N: 4,377,205.085m N: 4,372,780.995m  
 E: 503,891.729m E: 505,017.899m  
 Plat orientation and corner and well references are based upon the grid north meridian.  
 Well location references are based upon the magnetic meridian.

**Notes:**  
 Well No. Jed Unit 1H UTM Zone 17, NAD 1927  
 Top Hole Coordinates  
 N: 14,360,166.49'  
 E: 1,653,136.87'  
 Point of Entry Coordinates  
 N: 14,359,843.66'  
 E: 1,651,992.41'  
 Bottom Hole Coordinates  
 N: 14,345,651.84'  
 E: 1,656,832.04'

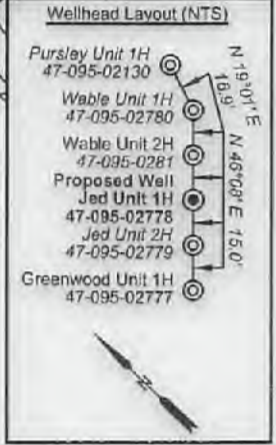

FILE NO: 34-54-L-17  
 DRAWING NO: Jed Unit 1H Well Plat  
 SCALE: 1" = 2000'  
 MINIMUM DEGREE OF ACCURACY: Submeter  
 PROVEN SOURCE OF ELEVATION: WVDOT, Harrisville, WV

**STATE OF WEST VIRGINIA**  
 DEPARTMENT OF ENVIRONMENTAL PROTECTION  
**OIL AND GAS DIVISION**

DATE: February 14 2022  
 OPERATOR'S WELL NO. Jed Unit 1H  
 API WELL NO  
 47 - 095 - 02778 M  
 STATE COUNTY PERMIT

WELL TYPE:  OIL  GAS  LIQUID INJECTION  WASTE DISPOSAL  
 (IF GAS) PRODUCTION:  STORAGE  DEEP  SHALLOW

LOCATION: ELEVATION: As-Built 971.8' WATERSHED: Outlet Middle Island Creek QUADRANGLE: Paden City 0.68; 48.1; 80; 53.7; 0.922; 9.4; 3.16563; 6.444; 2.44; 71.99; 69.15; 50.0; 17.0; 3.33; 205.862; 71.93152; 25; 127.39

DISTRICT: Lincoln Robert D. & SURFACE OWNER: Virginia A. Nalley COUNTY: Tyler

ROYALTY OWNER: Robert D. Nalley, et ux (3); George E. Miller, et ux; Thomas D. Butterfield, et ux. LEASE NO: ACREAGE: 80.00

PROPOSED WORK:  DRILL  CONVERT  DRILL DEEPER  FRACTURE OR STIMULATE  PLUG OFF OLD FORMATION  
 PERFORATE NEW FORMATION  OTHER PHYSICAL CHANGE IN WELL (SPECIFY) BHL MOD  
 PLUG AND ABANDON  CLEAN OUT AND REPLUG TARGET FORMATION: Marcellus Shale ESTIMATED DEPTH: 23,800' MD

WELL OPERATOR: Antero Resources Corporation DESIGNATED AGENT: Dianna Stamper - CT Corporation System  
 ADDRESS: 1615 Wynkoop Street ADDRESS: 5400 D Big Tyler Road  
 Denver, CO 80202 Charleston, WV 25313

02/18/2022

**Antero Resources  
Well No. Jed 1H**

Antero Resources Corporation

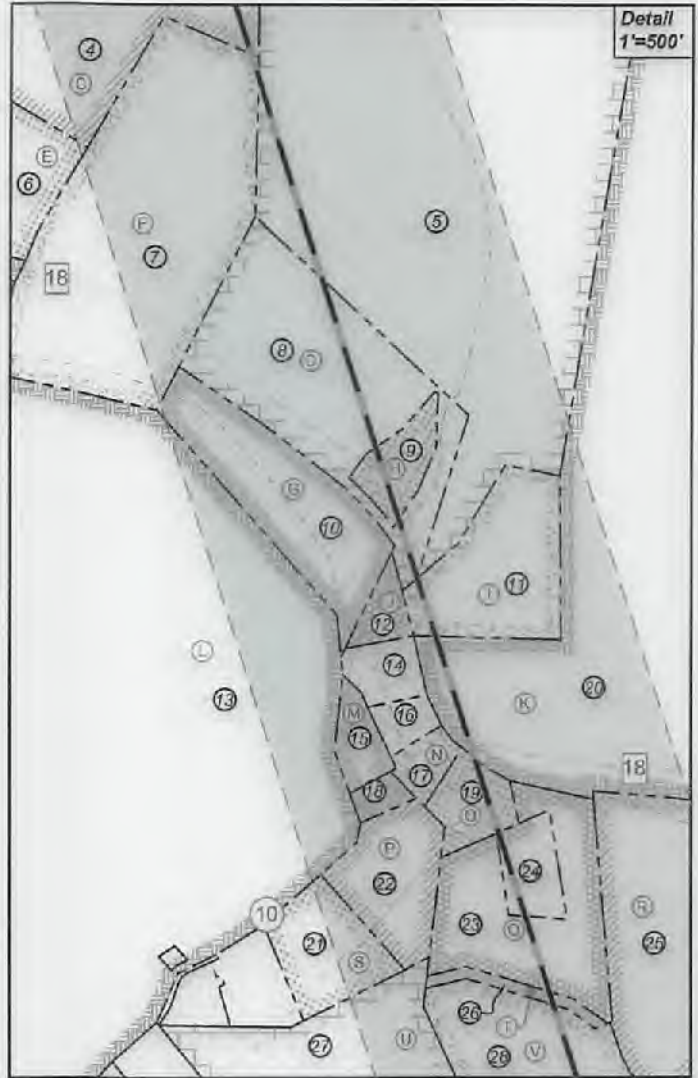

ID	TMPar	Owner	Bk/Pg	Acres
1	8-54	Robert D. & Virginia A. Nalley	198/41	30.00
2	8-38.3	Joann & Howard L. Schupbach Jr.	467/383	21.17
3	8-38.5	Donald D. & Alice J. Haught	300/583	21.17
4	8-53	Robert D. & Virginia A. Nalley	200/53	48.10
5	12-13	Robert D. & Virginia A. Nalley	183/452	38.75
6	12-11	Kenneth R. & Mary Joanne Hunt	231/387	3.00
7	12-12	George & Mary Jo Miller	195/44	9.33
8	12-14	Robert D. Nalley	393/662	7.35
9	12-14.1	Robert D. & Virginia Nalley	424/382	0.85
10	12-28	Warren C. & Erica N. Conklin	400/261	3.75
11	12-15	Pursley Cemetery	97/2	3.16
12	12A-1	Donald B. & Barbara S. Stokes	270/372	0.43
13	12-27	William P. & Jo Anne Ingram	156/175	183.16
14	12A-2	Church of Christ	85/552	0.66
15	12A-4	Eric J. Fletcher	666/526	0.44
16	12A-3	Pursley Church of Christ	358/83	0.42
17	12A-5	Stephen M. Johnson	AR51/1229	0.68
18	12A-6	Eric J. Fletcher	666/526	0.29
19	12A-7	Michael A. & Cheryl A. Mars	619/130	0.83
20	12-16	Harry Huff	230/546	45.11
21	12-32.1	Kay K. & Donald L. Steward	311/676	1.66
22	12-32	David R. & Nancy J. Goodfellow	311/618	1.94
23	12-34	Ronald L. & Donna L. George	372/167	5.13
24	12-33	Ronald L. & Donna L. George	372/167	0.85
25	12-35	Dale E. Berisford	307/443	9.21
26	12-34.1	Stacey Lynn Carney, et al	W53/701	0.90
27	12-38	Dena Grimes	W35/150	9.64
28	12-39	Stacey Carney, et al	W53/701	71.99
29	12-53.4	Walter J. West	359/617	52.95
30	12-52	Leslie Ray Tennant	382/603	68.15
31	12-51	Rickie Lee Littleton	281/193	61.23
32	12-61	Melinda A. King	568/757	17.00
33	12-62	Leslie Ray Tennant, et al	282/305	50.00
34	12-63	Melinda A. King	568/757	8.66
35	12-84	Ridgetop Capital, LP	375/206	3.33
36	12-85	GR Meckley Family Trust	OR50/28	0.50
37	12-67	Leslie R. Tennant, et al	283/574	54.07
38	12-66	Eugene W. & Leah M. Gilmore	286/7	25.00
39	15-9	Ridgetop Capital, LP	375/206	120.00
40	15-20	James L. & Martha Jo Stewart	330/936	76.10
41	15-13	B. F., Ben H. & Ida M. Kile	174/412	140.00
42	13-1	James L. & Martha Jo Stewart	330/931	194.04
43	15-16	Mary Ann Devine, et al	W36/282	81.67
44	15-17	Earl & Donna Smith	191/12	127.39
45	13-3.5	Lisa M. Beane	408/688	17.84

Leases			
A	Robert D. Nalley, et ux	S	Donald L. Steward, et ux
B	Robert L. Keller	T	Stacey Lynn Carney, et vir
C	Robert D. Nalley, et ux	U	Dena Raye Grimes
D	Robert D. Nalley, et ux	V	Matthew Goodfellow
E	Kenneth R. Hunt	W	Walter J. West
F	George E. Miller, et ux	X	Leslie R. Tennant
G	Warren C. Conklin, et ux	Y	Larry Folger, et ux
H	Thomas D. Butterfield, et ux	Z	BRC Appalachian Minerals I, LLC
I	Pursley Cemetery	AA	BRC Appalachian Minerals I, LLC
J	Donald B. & Barbara S. Stokes	AB	BRC Appalachian Minerals I, LLC
K	Harry H. Huff, et ux	AC	Gerald Meckley
L	William P. Ingram	AD	Ridgetop Capital, LP
M	Kimberly Wilcox	AE	Central Trinity Methodist Church
N	Stephen M. Johnson	AF	Ridgetop Capital, LP
O	Michael A. Mars, et ux	AG	Donald H. Lancaster, Jr.
P	Lisa J. York	AH	Debra Lynn Warner
Q	Ronald L. George et ux	AI	Donna Smith
R	Dale E. Berisford		

FILE NO: 34-54-L-17  
 DRAWING NO: Jed Unit 1H Well Plat  
 SCALE: 1" = 2000'  
 MINIMUM DEGREE OF ACCURACY:  
 Submeter  
 PROVEN SOURCE OF ELEVATION:  
 WVDOT, Harrisville, WV

**STATE OF WEST VIRGINIA**  
 DEPARTMENT OF ENVIRONMENTAL PROTECTION  
**OIL AND GAS DIVISION**

DATE: February 14 20 22  
 OPERATOR'S WELL NO. Jed Unit 1H  
 API WELL NO  
 47 - 095 - 02778 H  
 STATE COUNTY PERMIT

WELL TYPE:  OIL  GAS  LIQUID INJECTION  WASTE DISPOSAL  
 (IF GAS) PRODUCTION:  STORAGE  DEEP  SHALLOW

LOCATION: ELEVATION: As-Built 971.8' WATERSHED: Middle Island Creek QUADRANGLE: Paden City 0.68; 48.1;  
 Outlet  
 DISTRICT: Lincoln Robert D. & Virginia A. Nalley Michael A. Mars, et ux; Ridgetop Capital, LP (2); Central Trinity Methodist Church; Stephen M. Johnson; Leslie R. Tennant; Debra Lynn Warner; BRC Appalachian Minerals I, LLC (2);  
 COUNTY: Tyler 80; 53.7; 0.922; 9.4;  
 SURFACE OWNER: Virginia A. Nalley Donald L. George, et ux; Stacey Lynn Carney, et vir; Matthew Goodfellow; 3.16563; 6.444; 2.44;  
 ACREAGE: 80.00 71.99; 69.15; 50.0;  
 ROYALTY OWNER: Robert D. Nalley, et ux (3); George E. Miller, et ux; Thomas D. Butterfield, et ux; LEASE NO: ACREAGE: 71.93152,25; 127.39  
 17.0; 3.33; 205.862;

PROPOSED WORK:  DRILL  CONVERT  DRILL DEEPER  FRACTURE OR STIMULATE  PLUG OFF OLD FORMATION  
 PERFORATE NEW FORMATION  OTHER PHYSICAL CHANGE IN WELL (SPECIFY) BHL MOD 6,600' TVD  
 PLUG AND ABANDON  CLEAN OUT AND REPLUG TARGET FORMATION: Marcellus Shale ESTIMATED DEPTH: 23,800' MD

WELL OPERATOR: Antero Resources Corporation DESIGNATED AGENT: Dianna Stamper - CT Corporation System  
 ADDRESS: 1615 Wynkoop Street ADDRESS: 5400 D Big Tyler Road  
 Denver, CO 80202 Charleston, WV 25313

03/18/2022