

LATITUDE 39°32'30"

9,126'

LATITUDE 39°32'30"

7,004' TO BOTTOM HOLE

Antero Resources Corporation  
Well No. Atwood Unit 1H

**MINERAL OWNERSHIP**

A BISSIE M. SHIVELY  
 B ELAINE L. OILER  
 C OMA ANN FERRELL  
 D JON MICHAEL DUMARS ET UX  
 E HAUGHT FAMILY TRUST  
 F H 3 LLC  
 G CLARENCE MYSZCZELAKAUS

**ELLSWORTH DISTRICT - TYLER COUNTY**

12-05 ROSALTE HENRY  
 12-06 ANTERO MIDSTREAM LLC  
 12-07 COASTAL FOREST RESOURCES CO  
 12-09 COASTAL FOREST RESOURCES CO  
 12-14 ANTERO MIDSTREAM LLC  
 12-16 PATRICIA NYE  
 12-16 PATRICIA NYE  
 12-17 ANTERO MIDSTREAM LLC  
 12-18 ANTERO MIDSTREAM LLC  
 12-19 JON DUMARS  
 12-20 SHA YOHO  
 12-20.1 SHA YOHO  
 12-21 SHA YOHO  
 12-22 RALPH THACKER  
 12-23 ROBERT BARD  
 12-24 CHARLES EASTHAM  
 12-25 MARGARET LANCASTER  
 12-26 MARGARET LANCASTER  
 12-32 CARL WILCOX

**MCELROY DISTRICT - TYLER COUNTY**

2-04 LLOYD WEEKLEY  
 2-05 RONALD WEEKLEY  
 2-9.1 RICHARD BLANKENSHIP  
 2-9.2 WILLIAM LACY  
 2-9.3 SANDRA JOCHUM  
 2-10 WANDA PARR  
 2-11 THOMAS FERRELL

**ELLSWORTH DISTRICT - TYLER COUNTY**

17-04 ERVAIN PECK  
 17-07 GILBERT EDDY  
 17-08 RICHARD NAPTORKOWSKI  
 17-09 ERVAIN PECK  
 17-10 THOMAS JOES  
 17-10.1 CHARLES EASTHAM  
 17-10.2 THOMAS JOES  
 17-11 ELIZABETH RICHIE  
 17-12 FREDERICK SHATZER  
 17-13 CHARLES EASTHAM  
 17-14 WILLIAM TITUS  
 17-14.1 SAMUEL LEEK  
 17-14.2 SANDRA SHREVE  
 17-14.3 FRED SHREVE  
 17-14.4 FRED SHREVE  
 17-14.5 PEGGY LOUB  
 17-14.6 RONALD SHAVER  
 17-14.7 MICHAEL MARTIN  
 17-14.8 SANDRA SHREVE  
 17-14.9 FRED SHREVE  
 17-14.10 MICHAEL MARTIN  
 17-15 JEROME PLAUGHER  
 17-19 CLARENCE CLARK  
 17-20 KETH MALINKY  
 17-20.1 KETH MALINKY  
 17-21 RODNEY ADAMS  
 17-22 STEVEN MELOTT  
 17-23 MARJORIE STALEY  
 17-24 SHAWNIA STALEY  
 17-24.1 DAWN HADLEY  
 17-25 ELIZABETH MENSES  
 17-26 RICHARD NEFF  
 17-27 HAMMETT LAND & MINERALS LLC  
 17-28 ARTHUR PECK  
 17-29 HAMMETT LAND & MINERALS LLC  
 17-32 SHALYN MCGRAW  
 17-37 BONNIE HENTHORN  
 17-37.1 JOHN COOPER  
 17-37.2 PATRICK KELLER  
 17-38 PATRICK KELLER  
 17-38.1 PATRICK KELLER  
 17-39 PATRICK KELLER  
 17-39.1 PATRICK KELLER  
 17-39.2 PATRICK KELLER  
 17-40.1 RODNEY ADAMS  
 17-41 ROBERT BALL  
 17-45 EQT PRODUCTION CO.  
 17-46 EQT PRODUCTION CO.  
 17-47 JOHN BASSETT  
 17-48 TEREY JURY  
 17-49 MARTHA MENSES  
 17-50 MARTHA MENSES  
 17-51 JONATHAN COOPER  
 17-52 ANTERO RESOURCES CORP.  
 17-59 MICHAEL BEGLE  
 23-11 JENNIFER WILLIAMS  
 23-12 TERRY JOY  
 23-13 JOSEPH FERRELL  
 23-14 WANDA PARR  
 23-15 HARLEY LEMASTERS  
 23-16 RICK STALEY  
 23-17 RICK STALEY  
 23-18 RICK STALEY  
 23-28 RICHARD NEFF

5,673' TO BOTTOM HOLE

4,762'

LONGITUDE 80°45'00"

LONGITUDE 80°45'00"

**NOTES:**

**WELL 1H TOP HOLE INFORMATION:**  
 N: 377,217ft E: 1,638,297ft  
 LAT: 39°31'42.94" LON: 80°46'56.48"

**BOTTOM HOLE INFORMATION:**  
 N: 376,276ft E: 1,640,406ft  
 LAT: 39°31'33.94" LON: 80°46'29.39"

WEST VIRGINIA COORDINATE SYSTEM OF 1927 NORTH ZONE. ZONE WAS DERIVED FROM MEASUREMENTS TAKEN WITH TRIMBLE GEOXT SUBMETER MAPPING GRADE GPS UNIT. PLAT ORIENTATION, CORNER, AND WELL REFERENCE TIE LINES ARE BASED ON GRID NORTH.

**(NAD) 83 (UTM) ZONE 17 COORDS:**  
 WELL 1H TOP HOLE INFORMATION:  
 N: 4,375,469m E: 518,720m  
 BOTTOM HOLE INFORMATION:  
 N: 4,375,193m E: 519,368m

**(NAD) 27 (UTM) ZONE 17 COORDS:**  
 WELL 1H TOP HOLE INFORMATION:  
 N: 14,354,471ft E: 1,701,787ft  
 POINT OF ENTRY INFORMATION:  
 N: 14,354,917ft E: 1,703,361ft  
 BOTTOM HOLE INFORMATION:  
 N: 14,353,566ft E: 1,703,911ft

**NOTE**

NO OCCUPIED DWELLINGS OR BUILDINGS TWO THOUSAND FIVE HUNDRED (2,500) SQUARE FEET OR LARGER USED TO HOUSE OR SHELTER DAIRY CATTLE OR POULTRY HUSBANDRY ARE LOCATED WITHIN SIX HUNDRED TWENTY-FIVE (625) FEET OF THE CENTER OF THE WELL PAD.

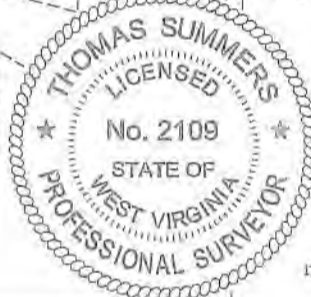
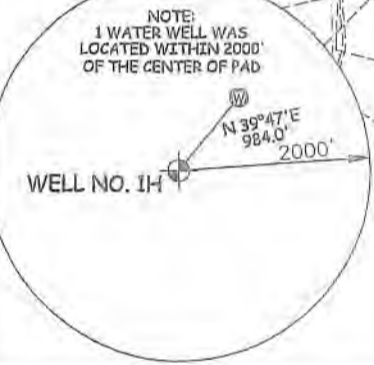

I THE UNDERSIGNED, HEREBY CERTIFY THAT THIS PLAT IS CORRECT TO THE BEST OF MY KNOWLEDGE AND BELIEF AND SHOWS ALL THE INFORMATION REQUIRED BY LAW AND THE RULES ISSUED AND PERSCRIBED BY THE DEPARTMENT OF ENVIRONMENTAL PROTECTION.



STATE OF WEST VIRGINIA, DIVISION OF ENVIRONMENTAL PROTECTION, OFFICE OF OIL AND GAS

WILLOW LAND SURVEYING PLLC  
 220 MASONIC AVE. PENNSBORO WEST VIRGINIA 26415

JOB # 20-014WA  
 DRAWING # ATWOOD1H  
 SCALE 1" = 2000'  
 MINIMUM DEGREE OF ACCURACY SUBMETER  
 PROVEN SOURCE OF ELEV. SUBMETER MAPPING GRADE GPS

**LEGEND**

--- Surface Owner Boundary Lines +/-  
 - - - - - Adjoining Surface Tracts +/-  
 ⊕ Found monument, as noted

THOMAS SUMMERS P.S. 2109

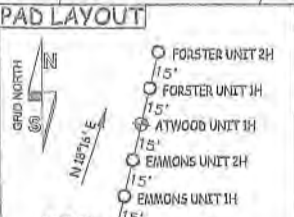

STATE OF WEST VIRGINIA DEPARTMENT OF ENERGY DIVISION OF OIL AND GAS

DATE 06/13/22  
 OPERATOR'S WELL# ATWOOD UNIT #1H

WELL TYPE: OIL \_\_\_ GAS X LIQUID INJECTION \_\_\_ WASTE DISPOSAL \_\_\_ 47 - 095 - 02798 McA  
 (IF "GAS") PRODUCTION X STORAGE \_\_\_ DEEP \_\_\_ SHALLOW X STATE COUNTY PERMIT  
 LOCATION: ELEVATION 1,222' - PROPOSED 1,247' - ORIGINAL WATERSHED OUTLET MIDDLE ISLAND CREEK  
 QUADRANGLE PORTER FALLS 7.5' DISTRICT ELLSWORTH COUNTY TYLER  
 SURFACE OWNER ANTERO MIDSTREAM LLC ACREAGE 50 ACRES +/-  
 OIL & GAS ROYALTY OWNER ELAINE L. OILER; H 3 LLC; HAUGHT FAMILY TRUST LEASE ACREAGE 50 AC.±; 14 AC.±; 16.25 AC.±

PROPOSED WORK: DRILL X CONVERT \_\_\_ DRILL DEEPER \_\_\_ REDRILL \_\_\_ FRACTURE OR STIMULATE X  
 PLUG OFF OLD FORMATION \_\_\_ PERFORATE NEW FORMATION X OTHER PHYSICAL CHANGE IN WELL  
 (SPECIFY) \_\_\_ PLUG & ABANDON \_\_\_ CLEAN OUT & REPLUG  
 TARGET FORMATION MARCELLUS ESTIMATED DEPTH 7,500' TVD 9,100' MD  
 WELL OPERATOR ANTERO RESOURCES CORP. DESIGNATED AGENT DIANNA STAMPER - CT CORPORATION SYSTEM  
 ADDRESS 1615 WYNKOOP ST. ADDRESS 5400 D BIG TYLER ROAD  
 FORM WW-6 DENVER, CO 80202 CHARLESTON, WV 25313

COUNTY NAME

PERMIT

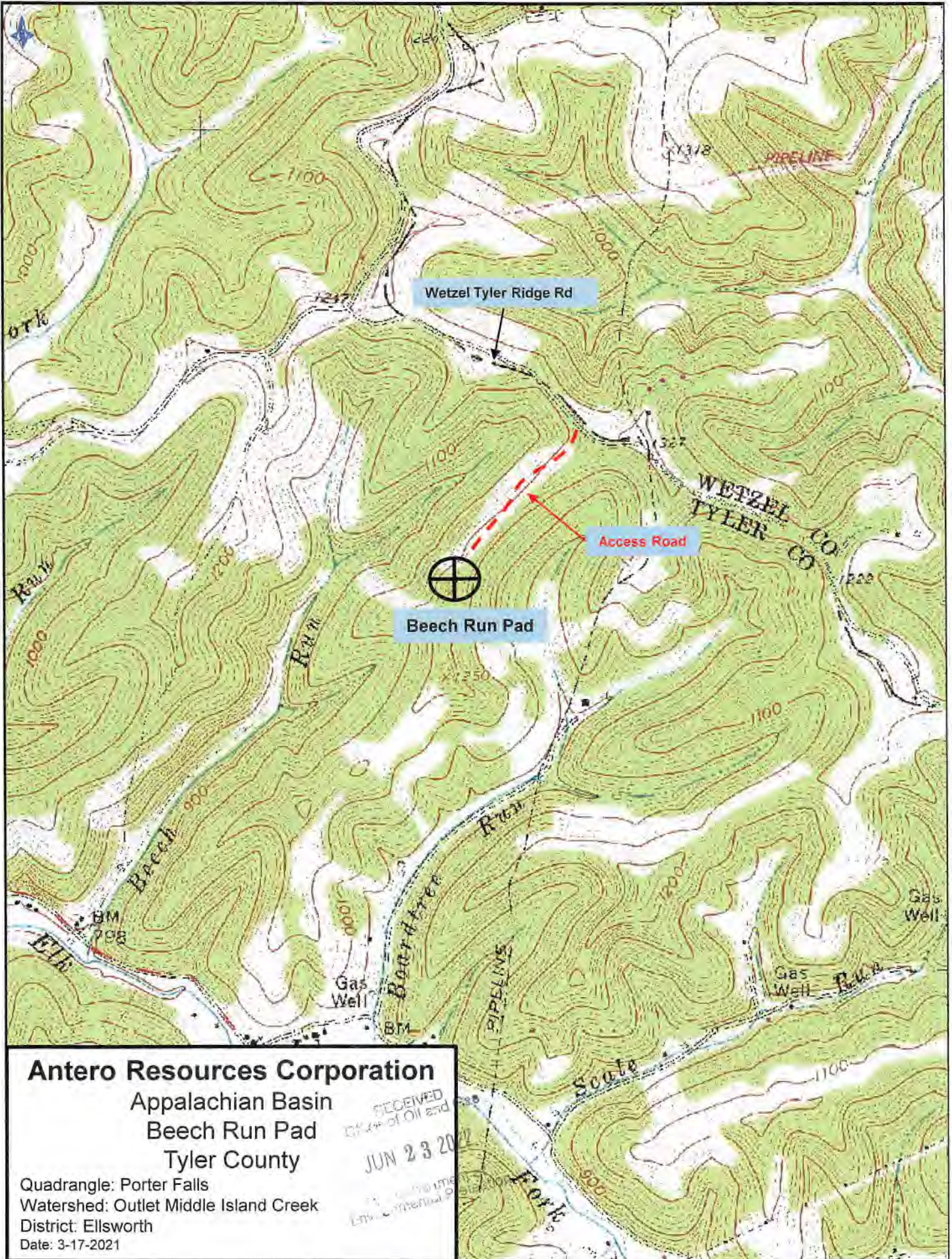

**Antero Resources Corporation**

Appalachian Basin

Beech Run Pad

Tyler County

Quadrangle: Porter Falls

Watershed: Outlet Middle Island Creek

District: Ellsworth

Date: 3-17-2021

RECEIVED  
State of Oil and Gas  
JUN 23 2021