

LATITUDE 39°32'30"

9,126'

LATITUDE 39°30'00"

2,337' TO BOTTOM HOLE

Antero Resources Corporation
Well No. Atwood Unit 1H

AS DRILLED DATA:
WELL 1H TOP HOLE INFORMATION:
N: 377,217ft E: 1,638,297ft
LAT: 39°31'42.94" LON: 80°46'56.48"
BOTTOM HOLE INFORMATION:
N: 362,514ft E: 1,644,883ft
LAT: 39°29'18.55" LON: 80°45'29.81"
WEST VIRGINIA COORDINATE SYSTEM OF 1927 NORTH ZONE.
SYSTEM WAS DERIVED FROM MEASUREMENTS TAKEN WITH TRIMBLE GEOXT SUBMETER MAPPING GRADE GPS UNIT. PLAT ORIENTATION, CORNER, AND WELL REFERENCE TIE LINES ARE BASED ON GRID NORTH.

(NAD) 83 (UTM) ZONE 17 COORDS:
WELL 1H TOP HOLE INFORMATION:
N: 4,375,469m E: 518,720m
BOTTOM HOLE INFORMATION:
N: 4,371,023m E: 520,801m

(NAD) 27 (UTM) ZONE 17 COORDS:
WELL 1H TOP HOLE INFORMATION:
N: 14,354,470ft E: 1,701,787ft
POINT OF ENTRY INFORMATION:
N: 14,354,910ft E: 1,703,368ft
BOTTOM HOLE INFORMATION:
N: 14,339,884ft E: 1,708,615ft

MINERAL OWNERSHIP

A	ELSIE M. SWEELY
B	BLAINE LOILER
C	OMA ANN FERRELL
D	JON MICHAEL DUMARS ETUX
E	HAUCHT FAMILY TRUST
F	H 3 LLC
G	CLARENCE MUTSCHELKNAUS
H	ROBERT LOUIS BARD
I	ELIZABETH ANN GREENLIEF
K	SUSAN LANCASTER GREEN
M	ELIZABETH C. MORRISON RICHIE
N	CLARENCE MUTSCHELKNAUS, SR. ET AL
O	BRC APPALACHIAN MINERALS I LLC
P	H 3 LLC
Q	BILLIE BLOYD
R	JETT CARNEY GILL
S	BRC APPALACHIAN MINERALS I LLC
T	ED BROOME INC.
U	BRC APPALACHIAN MINERALS I LLC
V	ANDREW HAUCHT ET UX
W	KAREN & ROGER ENTERPRISES LLC
X	JENNIFER PARFITT
Y	JENNIFER PARFITT

ELLSWORTH DISTRICT - TYLER COUNTY

12-05	ROSALIE HENRY
12-06	ANTERO MIDSTREAM LLC
12-07	COASTAL FOREST RESOURCES CO.
12-09	COASTAL FOREST RESOURCES CO.
12-14	ANTERO MIDSTREAM LLC
12-15	PATRICIA NYE
12-16	PATRICIA NYE
12-17	ANTERO MIDSTREAM LLC
12-18	ANTERO MIDSTREAM LLC
12-19	JON DUMARS
12-20	SHA YOHO
12-20.1	SHA YOHO
12-21	SHA YOHO
12-22	RALPH THACKER
12-23	ROBERT BARD
12-24	CHARLES EASTHAM
12-25	MARGARET LANCASTER
12-26	MARGARET LANCASTER
12-32	CARL WILCOX

ELLSWORTH DISTRICT - TYLER COUNTY

17-04	ERWAIN PECK
17-07	GILBERT EDDY
17-08	RICHARD MATORIKOWSKI
17-09	ERWAIN PECK
17-10	THOMAS JOBES
17-10.1	CHARLES EASTHAM
17-10.2	THOMAS JOBES
17-11	ELIZABETH RICHIE
17-12	FREDERICK SHATZER
17-13	CHARLES EASTHAM
17-14	WILLIAM TITUS
17-14.1	AMUEL LEEK
17-14.2	SANDRA SHREVE
17-14.3	FRED SHREVE
17-14.4	FRED SHREVE
17-14.5	PEGGY LOUB
17-14.6	RONALD SHAVER
17-14.7	MICHAEL MARTIN
17-14.8	SANDRA SHREVE
17-14.9	FRED SHREVE
17-14.10	MICHAEL MARTIN
17-15	JEROME FLAUGHER
17-19	CLARENCE CLARK
17-20	KEITH MALINIKY
17-20.1	KEITH MALINIKY
17-21	RODNEY ADAMS
17-22	STEVEN MELOTT
17-23	MARJORIE STALEY
17-24	SHAWNNA STALEY
17-24.1	DAWN HADLEY
17-25	ELIZABETH MENGES
17-26	RICHARD NEFF
17-27	HAMMETT LAND & MINERALS LLC
17-28	ARTHUR PECK
17-29	HAMMETT LAND & MINERALS LLC
17-32	SHALYN MCGRAW
17-37	BONNIE HENTHORN
17-37.1	JOHN COOPER
17-37.2	PATRICK KELLER
17-38	PATRICK KELLER
17-38.1	PATRICK KELLER
17-39	PATRICK KELLER
17-39.1	PATRICK KELLER
17-39.2	PATRICK KELLER
17-40.1	RODNEY ADAMS
17-41	ROBERT BALL
17-45	EQT PRODUCTION CO.
17-46	EQT PRODUCTION CO.
17-47	JOHN BASSETT
17-48	JEREMY JURY
17-49	MARTHA MENGES
17-51	MARTHA MENGES
17-51	JONATHAN COOPER
17-52	ANTERO RESOURCES CORP.
17-59	MICHAEL BEEGLE
23-11	JENNIFER WILLIAMS
23-12	TERRY JOY
23-13	JOSEPH FERRELL
23-14	WANDA PARR
23-15	HARLEY LEMASTERS
23-16	RICK STALEY
23-17	RICK STALEY
23-18	RICK STALEY
23-28	RICHARD NEFF

WV NORTH ZONE GRID NORTH

4,171' TO BOTTOM HOLE
LONGITUDE 80°45'00"
LONGITUDE 80°45'00"

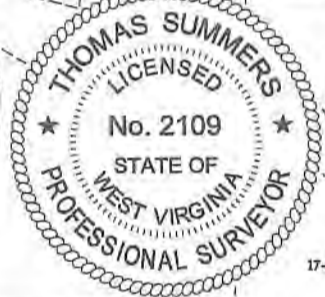

I THE UNDERSIGNED, HEREBY CERTIFY THAT THIS PLAT IS CORRECT TO THE BEST OF MY KNOWLEDGE AND BELIEF AND SHOWS ALL THE INFORMATION REQUIRED BY LAW AND THE RULES ISSUED AND PERSCRIBED BY THE DEPARTMENT OF ENVIRONMENTAL PROTECTION.



STATE OF WEST VIRGINIA, DIVISION OF ENVIRONMENTAL PROTECTION, OFFICE OF OIL AND GAS
WILLOW LAND SURVEYING PLLC
220 MASONIC AVE. PENNSBORO WEST VIRGINIA 26415

MCLEROY DISTRICT - TYLER COUNTY

2-04	LLOYD WEEKLEY
2-9.2	WILLIAM LACY
2-9.3	SANDRA JOCHUM
2-10	WANDA PARR
2-11	THOMAS FERRELL

JOB # 20-014WA
DRAWING # ATWOOD1HAD
SCALE 1" = 2000'
MINIMUM DEGREE OF ACCURACY SUBMETER
PROVEN SOURCE OF ELEV. SUBMETER MAPPING GRADE GPS

LEGEND
--- Surface Owner Boundary Lines +/-
--- Interior Surface Tracts +/-
--- Proposed Well Path
--- As Drilled Well Path
THOMAS SUMMERS P.S. 2109

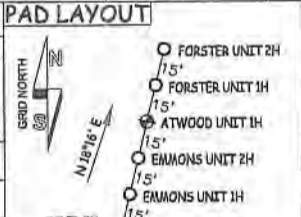

NOTE
1. NO OCCUPIED DWELLINGS OR BUILDINGS TWO THOUSAND FIVE HUNDRED (2,500) SQUARE FEET OR LARGER USED TO HOUSE OR SHELTER DAIRY CATTLE OR POULTRY HUSBANDRY ARE LOCATED WITHIN SIX HUNDRED TWENTY-FIVE (625) FEET OF THE CENTER OF THE WELL PAD.
2. TOP HOLE DATA SHOWN HEREON WAS PROVIDED BY ANTERO RESOURCES CORPORATION.
3. AS DRILLED DATA WAS PROVIDED BY ANTERO RESOURCES CORPORATION.
4. WLS IS NOT CERTIFYING THE DATA AND INFORMATION PROVIDED LISTED IN NOTES 2 AND 3, ONLY THE RELATIONSHIP TO THE DATA AND INFORMATION PROVIDED TO THE LEASE BOUNDARIES.
5. WLS IS BY NO MEANS RESPONSIBLE FOR ANY ERRORS OR INACCURACIES WITH THE DATA AND INFORMATION THAT HAS BEEN PROVIDED.

STATE OF WEST VIRGINIA DEPARTMENT OF ENERGY DIVISION OF OIL AND GAS

DATE 05/11/23
OPERATOR'S WELL# ATWOOD UNIT #1H

WELL TYPE: OIL ___ GAS X LIQUID INJECTION ___ WASTE DISPOSAL ___ 47 - 095 - 02798
(IF "GAS") PRODUCTION X STORAGE ___ DEEP ___ SHALLOW X STATE COUNTY PERMIT
LOCATION: ELEVATION 1,223'-AS BUILT WATERSHED OUTLET MIDDLE ISLAND CREEK
QUADRANGLE PORTER FALLS 7.5' DISTRICT ELLSWORTH COUNTY TYLER

SURFACE OWNER ANTERO MIDSTREAM LLC ACREAGE 50 ACRES +/-
OIL & GAS ROYALTY OWNER ELAINE L. OILER; H 3 LLC; HAUCHT FAMILY TRUST; CLARENCE MUTSCHELKNAUS; LEASE ACREAGE 50 AC +/- 14 AC +/- 6.25 AC +/- 6 AC +/-

ELIZABETH ANN GREENLIEF; ROBERT LOUIS BARD; SUSAN LANCASTER GREEN; CLARENCE MUTSCHELKNAUS, SR. ET AL; 24 AC +/- 30 AC +/- 49.33 AC +/- 71.75 AC +/-
BRC APPALACHIAN MINERALS I LLC; H 3 LLC; BILLIE BLOYD; JETT CARNEY GILL; ED BROOME INC.; ANDREW HAUCHT ET UX; 93.25 AC +/- 40.75 AC +/- 70 AC +/- 10.38 AC +/- 109.25 AC +/- 351.25 AC +/-
JENNIFER PARFITT; JENNIFER PARFITT 13 AC +/- 15.5 AC +/-

PROPOSED WORK: DRILL ___ CONVERT ___ DRILL DEEPER ___ REDRILL ___ FRACTURE OR STIMULATE ___
PLUG OFF OLD FORMATION ___ PERFORATE NEW FORMATION ___ OTHER PHYSICAL CHANGE IN WELL
(SPECIFY) AS DRILLED PLUG & ABANDON CLEAN OUT & REPLUG
TARGET FORMATION MARCELLUS ESTIMATED DEPTH 6,991' TVD 23,282' MD
WELL OPERATOR ANTERO RESOURCES CORP. DESIGNATED AGENT KEVIN ELLIS

ADDRESS 1615 WYNKOOP ST. ADDRESS 535 WHITE OAKS BLVD
DENVER, CO 80202 BRIDGEPORT, WV 26330

COUNTY NAME PERMIT

09/22/2023