

State of West Virginia
Department of Environmental Protection - Office of Oil and Gas
Well Operator's Report of Well Work

API 47 - 095 - 02803 County Tyler District Ellsworth
Quad Porter Falls 7.5' Pad Name Furbee Field/Pool Name -----
Farm name Antero Midstream LLC Well Number Forster Unit 1H
Operator (as registered with the OOG) Antero Resources Corporation
Address 1615 Wynkoop Street City Denver State CO Zip 80202

As Drilled location NAD 83/UTM Attach an as-drilled plat, profile view, and deviation survey
Top hole Northing 4375474m Easting 518721m
Landing Point of Curve Northing 4375300.59m Easting 518809.26m
Bottom Hole Northing 4371174m Easting 520242m

Elevation (ft) 1223' GL Type of Well New Existing Type of Report Interim Final
Permit Type Deviated Horizontal Horizontal 6A Vertical Depth Type Deep Shallow
Type of Operation Convert Deepen Drill Plug Back Redrilling Rework Stimulate
Well Type Brine Disposal CBM Gas Oil Secondary Recovery Solution Mining Storage Other _____
Type of Completion Single Multiple Fluids Produced Brine Gas NGL Oil Other _____
Drilled with Cable Rotary

Drilling Media Surface hole Air Mud Fresh Water Intermediate hole Air Mud Fresh Water Brine
Production hole Air Mud Fresh Water Brine
Mud Type(s) and Additive(s)
Air - Foam & 4% KCL
Mud - Polymer

RECEIVED
Office of Oil and Gas

JUN 23 2023

Date permit issued 7/26/2022 Date drilling commenced 9/30/2022 Date drilling ceased 12/27/2022
Date completion activities began 2/28/2023 Date completion activities ceased 4/1/2023
Verbal plugging (Y/N) N/A Date permission granted N/A Granted by N/A

Please note: Operator is required to submit a plugging application within 5 days of verbal permission to plug

Freshwater depth(s) ft 880' Open mine(s) (Y/N) depths No
Salt water depth(s) ft 959' Void(s) encountered (Y/N) depths No
Coal depth(s) ft 431' Cavern(s) encountered (Y/N) depths No
Is coal being mined in area (Y/N) No

Reviewed by:

APPROVED

09/22/2023

API 47-095 - 02803 Farm name Antero Midstream LLC Well number Forster Unit 1H

CASING STRINGS	Hole Size	Casing Size	Depth	New or Used	Grade wt/ft	Basket Depth(s)	Did cement circulate (Y/N) * Provide details below*
Conductor	28"	20"	125.5'	New	78.67#, X-60	N/A	Y
Surface	17-1/2"	13-3/8"	988'	New	54.5#, J-55	N/A	Y
Coal							
Intermediate 1	12-1/4"	9-5/8"	3369'	New	36#, J-55	N/A	Y
Intermediate 2							
Intermediate 3							
Production	8-3/4"/8-1/2"	5-1/2"	22041'	New	23#, P-110	N/A	Y
Tubing		2-3/8"	6924'		4.7#, P-110		
Packer type and depth set		N/A					

Comment Details _____

CEMENT DATA	Class/Type of Cement	Number of Sacks	Slurry wt (ppg)	Yield (ft ³ /sks)	Volume (ft ³)	Cement Top (MD)	WOC (hrs)
Conductor	Class A	198 sx	15.6	1.18	233	0'	8 Hrs.
Surface	Class A	739 sx	15.6	1.20	886	0'	8 Hrs.
Coal							
Intermediate 1	Class A	1120 sx	15.6	1.20	1344	0'	8 Hrs.
Intermediate 2							
Intermediate 3							
Production	Class H	3503 sx (Tail)	13.5 (Lead), 15.2(Tail)	1.26 (Tail)	4413	-500' into Intermediate Casing	8 Hrs.
Tubing							

Drillers TD (ft) 22041' MD, 6994' TVD (BHL), 6994' TVD (Deepest Point Drilled) Loggers TD (ft) 22041' MD Office of Oil and Gas
 Deepest formation penetrated Marcellus Plug back to (ft) N/A
 Plug back procedure N/A RECEIVED JUN 23 2023

Kick off depth (ft) ^{6026'} _____ WV Department of Environmental Protection

Check all wireline logs run caliper density deviated/directional induction
 neutron resistivity gamma ray temperature sonic

Well cored Yes No Conventional Sidewall Were cuttings collected Yes No

DESCRIBE THE CENTRALIZER PLACEMENT USED FOR EACH CASING STRING _____

Conductor - 0
 Surface - 1 above guide shoe, 1 above insert float, 1 every 4th joint to surface
 Intermediate - 1 above float joint, 1 above float collar, 1 every 4th joint to surface
 Production - 1 above float joint, 1 below float collar, 1 every 3rd joint to top of cement

WAS WELL COMPLETED AS SHOT HOLE Yes No DETAILS _____

WAS WELL COMPLETED OPEN HOLE? Yes No DETAILS _____

WERE TRACERS USED Yes No TYPE OF TRACER(S) USED N/A

09/22/2023 

EXHIBIT 1

Stage No.	Perforation Date	Perforated from MD ft.	Perforated to MD ft.	Number of Perforations	Formations
1	2/28/2023	21915.6	21873	60	Marcellus
2	3/1/2023	21833.69583	21666.175	60	Marcellus
3	3/1/2023	21630.27083	21462.75	60	Marcellus
4	3/1/2023	21426.84583	21259.325	60	Marcellus
5	3/1/2023	21223.42083	21055.9	60	Marcellus
6	3/2/2023	21019.99583	20852.475	60	Marcellus
7	3/2/2023	20816.57083	20649.05	60	Marcellus
8	3/2/2023	20613.14583	20445.625	60	Marcellus
9	3/2/2023	20409.72083	20242.2	60	Marcellus
10	3/2/2023	20206.29583	20038.775	60	Marcellus
11	3/2/2023	20002.87083	19835.35	60	Marcellus
12	3/3/2023	19799.44583	19631.925	60	Marcellus
13	3/3/2023	19596.02083	19428.5	60	Marcellus
14	3/3/2023	19392.59583	19225.075	60	Marcellus
15	3/3/2023	19189.17083	19021.65	60	Marcellus
16	3/4/2023	18985.74583	18818.225	60	Marcellus
17	3/4/2023	18782.32083	18614.8	60	Marcellus
18	3/4/2023	18578.89583	18411.375	60	Marcellus
19	3/4/2023	18375.47083	18207.95	60	Marcellus
20	3/4/2023	18172.04583	18004.525	60	Marcellus
21	3/5/2023	17968.62083	17801.1	60	Marcellus
22	3/5/2023	17765.19583	17597.675	60	Marcellus
23	3/5/2023	17561.77083	17394.25	60	Marcellus
24	3/6/2023	17358.34583	17190.825	60	Marcellus
25	3/6/2023	17154.92083	16987.4	60	Marcellus
26	3/6/2023	16951.49583	16783.975	60	Marcellus
27	3/6/2023	16748.07083	16580.55	60	Marcellus
28	3/6/2023	16544.64583	16377.125	60	Marcellus
29	3/6/2023	16341.22083	16173.7	60	Marcellus
30	3/7/2023	16137.79583	15970.275	60	Marcellus
31	3/7/2023	15934.37083	15766.85	60	Marcellus
32	3/7/2023	15730.94583	15563.425	60	Marcellus
33	3/7/2023	15527.52083	15360	60	Marcellus
34	3/7/2023	15324.09583	15156.575	60	Marcellus
35	3/8/2023	15120.67083	14953.15	60	Marcellus
36	3/8/2023	14917.24583	14749.725	60	Marcellus
37	3/8/2023	14713.82083	14546.3	60	Marcellus
38	3/8/2023	14510.39583	14342.875	60	Marcellus
39	3/8/2023	14306.97083	14139.45	60	Marcellus
40	3/8/2023	14103.54583	13936.025	60	Marcellus
41	3/9/2023	13900.12083	13732.6	60	Marcellus
42	3/9/2023	13696.69583	13529.175	60	Marcellus
43	3/9/2023	13493.27083	13325.75	60	Marcellus
44	3/9/2023	13289.84583	13122.325	60	Marcellus
45	3/9/2023	13086.42083	12918.9	60	Marcellus
46	3/10/2023	12882.99583	12715.475	60	Marcellus
47	3/10/2023	12679.57083	12512.05	60	Marcellus
48	3/10/2023	12476.14583	12308.625	60	Marcellus
49	3/10/2023	12272.72083	12105.2	60	Marcellus
50	3/10/2023	12069.29583	11901.775	60	Marcellus
51	3/10/2023	11865.87083	11698.35	60	Marcellus
52	3/11/2023	11662.44583	11494.925	60	Marcellus
53	3/11/2023	11459.02083	11291.5	60	Marcellus
54	3/11/2023	11255.59583	11088.075	60	Marcellus
55	3/11/2023	11052.17083	10884.65	60	Marcellus
56	3/11/2023	10848.74583	10681.225	60	Marcellus
57	3/11/2023	10645.32083	10477.8	60	Marcellus
58	3/11/2023	10441.89583	10274.375	60	Marcellus
59	3/12/2023	10238.47083	10070.95	60	Marcellus
60	3/12/2023	10035.04583	9867.525	60	Marcellus
61	3/12/2023	9807.57	9664.12	60	Marcellus
62	3/12/2023	9628.19583	9460.675	60	Marcellus
63	3/12/2023	9424.77083	9257.25	60	Marcellus
64	3/12/2023	9221.34583	9053.825	60	Marcellus
65	3/13/2023	9017.92083	8850.4	60	Marcellus
66	3/13/2023	8814.49583	8646.975	60	Marcellus
67	3/13/2023	8611.07083	8443.55	60	Marcellus
68	3/13/2023	8407.64583	8240.125	60	Marcellus
69	3/13/2023	8204.22083	8036.7	60	Marcellus
70	3/13/2023	8000.79583	7833.275	60	Marcellus
71	3/14/2023	7797.37083	7629.85	60	Marcellus
72	3/14/2023	7593.94583	7426.425	60	Marcellus
73	3/14/2023	7390.52083	7223	60	Marcellus

RECEIVED
Office of Oil and Gas
JUN 23 2023
WV Department of
Environmental Protection

09/22/2023

EXHIBIT 2

Stage No.	Stimulations Date	Avg Pump Rate	Avg Treatment Pressure (PSI)	Breakdown Pressure (PSI)	ISIP (PSI)	Amount of Proppant (lbs)	Amount of Water (bbls)	Amount of Nitrogen/ other (units)
1	2/28/2023	69.5	9365	6073.72	3368.869	171320	220217	N/A
2	3/1/2023	88.17	9508	5926	4021	408590	317133	N/A
3	3/1/2023	86.74	9476	6188	4432	412500	399951	N/A
4	3/1/2023	93.83	10021	6838	4128	413680	297162	N/A
5	3/1/2023	95.43	10002	6343	4026	406130	303302	N/A
6	3/2/2023	95.37	9950	4236	4511	410230	308572	N/A
7	3/2/2023	95.64	9995	6905	3811	411710	296143	N/A
8	3/2/2023	96.61	10037	4600	4251	399270	295169	N/A
9	3/2/2023	90.34	9521	5803	4440	418890	299364	N/A
10	3/2/2023	96.61	9994	4994	4056	411760	297163	N/A
11	3/2/2023	94.74	9758	6166	4057	406160	320810	N/A
12	3/3/2023	93.41	9951	6914	4411	411540	299372	N/A
13	3/3/2023	96.26051	9990.31	5385.32	4288.9	410730	300786	N/A
14	3/3/2023	93.51	9955	5666	3698	415092	303161	N/A
15	3/3/2023	93.54	9749	6114	4005	411250	306090	N/A
16	3/4/2023	96.72	9978	5916	4019	411970	299691	N/A
17	3/4/2023	97.33	10046	6290	4017	414170	295441	N/A
18	3/4/2023	95.97	9876	6653	3970	401420	299765	N/A
19	3/4/2023	98.57	9901	6784	3816	408340	299184	N/A
20	3/4/2023	97.32	9867	6262	4008	387150	286358	N/A
21	3/5/2023	97.16	9880	6305	4135	411640	300522	N/A
22	3/5/2023	98.33	9883	6152	4079	423800	297380	N/A
23	3/5/2023	96.89	9873	6038	4056	415590	306998	N/A
24	3/6/2023	93.72	9554	5931	4002	415280	299870	N/A
25	3/6/2023	96.88	9994	6179	4005	386620	280392	N/A
26	3/6/2023	97.84	9948	5839	4062	414850	283846	N/A
27	3/6/2023	98.48	10034	4650	4145	398380	287384	N/A
28	3/6/2023	97.52	9653	5685	4041	412440	294752	N/A
29	3/6/2023	96.33	9664	6138	4003	419210	301088	N/A
30	3/7/2023	97.34	9705	5774	4040	409660	292264	N/A
31	3/7/2023	97.58	9546	5875	4019	398350	286400	N/A
32	3/7/2023	98.3035	9550.926	6203.82	3722.248	409770	292037	N/A
33	3/7/2023	96.81	9316	6137	4024	418790	297338	N/A
34	3/7/2023	97.26	9272	5883	4006	406750	296335	N/A
35	3/8/2023	97.16465	9318.559	5847.66	3983.176	405780	288780	N/A
36	3/8/2023	96.59	9521	6083	4002	415100	297748	N/A
37	3/8/2023	98.02	9362	5530	4811	410650	346122	N/A
38	3/8/2023	97.62	8987	5115	3983	414910	293492	N/A
39	3/8/2023	99.19	9170	6023	4203	416660	297187	N/A
40	3/8/2023	97.25	9119	6601	4027	416980	299510	N/A
41	3/9/2023	97.58	8859	6517	4045	407450	294908	N/A
42	3/9/2023	97.45	9004	6471	3665	417100	306458	N/A
43	3/9/2023	97.76	8995	6169	3946	410630	292637	N/A
44	3/9/2023	96.84	8786	6578	3732	409860	289601	N/A
45	3/9/2023	97.24	8887	6766	4006	814600	292817	N/A
46	3/10/2023	97.44	8962	6201	4067	419760	299909	N/A
47	3/10/2023	96.78	8631	6421	4011	405100	292565	N/A
48	3/10/2023	96.23	8988	6168	3896	415890	293320	N/A
49	3/10/2023	94.97	8998	6231	3588	406660	285786	N/A
50	3/10/2023	96.36	8697	5761	3640	414940	291008	N/A
51	3/10/2023	97.31	8577	5596	4008	409850	293611	N/A
52	3/11/2023	97.61	8635	6505	4029	417220	299281	N/A
53	3/11/2023	97.67	8846	7477	4082	418840	297136	N/A
54	3/11/2023	97.64	8574	6542	4101	415270	296852	N/A
55	3/11/2023	98.02	8561	6017	3872	418230	293552	N/A
56	3/11/2023	97.48	8832	6112	3583	416650	292121	N/A
57	3/11/2023	98.35	8311	5884	4014	411080	290056	N/A
58	3/11/2023	97.41	8391	6473	4066	417010	294525	N/A
59	3/12/2023	97.44	8581	6098	4045	418140	298123	N/A
60	3/12/2023	98.33	8476	5559	3652	417460	299465	N/A
61	3/12/2023	97.35	8312	3706	3607	418840	303149	N/A
62	3/12/2023	98.72	8707	5547	3725	400370	286270	N/A
63	3/12/2023	98.24	8375	5515	4017	403700	286123	N/A
64	3/12/2023	98.02	8497	5730	3940	418110	295322	N/A
65	3/13/2023	97.89	8006	5098	4005	415300	297910	N/A
66	3/13/2023	97.5	8001	5296	3895	401320	287593	N/A
67	3/13/2023	99.25	8162	5722	3776	419020	300226	N/A
68	3/13/2023	99.22	7932	5461	3745	401070	289293	N/A
69	3/13/2023	97.64	7754	5584	4087	416950	297758	N/A
70	3/13/2023	97.42	7702	5207	4044	388080	283480	N/A
71	3/14/2023	97.71	7975	6034	4045	417520	300360	N/A
72	3/14/2023	99.17	7760	5387	3626	406770	295137	N/A
73	3/14/2023	98.73	7443	6459	3947	412570	296538	N/A
AVERAGE		96.4	9,144	5,950	3,989	30,164,472	21,697,169	0

RECEIVED
Office of Oil and Gas

JUN 23 2023

WV Department of
Environmental Protection

09/22/2023 *JM*

EXHIBIT 3

LITHOLOGY/ FORMATION	TOP DEPTH (TVD)	BOTTOM DEPTH (TVD)	TOP DEPTH (MD)	BOTTOM DEPTH (MD)
	From Surface	From Surface	From Surface	From Surface
Shaly Siltstone, tr LS	90	274	90	274
Sandy Siltstone, Coal	274	334	274	334
Silty Sandstone	334	424	334	424
Shaly Siltstone, occ LS	424	634	424	634
Sandy Siltstone, occ LS	634	964	634	964
Shaly Siltstone, occ SS	964	1,024	964	1,024
Shaly Siltstone	1,024	1,434	1,024	1,434
Sandy Siltstone, occ Shale	1,434	1,524	1,434	1,524
Silty Sandstone, tr coal	1,524	1,614	1,524	1,614
Silty Sandstone, coal, tr shale	1,614	1,734	1,614	1,734
Silty Sandstone, occ shale	1,734	1,884	1,734	1,884
Shaly Sandstone, coal, occ slst	1,884	2,124	1,884	2,124
Silty Sandstone, coal, occ Shale	2,124	2,076	2,124	2,077
Big Lime	2,102	2,782	2,077	2,783
Fifty Foot Sandstone	2,782	3,002	2,757	3,002
Gordon	3,002	3,212	2,976	3,213
Fifth Sandstone	3,212	3,450	3,187	3,450
Bayard	3,450	3,881	3,424	3,886
Speechley	3,881	4,131	3,860	4,142
Balltown	4,131	4,539	4,116	4,557
Bradford	4,539	5,099	4,531	5,124
Benson	5,099	5,567	5,098	5,602
Alexander	5,567	6,700	5,576	6,789
Sycamore	6,558	6,674	6,618	6,763
Middlesex	6,674	6,771	6,763	6,916
Burkett	6,771	6,805	6,916	6,986
Tully	6,805	6,866	6,986	7,175
Marcellus	6,866	NA	7,175	NA

RECEIVED
Office of Oil and Gas

JUN 23 2023

WV Department of
Environmental Protection

09/22/2023

LATITUDE 39°32'30"

9,123'

LATITUDE 39°30'00" 4,170' TO BOTTOM HOLE

Antero Resources Corporation Well No. Forster Unit 1H

AS DRILLED DATA: WELL 1H TOP HOLE INFORMATION: N: 377,232ft E: 1,638,300ft LAT: 39°31'43.09" LON: 80°46'56.44" BOTTOM HOLE INFORMATION: N: 363,037ft E: 1,643,057ft LAT: 39°29'23.46" LON: 80°45'53.19" WEST VIRGINIA COORDINATE SYSTEM OF 1927 NORTH ZONE. ZONE WAS DERIVED FROM MEASUREMENTS TAKEN WITH TRIMBLE GEOXT SAKETER MAPPING GRADE GPS UNIT. PLAT ORIENTATION, CORNER, AND WELL REFERENCE TIE LINES ARE BASED ON GRID NORTH.

(NAD) 83 (UTM) ZONE 17 COORDS: WELL 1H TOP HOLE INFORMATION: N: 4,375,474m E: 518,721m BOTTOM HOLE INFORMATION: N: 4,371,174m E: 520,242m

(NAD) 27 (UTM) ZONE 17 COORDS: WELL 1H TOP HOLE INFORMATION: N: 14,354,486ft E: 1,701,790ft POINT OF ENTRY INFORMATION: N: 14,354,410ft E: 1,702,003ft BOTTOM HOLE INFORMATION: N: 14,340,377ft E: 1,706,781ft

NOTE: 1 WATER WELL WAS LOCATED WITHIN 2000' OF THE CENTER OF PAD

WELL NO. 1H

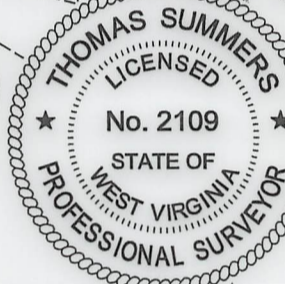

I THE UNDERSIGNED, HEREBY CERTIFY THAT THIS PLAT IS CORRECT TO THE BEST OF MY KNOWLEDGE AND BELIEF AND SHOWS ALL THE INFORMATION REQUIRED BY LAW AND THE RULES ISSUED AND PERSCRIBED BY THE DEPARTMENT OF ENVIRONMENTAL PROTECTION.



STATE OF WEST VIRGINIA, DIVISION OF ENVIRONMENTAL PROTECTION, OFFICE OF OIL AND GAS

WILLOW LAND SURVEYING PLLC 220 MASONIC AVE. PENNSBORO WEST VIRGINIA 26415

JOB # 20-014WA DRAWING # FORSTER1HAD SCALE 1" = 2000' MINIMUM DEGREE OF ACCURACY SUBMETER PROVEN SOURCE OF ELEV. SUBMETER MAPPING GRADE GPS

LEGEND: Surface Owner Boundary Lines +/- Interior Surface Tracts +/- Proposed Well Path As Drilled Well Path

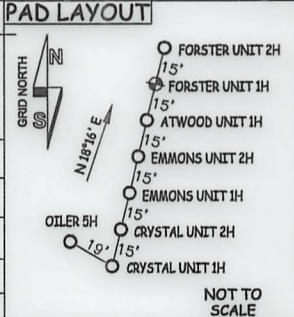

NOTE: 1. NO OCCUPIED DWELLINGS OR BUILDINGS TWO THOUSAND FIVE HUNDRED (2,500) SQUARE FEET OR LARGER USED TO HOUSE OR SHELTER DAIRY CATTLE OR POULTRY HUSBANDRY ARE LOCATED WITHIN SIX HUNDRED TWENTY-FIVE (625) FEET OF THE CENTER OF THE WELL PAD.

STATE OF WEST VIRGINIA DEPARTMENT OF ENERGY DIVISION OF OIL AND GAS

DATE 05/11/23 OPERATOR'S WELL# FORSTER UNIT #1H

WELL TYPE: OIL ___ GAS X LIQUID INJECTION ___ WASTE DISPOSAL ___ 47 - 095 - 02803 (IF "GAS") PRODUCTION X STORAGE ___ DEEP ___ SHALLOW X STATE COUNTY PERMIT LOCATION: ELEVATION 1,223' -AS BUILT WATERSHED OUTLET MIDDLE ISLAND CREEK QUADRANGLE PORTER FALLS 7.5' DISTRICT ELLSWORTH COUNTY TYLER SURFACE OWNER ANTERO MIDSTREAM LLC ACREAGE 50 ACRES +/-

OIL & GAS ROYALTY OWNER ELAINE L. OILER; ELSIE M. SNIVELY; JON MICHAEL DUMARS ET UX; ROBERT LOUIS BARD; LEASE ACREAGE 50 AC±: 53.75 AC±; 47.5 AC±; 30 AC±; VICTOR ALLEN CONWAY ET UX; JOYCE WILCOX; ELIZABETH G. MORRISON RICHIE; BRC APPALACHIAN MINERALS I LLC; BILLIE BLOYD; PHILLIP RONALD WILCOX; BRC APPALACHIAN MINERALS I LLC; BRC APPALACHIAN MINERALS I LLC; FIRST UNITED METHODIST CHURCH OF HUNTINGTON; 4.19 AC±; 29.67 AC±; 54.56 AC±; 93.25 AC±; 70 AC±; MARY JANE LEMASTERS; LOIS GAMBLE; DAVID E. BOWYER; TINA LOUISE ZEDIKER ET AL.; ANDREW HAUGHT ET UX 50 AC±; 10 AC±; 33 AC±; 35 AC±; 351.25 AC±

PROPOSED WORK: DRILL ___ CONVERT ___ DRILL DEEPER ___ REDRILL ___ FLAOURCE OR STIMULATE ___ PLUG OFF OLD FORMATION ___ PERFORATE NEW FORMATION ___ OTHER PHYSICAL CHANGE IN WELL (SPECIFY) AS DRILLED PLUG & ABANDON CLEAN OUT & REPLUG TARGET FORMATION MARCELLUS ESTIMATED DEPTH 6,994' TVD 22,041' MD WELL OPERATOR ANTERO RESOURCES CORP. DESIGNATED AGENT KEVIN ELLIS ADDRESS 1615 WYNKOOP ST. ADDRESS 535 WHITE OAKS BLVD BRIDGEPORT, WV 26330

FORM WW-6

DENVER, CO 80202

BRIDGEPORT, WV 26330

Table listing Mineral Ownerships with names and well identifiers.

Table listing land parcels with owner names and well identifiers.

WV NORTH ZONE GRID NORTH

3,697' TO BOTTOM HOLE

LONGITUDE 80°45'00"

4,747'

LONGITUDE 80°45'00"

09/22/2023

COUNTY NAME

PERMIT

LATITUDE 39°32'30"

9,123'

LATITUDE 39°30'00" +4,170' TO BOTTOM HOLE

Antero Resources Corporation Well No. Forster Unit 1H

AS DRILLED DATA: WELL 1H TOP HOLE INFORMATION: N: 377,232ft E: 1,638,300ft LAT: 39°31'43.09" LON: 80°46'56.44" BOTTOM HOLE INFORMATION: N: 363,037ft E: 1,643,057ft LAT: 39°29'23.46" LON: 80°45'53.19" WEST VIRGINIA COORDINATE SYSTEM OF 1927 NORTH ZONE. SYSTEM WAS DERIVED FROM MEASUREMENTS TAKEN WITH TRIMBLE GEOXT SUBMETER MAPPING GRADE GPS UNIT. PLAT ORIENTATION, CORNER, AND WELL REFERENCE TIE LINES ARE BASED ON GRID NORTH.

(NAD) 83 (UTM) ZONE 17 COORDS: WELL 1H TOP HOLE INFORMATION: N: 4,375,474m E: 518,721m BOTTOM HOLE INFORMATION: N: 4,371,174m E: 520,242m

(NAD) 27 (UTM) ZONE 17 COORDS: WELL 1H TOP HOLE INFORMATION: N: 14,354,486ft E: 1,701,790ft POINT OF ENTRY INFORMATION: N: 14,354,410ft E: 1,702,003ft BOTTOM HOLE INFORMATION: N: 14,340,377ft E: 1,706,781ft

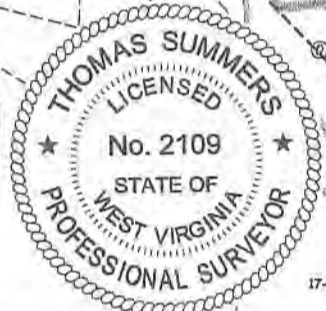
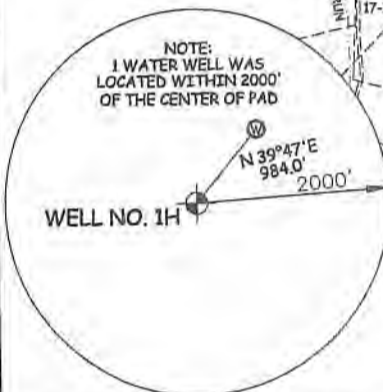

I THE UNDERSIGNED, HEREBY CERTIFY THAT THIS PLAT IS CORRECT TO THE BEST OF MY KNOWLEDGE AND BELIEF AND SHOWS ALL THE INFORMATION REQUIRED BY LAW AND THE RULES ISSUED AND PERSCRIBED BY THE DEPARTMENT OF ENVIRONMENTAL PROTECTION.



STATE OF WEST VIRGINIA, DIVISION OF ENVIRONMENTAL PROTECTION, OFFICE OF OIL AND GAS. WILLOW LAND SURVEYING PLLC 220 MASONIC AVE. PENNSBORO WEST VIRGINIA 26415

JOB # 20-014WA DRAWING # FORSTER1HAD SCALE 1" = 2000' MINIMUM DEGREE OF ACCURACY SUBMETER PROVEN SOURCE OF ELEV. SUBMETER MAPPING GRADE GPS

LEGEND: Surface Owner Boundary Lines +/- Interior Surface Tracts +/- Proposed Well Path As Drilled Well Path. Signature of Thomas Summers, P.S. 2109.

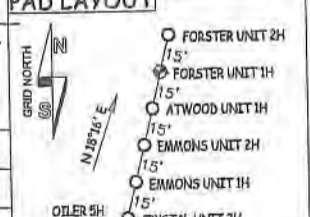

NOTE: 1. NO OCCUPIED DWELLINGS OR BUILDINGS TWO THOUSAND FIVE HUNDRED (2,500) SQUARE FEET OR LARGER USED TO HOUSE OR SHELTER DAIRY CATTLE OR POULTRY HUSBANDRY ARE LOCATED WITHIN SIX HUNDRED TWENTY-FIVE (625) FEET OF THE CENTER OF THE WELL PAD. 2. TOP HOLE DATA SHOWN HEREON WAS PROVIDED BY ANTERO RESOURCES CORPORATION. 3. AS DRILLED DATA WAS PROVIDED BY ANTERO RESOURCES CORPORATION. 4. WLS IS NOT CERTIFYING THE DATA AND INFORMATION PROVIDED LISTED IN NOTES 2 AND 3, ONLY THE RELATIONSHIP TO THE DATA AND INFORMATION PROVIDED TO THE LEASE BOUNDARIES. 5. WLS IS BY NO MEANS RESPONSIBLE FOR ANY ERRORS OR INACCURACIES WITH THE DATA AND INFORMATION THAT HAS BEEN PROVIDED.

STATE OF WEST VIRGINIA DEPARTMENT OF ENERGY DIVISION OF OIL AND GAS

DATE 05/11/23 OPERATOR'S WELL# FORSTER UNIT #1H

WELL TYPE: OIL GAS X LIQUID INJECTION WASTE DISPOSAL 47 095 02803 (IF "GAS") PRODUCTION X STORAGE DEEP SHALLOW X STATE COUNTY PERMIT LOCATION: ELEVATION 1,223' -AS BUILT WATERSHED OUTLET MIDDLE ISLAND CREEK QUADRANGLE PORTER FALLS 7.5 DISTRICT ELLSWORTH COUNTY TYLER SURFACE OWNER ANTERO MIDSTREAM LLC ACREAGE 50 ACRES +/-

OIL & GAS ROYALTY OWNER ELAINE L. OILER; ELSIE M. SNIVELY; JON MICHAEL DUMARS ET UX; ROBERT LOUIS BARD; LEASE ACREAGE 50 AC +/- 53.75 AC +/- 09/22/2023 VICTOR ALLEN CONWAY ET UX; JOYCE WILCOX; ELIZABETH G. MORRISON RICHIE; BRC APPALACHIAN MINERALS I LLC; BILLIE BLOYD; PHILLIP RONALD WILCOX; BRC APPALACHIAN MINERALS I LLC; BRC APPALACHIAN MINERALS I LLC; FIRST UNITED METHODIST CHURCH OF HUNTINGTON: 4.19 AC +/- 29.67 AC +/- 54.56 AC +/- 93.25 AC +/- 70 AC +/- MARY JANE LEMASTERS; LOIS GAMBLE; DAVID E. BOWYER; TINA LOUISE ZEDIKER ET AL.; ANDREW HAUGHT ET UX: 68 AC +/- 13 AC +/- 12 AC +/- 108.67 AC +/- 50 AC +/- 10 AC +/- 33 AC +/- 35 AC +/- 351.25 AC +/- PROPOSED WORK: DRILL CONVERT DRILL DEEPER REDRILL FRACTURE OR STIMULATE PLUG OFF OLD FORMATION PERFORATE NEW FORMATION OTHER PHYSICAL CHANGE IN WELL (SPECIFY) AS DRILLED PLUG & ABANDON CLEAN OUT & REPLUG TARGET FORMATION MARCELLUS ESTIMATED DEPTH 6,994' TVD 22,041' MD WELL OPERATOR ANTERO RESOURCES CORP. DESIGNATED AGENT KEVIN ELLIS ADDRESS 1615 WYNKOOP ST. ADDRESS 535 WHITE OAKS BLVD BRIDGEPORT, WV 26330

COUNTY NAME PERMIT

Handwritten initials 'CW' in the bottom right corner.

Hydraulic Fracturing Fluid Product Component Information Disclosure

Job Start Date:	2/28/2023
Job End Date:	3/14/2023
State:	West Virginia
County:	Tyler
API Number:	47-095-02803-00-00
Operator Name:	Antero Resources Corporation
Well Name and Number:	Beech Run Forster 1H
Latitude:	39.52836000
Longitude:	-80.78234000
Datum:	WGS84
Federal Well:	NO
Indian Well:	NO
True Vertical Depth:	6,992
Total Base Water Volume (gal):	22,710,142
Total Base Non Water Volume:	0



Hydraulic Fracturing Fluid Composition:

Trade Name	Supplier	Purpose	Ingredients	Chemical Abstract Service Number (CAS #)	Maximum Ingredient Concentration in Additive (% by mass)**	Maximum Ingredient Concentration in HF Fluid (% by mass)**	Comments
Produced Water	Halliburton	Base Fluid	Water				
					7732-18-5	100.00000	86.31510
Ingredients	Listed Above	Listed Above	Water				
					7732-18-5	100.00000	0.13482

Handwritten signature or initials in blue ink.

RECEIVED
 Office of Oil and Gas
 JUN 23 2023
 WV Department of
 Environmental Protection

WG-36 GELLING AGENT	Halliburton	Gelling Agent					
				Listed Below			
Chemstream StimSTREAM FR 2800	Chemstream, Inc.	Friction Reducer					
				Listed Below			
Sand-Common White-100 Mesh, SSA-2	Halliburton	Proppant					
				Listed Below			
HAI-501	Halliburton	Acid Corrosion Inhibitor					
				Listed Below			
HYDROCHLORIC ACID, 22 BAUME	Halliburton	Solvent					
				Listed Below			
MC B-8614A	MultiChem	Biocide					
				Listed Below			
OPTIFLO-II DELAYED RELEASE BREAKER	Halliburton	Breaker					
				Listed Below			
Items above are Trade Names with the exception of Base Water . Items below are the individual ingredients.							
			Crystalline silica, quartz	14808-60-7	100.00000	13.48789	
			Hydrochloric acid	7647-01-0	30.00000	0.03795	

RECEIVED
 Office of Oil and Gas
 JUN 23 2023
 WV Department of
 Environmental Protection

		Distillates, (petroleum), hydrotreated light	64742-47-8	25.00000	0.01429
		Guar gum	9000-30-0	100.00000	0.00467
		Alcohols, C11-14-iso, C-13-rich, ethoxylated	78330-21-9	5.00000	0.00286
		Glutaraldehyde	111-30-8	30.00000	0.00249
		Alkyl (C12-16) dimethylbenzyl ammonium chloride	68424-85-1	5.00000	0.00042
		Methanol	67-56-1	100.00000	0.00024
		Ammonium persulfate	7727-54-0	100.00000	0.00014
		Ethanol	64-17-5	1.00000	0.00008
		Mixture of dimer and trimer fatty acids of indefinite composition derived from tall oil	61790-12-3	30.00000	0.00007
		Modified thiourea polymer	Proprietary	30.00000	0.00007
		Oxylated phenolic resin	Proprietary	30.00000	0.00004
		Propargyl alcohol	107-19-7	5.00000	0.00001
		Hexadecene	629-73-2	5.00000	0.00001
		Ethoxylated alcohols	Proprietary	5.00000	0.00001
		C.I. pigment Orange 5	3468-63-1	1.00000	0.00000

* Total Water Volume sources may include various types of water including fresh water, produced water, and recycled water

** Information is based on the maximum potential for concentration and thus the total may be over 100%

*** If you are calculating a percentage of total ingredients do not add the water volume below the green line to the water volume above the green line

Note: For Field Development Products (products that begin with FDP), MSDS level only information has been provided.

Ingredient information for chemicals subject to 29 CFR 1910.1200(i) and Appendix D are obtained from suppliers Material Safety Data Sheets (MSDS)

RECEIVED
Office of Oil and Gas
JUN 23 2023
WV Department of
Environmental Protection