

(+) DENOTES LOCATION OF WELL ON UNITED STATES TOPOGRAPHIC MAPS

FILE NO. _____
DRAWING NO. 1
SCALE 1" = 2000'
MINIMUM DEGREE OF ACCURACY 1 in 200
PROVEN SOURCE OF ELEVATION GPS
submeter unit

I THE UNDERSIGNED, HEREBY CERTIFY THAT THIS PLAT IS CORRECT TO THE BEST OF MY KNOWLEDGE AND BELIEF AND SHOWS ALL THE INFORMATION REQUIRED BY LAW AND THE RULES ISSUED AND PRESCRIBED BY THE DEPARTMENT OF ENVIRONMENTAL PROTECTION.

(SIGNED) David L Jackson
R.P.E. _____ P.S. 708

WV Department of Environmental Protection

RECEIVED
Office of Oil & Gas
JUL 05 2022

DAVID JACKSON
LICENSED
No. 708
STATE OF WEST VIRGINIA
PROFESSIONAL SURVEYOR

STATE OF WEST VIRGINIA
Division of Environmental Protection
OFFICE OF OIL AND GAS

DATE June 11, 2022
OPERATOR'S WELL NO. TI-03-1A
API WELL NO. _____

WELL TYPE: OIL GAS LIQUID INJECTION WASTE DISPOSAL STATE COUNTY PERMIT
(IF "GAS") PRODUCTION X STORAGE DEEP SHALLOW

LOCATION: ELEVATION 724.0' WATER SHED Big Run of Outlet Middle Island Creek (HUC-10)
DISTRICT McElroy COUNTY Tyler
QUADRANGLE Shirley 7 1/2'

SURFACE OWNER Edsel Hoover, Jr., Eileen Young, Terry & Terese Jackson ACREAGE 112.25 ac.
OIL & GAS ROYALTY OWNER J.E. Spence LEASE ACREAGE 639 ac
LEASE NO. TI-03 See Page 2

PROPOSED WORK: DRILL X CONVERT DRILL DEEPER REDRILL FRACTURE OR
STIMULATE X PLUG OFF OLD FORMATION PERFORATE NEW
FORMATION OTHER PHYSICAL CHANGE IN WELL (SPECIFY)

PLUG AND ABANDON CLEAN OUT AND REPLUG
TARGET FORMATION Marcellus ESTIMATED DEPTH TVD: 6,400'; TMD 15,622'
WELL OPERATOR Jay-Bee Oil & Gas, Inc. DESIGNATED AGENT Deborah Broda-Morgan
ADDRESS 16 South Avenue W, Ste 118, Cranford NJ 07016 ADDRESS 429 Simonton Road, Ellenboro, WV 26346

Bottom Hole 9,252'
Top Hole 3,509'
LONGITUDE 80-45-00 N (BH)
LONGITUDE 80-47-30 N (TH)

08/12/2022

form wv6

Tags	Number	Tax Map -Parcel	Surface Owner	Acres
A	S1	05-05-15	EDSEL HOOVER, TERRY & TERESA JACKSON, & EILEEN YOUNG	112.25
C	S2	05-10-04	DONALD J LISBY & JUDITH A LISBY	80
D	S3	P/O 05-10-12	JOSEPH BOYD	10.25
E	S4	P/O 05-10-12	JOSEPH BOYD	35
F	S5	05-11-47.2	DARRIN H LEMASTERS	46.344
G	S6	05-11-24	DONALD THOMAS; DALLAS YEATER & MARY ANN YEATER; ROBERT LEE THOMAS	55.4
I	S7	05-11-25	BEVERLY GUYNN ET AL	49.732
	S8	05-11-25.9	CARL G DAVIS	1
J	S9	05-11-25.11	BEVERLY GUYNN ET AL	0.8
K	S10	05-11-25.15	LOVELL R & EILENE G DAVIS	12.28
	S11	05-11-36.1	JOHN W KILE EST	50
	S12	05-11-25.18	TODD E & CONNIE L DAVIS	10
B	S13	05-10-03	JASON M & AIMEE L STEVENS	27.25
	S14	05-11-12	SARAH GATRELL	47
	S15	05-11-11	REX S GODDARD	25
	S16	05-11-26	DAVID LEE KYLE	40.58
	S17	05-11-26.1	DAVID LEE KYLE	0.26
	S18	05-11-04	DAVE & ANNIE UNDERWOOD ESTS	136
	S19	05-11-13	JENNY L HOOVER	30.05
	S20	05-11-27	JOHN & PATTY MONTGOMERY	65
	S21	05-11-36	JOHN W KILE EST	57
	S22	05-11-41	TODD E & CONNIE L DAVIS	18.82
	S23	05-16-02	MICHAEL D & BAN T SLOSS; CULLEN JOSEPH SLOSS	81.78
	S24	05-11-25.12	JAMES R YEATER	13.75
	S25	05-11-25.7	TODD E & CONNIE L DAVIS	3.032
	S26	05-11-25.10	ROSIE MARY CRAMER	2.44
	S27	05-11-25.16	ROSIE MARY CRAMER	0.14
	S28	05-11-25.14	ROSIE MARY CRAMER	0.54
	S29	05-11-25.6	ROSIE MARY CRAMER	2.19
	S30	05-11-25.13	ROSIE MARY CRAMER	0.18
	S31	05-11-46	ALVA D SPENCER EST ET AL	257
	S32	05-11-47.1	EUGENE R FRENCH & HILDA FRENCH	9.718
	S33	05-11-24.1	ROBERT L & MICHELLE R THOMAS	0.99
H	S34	05-11-24.2	JONI L THOMAS & GEORGE W MCCROBIE	1.1
	S35	05-11-47	JAY BEE OIL & GAS INC	43.438
	S36	05-10-14	CHARLENE L GARRISON	32.5
	S37	05-10-14.1	RICKEY L BOYD & ROBERTA J BOYD	2.5
	S38	05-10-12.1	JOSEPH BOYD	28.25
	S39	05-10-12	JOSEPH BOYD	66
	S40	05-10-11	LONNIE C & DEBBIE K FREY	85
	S41	05-10-47	JAMES WRIGHT	2
	S42	05-11-48	S D & M E SPENCER ESTATE	18.25
	S43	05-10-2.14	JACK F STARCHER JR & ROBERTA A STARCHER	60.832
	S44	05-05-14	LAURA L GARGASZ	62.5
	S45	05-05-17	BRIAN K & KATHRYN A HAYDEN	61.73
	S46	05-11-49	JUDY NICHOLS (LIFE ESTATE) & MARK I. NICHOLS & MITCHELL B NICHOLS	133.71
	S47	05-10-15	JOSEPH A BOYD	0.5
	S48	05-11-23	LIZABETH A MCCOURT & PATRICK A JENKINS	0.3
	S49	05-10-10	KENNETH R & JENNIFER L MASON	55
	S50	05-10-48	ROBERT C MCMAHON	0.36

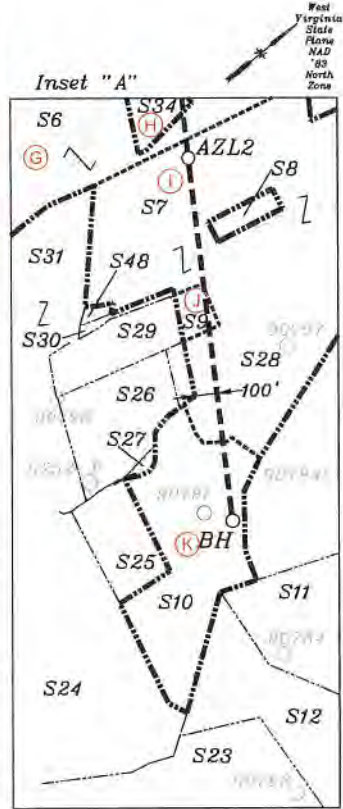

RECEIVED
Office of Oil & Gas
JUL 05 2022

WV Department of
Environmental Protection

Jay-Bee Oil & Gas, Inc. - T1-03-1A Permit - WW-6A1 Exhibit				
Tracts	District Tax Map/Parcel	JB Tract #	Lessor, Grantor, etc.	Deed Book/Page
A	05-05-15	p/o T1-03	Sara L. Anetsberger, et al	300/211
B	05-10-03	T5004	Gayla Blizzard, et al	412/345
C	05-10-04	p/o T1-03	Bernice Baker, et al	301/342
D	p/o 05-10-12	W668D	Barbara Baker, et al	406/736
E	p/o 05-10-12	p/o W668B	Joseph Boyd, et al	381/281
F	05-11-47.2	p/o FoutT30B	Connie Bowen, et al	418/565
G	05-11-24	p/o FoutT30A	Richard L. Clark, et al	410/263
H	5-11-24.2	p/o FoutT30A	Richard L. Clark, et al	410/263
I	05-11-25	T3054A	Eugene H Armstrong, et al	426/68
J	05-11-25.11	T3054J	Estella Goodfellow, et al	383/779
K	05-11-25.15	T3054C	Lovell R. Davis & Eilene G. Davis, et al	471/47



P.S. 708 David L Jackson



Jay Bee Oil & Gas
DRILLING
into the future

OPERATOR'S
WELL #: T1-03-1A
DISTRICT: McElroy
COUNTY: Tyler
STATE: WV

WELL PLAT
PAGE 2 OF 2
DATE: 06/11/2022

08/12/2022