

Antero Resources
Well No. Mamba 2H
BHL MOD
 Antero Resources Corporation



I, the undersigned, hereby certify that this plat is correct to the best of my knowledge and belief and shows all the information required by law and the rules issued and prescribed by the Department of Environmental Protection.

Bradley D. Miller
 Bradley D. Miller, P.S. 2167



Note: 0 water wells or springs were found within 2000' of proposed well. No occupied dwellings or buildings 2,500 square feet or larger used to house or shelter dairy cattle or poultry husbandry are located within 625' of the center of the well pad.

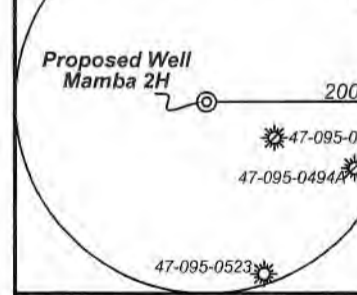

FILE NO: 99-54-E-19
 DRAWING NO: Mamba Unit 2H Well Plat
 SCALE: 1" = 2000'
 MINIMUM DEGREE OF ACCURACY: Submeter
 PROVEN SOURCE OF ELEVATION: WVDOT, Harrisville, WV

STATE OF WEST VIRGINIA
 DEPARTMENT OF ENVIRONMENTAL PROTECTION
OIL AND GAS DIVISION

DATE: September 14 20 22
 OPERATOR'S WELL NO. Mamba Unit 2H
 API WELL NO. MOD 17282
 STATE COUNTY PERMIT

WELL TYPE: OIL GAS LIQUID INJECTION WASTE DISPOSAL
 (IF GAS) PRODUCTION: STORAGE DEEP SHALLOW

LOCATION: ELEVATION: Proposed 1193' Existing 1215' WATERSHED: Outlet Middle Island Creek QUADRANGLE: TH:Porter Falls BH:Paden City 20: 164.28125; 20: 67: 33.25; 3: 36.15; 98.5;
 DISTRICT: Ellsworth/Magnolia Michael Stillwagner, Don A. Stertzbach, et ux; Jeffrey Seckman; James D. VanCamp, et ux; William G. Baker; Antero Minerals, LLC; COUNTY: Tyler/Wetzel 10/14/2022
 SURFACE OWNER: Dennis & Clista Heintzman Gary A. Midcap, et ux (3); Lee Morgan; James D. VanCamp; ACREAGE: 417.6 30.9625; 40; 48.796; 10.02; 33.48125; 44;
 ROYALTY OWNER: BRC Appalachian Minerals I, LLC (2); TMP Properties, LLC; Judy P. Meyers; LEASE NO: ACREAGE: 42.46875; 99.4438
 PROPOSED WORK: DRILL CONVERT DRILL DEEPER FRACTURE OR STIMULATE PLUG OFF OLD FORMATION
 PERFORATE NEW FORMATION OTHER PHYSICAL CHANGE IN WELL (SPECIFY) BHL MOD
 PLUG AND ABANDON CLEAN OUT AND REPLUG TARGET FORMATION: Marcellus Shale ESTIMATED DEPTH: 7,100' TVD 25,300' MD

WELL OPERATOR: Antero Resources Corporation DESIGNATED AGENT: Dianna Stamper - CT Corporation System
 ADDRESS: 1615 Wynkoop Street ADDRESS: 5400 D Big Tyler Road
 Denver, CO 80202 Charleston, WV 25313

Notes
 West Virginia Coordinate System of 1927, North Zone based upon Differential GPS Measurements.
 Well No. Mamba Unit 2H Top Hole coordinates are
 N: 382,729.52' Latitude: 39°32'34.42"
 E: 1,617,666.98' Longitude: 80°51'20.81"
 Bottom Hole coordinates are
 N: 399,562.09' Latitude: 39°35'20.07"
 E: 1,612,952.76' Longitude: 80°52'24.26"
 UTM Zone 17, NAD 1983
 Top Hole Coordinates Bottom Hole Coordinates
 N: 4,377,043.715m N: 4,382,147.862m
 E: 512,407.241m E: 510,885.574m
 Plat orientation and corner and well references are based upon the grid north meridian.
 Well location references are based upon the magnetic meridian.

Notes:
 Well No. Mamba Unit 2H UTM Zone 17, NAD 1927
 Top Hole Coordinates
 N: 14,359,636.35'
 E: 1,681,074.83'
 Point of Entry Coordinates
 N: 14,361,173.18'
 E: 1,681,353.34'
 Bottom Hole Coordinates
 N: 14,376,382.18'
 E: 1,676,081.96'

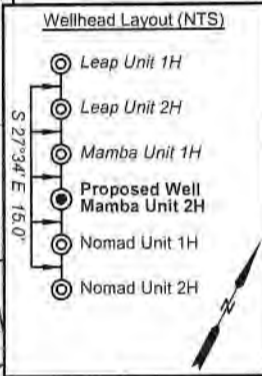

RECEIVED
 Office of Oil & Gas
 SEP 21 2022
 DEPARTMENT OF ENVIRONMENTAL PROTECTION

11,294' to Bottom Hole

6,330' to Top Hole

TOP HOLE LATITUDE 39 - 35 - 00
 BTM HOLE LATITUDE 39 - 37 - 30

LONGITUDE 80 - 50 - 00

13,146' to Bottom Hole

14,729' to Top Hole

Page 1 of 2

Wetzel County Tyler County

Mamba Unit 2H Bottom Hole

47-095-00685

500' Buffer

GRID NORTH

SEAL

Proposed Well No. Mamba 2H

Well Location References (NTS)

Stake w/ Tack

AZ129° 37'

AZ20° 52'

Heintzman Pad

Not to Scale

BTM Hole 7.5 Spot

Top Hole 7.5 Spot

SEE DETAIL (PAGE 2)

Iron Pin

Fence Corner

Stone

Proposed Well No. Mamba Unit 2H

47-095-0493A

47-095-0494A

47-095-0523A

Legend

Proposed gas well

Monument, as noted

Existing Well, as noted

Digitized Well, as noted

Creek or Drain

Road

Surface boundary (approx.)

Interior surface tracts (approx.)

County Line

Antero Resources
Well No. Mamba 2H
BHL MOD
 Antero Resources Corporation

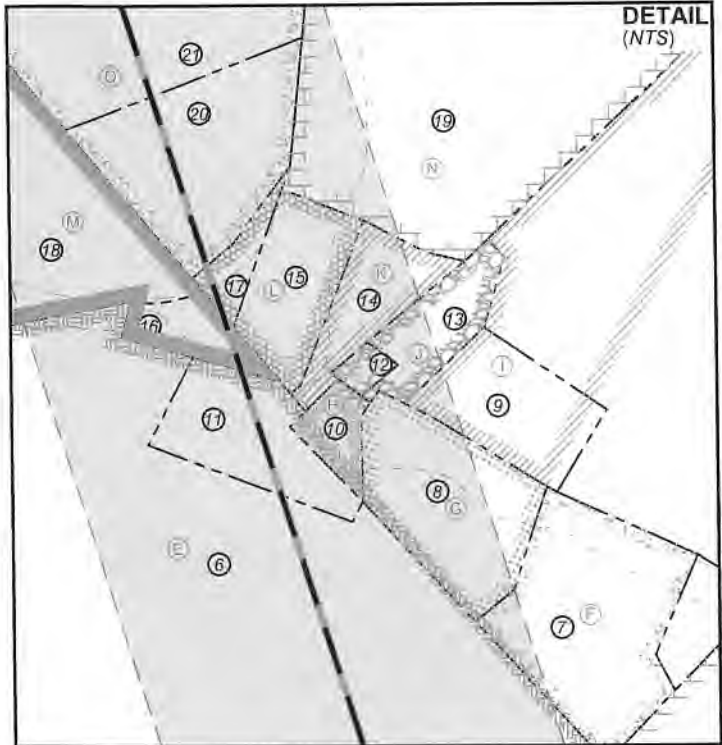

ID	TM/Par	Owner	Bk/Pg	Acres
1	6-36	Dennis & Clista Heintzman	297/640	417.60
2	10-4	Stefan L. & Alberta B. Smolski	356/467	56.08
3	6-49	Dennis & Clista A. Heintzman	297/637	45.00
4	6-30.1	Larry M. & Amy B. Adams	369/344	150.33
5	6-30	Larry G. Rice	333/682	64.61
6	6-27	Ronnie L. VanCamp, et al	568/32	69.88
7	6-27.3	Laura A. Richeson	365/34	5.14
8	6-27.4	Joseph M. & Tammy A. Rice	634/778	3.79
9	6-21.2	Richard E. Leek	OR147/27	3.15
10	6-27.1	Larry G. Rice	333/682	0.81
11	6-27.5	David W. VanCamp	555/14	2.56
12	6-21.3	Richard E. Leek	OR147/27	0.28
13	6-21.1	Richard E. Leek	391/533	2.74
14	6-29	Richard Leek	402/216	1.00
15	6-28	David Wayne & Virginia VanCamp	395/557	2.00
16	6-47.1	Donna Faulk	408/113	1.00
17	6-27.2	David Wayne & Virginia VanCamp	395/557	1.0
18	6-47	Jeffrey Seckman	545/70	18.99
19	6-11	Jeffrey A. & Joann E. Seckman	343/153-A	68.72
20	6-20.2	Hiram Groves	98/195	7.50
21	6-20.1	Jeffrey Seckman	545/70	2.52
22	6-19	Linda J. & Jack E. Mason	OR101/678	10.00
23	6-20	Jeffrey Seckman	545/70	36.15
24	6-8	Matthew T. Ebert	361/219	98.50
25	6-7	Gary A. & Penny K. Midcap	301/265	30.90
26	3-26.1	Gary A. & Penny K. Midcap	301/265	40.00
27	3-34	Charlotte Terry, et al	WB76/367	57.19
28	3-27	Herbert & Phyllis Glendenning	349/827	33.25
29	3-25.1	Gary A. & Penny K. Midcap	304/230	33.48
30	3-25	Gary A. & Penny K. Midcap	301/265	42.47
31	3-28	Rhoda & Lawrence Morgan Est	317/413	61.33
32	3-19	Gary A. & Penny K. Midcap	301/265	20.94
33	3-9	Steven D. & Brenda M. Higgins	313/623	163.34
34	3-10	Steven D. & Brenda M. Higgins	313/623	79.75
35	3-10.1	Steven D. & Brenda M. Higgins	313/623	10.16
36	1-11	Daniel A. Witschey	541/326	122.81
37	16-64	Richard Todd Kay	420/650	29.00
38	1-16	Daniel A. & Amy J. Witschey	602/421	20.00
39	17-15	Don A. Stertzbach	367/623	37.90
40	16-63	Richard E. Kay, et ux	395/329	19.00

Leases	
A	BRC Appalachian Minerals I, LLC
B	Rose Enterprises, LLC
C	Dennis R. & Clista A. Heintzman
D	TMP Properties, LLC
E	Judy P. Meyers
F	Laura A. Richeson
G	Bobby J. Dennis
H	David W. VanCamp, et ux
I	BRC Appalachian Minerals I, LLC
J	Antero Mineral, LLC
K	Martha Elizabeth Matthews
L	David Wayne VanCamp, et ux
M	Jeffrey Seckman
N	Jon Keith Irvin
O	James D. VanCamp
P	Linda J. & Jack E. Mason
Q	David E. Bowyer
R	Christina L. Ebert
S	Gary A. Midcap, et ux
T	Gary A. Midcap, et ux
U	Lee Morgan
V	BRC Appalachian Minerals I, LLC
W	James D. VanCamp, et ux
X	MAP2012-OK
Y	William G. Baker
Z	Gary A. Midcap, et ux
AA	Mary F. Mutschelknaus
AB	Steven D. Higgins, et ux
AC	Beverly Kay Campbell
AD	Cider Run Mineral Holdings, LLC
AE	Don A. Stertzbach, et ux
AF	Michael Stillwagner
AG	Ridgetop Royalties

RECEIVED
 Office of Oil & Gas
SEP 21 2022
 WV Department of
 Environmental Protection

FILE NO: 99-54-E-19
 DRAWING NO: Mamba Unit 2H Well Plat
 SCALE: 1" = 2000'
 MINIMUM DEGREE OF ACCURACY:
 Submeter
 PROVEN SOURCE OF ELEVATION:
 WVDOT, Harrisville, WV

STATE OF WEST VIRGINIA
 DEPARTMENT OF ENVIRONMENTAL PROTECTION
OIL AND GAS DIVISION

DATE: September 14 2022
 OPERATOR'S WELL NO. Mamba Unit 2H
 API WELL NO. 47-095-12821
 STATE COUNTY PERMIT

WELL TYPE: OIL GAS LIQUID INJECTION WASTE DISPOSAL
 (IF GAS) PRODUCTION: STORAGE DEEP SHALLOW
 LOCATION: ELEVATION: Existing 1215' Proposed 1193' Outlet: Middle Island Creek TH:Porter Falls
 DISTRICT: Ellsworth/Magnolia WATERSHED: Middle Island Creek QUADRANGLE: BH:Paden City 20: 164.28125;
 SURFACE OWNER: Dennis & Clista Heintzman COUNTY: Tyler/Wetzel 20: 67-33.25;
 ROYALTY OWNER: BRC Appalachian Minerals I, LLC (2); TMP Properties, LLC; Judy P. Meyers; LEASE NO: ACREAGE: 417.6 30.9625; 40; 48.796;
 PROPOSED WORK: DRILL CONVERT DRILL DEEPER FRACTURE OR STIMULATE PLUG OFF OLD FORMATION
 PERFORATE NEW FORMATION OTHER PHYSICAL CHANGE IN WELL (SPECIFY) BHL MOD ACREAGE: 3; 36.15; 98.5;
 PLUG AND ABANDON CLEAN OUT AND REPLUG TARGET FORMATION: Marcellus Shale ESTIMATED DEPTH: 25,300' MD 10.02; 33.48125; 44;

WELL OPERATOR: Antero Resources Corporation DESIGNATED AGENT: Dianna Stamper - CT Corporation System
 ADDRESS: 1615 Wynkoop Street ADDRESS: 5400 D Big Tyler Road
 Denver, CO 80202 Charleston, WV 25313