

LATITUDE 39°32'30" 305' →

LATITUDE 39°30'00" ←

8,075' TO BOTTOM HOLE

6,823' TO BOTTOM HOLE

4,844' TO BOTTOM HOLE

LONGITUDE 80°47'30"

LONGITUDE 80°45'00"

Antero Resources Corporation
Well No. Gothic Unit 2H

NOTES:
 WELL 2H TOP HOLE INFORMATION:
 N: 377,177ft E: 1,635,364ft
 LAT: 39°31'42.12" LON: 80°47'33.90"
 BOTTOM HOLE INFORMATION:
 N: 359,967ft E: 1,639,109ft
 LAT: 39°28'52.57" LON: 80°46'42.98"
 WEST VIRGINIA COORDINATE SYSTEM OF 1927 NORTH ZONE
 MEASUREMENTS TAKEN WITH TRIMBLE GEOXT SUBMETER MAPPING GRADE GPS UNIT. PLAT ORIENTATION, CORNER, AND WELL REFERENCE TIE LINES ARE BASED ON GRID NORTH.

(NAD) 83 (UTM) ZONE 17 COORDS:
 WELL 2H TOP HOLE INFORMATION:
 N: 4,375,442m E: 517,827m
 BOTTOM HOLE INFORMATION:
 N: 4,370,218m E: 519,055m

(NAD) 27 (UTM) ZONE 17 COORDS:
 WELL 2H TOP HOLE INFORMATION:
 N: 14,354,381ft E: 1,698,856ft
 POINT OF ENTRY INFORMATION:
 N: 14,353,744ft E: 1,697,258ft
 BOTTOM HOLE INFORMATION:
 N: 14,337,242ft E: 1,702,886ft

NOTE
 NO OCCUPIED DWELLINGS OR BUILDINGS TWO THOUSAND FIVE HUNDRED (2,500) SQUARE FEET OR LARGER USED TO HOUSE OR SHELTER DAIRY CATTLE OR POULTRY HUSBANDRY ARE LOCATED WITHIN SIX HUNDRED TWENTY-FIVE (625) FEET OF THE CENTER OF THE WELL PAD.

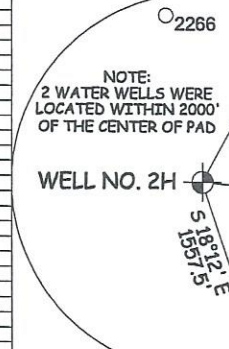
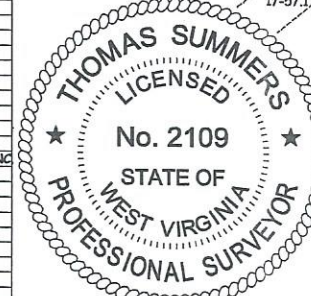
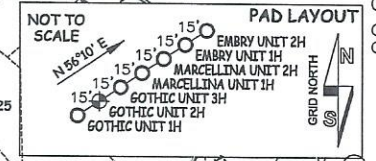

ELLSWORTH DISTRICT - TYLER COUNTY	
11-20	EDWARD QUIRK
11-21	EDWARD QUIRK
11-22	NILE HARRIS
11-59	EDWARD QUIRK
11-60	MICHAEL MARTIN
12-5	ROSALIE HENRY
12-6	ANTERO MIDSTREAM LLC
12-7	COASTAL FOREST RESOURCES CO.
12-8	SHIRLEY CARROLL
12-9	COASTAL FOREST RESOURCES CO.
12-10	MICHAEL MARTIN
12-11	CLARA WALLACE
12-12	ROCKFORD ENERGY LLC
12-13	ERIC FISHER
12-14	ANTERO MIDSTREAM LLC
12-15	PATRICIA NYE
12-16	PATRICIA NYE
12-17	ANTERO MIDSTREAM LLC
12-18	ANTERO MIDSTREAM LLC
12-19	JON DUMARS
12-23	ROBERT BARD
12-32	CARL WILCOX
12-33	RICHARD NEFF
16-13	GAIL NEFF
16-31	CHRISTOPHER INVESTMENTS INC.
17-1	RICHARD NEFF
17-2	EDWARD WARF
17-3	FLOYD EDDY
17-3.1	FLORA ROBERTS
17-4	ERWAIN PECK
17-5	DOUG SMITH
17-6	ERWAIN PECK
17-7	GILBERT EDDY
17-8	RICHARD NAPIORKOWSKI
17-9	ERWAIN PECK
17-10	THOMAS JOBES
17-10.1	CHARLES EASTHAM
17-10.2	THOMAS JOBES
17-11	ELIZABETH RICHIE
17-23	MARJORIE STALEY
17-24.1	DAWN HADLEY
17-25	ELIZABETH MENGES
17-27	RICHARD NEFF
17-27	HAMMETT LAND & MINERALS LLC
17-28	ARTHUR PECK
17-29	HAMMETT LAND & MINERALS LLC
17-32	SHALYN MCGRAW
17-33	HAMMETT LAND & MINERALS LLC
17-34	SAMUEL HAMMETT
17-34.1	MANUFACTURERS LIGHT & HEAT CO.
17-34.2	HAMMETT LAND & MINERALS LLC
17-35	SAMUEL HAMMETT
17-36	SAMUEL HAMMETT
17-37	BONNIE HENTHORN
17-37.1	JOHN COOPER
17-49	MARTHA MENGES
17-50	MARTHA MENGES
17-51	JONATHAN COOPER
17-52	ANTERO RESOURCES CORP.
17-53	WILLIAM JAMES
17-54	WANDA PARR
17-57.1	RICHARD WILLIAMS
17-57.2	RICHARD WILLIAMS
17-58	CHRISTOPHER INVESTMENTS INC.
17-59	MICHAEL BEEGLE
17-60	JOHN RIAL
17-61	T. E. CUNNINGHAM
17-62	EDNA EDDY
17-63	EDNA ROBERTS
17-64	ANGELA SMITH
17-65	GILBERT EDDY
17-65.1	CHRISTIAN CHURCH
17-66	FLOYD EDDY
17-67	JEREMY NEFF
17-67.1	CYNTHIA EDDY
17-68	JEREMY NEFF
17-69	LARRY HENTHORN
17-70	DALE RICHMOND
17-71	LARRY HENTHORN
17-72	LARRY HENTHORN
23-4	DALE PARR
23-7	DALE PARR
23-9	DALE PARR
23-10	DALE PARR
23-11	JENNIFER WILLIAMS
23-12	TERRY JOY
MCELROY DISTRICT - TYLER COUNTY	
2-3	LLOYD WEEKLEY
2-4	LLOYD WEEKLEY
2-5	RONALD WEEKLEY
2-9	ELDEN NICHOLS
2-9.1	RICHARD BLANKENSHIP
2-9.2	WILLIAM LACY
2-9.3	SANDRA JOCHUM
2-10	WANDA PARR
2-18	MICHAEL SHERWOOD
2-20	ELDEN NICHOLS
2-21	CHARLES HAGAN
2-22	RICHARD THOMASELL

I THE UNDERSIGNED, HEREBY CERTIFY THAT THIS PLAT IS CORRECT TO THE BEST OF MY KNOWLEDGE AND BELIEF AND SHOWS ALL THE INFORMATION REQUIRED BY LAW AND THE RULES ISSUED AND PRESCRIBED BY THE DEPARTMENT OF ENVIRONMENTAL PROTECTION.

JOB # 20-011WA
 DRAWING # GOthic2H
 SCALE 1" = 2000'
 MINIMUM DEGREE OF ACCURACY SUBMETER
 PROVEN SOURCE OF ELEV. SUBMETER MAPPING GRADE GPS
 STATE OF WEST VIRGINIA DEPARTMENT OF ENERGY DIVISION OF OIL AND GAS

LEGEND
 - - - - - Surface Owner Boundary Lines +/-
 - - - - - Adjoining Surface Tracts +/-
 ⊕ Found monument, as noted
 THOMAS SUMMERS P.S. 2109
 DATE 01/12/23
 OPERATOR'S WELL# GOthic UNIT #2H



STATE OF WEST VIRGINIA, DIVISION OF ENVIRONMENTAL PROTECTION, OFFICE OF OIL AND GAS
 WILLOW LAND SURVEYING PLLC
 220 MASONIC AVE. PENNSBORO WEST VIRGINIA 26415

WELL TYPE: OIL GAS LIQUID INJECTION WASTE DISPOSAL 47 - 095 - 02825
 (IF "GAS") PRODUCTION STORAGE DEEP SHALLOW
 LOCATION: ELEVATION 1,200' - AS BUILT WATERSHED OUTLET MIDDLE ISLAND CREEK
 QUADRANGLE PORTER FALLS 7.5' (TH) - SHIRLEY 7.5' (BH) DISTRICT ELLSWORTH COUNTY TYLER
 SURFACE OWNER CLARA SUZANNE WALLACE & RICKIE WALLACE ACREAGE 60 ACRES +/-
 OIL & GAS ROYALTY OWNER PHILLIP K. GEORGE; SAMUEL K. STONEKING JR.; RICHARD NEFF ET UX; LEASE ACREAGE 60 AC +/-; 76.88 AC +/-; 35.36 AC +/-;
 KERRY L LEMASTERS; EDWARD B. WARF ET UX; RICHARD NEFF ET UX; ANTERO MINERALS LLC; RIVERSIDE RESOURCES, LLC; 100 AC +/-; 43.87 AC +/-; 40 AC +/-; 118 AC +/-; 54.5 AC +/-;
 WILLIAM M. BAKER ET AL; HAMMETT LAND & MINERALS; SHELDON A. FERRELL; SHIBEN ESTATES INC.; H3 LLC; WANDA J. PARR; 58.5 AC +/-; 10.01 AC +/-; 61.66 AC +/-; 90.65 AC +/-; 60 AC +/-; 14.42 AC +/-;
 SHARON GRIFFETH; WALTER R. MYERS; LORRAINE B. WEEKLEY; JAY BEE ROYALTY, LLC; LARRY MARK ADAMS 50 AC +/-; 46.66 AC +/-; 68.5 AC +/-; 40 AC +/-; 50 AC +/-
 PROPOSED WORK: DRILL CONVERT DRILL DEEPER REDRILL FRACTURE OR STIMULATE
 PLUG OFF OLD FORMATION PERFORATE NEW FORMATION OTHER PHYSICAL CHANGE IN WELL (SPECIFY) MOD-BHL
 TARGET FORMATION MARCELLUS ESTIMATED DEPTH 7,400' TVD 27,300' MD
 WELL OPERATOR ANTERO RESOURCES CORP. DESIGNATED AGENT KEVIN ELLIS
 ADDRESS 1615 WYNKOOP ST. ADDRESS 535 WHITE OAKS BLVD
 FORM WW-6 DENVER, CO 80202 BRIDGEPORT, WV 26330

COUNTY NAME PERMIT