

FILE #: TRB1  
 DRAWING #: 3085  
 SCALE: PLAT: 1" = 1500'  
 TICK: 1" = 2000'  
 MINIMUM DEGREE OF ACCURACY: 1/200  
 PROVEN SOURCE: SUBMETER MAPPING GRADE GPS

I, THE UNDERSIGNED, HEREBY CERTIFY THAT THIS PLAT IS CORRECT TO THE BEST OF MY KNOWLEDGE AND BELIEF AND SHOWS ALL THE INFORMATION REQUIRED BY LAW AND THE REGULATIONS ISSUED AND PRESCRIBED BY THE DEPARTMENT OF ENVIRONMENTAL PROTECTION.  
 Signed: *[Signature]*  
 L.L.S. #2124 : Ernest J. Benchek III

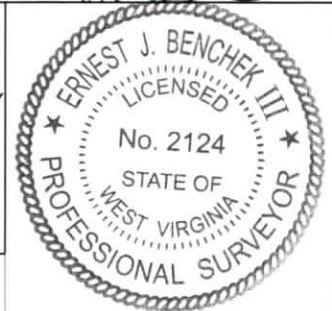

(+) DENOTES LOCATION OF WELL ON UNITED STATES TOPOGRAPHIC MAPS WVDEP

OFFICE OF OIL & GAS  
 601 57TH STREET  
 CHARLESTON, WV 25304

Well Type:  Oil  Waste Diposal  Production  Deep  
 Gas  Liquid Injection  Storage  Shallow

WATERSHED: OUTLET MIDDLE ISLAND CREEK

COUNTY/DISTRICT: TYLER / McELROY

SURFACE OWNER: WEST VIRGINIA DEPT. OF NATURAL RESOURCES

OIL & GAS ROYALTY OWNER: Tribune Resources, LLC, Et Al

LEASE NUMBERS:

DATE: AUGUST 5, 2024

OPERATOR'S WELL #: BFT 6H

API WELL #: 47 95

STATE COUNTY PERMIT

AS-BUILT ELEVATION: 880'

QUADRANGLE: CENTER POINT

ACREAGE: 110.00 +/-

ACREAGE: 1307 **08/16/2024**

DRILL  CONVERT  DRILL DEEPER  REDRILL  FRACTURE OR STIMULATE   
 PLUG OFF FORMATION  PERFORATE NEW FORMATION  PLUG & ABANDON   
 CLEAN OUT & REPLUG  OTHER CHANGE  (SPECIFY):

TARGET FORMATION: MARCELLUS

WELL OPERATOR: TRIBUNE RESOURCES, LLC

ADDRESS: 3861 AMBASSADOR CAFFERY PARKWAY SUITE 600

CITY: LAFAYETTE STATE: LA ZIP CODE: 70503

ESTIMATED DEPTH: TVD: 6,933' TMD: 19,545'

DESIGNATED AGENT: HARMAN BROWN

ADDRESS: 18396 MOUNTAINEER HIGHWAY

CITY: WILEVILLE STATE: WV ZIP CODE: 26581

PROPERTY OWNER INDEX	
5-8-8	WV DEPT. OF NATURAL RESOURCES COMMERCE
5-8-21	JERRY L. WALTERS
5-8-22	WV DEPT. OF NATURAL RESOURCES COMMERCE
5-8-34	ASCENT RESOURCES MARCELLUS MINERALS LLC
5-8-35	GORDON L SWARTZ IV
5-13-8	CHARLES A. MUSTO & CHERRI L. HACK
5-13-7	ROGER D. & JANET M. FLUHARTY
5-13-7.1	ALLEN D. STACKPOLE
5-13-9	KENNETH L. & GENIEVA GLOVER
5-13-11.2	LEONARD LEE & LINDA LOUGH
5-13-65	MELBA JEAN TEMPLETON LIFE ESTATE
5-13-30	MELBA JEAN TEMPLETON LIFE ESTATE
5-13-29	KENNETH DALE NICE JR.
5-13-25	ROYCE J. & ROYAL J. WATTS
5-13-24	DONNA WOLF
5-13-13	RALPH D. THACKER & MAURICE J. CARLISLE JR
5-13-22	JOSEPH & BARBARA S CUCHTA

LEASE INDEX			
A	MARC00717-001	H	MARC03520-000
B	MARC00713-000	I	MARC03489-000
C	MARC00713-000	J	MARC01363-001
D	MARC00765-000	K	MARC05083-000
E	Fee 2172-00	L	MARC01228-001
F	MARC00738-001	M	MARC01574-000
G	MARC00722-000	N	MARC05181-000

08/16/2024

FILE #: TRB2

DRAWING #: 3085

SCALE: N/A

DATE: AUGUST 5, 2024

OPERATOR'S WELL #: BFT 6H

API WELL #: 47 095  
STATE COUNTY PERMIT

WELL NAME: BFT 6H  
CENTER POINT, WV

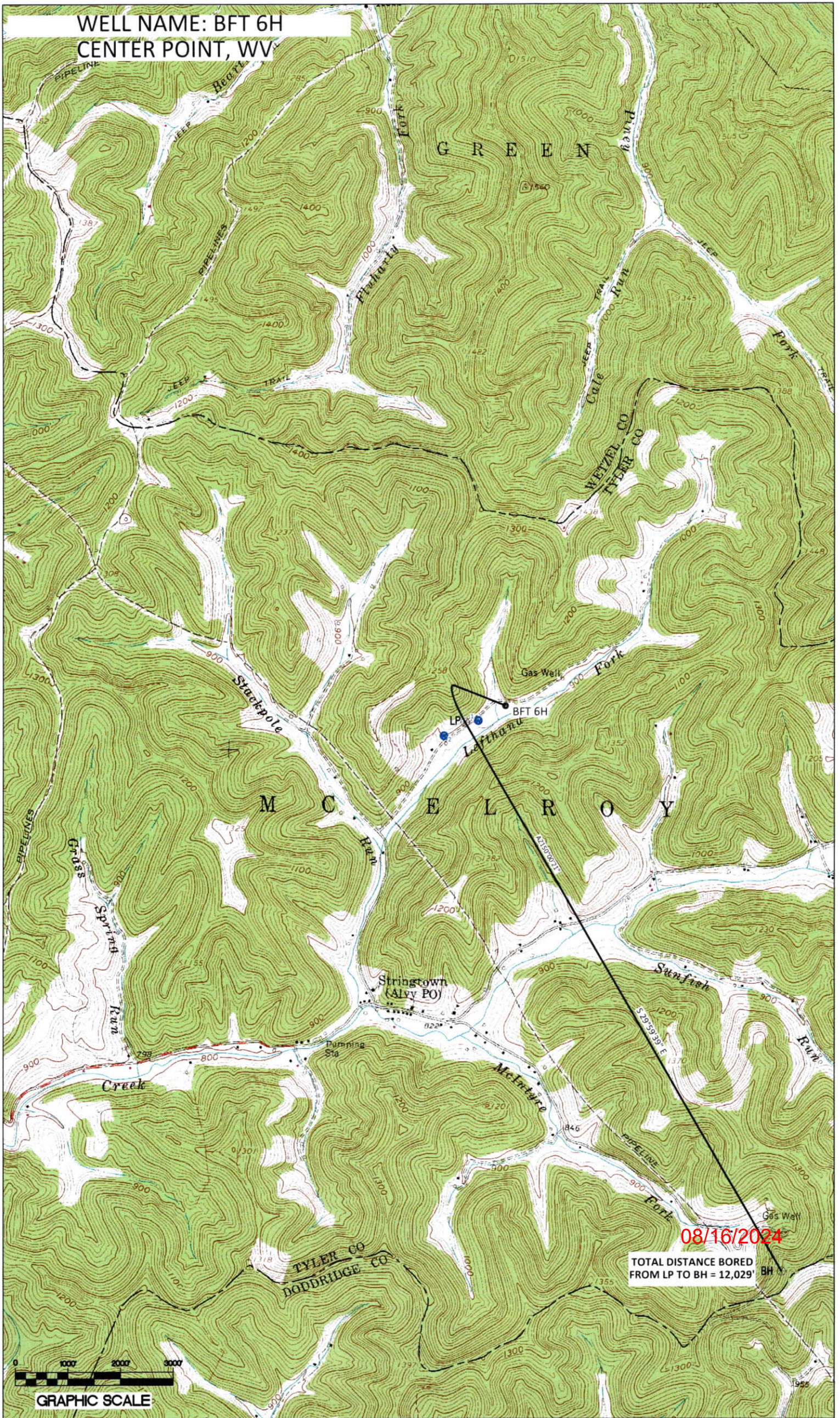

08/16/2024

TOTAL DISTANCE BORED  
FROM LP TO BH = 12,029' BH



GRAPHIC SCALE