

State of West Virginia  
Department of Environmental Protection - Office of Oil and Gas  
Well Operator's Report of Well Work

API 47 - 095 - 02841 County Tyler District Ellsworth  
Quad Porter Falls 7.5' Pad Name Ed Yost Field/Pool Name -----  
Farm name Edward Yost Estate Well Number Peach Fork Unit 1H  
Operator (as registered with the OOG) Antero Resources Corporation  
Address 1615 Wynkoop Street City Denver State CO Zip 80202

As Drilled location NAD 83/UTM Attach an as-drilled plat, profile view, and deviation survey  
Top hole Northing 4377602m Easting 514056m  
Landing Point of Curve Northing 4377826.44m Easting 513423.72m  
Bottom Hole Northing 4383058m Easting 511908m

Elevation (ft) 1233' GL Type of Well  New  Existing Type of Report  Interim  Final  
Permit Type  Deviated  Horizontal  Horizontal 6A  Vertical Depth Type  Deep  Shallow  
Type of Operation  Convert  Deepen  Drill  Plug Back  Redrilling  Rework  Stimulate  
Well Type  Brine Disposal  CBM  Gas  Oil  Secondary Recovery  Solution Mining  Storage  Other \_\_\_\_\_  
Type of Completion  Single  Multiple Fluids Produced  Brine  Gas  NGL  Oil  Other \_\_\_\_\_  
Drilled with  Cable  Rotary

Drilling Media Surface hole  Air  Mud  Fresh Water Intermediate hole  Air  Mud  Fresh Water  Brine  
Production hole  Air  Mud  Fresh Water  Brine  
Mud Type(s) and Additive(s) Air - Foam & 4% KCL  
Mud - Polymer

RECEIVED  
Office of Oil and Gas  
JAN 05 2024  
WV Department of  
Environmental Protection

Date permit issued 12/19/2022 Date drilling commenced 1/23/2023 Date drilling ceased 3/31/2023  
Date completion activities began 6/16/2023 Date completion activities ceased 8/29/2023  
Verbal plugging (Y/N) N/A Date permission granted N/A Granted by N/A

Please note: Operator is required to submit a plugging application within 5 days of verbal permission to plug

Freshwater depth(s) ft 203' Open mine(s) (Y/N) depths No  
Salt water depth(s) ft 1810' Void(s) encountered (Y/N) depths No  
Coal depth(s) ft N/A Cavern(s) encountered (Y/N) depths No  
Is coal being mined in area (Y/N) No

APPROVED

Reviewed by: [Signature]  
02/16/2024

API 47-095 - 02841 Farm name Edward Yost Estate Well number Peach Fork Unit 1H

CASING STRINGS	Hole Size	Casing Size	Depth	New or Used	Grade wt/ft	Basket Depth(s)	Did cement circulate (Y/N) * Provide details below*
Conductor	28"	20"	130'	New	91.59#, J-55	N/A	Y
Surface	17-1/2"	13-3/8"	403'	New	54.5#, J-55	N/A	Y
Coal							
Intermediate 1	12-1/4"	9-5/8"	3477'	New	36#, J-55	N/A	Y
Intermediate 2							
Intermediate 3							
Production	8-3/4" /8-1/2"	5-1/2"	25205'	New	23#, P-110	N/A	Y
Tubing		2-3/8"	6869'		4.7#, J-55		
Packer type and depth set		N/A					

Comment Details \_\_\_\_\_

CEMENT DATA	Class/Type of Cement	Number of Sacks	Slurry wt (ppg)	Yield (ft <sup>3</sup> /sks)	Volume (ft <sup>3</sup> )	Cement Top (MD)	WOC (hrs)
Conductor	Class A	178 sx	15.6	1.18	210	0'	8 Hrs.
Surface	Class C	355 sx	15.8	1.17	415	0'	8 Hrs.
Coal							
Intermediate 1	Class C	1209 sx	15.8	1.16	1402	0'	8 Hrs.
Intermediate 2							
Intermediate 3							
Production	Class H	4184 sx (Tail)	13.5 (Lead), 15.2(Tail)	1.25 (Tail)	5230	~500' into Intermediate Casing	8 Hrs.
Tubing							

Drillers TD (ft) 25205' MD, 6687' TVD (BHL), 6760' TVD (Deepest Point Drilled)      Loggers TD (ft) 25205' MD  
 Deepest formation penetrated Marcellus      Plug back to (ft) N/A  
 Plug back procedure N/A

RECEIVED  
Office of Oil and Gas

JAN 05 2024

Kick off depth (ft) 6119'

WV Department of Environmental Protection

Check all wireline logs run       caliper     density     deviated/directional     induction  
 neutron     resistivity     gamma ray     temperature     sonic

Well cored     Yes     No      Conventional      Sidewall      Were cuttings collected     Yes     No

DESCRIBE THE CENTRALIZER PLACEMENT USED FOR EACH CASING STRING \_\_\_\_\_

Conductor - 0  
 Surface - 1 above guide shoe, 1 above insert float, 1 every 4th joint to surface  
 Intermediate - 1 above float joint, 1 above float collar, 1 every 4th joint to surface  
 Production - 1 above float joint, 1 below float collar, 1 every 3rd joint to top of cement

WAS WELL COMPLETED AS SHOT HOLE     Yes     No      DETAILS \_\_\_\_\_

WAS WELL COMPLETED OPEN HOLE?     Yes     No      DETAILS \_\_\_\_\_

WERE TRACERS USED     Yes     No      TYPE OF TRACER(S) USED N/A

02/16/2024







EXHIBIT 1					
Stage No.	Perforation Date	Perforated from MD ft.	Perforated to MD ft.	Number of Perforations	Formations
1	6/16/2023	25076	25033	60	Marcellus
2	6/17/2023	24994.38015	24828.2809	60	Marcellus
3	6/17/2023	24792.66105	24626.5618	60	Marcellus
4	6/18/2023	24590.94195	24424.8427	60	Marcellus
5	6/18/2023	24389.22285	24223.1236	60	Marcellus
6	6/19/2023	24187.50375	24021.4045	60	Marcellus
7	6/19/2023	23985.78464	23819.6854	60	Marcellus
8	6/19/2023	23784.06554	23617.9663	60	Marcellus
9	6/20/2023	23582.34644	23416.2472	60	Marcellus
10	6/20/2023	23380.62734	23214.5281	60	Marcellus
11	6/20/2023	23178.90824	23012.809	60	Marcellus
12	6/21/2023	22977.18914	22811.0899	60	Marcellus
13	6/21/2023	22775.47004	22609.3708	60	Marcellus
14	6/22/2023	22573.75094	22407.6517	60	Marcellus
15	6/22/2023	22372.03184	22205.9326	60	Marcellus
16	6/22/2023	22170.31273	22004.2135	60	Marcellus
17	6/23/2023	21968.59363	21802.4944	60	Marcellus
18	6/23/2023	21766.87453	21600.7753	60	Marcellus
19	6/23/2023	21565.15543	21399.0562	60	Marcellus
20	6/24/2023	21363.43633	21197.3371	60	Marcellus
21	6/24/2023	21161.71723	20995.618	60	Marcellus
22	6/24/2023	20959.99813	20793.8989	60	Marcellus
23	6/25/2023	20758.27903	20592.1798	60	Marcellus
24	6/25/2023	20556.55993	20390.4607	60	Marcellus
25	6/25/2023	20354.84082	20188.7416	60	Marcellus
26	6/26/2023	20153.12172	19987.0225	60	Marcellus
27	6/26/2023	19951.40262	19785.3034	60	Marcellus
28	6/26/2023	19749.68352	19583.5843	60	Marcellus
29	6/26/2023	19547.96442	19381.8652	60	Marcellus
30	6/27/2023	19346.24532	19180.1461	60	Marcellus
31	6/27/2023	19144.52622	18978.427	60	Marcellus
32	6/27/2023	18942.80712	18776.7079	60	Marcellus
33	6/28/2023	18741.08801	18574.9888	60	Marcellus
34	6/28/2023	18539.36891	18373.2697	60	Marcellus
35	6/28/2023	18337.64981	18171.5506	60	Marcellus
36	6/29/2023	18135.93071	17969.8315	60	Marcellus
37	6/29/2023	17934.21161	17768.1124	60	Marcellus
38	6/29/2023	17732.49251	17566.3933	60	Marcellus
39	6/29/2023	17530.77341	17364.6742	60	Marcellus
40	6/30/2023	17329.05431	17162.9551	60	Marcellus
41	6/30/2023	17127.33521	16961.236	60	Marcellus
42	6/30/2023	16925.6161	16759.5169	60	Marcellus
43	7/1/2023	16723.897	16557.7978	60	Marcellus
44	7/1/2023	16522.1779	16356.0787	60	Marcellus
45	7/2/2023	16320.4588	16154.3596	60	Marcellus
46	7/2/2023	16118.7397	15952.6404	60	Marcellus
47	7/2/2023	15917.0206	15750.9213	60	Marcellus
48	7/2/2023	15715.3015	15549.2022	60	Marcellus
49	7/3/2023	15513.5824	15347.4831	60	Marcellus
50	7/3/2023	15311.8633	15145.764	60	Marcellus
51	7/3/2023	15110.14419	14944.0449	60	Marcellus
52	7/3/2023	14908.42509	14742.3258	60	Marcellus
53	7/3/2023	14706.70599	14540.6067	60	Marcellus
54	7/3/2023	14504.98689	14338.8876	60	Marcellus
55	7/3/2023	14303.26779	14137.1685	60	Marcellus
56	7/4/2023	14101.54869	13935.4494	60	Marcellus
57	7/4/2023	13899.82959	13733.7303	60	Marcellus
58	7/4/2023	13698.11049	13532.0112	60	Marcellus
59	7/4/2023	13496.39139	13330.2921	60	Marcellus
60	7/4/2023	13294.67228	13128.573	60	Marcellus
61	7/4/2023	13092.95318	12926.8539	60	Marcellus
62	7/5/2023	12891.23408	12725.1348	60	Marcellus
63	7/5/2023	12689.51498	12523.4157	60	Marcellus
64	7/5/2023	12487.79588	12321.6966	60	Marcellus
65	7/5/2023	12286.07678	12119.9775	60	Marcellus
66	7/5/2023	12084.35768	11918.2584	60	Marcellus
67	7/5/2023	11882.63858	11716.5393	60	Marcellus
68	7/5/2023	11680.91948	11514.8202	60	Marcellus
69	7/6/2023	11479.20037	11313.1011	60	Marcellus
70	7/6/2023	11277.48127	11111.382	60	Marcellus
71	7/6/2023	11075.76217	10909.6629	60	Marcellus
72	7/6/2023	10874.04307	10707.9438	60	Marcellus
73	7/6/2023	10672.32397	10506.2247	60	Marcellus
74	7/7/2023	10470.60487	10304.5056	60	Marcellus
75	7/7/2023	10268.88577	10102.7865	60	Marcellus
76	7/7/2023	10067.16667	9901.06742	60	Marcellus
77	7/7/2023	9865.447566	9699.34831	60	Marcellus
78	7/7/2023	9663.728464	9497.62921	60	Marcellus
79	7/7/2023	9462.009363	9295.91011	60	Marcellus
80	7/8/2023	9260.290262	9094.19101	60	Marcellus
81	7/8/2023	9058.571161	8892.47191	60	Marcellus
82	7/8/2023	8856.85206	8690.75281	60	Marcellus
83	7/8/2023	8655.132959	8489.03371	60	Marcellus
84	7/8/2023	8453.413858	8287.31461	60	Marcellus
85	7/8/2023	8251.694757	8085.59551	60	Marcellus
86	7/8/2023	8049.975655	7883.8764	60	Marcellus
87	7/8/2023	7848.256554	7682.1573	60	Marcellus
88	7/9/2023	7646.537453	7480.4382	60	Marcellus
89	7/9/2023	7444.818352	7278.7191	60	Marcellus
90	7/9/2023	7243.099251	7077	60	Marcellus

RECEIVED  
Office of Oil and Gas

JAN 05 2024

WV Department of  
Environmental Protection

02/16/2024

EXHIBIT 2

Stage No.	Stimulations Date	Avg Pump Rate	Avg Treatment Pressure (PSI)	max Breakdown Pressure (PSI)	ISIP (PSI)	Amount of Proppant (lbs)	Amount of Water (bbls)	Amount of Nitrogen/ other (units)
1	6/16/2023	29.59	4259	7116	3828	174566	6230.9352	N/A
2	6/17/2023	79.19	9502	5077	4080	401680	7929.9271	N/A
3	6/17/2023	86.29692	9977.27	5270.94	3818.105	399060	8791.1348	N/A
4	6/18/2023	82.4	9839	5578	3745	399620	6976.2955	N/A
5	6/18/2023	90.17836	10364.21	5417.29	3876.197	399520	7085.779	N/A
6	6/19/2023	88.48839	10234.79	5271.28	3794.217	400220	7288.839	N/A
7	6/19/2023	86.80161	10054.98	5273.49	3843.923	401020	7165.8988	N/A
8	6/19/2023	88.04	10133	5180	3552	400360	7129.2017	N/A
9	6/20/2023	87.15	9963	5350	3911	400140	7211.331	N/A
10	6/20/2023	87.20274	9933.166	4963.27	3579.735	406900	7248.844	N/A
11	6/20/2023	89.41	10040	5088	3724	408760	7238.696	N/A
12	6/21/2023	91.02861	10010.79	5304.42	3783.149	413400	7213.3574	N/A
13	6/21/2023	90.92	9837	5213	4020	412900	8511.0793	N/A
14	6/22/2023	96.88	10503	3395	4016	415000	7255.0731	N/A
15	6/22/2023	91.20099	9986.26	4664.15	3455.702	410008	7193.0307	N/A
16	6/22/2023	95.66546	10077.37	5416.83	3706.378	415500	7412.6633	N/A
17	6/23/2023	97.19	10368	3443	3774	421660	7052.9964	N/A
18	6/23/2023	97.33007	10369.14	5222.87	3932.933	413120	7366.9714	N/A
19	6/23/2023	97.87	10438	3878	3906	405240	7160.9629	N/A
20	6/24/2023	97.79	10340	3581	3879	411200	7200.6824	N/A
21	6/24/2023	97.28066	10456.97	5965.29	3790.712	414780	7450.294	N/A
22	6/24/2023	95.67	9990	5157	3949	420860	7120.7617	N/A
23	6/25/2023	96.57	10034	4368	3804	407400	6639.5545	N/A
24	6/25/2023	96.28464	10080.73	5472.59	3873.907	418500	7406.2955	N/A
25	6/25/2023	97.54471	9972.167	5391.98	4062.16	418040	7419.5057	N/A
26	6/26/2023	96.98	10052	3046	4097	418300	7151.6664	N/A
27	6/26/2023	98.27	10043	5317	3767	412760	7406.3002	N/A
28	6/26/2023	96.75436	10012.84	5254.49	3827.296	416580	7191.4014	N/A
29	6/26/2023	98.15	10097	4783	3854	407720	7061.9907	N/A
30	6/27/2023	97.91	9991	4185	3871	410420	7094.3636	N/A
31	6/27/2023	97.28833	10025.88	5803.95	3646.721	412720	7395.3576	N/A
32	6/27/2023	97.98	10057	5017	3773	397725	6925.7907	N/A
33	6/28/2023	97.49	10043	5385	3812	421120	6885.9962	N/A
34	6/28/2023	97.20736	9835.744	4675	3673.259	407980	6950.7474	N/A
35	6/28/2023	97.17	9818	5514	3668	407020	7006.0557	N/A
36	6/29/2023	97.96	10014	5323	3971	417680	7213.8112	N/A
37	6/29/2023	97.79	9494	4840	3679	422520	7330.1886	N/A
38	6/29/2023	96.56064	9371.174	5345.11	4065.899	412240	7156.5688	N/A
39	6/29/2023	97.21	9085	5596	4144	413560	7030.3838	N/A
40	6/30/2023	96.60223	9100.239	4978.59	4026.099	410060	7143.0369	N/A
41	6/30/2023	95.83781	9145.258	5501.97	4066.872	411220	7268.3298	N/A
42	6/30/2023	96.69	8993	5392	4021	417660	7266.0533	N/A
43	7/1/2023	97.79726	9068.526	2191.69	3247.073	414360	7248.4757	N/A
44	7/1/2023	97.2	8688	5368	3757	418120	7225.6464	N/A
45	7/2/2023	96.9	8929	5464	3774	419640	6923.3326	N/A
46	7/2/2023	97.52	8785	5278	3827	416520	6989.3779	N/A
47	7/2/2023	96.29581	8751.872	5163.04	3385.088	416260	7238.1448	N/A
48	7/2/2023	96.7	8696	5491	3687	409220	7195.0214	N/A
49	7/3/2023	97.61	8952	4832	3373	409400	7283.5871	N/A
50	7/3/2023	98.04	8712	5218	3217	411380	7107.5821	N/A
51	7/3/2023	96.85363	8744.717	5614.9	3508.172	412980	6817.7883	N/A
52	7/3/2023	96.82124	8627.321	4320.63	3987.224	410183	7006.024	N/A
53	7/3/2023	97.15539	9018.555	5070.76	3478.256	421400	7222.0231	N/A
54	7/3/2023	96.77	9029	3769	3872	417920	7172.6143	N/A
55	7/3/2023	97.57	9021	5018	3431	414840	7168.8676	N/A
56	7/4/2023	97.44	8863	5330	3434	404620	6687.3164	N/A
57	7/4/2023	97.49	9072	5467	3209	409960	6869.1793	N/A
58	7/4/2023	96.68	8804	5679	3651	420460	7306.1183	N/A
59	7/4/2023	97.58362	8842.012	5048.33	3522.534	417300	7192.666	N/A
60	7/4/2023	97.41887	8657.4	5359.98	3497.459	409600	6981.4114	N/A
61	7/4/2023	97.06589	8893.94	5385.4	3558.144	415120	7202.6198	N/A
62	7/5/2023	96.74666	8832.713	4328.52	3372.613	419420	6949.1286	N/A
63	7/5/2023	98.36	8777	4826	3517	405680	6820.4795	N/A
64	7/5/2023	97.06	8499	5112	3798	414340	6832.2462	N/A
65	7/5/2023	97.01803	8405.69	5259.98	3330.866	417920	6809.146	N/A
66	7/5/2023	96.7	8245	5580	3832	424460	6872.9986	N/A
67	7/5/2023	97.58	8085	5567	3836	400500	6722.3445	N/A
68	7/5/2023	97.9	8359	5641	3896	393560	6824.5505	N/A
69	7/6/2023	96.49	8665	6121	3469	399260	7047.8626	N/A
70	7/6/2023	98.24	8376	5561	3514	415300	6830.0957	N/A
71	7/6/2023	96.77404	8528.695	5412.21	3309.939	405080	7196.5688	N/A
72	7/6/2023	96.12	8491	5434	3468	407980	7148.251	N/A
73	7/6/2023	83.52972	7412.049	4436.95	4267.461	415600	9299.2076	N/A
74	7/7/2023	95.74772	8551.021	5265.19	3666.406	395930	6943.5736	N/A
75	7/7/2023	97.56	8271	5456	3948	409620	6899.034	N/A
76	7/7/2023	97.31162	8182.427	5634.53	3851.257	421460	6966.2702	N/A
77	7/7/2023	97.65	8321	5408	3588	419060	6932.2119	N/A
78	7/7/2023	97.60182	8181.119	4612.94	3703.087	411180	6826.6683	N/A
79	7/7/2023	97.26	8449	5484	3890	413820	7020.7198	N/A
80	7/8/2023	97.96685	8090.363	5732.29	3624.415	415680	7052.605	N/A
81	7/8/2023	98.36335	8134.761	5735.01	3766.304	413120	7273.0407	N/A
82	7/8/2023	98.47	7797	5399	3582	417620	6882.0383	N/A
83	7/8/2023	98.15376	7765.283	5478.12	3569.84	419540	7026.3279	N/A
84	7/8/2023	98.00855	7675.413	5925.97	3384.843	425260	7035.1357	N/A
85	7/8/2023	97.86	7567	5645	3534	413060	6818.2164	N/A
86	7/8/2023	97.69	7623	5284	3788	405860	7108.7702	N/A
87	7/8/2023	98.262	7601.064	5401.51	3528.243	414180	7056.5319	N/A
88	7/9/2023	98.4606	7559.846	5385.74	3493.136	409340	6984.5507	N/A
89	7/9/2023	98.70755	7348.936	5977.13	3400.084	420880	6836.6838	N/A
90	7/9/2023	97.3817	7334.279	5439.51	3630.626	407800	6779.7712	N/A
AVERAGE		95.0	9,058	5,151	3,710	36,819,532	642,811	0

RECEIVED  
Office of Oil and Gas  
JAN 05 2024  
WV Department of  
Environmental Protection



**EXHIBIT 3**

LITHOLOGY/ FORMATION	TOP DEPTH (TVD)	BOTTOM DEPTH (TVD)	TOP DEPTH (MD)	BOTTOM DEPTH (MD)
	From Surface	From Surface	From Surface	From Surface
Silty Sandstone	70	170	70	170
Silty Shale	170	330	170	330
shaly sand	330	420	330	420
Shale	420	850	420	850
Dolomitic Shale	850	1,000	850	1,000
Shaly Siltstone	1,000	1,100	1,000	1,100
Silty Sandstone	1,100	1,320	1,100	1,320
Shaly Sand	1,320	1,470	1,320	1,470
Sandstone	1,470	1,720	1,470	1,720
Silty, Shaly, Sandstone	1,720	1,760	1,720	1,760
Sandstone, Tr Shale, Tr Coal	1,760	1,800	1,760	1,800
Silty Sandstone	1,800	1,880	1,800	1,880
Shaly Siltstone	1,880	2,075	1,880	2,094
Big Lime	2,105	2,950	2,124	2,981
Fifty Foot Sandstone	2,950	2,999	2,981	3,030
Gordon	2,999	3,197	3,030	3,232
Fifth Sandstone	3,197	3,454	3,232	3,492
Bayard	3,454	4,098	3,492	4,149
Speechley	4,098	4,322	4,149	4,378
Balltown	4,322	4,804	4,378	4,870
Bradford	4,804	5,093	4,870	5,162
Benson	5,093	5,485	5,162	5,559
Alexander	5,485	6,563	5,559	6,712
Sycamore	6,424	6,533	6,538	6,682
Middlesex	6,533	6,623	6,682	6,828
Burkett	6,623	6,642	6,828	6,865
Tully	6,642	6,702	6,865	7,025
Marcellus	6,702	NA	7,025	NA

RECEIVED  
Office of Oil and Gas

JAN 05 2024

WV Department of  
Environmental Protection

02/16/2024



LATITUDE 39°35'00" 915'

7,932' TO BOTTOM HOLE

LATITUDE 39°37'30"

10,163' TO BOTTOM HOLE

12,905'

LONGITUDE 80°50'00"

LONGITUDE 80°50'00"

Antero Resources Corporation Well No. Peach Fork Unit 1H

Table listing landowners in Ellsworth District - Tyler County, including names like Annette Hinkle, Ruby Carroll, Daniel Witschey, etc.

AS DRILLED DATA: WELL 1H TOP HOLE INFORMATION: N: 384,472ft E: 1,623,109ft LAT: 39°32'52.45" LON: 80°50'11.68" BOTTOM HOLE INFORMATION: N: 402,493ft E: 1,616,359ft LAT: 39°35'49.55" LON: 80°51'41.33" WEST VIRGINIA COORDINATE SYSTEM OF 1927 NORTH ZONE. ZONE WAS DERIVED FROM MEASUREMENTS TAKEN WITH TRIMBLE GEOXT SUBMETER MAPPING GRADE GPS UNIT. PLAT ORIENTATION, CORNER, AND WELL REFERENCE TIE LINES ARE BASED ON GRID NORTH.

(NAD) 83 (UTM) ZONE 17 COORDS: WELL 1H TOP HOLE INFORMATION: N: 4,377,602m E: 514,056m BOTTOM HOLE INFORMATION: N: 4,383,058m E: 511,908m

(NAD) 27 (UTM) ZONE 17 COORDS: WELL 1H TOP HOLE INFORMATION: N: 14,361,469ft E: 1,686,485ft POINT OF ENTRY INFORMATION: N: 14,362,264ft E: 1,685,322ft BOTTOM HOLE INFORMATION: N: 14,379,369ft E: 1,679,437ft

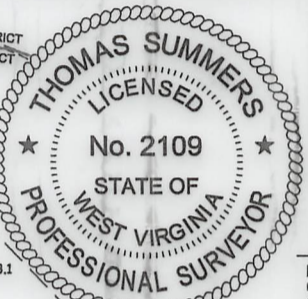

WV NORTH ZONE GRID NORTH

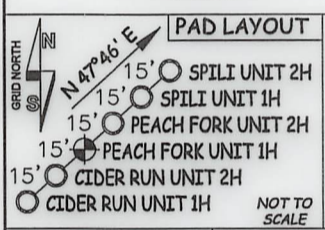
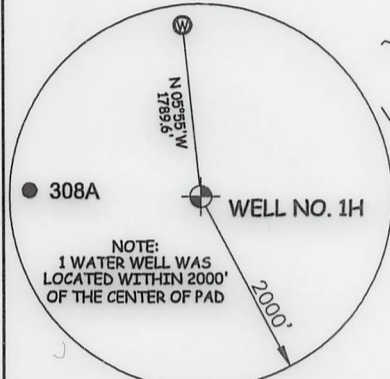

NOTE: 1. NO OCCUPIED DWELLINGS OR BUILDINGS TWO THOUSAND FIVE HUNDRED (2,500) SQUARE FEET OR LARGER USED TO HOUSE OR SHELTER DAIRY CATTLE OR POULTRY HUSBANDRY ARE LOCATED WITHIN SIX HUNDRED TWENTY-FIVE (625) FEET OF THE CENTER OF THE WELL PAD. 2. TOP HOLE DATA SHOWN HEREON WAS PROVIDED BY ANTERO RESOURCES CORPORATION. 3. AS DRILLED DATA WAS PROVIDED BY ANTERO RESOURCES CORPORATION. 4. VLS IS NOT CERTIFYING THE DATA AND INFORMATION PROVIDED LISTED IN NOTES 2 AND 3, ONLY THE RELATIONSHIP TO THE DATA AND INFORMATION PROVIDED TO THE LEASE BOUNDARIES. 5. VLS IS BY NO MEANS RESPONSIBLE FOR ANY ERRORS OR INACCURACIES WITH THE DATA AND INFORMATION THAT HAS BEEN PROVIDED.



STATE OF WEST VIRGINIA, DIVISION OF ENVIRONMENTAL PROTECTION, OFFICE OF OIL AND GAS. WILLOW LAND SURVEYING PLLC, 220 MASONIC AVE. PENNSBORO WEST VIRGINIA 26415

I THE UNDERSIGNED, HEREBY CERTIFY THAT THIS PLAT IS CORRECT TO THE BEST OF MY KNOWLEDGE AND BELIEF AND SHOWS ALL THE INFORMATION REQUIRED BY LAW AND THE RULES ISSUED AND PERSCRIBED BY THE DEPARTMENT OF ENVIRONMENTAL PROTECTION.

JOB # 20-011WA DRAWING # PEACHFORK1HAD SCALE 1" = 2000' MINIMUM DEGREE OF ACCURACY SUBMETER PROVEN SOURCE OF ELEV. SUBMETER MAPPING GRADE GPS

LEGEND: Surface Owner Boundary Lines +/-, Interior Surface Tracts +/-, Proposed Well Path, As Drilled Well Path. THOMAS SUMMERS P.S. 2109 DATE 11/09/23 OPERATOR'S WELL# PEACH FORK UNIT #1H

WELL TYPE: OIL GAS X LIQUID INJECTION WASTE DISPOSAL 47 095 02841 (IF "GAS") PRODUCTION X STORAGE DEEP SHALLOW X STATE COUNTY PERMIT LOCATION: ELEVATION 1,233' -AS BUILT WATERSHED OUTLET MIDDLE ISLAND CREEK QUADRANGLE PORTER FALLS 7.5' DISTRICT ELLSWORTH COUNTY TYLER SURFACE OWNER EDWARD YOST ESTATE ACREAGE 109.06 ACRES +/- LEASE ACREAGE 45.67 ACRES +/- OIL & GAS ROYALTY OWNER FISHER OIL COMPANY

PROPOSED WORK: DRILL CONVERT DRILL DEEPER REDRILL FRACTURE OR STIMULATE PLUG OFF OLD FORMATION PERFORATE NEW FORMATION OTHER PHYSICAL CHANGE IN WELL (SPECIFY) AS DRILLED PLUG & ABANDON CLEAN OUT & REPLUG TARGET FORMATION MARCELLUS ESTIMATED DEPTH 6,687' TVD 25,205' MD WELL OPERATOR ANTERO RESOURCES CORP. DESIGNATED AGENT KEVIN ELLIS ADDRESS 1615 WYNKOOP ST. DENVER, CO 80202 ADDRESS 535 WHITE OAK BLVD. BRIDGEPORT, WV 26330



LATITUDE 39°35'00" 915'

7,932' TO BOTTOM HOLE

LATITUDE 39°37'30"

10,163' TO BOTTOM HOLE

12,905'

LONGITUDE 80°50'00"

LONGITUDE 80°50'00"

Antero Resources Corporation Well No. Peach Fork Unit 1H

Table listing landowners and lease numbers for the Ellsworth District in Tyler County, West Virginia. Owners include names like Annette Hinkle, Ruby Carroll, Daniel Witschey, etc.

WV NORTH ZONE GRID NORTH

AS DRILLED DATA: WELL 1H TOP HOLE INFORMATION: N: 384,472ft E: 1,623,109ft LAT: 39°32'52.45" LON: 80°50'11.68" BOTTOM HOLE INFORMATION: N: 402,493ft E: 1,616,359ft LAT: 39°35'49.55" LON: 80°51'41.33" WEST VIRGINIA COORDINATE SYSTEM OF 1927 NORTH ZONE. ZONE WAS DERIVED FROM MEASUREMENTS TAKEN WITH TRIMBLE GEOXT SUBMETER MAPPING GRADE GPS UNIT. PLAT ORIENTATION, CORNER, AND WELL REFERENCE TIE LINES ARE BASED ON GRID NORTH.

(NAD) 83 (UTM) ZONE 17 COORDS: WELL 1H TOP HOLE INFORMATION: N: 4,377,602m E: 514,056m BOTTOM HOLE INFORMATION: N: 4,383,058m E: 511,908m

(NAD) 27 (UTM) ZONE 17 COORDS: WELL 1H TOP HOLE INFORMATION: N: 14,361,469ft E: 1,686,485ft POINT OF ENTRY INFORMATION: N: 14,362,264ft E: 1,685,322ft BOTTOM HOLE INFORMATION: N: 14,379,369ft E: 1,679,437ft

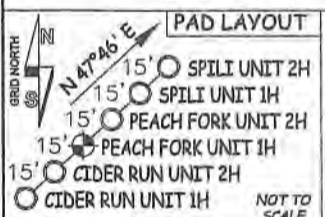
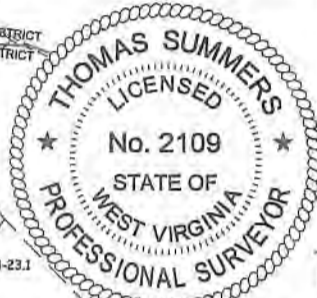

NOTE: 1. NO OCCUPIED DWELLINGS OR BUILDINGS TWO THOUSAND FIVE HUNDRED (2,500) SQUARE FEET OR LARGER USED TO HOUSE OR SHELTER DAIRY CATTLE OR POULTRY HUSBANDRY ARE LOCATED WITHIN SIX HUNDRED TWENTY-FIVE (625) FEET OF THE CENTER OF THE WELL PAD. 2. TOP HOLE DATA WAS PROVIDED BY ANTERO RESOURCES CORPORATION. 3. AS DRILLED DATA WAS PROVIDED BY ANTERO RESOURCES CORPORATION. 4. WLS IS NOT CERTIFYING THE DATA AND INFORMATION PROVIDED LISTED IN NOTES 2 AND 3, ONLY THE RELATIONSHIP TO THE DATA AND INFORMATION PROVIDED TO THE LEASE BOUNDARIES. 5. WLS IS BY NO MEANS RESPONSIBLE FOR ANY ERRORS OR INACCURACIES WITH THE DATA AND INFORMATION THAT HAS BEEN PROVIDED.



STATE OF WEST VIRGINIA, DIVISION OF ENVIRONMENTAL PROTECTION, OFFICE OF OIL AND GAS. WILLOW LAND SURVEYING PLLC, 220 MASONIC AVE. PENNSBORO WEST VIRGINIA 26415

I THE UNDERSIGNED, HEREBY CERTIFY THAT THIS PLAT IS CORRECT TO THE BEST OF MY KNOWLEDGE AND BELIEF AND SHOWS ALL THE INFORMATION REQUIRED BY LAW AND THE RULES ISSUED AND PERSCRIBED BY THE DEPARTMENT OF ENVIRONMENTAL PROTECTION.

JOB # 20-011WA DRAWING # PEACHFORK1HAD SCALE 1" = 2000' MINIMUM DEGREE OF ACCURACY SUBMETER PROVEN SOURCE OF ELEV. SUBMETER MAPPING GRADE GPS STATE OF WEST VIRGINIA DEPARTMENT OF ENERGY DIVISION OF OIL AND GAS

LEGEND: Surface Owner Boundary Lines +/-, Interior Surface Tracts +/-, Proposed Well Path, As Drilled Well Path. THOMAS SUMMERS P.S. 2109 DATE 11/09/23 OPERATOR'S WELL# PEACH FORK UNIT #1H

WELL TYPE: OIL GAS X LIQUID INJECTION WASTE DISPOSAL 47 095 02841 (IF "GAS") PRODUCTION X STORAGE DEEP SHALLOW X STATE COUNTY PERMIT LOCATION: ELEVATION 1,233'-AS BUILT WATERSHED OUTLET MIDDLE ISLAND CREEK QUADRANGLE PORTER FALLS 7.5' DISTRICT ELLSWORTH COUNTY TYLER SURFACE OWNER EDWARD YOST ESTATE ACREAGE 109.06 ACRES +/- OIL & GAS ROYALTY OWNER FISHER OIL COMPANY LEASE ACREAGE 45.67 ACRES±

PROPOSED WORK: DRILL CONVERT DRILL DEEPER REDRILL FRACTURE OR STIMULATE PLUG OFF OLD FORMATION PERFORATE NEW FORMATION OTHER PHYSICAL CHANGE IN WELL (SPECIFY AS DRILLED) PLUG & ABANDON CLEAN OUT & REPLUG TARGET FORMATION MARCELLUS ESTIMATED DEPTH 6,687' TVD 25,205' MD WELL OPERATOR ANTERO RESOURCES CORP. DESIGNATED AGENT KEVIN ELLIS ADDRESS 1615 WYNKOOP ST. ADDRESS 535 WHITE OAK BLVD. BRIDGEPORT, WV 26330 FORM WW-6 DENVER, CO 80202

02/16/2024



## Hydraulic Fracturing Fluid Product Component Information Disclosure

Job Start Date:	6/16/2023
Job End Date:	7/9/2023
State:	West Virginia
County:	Tyler
API Number:	47-095-02841-00-00
Operator Name:	Antero Resources Corporation
Well Name and Number:	PEACH FORK UNIT 1H
Latitude:	39.54797900
Longitude:	-80.83640600
Datum:	WGS84
Federal Well:	NO
Indian Well:	NO
True Vertical Depth:	7,868
Total Base Water Volume (gal):	28,312,532
Total Base Non Water Volume:	0



### Hydraulic Fracturing Fluid Composition:

Trade Name	Supplier	Purpose	Ingredients	Chemical Abstract Service Number (CAS #)	Maximum Ingredient Concentration in Additive (% by mass)**	Maximum Ingredient Concentration in HF Fluid (% by mass)**	Comments
Produced Water	Halliburton	Base Fluid					
			Water	7732-18-5	100.00000	86.34869	Density = 8.34
Ingredients	Listed Above	Listed Above					
			Water	7732-18-5	100.00000	0.16431	

RECEIVED  
 Office of Oil and Gas  
 JAN 05 2024  
 WV Department of Environmental Protection



MC B-8614A	MultiChem	Biocide					
				Listed Below			
FDP-S1464-22	Halliburton	Friction Reducer					
				Listed Below			
HAI-501	Halliburton	Acid Corrosion Inhibitor					
				Listed Below			
OPTIFLO-II DELAYED RELEASE BREAKER	Halliburton	Breaker					
				Listed Below			
WG-36 GELLING AGENT	Halliburton	Gelling Agent					
				Listed Below			
100 Mesh Permian	Halliburton	Proppant					
				Listed Below			
HYDROCHLORIC ACID, 22 BAUME	Halliburton	Solvent					
				Listed Below			
Items above are Trade Names with the exception of Base Water . Items below are the individual ingredients.							
			Crystalline silica, quartz	14808-60-7	100.00000	13.46448	
			Hydrochloric acid	7647-01-0	30.00000	0.03859	
			Complex amine compound	Proprietary	60.00000	0.02740	

RECEIVED  
 Office of Oil and Gas  
 JAN 05 2024  
 ENVIRONMENTAL  
 PROTECTION

			Hydrotreated distillate	Proprietary	30.00000	0.01370	
			Guar gum	9000-30-0	100.00000	0.00389	
			Glutaraldehyde	111-30-8	30.00000	0.00249	
			Ethoxylated alcohol	Proprietary	5.00000	0.00228	
			Fatty nitrogen derived amides	Proprietary	5.00000	0.00228	
			Ammonium chloride	12125-02-9	5.00000	0.00228	
			Sorbitan monooleate polyoxyethylene derivative	9005-65-6	1.00000	0.00046	
			Sorbitan, mono-9-octadecenoate, (Z)	1338-43-8	1.00000	0.00046	
			Alkyl (C12-16) dimethylbenzyl ammonium chloride	68424-85-1	5.00000	0.00041	
			Methanol	67-56-1	100.00000	0.00024	
			Ammonium persulfate	7727-54-0	100.00000	0.00014	
			Ethanol	64-17-5	1.00000	0.00008	
			Modified thiourea polymer	Proprietary	30.00000	0.00007	
			Mixture of dimer and trimer fatty acids of indefinite composition derived from tall oil	61790-12-3	30.00000	0.00007	
			Oxylated phenolic resin	Proprietary	30.00000	0.00004	
			Hexadecene	629-73-2	5.00000	0.00001	
			Ethoxylated alcohols	Proprietary	5.00000	0.00001	
			Propargyl alcohol	107-19-7	5.00000	0.00001	
			C.I. pigment Orange 5	3468-63-1	1.00000	0.00000	

RECEIVED  
 Office of Oil and Gas  
 JAN 08 2024

\* Total Water Volume sources may include various types of water including fresh water, produced water, and recycled water

\*\* Information is based on the maximum potential for concentration and thus the total may be over 100%

\*\*\* If you are calculating a percentage of total ingredients do not add the water volume below the green line to the water volume above the green line

Note: For Field Development Products (products that begin with FDP), MSDS level only information has been provided.

Ingredient information for chemicals subject to 29 CFR 1910.1200(i) and Appendix D are obtained from suppliers Material Safety Data Sheets (MSDS)