

LATITUDE 39°35'00" 904'

LATITUDE 39°37'30"

7,238' TO BOTTOM HOLE

9,540' TO BOTTOM HOLE

12,896'

LONGITUDE 80°50'00"

LONGITUDE 80°50'00"

Antero Resources Corporation Well No. Peach Fork Unit 2H

Table listing leaseholders for Ellsworth District - Tyler County, including Daniel Witschey, Michael Daugherty, Witschey Realty Inc., etc.

AS DRILLED DATA: WELL 2H TOP HOLE INFORMATION: N: 384,480ft E: 1,623,119ft... BOTTOM HOLE INFORMATION: N: 403,106ft E: 1,617,061ft...

(NAD) 83 (UTM) ZONE 17 COORDS: WELL 2H TOP HOLE INFORMATION: N: 4,377,605m E: 514,059m...

(NAD) 27 (UTM) ZONE 17 COORDS: WELL 2H TOP HOLE INFORMATION: N: 14,361,477ft E: 1,686,495ft...

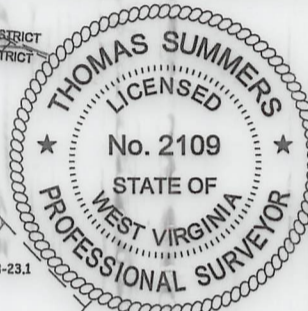

WV NORTH ZONE GRID NORTH

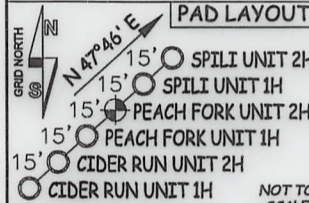
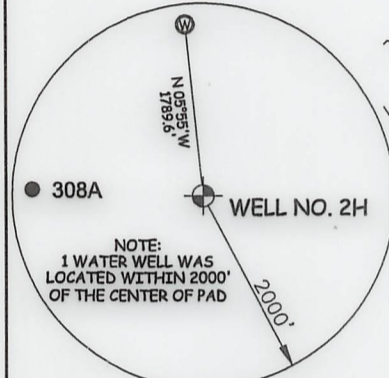

NOTE: 1. NO OCCUPIED DWELLINGS OR BUILDINGS TWO THOUSAND FIVE HUNDRED (2,500) SQUARE FEET OR LARGER USED TO HOUSE OR SHELTER DAIRY CATTLE OR POULTRY HUSBANDRY...



STATE OF WEST VIRGINIA, DIVISION OF ENVIRONMENTAL PROTECTION, OFFICE OF OIL AND GAS. WILLOW LAND SURVEYING PLLC, 220 MASONIC AVE. PENNSBORO WEST VIRGINIA 26415

I THE UNDERSIGNED, HEREBY CERTIFY THAT THIS PLAN IS CORRECT TO THE BEST OF MY KNOWLEDGE AND BELIEF AND SHOWS ALL THE INFORMATION REQUIRED BY LAW AND THE RULES ISSUED AND PERSCRIBED BY THE DEPARTMENT OF ENVIRONMENTAL PROTECTION.

JOB # 20-011WA DRAWING # PEACHFORK2HAD SCALE 1" = 2000' MINIMUM DEGREE OF ACCURACY SUBMETER PROVEN SOURCE OF ELEV. SUBMETER MAPPING GRADE GPS

LEGEND: Surface Owner Boundary Lines +/-, Interior Surface Tracts +/-, Proposed Well Path, As Drilled Well Path. THOMAS SUMMERS P.S. 2109 DATE 11/09/23 OPERATOR'S WELL # PEACH FORK UNIT #2H

WELL TYPE: OIL GAS X LIQUID INJECTION WASTE DISPOSAL 47 095 02842 (IF "GAS") PRODUCTION X STORAGE DEEP SHALLOW X STATE COUNTY 02/16/2024 LOCATION: ELEVATION 1,233' - AS BUILT WATERSHED OUTLET MIDDLE ISLAND CREEK QUADRANGLE PORTER FALLS 7.5' DISTRICT ELLSWORTH COUNTY TYLER SURFACE OWNER EDWARD YOST ESTATE ACREAGE 109.06 ACRES +/- OIL & GAS ROYALTY OWNER FISHER OIL COMPANY LEASE ACREAGE 45.67 ACRES +/-

PROPOSED WORK: DRILL CONVERT DRILL DEEPER REDRILL FRACTURE OR STIMULATE PLUG OFF OLD FORMATION PERFORATE NEW FORMATION OTHER PHYSICAL CHANGE IN WELL (SPECIFY) AS DRILLED PLUG & ABANDON CLEAN OUT & REPLUG TARGET FORMATION MARCELLUS ESTIMATED DEPTH 6,689' TVD 25,626' MD WELL OPERATOR ANTERO RESOURCES CORP. DESIGNATED AGENT KEVIN ELLIS ADDRESS 1615 WYNKOOP ST. ADDRESS 535 WHITE OAK BLVD. DENVER, CO 80202 BRIDGEPORT, WV 26330