

**Antero Resources
Well No. Calvin 2H**

PAGE 1 of 2

Antero Resources Corporation

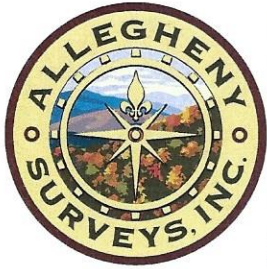

Calvin Unit 2H
Bottom Hole

7,543' to Bottom Hole
4,479' to Top Hole
TOP HOLE LATITUDE 39 - 30 - 00
BTM HOLE LATITUDE 39 - 32 - 30

Notes
West Virginia Coordinate System of 1927, North Zone based upon Differential GPS Measurements.
Well No. Calvin Unit 2H Top Hole coordinates are
N: 362,156.11" Latitude: 39°29'05.85"
E: 1,583,928.48" Longitude: 80°58'27.12"
Bottom Hole coordinates are
N: 371,660.67" Latitude: 39°30'39.31"
E: 1,581,017.81" Longitude: 80°59'06.25"
UTM Zone 17, NAD 1983
Top Hole Coordinates Bottom Hole Coordinates
N: 4,370,604.018m N: 4,373,484.801m
E: 502,233.193m E: 501,298.128m
Plat orientation and corner and well references are based upon the grid north meridian.
Well location references are based upon the magnetic meridian.

5,479' to Top Hole

11,200' to Bottom Hole

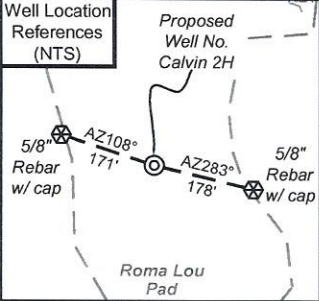

I, the undersigned, hereby certify that this plat is correct to the best of my knowledge and belief and shows all the information required by law and the rules issued and prescribed by the Department of Environmental Protection.

Bradley D. Miller
Bradley D. Miller, P.S. 2167

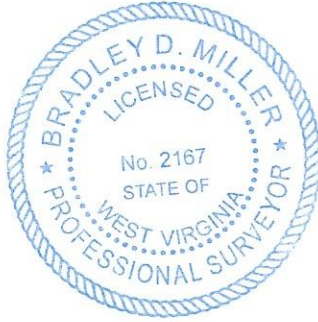

SEAL

Notes:
Well No. Calvin Unit 2H UTM Zone 17, NAD 1927
Top Hole Coordinates
N: 14,338,509.80'
E: 1,647,695.90'
Point of Entry Coordinates
N: 14,338,562.11'
E: 1,647,800.90'
Bottom Hole Coordinates
N: 14,347,961.20'
E: 1,644,628.01'

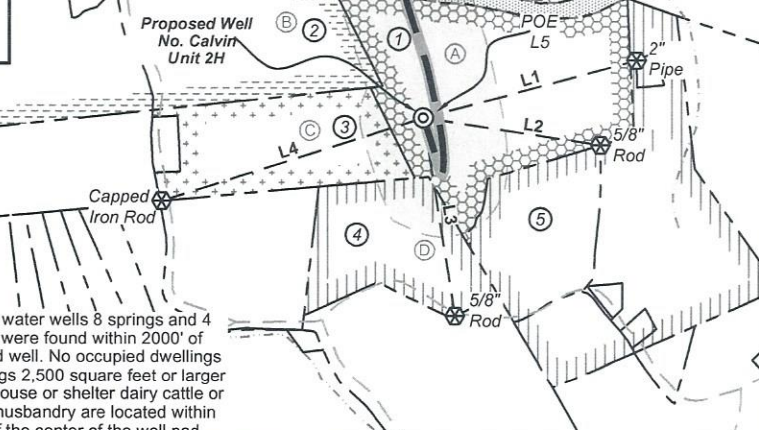
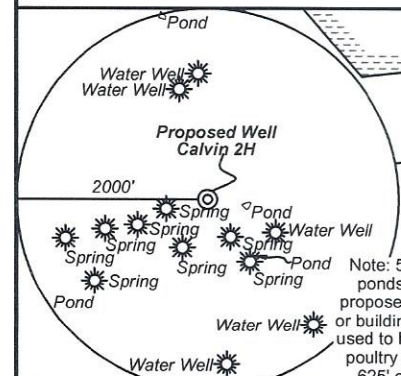
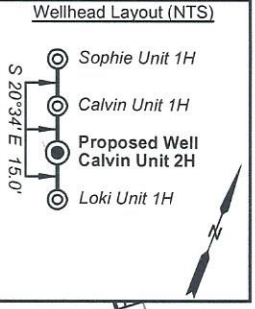

	Bearing	Dist.
L1	S 74°47' W	1,730.6'
L2	N 81°17' W	1,404.0'
L3	N 08°59' W	1,572.3'
L4	N 72°21' E	2,151.5'
L5	N 64°29' E	117.3'

Legend

- Proposed gas well
- Monument, as noted
- Existing Well, as noted
- Digitized Well, as noted
- Creek or Drain
- Road
- Surface boundary (approx.)
- Interior surface tracts (approx.)
- District Line

FILE NO: 258-54-U-22
DRAWING NO: Calvin Unit 2H
SCALE: 1" = 1500'
MINIMUM DEGREE OF ACCURACY: Submeter
PROVEN SOURCE OF ELEVATION: WVDOT, Harrisville, WV

STATE OF WEST VIRGINIA
DEPARTMENT OF ENVIRONMENTAL PROTECTION
OIL AND GAS DIVISION

DATE: January 23 2023
OPERATOR'S WELL NO. Calvin 2H
API WELL NO
47 - 095 - 02948
STATE COUNTY PERMIT

WELL TYPE: OIL GAS LIQUID INJECTION WASTE DISPOSAL
(IF GAS) PRODUCTION: STORAGE DEEP SHALLOW

LOCATION: ELEVATION: As-Built 883' WATERSHED: Outlet Middle Island Creek QUADRANGLE: BH: Paden City
DISTRICT: Union/Lincoln COUNTY: Tyler 03/17/2023
SURFACE OWNER: Antero Resources Corp. Linda Pryor Henriksen, et vir; Arnold L. Schulberg Oil & Gas Trust; Warren R. & Mary N. Stewart; Greenbrier Royalty Fund III, LLC; ACREAGE: 60.38 57.23; 250.5; 72.88;
ROYALTY OWNER: Berna J. Hammel; WVDNR; Steven D. Zechman & Linda M. Jensen; Jay Edward Smith; Haight Family Trust; David L. Stewart; Warren T. Stewart; 339.71; 38; 65; 0.69;
PROPOSED WORK: DRILL CONVERT DRILL DEEPER FRACTURE OR STIMULATE PLUG OFF OLD FORMATION
 PERFORATE NEW FORMATION OTHER PHYSICAL CHANGE IN WELL (SPECIFY) _____ LEASE NO: _____ ACREAGE: 65.462; 83.61; 158.74
 PLUG AND ABANDON CLEAN OUT AND REPLUG TARGET FORMATION: Marcellus Shale ESTIMATED DEPTH: 17,900' MD 6,500' TVD

WELL OPERATOR: Antero Resources Corporation DESIGNATED AGENT: Kevin Ellis
ADDRESS: 1615 Wynkoop Street ADDRESS: 535 White Oaks Blvd.
Denver, CO 80202 Bridgeport, WV 26330

Antero Resources Corporation

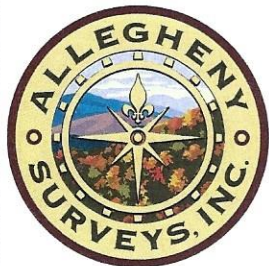

ID	TM-Par	Owner	Bk/Pg	Acres
1	10-4.1	Antero Resources Corporation	OR12/739	60.38
2	9-9.1	Jennifer K. & Diane M. Thomas	AR46/754	40.00
3	10-4	Kevin L. & Tammy J. Thomas	OR7/290	32.22
4	10-5.3	Richard Daniel Bowen	344/814	25.92
5	10-5.5	Bowen Family Irrevocable Trust	372/303	22.89
6	9-4	Steven D. Zechman & Linda M. Jensen	348/422	250.00
7	6-3	Eldon J. & Ruth A. Helman	383/761	72.80
8	5-16	Charity Gas Inc.	358/516	393.00
9	5-15.3	David L. Stewart	WB39/431	38.00
10	6-4	Darren E. Thacker	616/762	67.00
11	5-15	Warren T. Stewart	WB39/431	25.00
12	5-15.2	Warren T. Stewart	501/702	40.00
13	6-5.2	Julia Felty Carolus	323/585	5.50
14	5-15.1	Warren T. & Mary N. Stewart	249/576	0.69
15	5-26	Paul R. Felty	288/126	82.22
16	5-5	Antero Resources Corp.	598/600	173.00
17	14-1	Edward E. & Connie Howell	361/829	158.74

Leases	
A	Berna J. Hammel
B	Mary Faye Grove
C	Sally & Mitchell Dunn
D	J&N Management Enterprises, LLC
E	WVDNR
F	Steven D. Zechman & Linda M. Jensen
G	Jay Edward Smith
H	Haught Family Trust
I	David L. Stewart
J	Greenbrier Royalty Fund III, LLC
K	Warren T. Stewart
L	Warren R. & Mary N. Stewart
M	Linda Pryor Henriksen, et vir
N	Ridgetop Appalachia, LLC
O	Arnold L. Schulberg Oil and Gas Trust

FILE NO: 258-54-U-22
 DRAWING NO: Calvin Unit 2H
 SCALE: 1" = 1500'
 MINIMUM DEGREE OF ACCURACY:
Submeter
 PROVEN SOURCE OF ELEVATION:
WVDOT, Harrisville, WV



DATE: January 23 2023
 OPERATOR'S WELL NO. Calvin 2H
 API WELL NO
47 - 095 - 02849
 STATE COUNTY PERMIT

WELL TYPE: OIL GAS LIQUID INJECTION WASTE DISPOSAL
 (IF GAS) PRODUCTION: STORAGE DEEP SHALLOW

LOCATION: ELEVATION: As-Built 883' WATERSHED: Outlet Middle Island Creek QUADRANGLE: BH: Paden City
 DISTRICT: Union/Lincoln COUNTY: Tyler **03/17/2023**
 SURFACE OWNER: Antero Resources Corp. Linda Pryor Henriksen, et vir; Arnold L. Schulberg Oil & Gas Trust; Warren R. & Mary N. Stewart; Greenbrier Royalty Fund III, LLC; Haught Family Trust; David L. Stewart; Warren T. Stewart; ACREAGE: 60.38 57.23; 250.5; 72.88; 339.71; 38; 65; 0.69;
 ROYALTY OWNER: Berna J. Hammel; WVDNR; Steven D. Zechman & Linda M. Jensen; Jay Edward Smith; LEASE NO: _____ ACREAGE: 65.462; 83.61; 158.74
 PROPOSED WORK: DRILL CONVERT DRILL DEEPER FRACTURE OR STIMULATE PLUG OFF OLD FORMATION
 PERFORATE NEW FORMATION OTHER PHYSICAL CHANGE IN WELL (SPECIFY) _____ 6,500' TVD
 PLUG AND ABANDON CLEAN OUT AND REPLUG TARGET FORMATION: Marcellus Shale ESTIMATED DEPTH: 17,900' MD

WELL OPERATOR: Antero Resources Corporation DESIGNATED AGENT: Kevin Ellis
 ADDRESS: 1615 Wynkoop Street ADDRESS: 535 White Oaks Blvd.
Denver, CO 80202 Bridgeport, WV 26330