

9,526' to Bottom Hole

4,479' to Top Hole
TOP HOLE LATITUDE 39 - 30 - 00
BTM HOLE LATITUDE 39 - 32 - 30

LONGITUDE 80 - 57 - 30

5,417' to Bottom Hole

5,479' to Top Hole

Antero Resources
Well No. Calvin 2H
As-Drilled
Antero Resources Corporation

PAGE 1 of 2

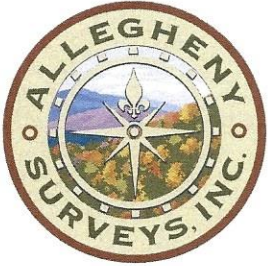

Top Hole Coordinates, As-drilled data, and information was provided by Antero Resources Corporation. Allegheny Surveys Inc. (ASI) is not certifying the data and information provided. ASI is not responsible for any errors or inaccuracies with the data and information that has been provided.

I, the undersigned, hereby certify that this plat is correct to the best of my knowledge and belief and shows all the information required by law and the rules issued and prescribed by the Department of Environmental Protection.

Bradley D. Miller
Bradley D. Miller, P.S. 2167

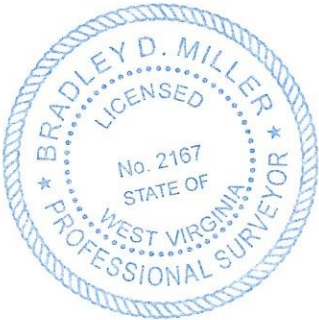

SEAL

Note: 5 water wells 8 springs and 4 ponds were found within 2000' of proposed well. No occupied dwellings or buildings 2,500 square feet or larger used to house or shelter dairy cattle or poultry husbandry are located within 625' of the center of the well pad.

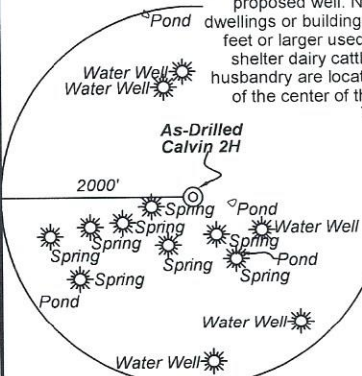

Legend

- Proposed gas well
- Monument, as noted
- Existing Well, as noted
- Digitized Well, as noted
- Creek or Drain
- Road
- Surface boundary (approx.)
- Interior surface tracts (approx.)
- District Line

Notes
West Virginia Coordinate System of 1927, North Zone based upon Differential GPS Measurements.
Well No. Calvin Unit 2H Top Hole coordinates are
N: 362,156.49' Latitude: 39°29'05.85"
E: 1,583,928.38' Longitude: 80°58'27.12"
Bottom Hole coordinates are
N: 377,475.29' Latitude: 39°31'36.46"
E: 1,579,129.41' Longitude: 80°59'31.57"
UTM Zone 17, NAD 1983
Top Hole Coordinates Bottom Hole Coordinates
N: 4,370,604.133m N: 4,375,246.642m
E: 502,233.160m E: 500,693.284m
Plat orientation and corner and well references are based upon the grid north meridian.
Well location references are based upon the magnetic meridian.

Calvin 2H As-Drilled POE Coordinates
West Virginia Coordinate System of 1927, North Zone
N: 362,214.70'
E: 1,584,019.16'
Latitude: 39°29'06.44"
Longitude: 80°58'25.98"
UTM Zone 17, NAD 1983
N: 4,370,622.330m
E: 502,260.520m

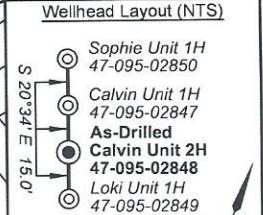

	Bearing	Dist.
L1	S 74°47' W	1,730.6'
L2	N 81°16' W	1,404.1'
L3	N 09°00' W	1,572.7'
L4	N 72°20' E	2,151.6'

RECEIVED
Office of Oil and Gas
FEB 02 2024

WV Department of Environmental Protection

FILE NO: 258-54-U-22
DRAWING NO: Calvin Unit 2H As-Drilled
SCALE: 1" = 2000'
MINIMUM DEGREE OF ACCURACY: Submeter
PROVEN SOURCE OF ELEVATION: WVDOT, Harrisville, WV

STATE OF WEST VIRGINIA
DEPARTMENT OF ENVIRONMENTAL PROTECTION
OIL AND GAS DIVISION

DATE: January 17 20 24
OPERATOR'S WELL NO. Calvin 2H
API WELL NO
47 - 095 - 02848
STATE COUNTY PERMIT

WELL TYPE: OIL GAS LIQUID INJECTION WASTE DISPOSAL
(IF GAS) PRODUCTION: STORAGE DEEP SHALLOW

LOCATION: ELEVATION: As-Built 883' WATERSHED: Outlet Middle Island Creek QUADRANGLE: BH: Paden City 60.38;
DISTRICT: Union/Lincoln Ridgetop Appalachia, LLC; Shannon H. McCullough; Colleen Marie Anderson; 57.23; 250.5;
SURFACE OWNER: Antero Resources Corp. Warren R. & Mary N. Stewart; Greenbrier Royalty Fund III, LLC; 59.24; 14.8;
ROYALTY OWNER: Berna J. Hammel; WVDNR; Steven D. Zechman & Linda M. Jensen; Jay Edward Smith; Haught Family Trust; David L. Stewart; Warren T. Stewart; 65; 0.69; 65.462;
PROPOSED WORK: DRILL CONVERT DRILL DEEPER FRACTURE OR STIMULATE PLUG OFF OLD FORMATION
 PERFORATE NEW FORMATION OTHER PHYSICAL CHANGE IN WELL (SPECIFY) As-Drilled 5,980' TVD
 PLUG AND ABANDON CLEAN OUT AND REPLUG TARGET FORMATION: Marcellus Shale ESTIMATED DEPTH: 22,330' MD

WELL OPERATOR: Antero Resources Corporation DESIGNATED AGENT: Kevin Ellis
ADDRESS: 1615 Wynkoop Street ADDRESS: 535 White Oaks Blvd.
Denver, CO 80202 Bridgeport, WV 26330



ID	TM-Par	Owner	Bk/Pg	Acres
1	10-4.1	Antero Resources Corporation	OR12/739	60.38
2	9-9.1	Jennifer K. & Diane M. Thomas	AR46/754	40.00
3	10-4	Kevin L. & Tammy J. Thomas	OR7/290	32.22
4	10-5.3	Richard Daniel Bowen	344/814	25.92
5	10-5.5	Bowen Family Irrevocable Trust	372/303	22.89
6	9-4	Steven D. Zechman & Linda M. Jensen	348/422	250.00
7	6-3	Eldon J. & Ruth A. Helman	383/761	72.80
8	5-16	Charity Gas Inc.	358/516	393.00
9	5-15.3	David L. Stewart	WB39/431	38.00
10	6-4	Darren E. Thacker	616/762	67.00
11	5-15	Warren T. Stewart	WB39/431	25.00
12	5-15.2	Warren T. Stewart	501/702	40.00
13	6-5.2	Julia Fetty Carolus	323/585	5.50
14	5-15.1	Warren T. & Mary N. Stewart	249/576	0.69
15	5-26	Paul R. Fetty	288/126	82.22
16	5-5	Antero Resources Corp.	598/600	173.00
17	14-1	Edward E. & Connie Howell	361/829	158.74
18	11-11	Thomas E. Bowen	374/636	119.75
19	11-12	Patrick & Kevin Hill, et al	584/619	59.95
20	11-14	Calvin Lee & Irene M. Stewart	251/635	4.99
21	11-13	Donald & Arieille Beaumier	OR166/365	25.50
22	11-14.2	Gerald Eugene & Sonya Stewart	374/843	1.75
23	11-14.1	Gerald Eugene Stewart	279/572	3.00
24	11-16	John Mark Campbell	326/365	8.85
25	11-17	Thomas E. Neff	341/213	10.00
26	11-18	William L. & Lynn A. Hinkle	366/387	72.50
27	11-21.3	Bryan Steven & Vanessa Nicole Owens	OR97/316	9.93
28	11-19.1	Sheila & Rex Ervin	409/542	34.55
29	11-20	Virginia Kasun	216/513	0.26
30	11-19.2	Jereld A. & Holly J. Cunningham	294/161	6.08
31	11-21.1	Bryan Steven & Vanessa Nicole Owens	OR97/316	23.47
32	11-19	Bessie R. Cochran	WB28/156	0.95
33	11-21.2	The John Porfeli Living Trust	513/812	13.54
34	11-23.1	Ronda S. Parsons	387/398	4.65

Leases	
A	Berna J. Hammel
B	Mary Faye Grove
C	Sally & Mitchell Dunn
D	J&N Management Enterprises, LLC
E	WVDNR
F	Steven D. Zechman & Linda M. Jensen
G	Jay Edward Smith
H	Haught Family Trust
I	David L. Stewart
J	Greenbrier Royalty Fund III, LLC
K	Warren T. Stewart
L	Julia Marie May
M	Warren R. & Mary N. Stewart
N	Linda Pryor Henriksen, et vir
O	Ridgetop Appalachia, LLC
P	Arnold L. Schulberg Oil and Gas Trust
Q	Warren V. Bowen
R	Shannon H. McCullough
S	Colleen Marie Anderson
T	John Mark Campbell
U	Donald A. Quinif, et ux

RECEIVED
Office of Oil and Gas

FEB 02 2024

WV Department of
Environmental Protection

FILE NO: 258-54-U-22
 DRAWING NO: Calvin Unit 2H As-Drilled
 SCALE: 1" = 2000'
 MINIMUM DEGREE OF ACCURACY:
 Submeter
 PROVEN SOURCE OF ELEVATION:
 WVDOT, Harrisville, WV

STATE OF WEST VIRGINIA
 DEPARTMENT OF ENVIRONMENTAL PROTECTION
OIL AND GAS DIVISION

DATE: January 17 20 24
 OPERATOR'S WELL NO. Calvin 2H
 API WELL NO
 47 - 095 - 02848
 STATE COUNTY PERMIT

WELL TYPE: OIL GAS LIQUID INJECTION WASTE DISPOSAL
 (IF GAS) PRODUCTION: STORAGE DEEP SHALLOW

LOCATION: ELEVATION: As-Built 883' WATERSHED: Outlet Middle Island Creek QUADRANGLE: BH: Paden City 60.38;
 DISTRICT: Union/Lincoln Ridgetop Appalachia, LLC; Shannon H. McCullough; Colleen Marie Anderson; COUNTY: Tyler 57.23; 250.5;
 SURFACE OWNER: Antero Resources Corp. Warren R. & Mary N. Stewart; Greenbrier Royalty Fund III, LLC; ACREAGE: 60.38 65; 0.69; 65.462;
 ROYALTY OWNER: Berna J. Hammel; WVDNR; Steven D. Zechman & Linda M. Jensen; Jay Edward Smith; LEASE NO: ACREAGE: 83.61; 158.74; 151.50;
 PROPOSED WORK: DRILL CONVERT DRILL DEEPER FRACTURE OR STIMULATE PLUG OFF OLD FORMATION
 PERFORATE NEW FORMATION OTHER PHYSICAL CHANGE IN WELL (SPECIFY) As-Drilled 5,980' TVD
 PLUG AND ABANDON CLEAN OUT AND REPLUG TARGET FORMATION: Marcellus Shale ESTIMATED DEPTH: 22,330' MD

WELL OPERATOR: Antero Resources Corporation DESIGNATED AGENT: Kevin Ellis
 ADDRESS: 1615 Wynkoop Street ADDRESS: 535 White Oaks Blvd.
 Denver, CO 80202 Bridgeport, WV 26330