

Antero Resources
Well No. Ringnus 2H
As-Drilled
 Antero Resources Corporation

PAGE 1 of 2

10,408' to Top Hole

4,751' to Bottom Hole
TOP HOLE LATITUDE 39 - 35 - 00
BTM HOLE LATITUDE 39 - 37 - 30

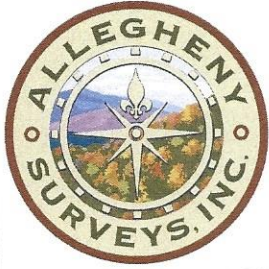

Notes
 West Virginia Coordinate System of 1927, North Zone based upon Differential GPS Measurements.
 Well No. Ringnus Unit 2H Top Hole coordinates are
 N: 386,241.71' Latitude: 39°33'06.73"
 E: 1,601,890.58' Longitude: 80°54'42.88"
 Bottom Hole coordinates are
 N: 403,737.18' Latitude: 39°35'58.72"
 E: 1,596,073.52' Longitude: 80°56'00.70"
 UTM Zone 17, NAD 1983
 Top Hole Coordinates Bottom Hole Coordinates
 N: 4,378,033.356m N: 4,383,333.838m
 E: 507,583.051m E: 505,722.005m
 Plat orientation and corner and well references are based upon the grid north meridian.
 Well location references are based upon the magnetic meridian.

Top Hole Coordinates, As-drilled data, and information was provided by Antero Resources Corporation. Allegheny Surveys Inc. (ASI) is not certifying the data and information provided. ASI is not responsible for any errors or inaccuracies with the data and information that has been provided.

I, the undersigned, hereby certify that this plat is correct to the best of my knowledge and belief and shows all the information required by law and the rules issued and prescribed by the Department of Environmental Protection.

Bradley D. Miller
 Bradley D. Miller, P.S. 2167

Ringnus 2H As-Drilled POE Coordinates
 West Virginia Coordinate System of 1927, North Zone
 N: 385,859.75'
 E: 1,601,891.17'
 Latitude: 39°33'02.96"
 Longitude: 80°54'42.79"
 UTM Zone 17, NAD 1983
 N: 4,377,916.992m
 E: 507,585.170m

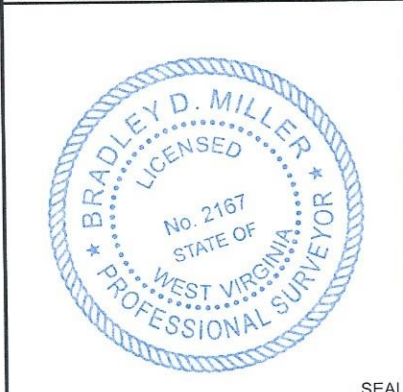

Note: 1 water well were found within 2000' of proposed well. No occupied dwellings or buildings 2,500 square feet or larger used to house or shelter dairy cattle or poultry husbandry are located within 625' of the center of the well pad.

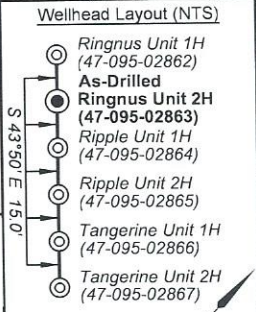
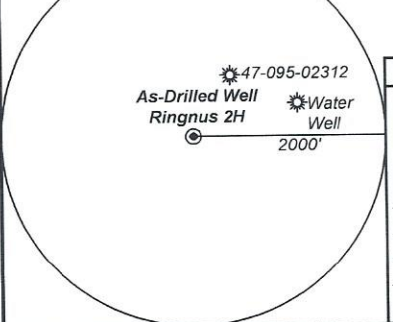

- Legend**
- Proposed gas well
 - Monument, as noted
 - Existing Well, as noted
 - Digitized Well, as noted
 - Creek or Drain
 - Road
 - Surface boundary (approx.)
 - Interior surface tracts (approx.)
 - County Line

SEAL

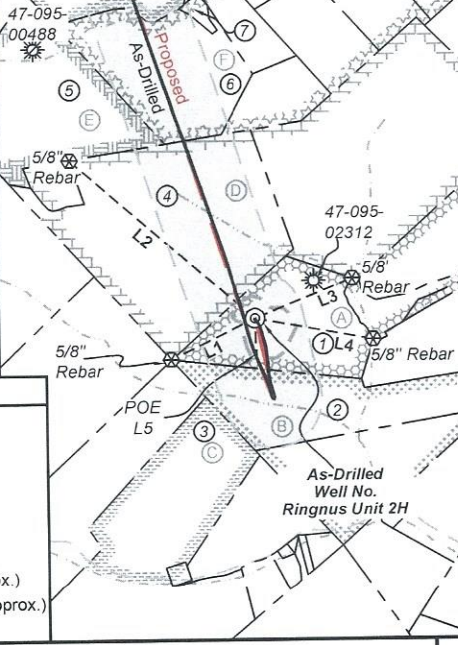

	Bearing	Dist.
L1	N 64°06' E	975.0'
L2	S 48°50' E	2,539.4'
L3	S 67°42' W	1,094.6'
L4	N 79°28' W	1,245.9'

FILE NO: 20-54-L-18
 DRAWING NO: Ringnus 2H As-Drilled
 SCALE: 1" = 2000'
 MINIMUM DEGREE OF ACCURACY: Submeter
 PROVEN SOURCE OF ELEVATION: WVDOT, Harrisville, WV

STATE OF WEST VIRGINIA
 DEPARTMENT OF ENVIRONMENTAL PROTECTION
OIL AND GAS DIVISION

DATE: January 17 2024
 OPERATOR'S WELL NO. Ringnus 2H
 API WELL NO
 47 - 95 - 02863
 STATE COUNTY PERMIT

WELL TYPE: OIL GAS LIQUID INJECTION WASTE DISPOSAL
 (IF GAS) PRODUCTION: STORAGE DEEP SHALLOW

LOCATION: ELEVATION: As-Built 1,007' WATERSHED: Outlet Middle Island Creek QUADRANGLE: Paden City 164.21; 93.167; 47.47;
 DISTRICT: Lincoln COUNTY: Tyler 190.043; 267.113;
 SURFACE OWNER: David E. Bowyer LONNIE L. & BETTIE LOU BILLITER, JOHN PAUL BUCK, ET UX; LEE & HALL ROYALTIES, GARY HOLMES, ET UX; BOUNTY MINERALS, LLC; HENRY P. SNYDER, ET AL; WACO OIL & GAS CO. INC.; BRANDON P. MASON, ET UX; HERITAGE RESOURCES MARCELLUS MINERALS, LLC; JANEL L. HEINTZMAN, JANE ANN MILLER, DRILLING APPALACHIAN CORPORATION; RICHARD TUTTLE, ET UX; 24,832.66; 29.6;
 ROYALTY OWNER: Timothy L. VanCamp, Tamara M. Reynolds, BRC Appalachian Minerals I, LLC, J. Maurice Carlisle; LEASE NO: ACREAGE: 85.785 58.293; 9.93; 95.4; 200
 PROPOSED WORK: DRILL CONVERT DRILL DEEPER FRACTURE OR STIMULATE PLUG OFF OLD FORMATION
 PERFORATE NEW FORMATION OTHER PHYSICAL CHANGE IN WELL (SPECIFY) As-Drilled 6,237' TVD
 PLUG AND ABANDON CLEAN OUT AND REPLUG TARGET FORMATION: Marcellus Shale ESTIMATED DEPTH: 25,441' MD

WELL OPERATOR: Antero Resources Corporation DESIGNATED AGENT: Kevin Ellis
 ADDRESS: 1615 Wynkoop Street ADDRESS: 535 White Oaks Blvd.
 Denver, CO 80202 Bridgeport, WV 26330

06/28/2024

Antero Resources
Well No. Ringnus 2H
As-Drilled
 Antero Resources Corporation

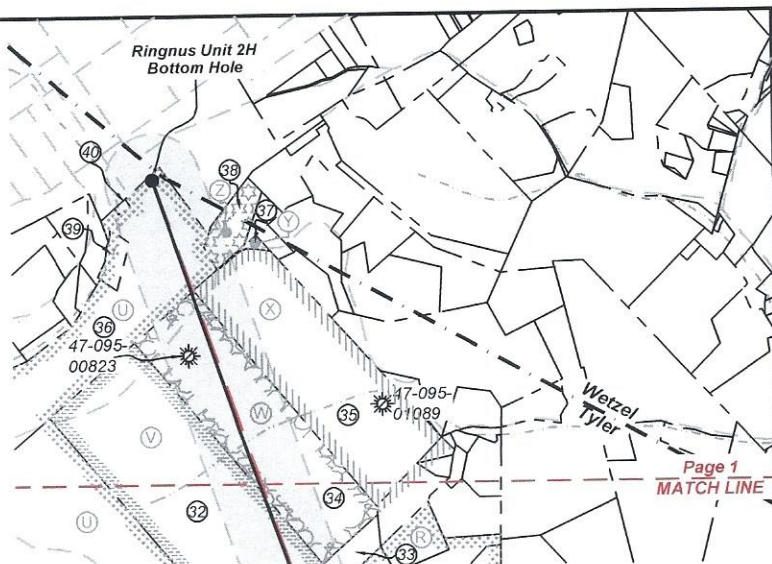
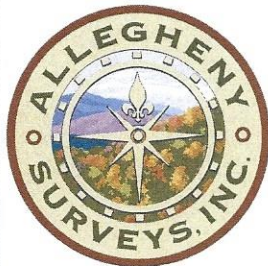

ID	TM-Par	Owner	Bk/Pg	Acres
1	9-19	David E. Bowyer	OR16/22	85.79
2	9-31.1	David E. Bowyer	OR16/22	38.04
3	9-28	Constance Heintzman	WB43/505	104.50
4	9-17	Ethan A. & Marsha L. Riffle	323/649	90.04
5	9-16	Donald Grimes	547/631	118.21
6	9-6.1	Larry G. & Joyce Ann Kaprich	326/874	40.51
7	9-6.3	Donna E. Cecil	611/328	1.44
8	9-5.1	Carl L. & Donna M. Yoho	328/400	1.65
9	9-5	Chad & Janet L. Heintzman	330/527	64.35
10	9-7.1	Carl L & Donna M Yoho	320/456	117.00
11	5-18	Melvin S. Stern, et al	222/185	43.50
12	5-17	Kenneth W. & Susan D. Paden	215/390	11.11
13	5-16	Kenneth W. & Susan D. Paden	215/390	11.11
14	5-14	Kenneth W. & Susan D. Paden	215/390	55.22
15	5-15	Kenneth W. & Susan D. Paden	215/390	21.32
16	5-15.1	Joshua K. & Tomela Paden	355/821	1.00
17	5-19	John P. & Susan Buck	337/634	159.21
18	5-7	Jane Buck	42/148	0.87
19	5-9.2	Bryan Scott & Eleanor A. Campbell	350/334	1.23
20	5-9	Sally Anderson	368/92	25.89
21	5-9.3	Franklin G. & Nancy M. Broughman	351/143	8.92
22	5-8	Franklin & Nancy Broughman	338/292	33.17
23	5-2.1	John Goode	OR28/720	27.52
24	5-1	Richard Lee & Linda Tuttle	362/43	88.00
25	5-34	Timothy J. & Miranda Haynes	OR151/407	74.50
26	5-35	Ethel & Timothy Brown	AR45/28	8.50
27	5-36	Brandon P. Mason and Katie E. Mason	396/464	56.86
28	5-41	Cheryl W. Cowen, et al	166/56	36.00
29	5-38	Clegg Family Irrevocable Trust	361/387	3.50
30	5-37	Clegg Family Irrevocable Trust	369/576	19.80
31	2-??	Shawn D. & Tara A. Cross	612/75	---
32	1-8	Gary & Marsha L. Holmes	372/325	95.40
33	2-11	Misty D. Willey	555/467	4.00
34	2-1	Lloyd Wayne & Lottie Cross	188/383	50.00
35	2-2	Betty Lou Billiter Irrevocable Trust	375/476	65.00
36	15-12	Mike Ross Inc.	459/59	69.45
37	2-5	Betty Lou Billiter Irrevocable Trust	375/476	0.60
38	15-4	Linda K Patterson et al	AP97/843	7.17
39	1-27	Lloyd Lewis	295/505	2.50
40	1-22	Monongahela Power Company	184/487	0.28

Leases	
A	Timothy L. VanCamp
B	Tamara M. Reynolds
C	Martha Hayes, et vir
D	BRC Appalachian Minerals I LLC
E	Earl Grimes, et ux
F	J. Maurice Carlisle
G	John T. Goosman, et ux
H	Janet L. Heintzman
I	BRC Appalachian Minerals I, LLC
J	Jane Ann Miller
K	John Paul Buck, et ux
L	BRC Appalachian Minerals I, LLC
M	Drilling Appalachian Corporation
N	Ralph & Stella Judge
O	Richard Tuttle, et ux
P	Waco Oil & Gas Co Inc.
Q	Brandon P. Mason, et ux
R	Heritage Resources - Marcellus Minerals, LLC
S	Lee & Hall Royalties
T	BRC Appalachian Minerals I, LLC
U	Henry P. Snyder, et al
V	Gary Holmes, et ux
W	Bounty Minerals, LLC
X	Lonnie L. & Bettie Lou Billiter
Y	Betty Lou Billiter Irrevocable Trust
Z	Esther K. Hissam

FILE NO: 20-54-L-18
 DRAWING NO: Ringnus 2H As-Drilled
 SCALE: 1" = 2000'
 MINIMUM DEGREE OF ACCURACY:
Submeter
 PROVEN SOURCE OF ELEVATION:
WVDOT, Harrisville, WV

STATE OF WEST VIRGINIA
 DEPARTMENT OF ENVIRONMENTAL PROTECTION
OIL AND GAS DIVISION

DATE: January 17 2024
 OPERATOR'S WELL NO. Ringnus 2H
 API WELL NO
47 - 95 - 02863
 STATE COUNTY PERMIT

WELL TYPE: OIL GAS LIQUID INJECTION WASTE DISPOSAL
 (IF GAS) PRODUCTION: STORAGE DEEP SHALLOW

LOCATION: ELEVATION: As-Built 1,007' WATERSHED: Outlet Middle Island Creek QUADRANGLE: Paden City
 DISTRICT: Lincoln COUNTY: Tyler
 SURFACE OWNER: David E. Bowyer ACREAGE: 85.765
 ROYALTY OWNER: Timothy L. VanCamp, Tamara M. Reynolds, BRC Appalachian Minerals I, LLC, J. Maurice Carlisle, LEASE NO: _____ ACREAGE: 59.50, 50, 65, 200

PROPOSED WORK: DRILL CONVERT DRILL DEEPER FRACTURE OR STIMULATE PLUG OFF OLD FORMATION
 PERFORATE NEW FORMATION OTHER PHYSICAL CHANGE IN WELL (SPECIFY) As-Drilled
 PLUG AND ABANDON CLEAN OUT AND REPLUG TARGET FORMATION: Marcellus Shale ESTIMATED DEPTH: 25,441' MD

WELL OPERATOR: Antero Resources Corporation DESIGNATED AGENT: Kevin Ellis
 ADDRESS: 1615 Wynkoop Street ADDRESS: 535 White Oaks Blvd.
Denver, CO 80202 Bridgeport, WV 26330