

10,397' to Top Hole

3,641' to Bottom Hole
TOP HOLE LATITUDE 39 - 35 - 00
BTM HOLE LATITUDE 39 - 37 - 30

9,922' to Bottom Hole
TOP HOLE LONGITUDE 80 - 52 - 30
BTM HOLE LONGITUDE 80 - 56 - 00

11,471' to Top Hole

Antero Resources
Well No. Ripple 1H
As-Drilled
Antero Resources Corporation

PAGE 1 of 2

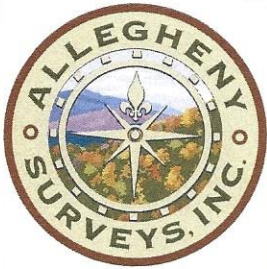

Top Hole Coordinates, As-drilled data, and information was provided by Antero Resources Corporation. Allegheny Surveys Inc. (ASI) is not certifying the data and information provided. ASI is not responsible for any errors or inaccuracies with the data and information that has been provided.

I, the undersigned, hereby certify that this plat is correct to the best of my knowledge and belief and shows all the information required by law and the rules issued and prescribed by the Department of Environmental Protection.

Bradley D. Miller
Bradley D. Miller, P.S. 2167

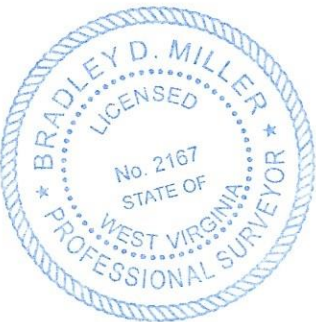

Note: 1 water well were found within 2000' of proposed well. No occupied dwellings or buildings 2,500 square feet or larger used to house or shelter dairy cattle or larger used to house or shelter poultry husbandry are located within 625' of the center of the well pad.

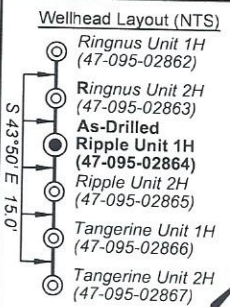
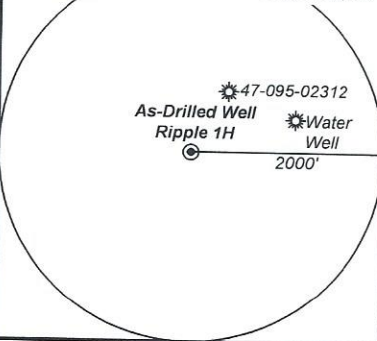

- Legend**
- Proposed gas well
 - Monument, as noted
 - Existing Well, as noted
 - Digitized Well, as noted
 - Creek or Drain
 - Road
 - Surface boundary (approx.)
 - Interior surface tracts (approx.)
 - County Line

Notes
West Virginia Coordinate System of 1927, North Zone based upon Differential GPS Measurements.
Well No. Ripple Unit 1H Top Hole coordinates are
N: 386,231.04' Latitude: 39°33'06.63"
E: 1,601,901.02' Longitude: 80°54'42.74"
Bottom Hole coordinates are
N: 403,033.25' Latitude: 39°35'51.94"
E: 1,597,172.04' Longitude: 80°55'46.52"
UTM Zone 17, NAD 1983
Top Hole Coordinates Bottom Hole Coordinates
N: 4,378,030.158m N: 4,383,124.977m
E: 507,586.286m E: 506,060.251m
Plat orientation and corner and well references are based upon the grid north meridian.
Well location references are based upon the magnetic meridian.

Ripple 1H As-Drilled POE Coordinates
West Virginia Coordinate System of 1927, North Zone
N: 385,940.97'
E: 1,602,717.09'
Latitude: 39°33'03.89"
Longitude: 80°54'32.27"
UTM Zone 17, NAD 1983
N: 4,377,945.944m
E: 507,836.378m



RECEIVED
Office Of Oil and Gas
FEB 14 2024
WV Department of Environmental Protection

	Bearing	Dist.
L1	N 64°56' E	979.8'
L2	S 48°48' E	2,554.3'
L3	S 66°58' W	1,089.1'
L4	N 79°52' W	1,233.7'

FILE NO: 15-54-L-23
DRAWING NO: Ripple 1H As-Drilled
SCALE: 1" = 2000'
MINIMUM DEGREE OF ACCURACY: Submeter
PROVEN SOURCE OF ELEVATION: WVDOT, Harrisville, WV

STATE OF WEST VIRGINIA
DEPARTMENT OF ENVIRONMENTAL PROTECTION
OIL AND GAS DIVISION

DATE: January 17 20 24
OPERATOR'S WELL NO. Ripple 1H
API WELL NO
47 - 95 - 02864
STATE COUNTY PERMIT

WELL TYPE: OIL GAS LIQUID INJECTION WASTE DISPOSAL
(IF GAS) PRODUCTION: STORAGE DEEP SHALLOW
LOCATION: ELEVATION: As-Built 1,007' WATERSHED: Outlet Middle Island Creek QUADRANGLE: Paden City
DISTRICT: Lincoln/Magnolia COUNTY: Tyler
SURFACE OWNER: David E. Bowyer
ROYALTY OWNER: Timothy L. VanCamp; Tamara M. Reynolds; BRC Appalachian Minerals I, LLC; J. Maurice Carlisle; LEASE NO: ACREAGE: 85.785
PROPOSED WORK: DRILL CONVERT DRILL DEEPER FRACTURE OR STIMULATE PLUG OFF OLD FORMATION
 PERFORATE NEW FORMATION OTHER PHYSICAL CHANGE IN WELL (SPECIFY) As-Drilled
 PLUG AND ABANDON CLEAN OUT AND REPLUG TARGET FORMATION: Marcellus Shale ESTIMATED DEPTH: 24,522' MD

WELL OPERATOR: Antero Resources Corporation DESIGNATED AGENT: Kevin Ellis
ADDRESS: 1615 Wynkoop Street ADDRESS: 535 White Oaks Blvd.
Denver, CO 80202 Bridgeport, WV 26330

06/28/2024

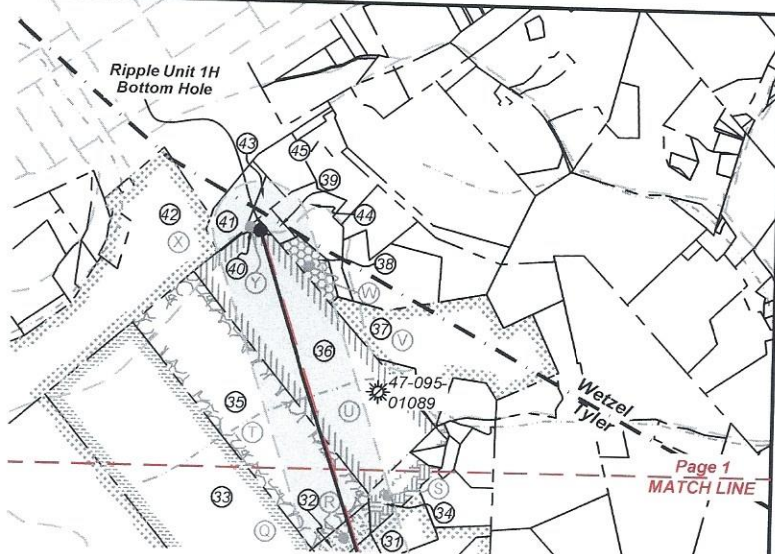
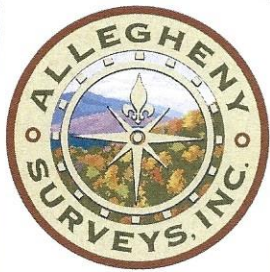

ID	TM-Par	Owner	Bk/Pg	Acres
1	9-19	David E. Bowyer	OR16/22	85.79
2	9-31.1	David E. Bowyer	OR16/22	38.04
3	9-21	Thomas K. Brotherton	23/310	64.00
4	9-20	Jason & Jessica Greathouse & Laken Curtis	OR59/513	7.38
5	9-17	Ethan A. & Marsha L. Riffle	323/649	90.04
6	9-18	Michael V. & Debra K. Smith	331/94	100.00
7	9-6	Larry G. & Joyce Ann Kaprich	375/254	12.11
8	9-6.1	Larry G. & Joyce Ann Kaprich	326/874	40.51
9	9-6.2	Larry G. & Joyce Ann Kaprich	375/254	9.47
10	9-7.3	Larry G. & Joyce Ann Kaprich	375/254	17.23
11	9-6.3	Donna E. Cecil	611/328	1.44
12	9-7	Ralph D. Thacker & Maurice J. Calisle Jr.	OR177/619	10.25
13	9-5.1	Carl L. & Donna M. Yoho	328/400	1.65
14	9-5	Chad & Janet L. Heintzman	330/527	64.35
15	9-7.1	Carl L. & Donna M. Yoho	320/456	117.00
16	5-17	Kenneth W. & Susan D. Paden	215/390	11.11
17	5-14	Kenneth W. & Susan D. Paden	215/390	55.22
18	5-15	Kenneth W. & Susan D. Paden	215/390	21.32
19	5-15.1	Joshua K. & Tomela Paden	355/821	1.09
20	5-20	Teri Jo Fiber	644/240	---
21	5-19	John P. & Susan Buck	337/634	159.21
22	5-8	Franklin & Nancy Broughman	338/292	33.17
23	5-1	Richard Lee & Linda Tuttle	362/43	88.00
24	5-34	Timothy J. & Miranda Haynes	OR151/407	74.50
25	5-35	Ethel & Timothy Brown	AR45/28	8.50
26	5-40	Jason Phillips	OR164/108	0.52
27	5-36	Brandon P. Mason and Katie E. Mason	396/464	56.86
28	5-39	Jason Phillips	OR164/108	16.29
29	5-41	Cheryl W. Cowen, et al	166/56	36.00
30	2-??	Shawn D. & Tara A. Cross	612/75	---
31	2-12	Shawn D. & Tara A. Cross	612/75	6.00
32	2-11	Misty D. Willey	555/467	4.00
33	1-8	Gary & Marsha L. Holmes	372/325	95.40
34	2-14	Shirley Billiter	215/573	7.13
35	2-1	Lloyd Wayne & Lottie Cross	188/383	50.00
36	2-2	Betty Lou Billiter Irrevocable Trust	375/476	65.00
37	2-4	Timothy J. & Tiffany D. Michael	575/824	37.50
38	2-3	Ernest & James Billiter	WB8/26	3.62
39	15-5	Betty Lou Billiter Irrevocable Trust	423/179	2.00
40	2-5	Betty Lou Billiter Irrevocable Trust	375/476	0.60
41	15-4	Linda K Patterson et al	AP97/843	7.17
42	15-12	Mike Ross Inc.	459/59	69.45
43	15-4.1	Lacey A Ryan, et al	AP94/179	1.83
44	15-6	Betty Lou Billiter Irrevocable Trust	423/179	9.00
45	15-1	Peter Testerman Jr & Marie Hass	439/425	9.00

RECEIVED
 Office Of Oil and Gas
 FEB 14 2024
 WV Department of
 Environmental Protection

Leases	
A	Timothy L. Vancamp
B	Tamara M. Reynolds
C	Bounty Minerals, LLC
D	BRC Appalachian Minerals I LLC
E	J. Maurice Carlisle
F	John T. Goosman, et ux
G	Janet L. Heintzman
H	Jane Ann Miller
I	John Paul Buck, et ux
J	John Paul Buck, et ux
K	Drilling Appalachian Corporation
L	Waco Oil & Gas Co Inc.
M	Richard Tuttle, et ux
N	Terry D. Wade, et ux
O	Brandon P. Mason, et ux
P	Heritage Resources - Marcellus Minerals, LLC
Q	Gary Holmes, et ux
R	Misty D. Willey
S	Shirley J. Billiter
T	Bounty Minerals, LLC
U	Lonnie L. & Bettie Lou Billiter
V	Michael Dail Stillwagner
W	OCTO Energy, LLC
X	Henry P. Snyder, et al
Y	Betty Lou Billiter Irrevocable Trust

FILE NO: 15-54-L-23
 DRAWING NO: Ripple 1H As-Drilled
 SCALE: 1" = 2000'
 MINIMUM DEGREE OF ACCURACY:
 Submeter
 PROVEN SOURCE OF ELEVATION:
 WVDOT, Harrisville, WV

STATE OF WEST VIRGINIA
 DEPARTMENT OF ENVIRONMENTAL PROTECTION
OIL AND GAS DIVISION

DATE: January 17 20 24
 OPERATOR'S WELL NO. Ripple 1H
 API WELL NO
 47 - 95 - 02864
 STATE COUNTY PERMIT

WELL TYPE: OIL GAS LIQUID INJECTION WASTE DISPOSAL
 (IF GAS) PRODUCTION: STORAGE DEEP SHALLOW

LOCATION: ELEVATION: As-Built 1,007' WATERSHED: Outlet Middle Island Creek QUADRANGLE: Paden City
 DISTRICT: Lincoln/Magnolia COUNTY: Tyler
 SURFACE OWNER: David E. Bowyer ACREAGE: 85.785
 ROYALTY OWNER: Timothy L. VanCamp, Tamara M. Reynolds, BRC Appalachian Minerals I, LLC, J. Maurice Carlisle, LEASE NO: _____ ACREAGE: 74.5, 58.293, 50, 65,
 PROPOSED WORK: DRILL CONVERT DRILL DEEPER FRACTURE OR STIMULATE PLUG OFF OLD FORMATION
 PERFORATE NEW FORMATION OTHER PHYSICAL CHANGE IN WELL (SPECIFY) As-Drilled
 PLUG AND ABANDON CLEAN OUT AND REPLUG TARGET FORMATION: Marcellus Shale ESTIMATED DEPTH: 24,522' MD

WELL OPERATOR: Antero Resources Corporation DESIGNATED AGENT: Kevin Ellis
 ADDRESS: 1615 Wynkoop Street ADDRESS: 535 White Oaks Blvd.
Denver, CO 80202 Bridgeport, WV 26330

06/28/2024