



west virginia department of environmental protection

Office of Oil and Gas
601 57th Street, S.E.
Charleston, WV 25304
(304) 926-0450
fax: (304) 926-0452

Harold D. Ward, Cabinet Secretary
www.dep.wv.gov

Wednesday, April 30, 2025
PERMIT MODIFICATION APPROVAL
Horizontal 6A / New Drill

ANTERO RESOURCES CORPORATION
1615 WYNKOOP STREET

DENVER, CO 80202

Re: Permit Modification Approval for Gorby Unit 1H
47-095-02909-00-00

Extended Lateral Length

ANTERO RESOURCES CORPORATION

The Office of Oil and Gas has reviewed the attached permit modification for the above referenced permit. The attached modification has been approved and well work may begin. Please be reminded that the oil and gas inspector is to be notified twenty-four (24) hours before permitted well work is commenced.

If there are any questions, please feel free to contact me at (304) 926- 0450.

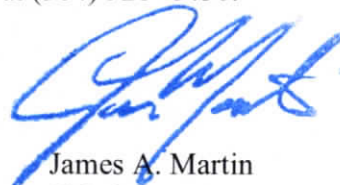

James A. Martin
Chief

Operator's Well Number: Gorby Unit 1H
Farm Name: Antero Resources Corporation
U.S. WELL NUMBER: 47-095-02909-00-00
Horizontal 6A New Drill
Date Modification Issued: 4/30/2025

Promoting a healthy environment.

05/02/2025

STATE OF WEST VIRGINIA
DEPARTMENT OF ENVIRONMENTAL PROTECTION, OFFICE OF OIL AND GAS
WELL WORK PERMIT APPLICATION

1) Well Operator: Antero Resources Corporation 494507062 095 - Tyler Lincoln Paden City
Operator ID County District Quadrangle

2) Operator's Well Number: Gorby Unit 1H MOD Well Pad Name: Mayfield Pad

3) Farm Name/Surface Owner: Antero Resources Corporation Public Road Access: Veterans Hwy

4) Elevation, current ground: 864' Elevation, proposed post-construction: _____

5) Well Type (a) Gas X Oil _____ Underground Storage _____
Other _____

(b) If Gas Shallow X Deep _____
Horizontal X _____

CH#4038287
\$7500.00

6) Existing Pad: Yes or No No

7) Proposed Target Formation(s), Depth(s), Anticipated Thickness and Expected Pressure(s):
Marcellus Shale: 7000' TVD, Anticipated Thickness- 55 feet, Associated Pressure- 2800#

8) Proposed Total Vertical Depth: 7000' TVD

9) Formation at Total Vertical Depth: Marcellus

10) Proposed Total Measured Depth: 24900' MD

11) Proposed Horizontal Leg Length: 15305.6'

12) Approximate Fresh Water Strata Depths: 384'

13) Method to Determine Fresh Water Depths: 47-095-00277

14) Approximate Saltwater Depths: 1736'

15) Approximate Coal Seam Depths: N/A

16) Approximate Depth to Possible Void (coal mine, karst, other): None Anticipated

17) Does Proposed well location contain coal seams
directly overlying or adjacent to an active mine? Yes _____ No X

(a) If Yes, provide Mine Info: Name: _____
Depth: _____
Seam: _____
Owner: _____

RECEIVED
Office of Oil and Gas

APR 23 2025

05/02/2025
4-17-25

WW-6B
(04/15)

API NO. 47- 095 - 02909
OPERATOR WELL NO. Gorby Unit 1H MOD
Well Pad Name: Mayfield Pad

18)

CASING AND TUBING PROGRAM

TYPE	Size (in)	New or Used	Grade	Weight per ft. (lb/ft)	FOOTAGE: For Drilling (ft)	INTERVALS: Left in Well (ft)	CEMENT: Fill-up (Cu. Ft.)/CTS
Conductor	20"	New	H-40	94#	100	100	CTS, 96 Cu. Ft.
Fresh Water	13-3/8"	New	J-55	54.5#	434	434	CTS, 452 Cu. Ft.
Coal	9-5/8"	New	J-55	36#	2500	2500	CTS, 1018 Cu. Ft.
Intermediate							
Production	5-1/2"	New	P-110	23#	24900	24900	5347 Cu. Ft.
Tubing	2-3/8"	New	N-80	4.7#			
Liners							

TYPE	Size (in)	Wellbore Diameter (in)	Wall Thickness (in)	Burst Pressure (psi)	Anticipated Max. Internal Pressure (psi)	Cement Type	Cement Yield (cu. ft./k)
Conductor	20"	24"	0.438"	1530	50	Class A/L	~1.18
Fresh Water	13-3/8"	17-1/2"	0.38"	2730	1000	Class A/L	~1.18
Coal	9-5/8"	12-1/4"	0.352"	3520	1500	Class A/L	~1.18
Intermediate							
Production	5-1/2"	8-3/4" & 8-1/2"	0.415"	12,630	2500	Lead-H/POZ & Tail - H	H/POZ-1.44 & H-1.8
Tubing	2-3/8"	4.778"	0.19"	11,200			
Liners							

PACKERS

Kind:	N/A			
Sizes:	N/A			
Depths Set:	N/A			

RECEIVED
Office of Oil and Gas

APR 23 2025

WV Department of
Environmental Protection

Page 2 of 3

05/02/2025

4/17/25

19) Describe proposed well work, including the drilling and plugging back of any pilot hole:

Drill, perforate, fracture a new shallow well and complete Marcellus Shale.

20) Describe fracturing/stimulating methods in detail, including anticipated max pressure and max rate:

Antero plans to pump Slickwater into the Marcellus Shale formation in order to ready the well for production. The fluid will be comprised of approximately 99 percent water and sand, with less than 1 percent special-purpose additives as shown in the attached "List of Anticipated Additives Used for Fracturing or Stimulating Well."

Anticipated Max Pressure - 9300 lbs
Anticipated Max Rate - 80 bpm

21) Total Area to be disturbed, including roads, stockpile area, pits, etc., (acres): 18.77 acres

22) Area to be disturbed for well pad only, less access road (acres): 7.98 acres

23) Describe centralizer placement for each casing string:

Conductor: no centralizers

Surface Casing: one centralizer 10' above the float shoe, one on the insert float collar and one every 4th joint spaced up the hole to surface.

Intermediate Casing: one centralizer above float joint, one centralizer 5' above float collar and one every 4th collar to surface.

Production Casing: one centralizer at shoe joint and one every 3 joints to top of cement in intermediate casing.

24) Describe all cement additives associated with each cement type:

Conductor: no additives, Class A/L cement.

Surface: Class A/L cement with 2-3% calcium chloride and 1/4 lb of flake

Intermediate: Class A/L cement with 1/4 lb of flake, 5 gallons of clay treat

Production: Lead cement- 50/50 Class H/Poz + 1.5% salt + 1% C-45 + 0.5% C-16a + 0.2% C-12 + 0.45% C-20 + 0.05% C-51

Production: Tail cement- Class H + 45 PPS Calcium Carbonate + 1.0% FL-160 + 0.2% ACGB-47 + 0.05% ACSA-51 + 0.2% ACR-20

25) Proposed borehole conditioning procedures:

Conductor: blowhole clean with air, run casing, 10 bbls fresh water.

Surface: blowhole clean with air, trip to conductor shoe, trip to bottom, blowhole clean with air, trip out, run casing, circulate pipe capacity + 40 bbls fresh water followed by 25 bbls bentonite mud, 10 bbls fresh water spacer.

Intermediate: blowhole clean with air, trip to surface casing shoe, trip to bottom, blowhole clean with air, trip out, run casing, circulate 40 bbls brine water followed by 10 bbls fresh water and 25 bbls bentonite mud, pump 10 bbls fresh water.

Production: circulate with 14 lb/gal NaCl mud, trip to middle of lateral, circulate, pump high viscosity sweep, trip to base of curve, pump high viscosity sweep, trip to top of curve, trip to bottom, circulate, pump high viscosity sweep, trip out, run casing, circulate 10 bbls fresh water, pump 48 bbls barite pill, pump 10 bbls fresh water followed by 48 bbls mud flush and 10 bbls water.

RECEIVED
Office of Oil and Gas

*Note: Attach additional sheets as needed.

APR 23 2025

Page 3 of 3

WV Department of
Environmental Protection

05/02/2025

4/17/25

LEGEND

- Proposed gas well
- ⊗ Existing Well, as noted
- ⊗ Digitized Well, as noted



The orientation of this survey is Grid North, and its coordinate base is the West Virginia Coordinate System of 1927, North Zone

RECEIVED
Office of Oil and Gas

APR 23 2025

WV Department of
Environmental Protection

Gorby 1H

500'
Buffer

47-095-0406



Bridgeport Office
Phone: (304) 848-5035
Fax: (304) 848-5037

172 Thompson Drive
Bridgeport, WV 26330

PARTY CHIEF: C. Lynch

DRAWN BY: C. Robinson

RESEARCH: J. Miller

PREPARED: March 19, 2025

SURVEYED: Dec. 2016

PROJECT NO: 153-54-L-23

FIELD CREW: C.L., K.M.

Sheet 1 of 1

DRAWING NO: Gorby 1H AOR



Scale: 1 inch = 2000 feet

05/02/2025

UWI (APINum)	Well Name	Well Number	Operator	Hist Oper	TD	Perforated Interval (shallowest, deepest)	Perforated Formation(s)	Producible Formation(s) not perf'd
47095004060000			UNKNOWN	UNKNOWN	3,224		Weir, Benson, Alexander	N/A

RECEIVED
Office of Oil and Gas

APR 23 2025

WV Department of
Environmental Protection

]

INFORMATION SUPPLIED UNDER WEST VIRGINIA CODE
Chapter 22, Article 6A, Section 5(a)(5)
IN LIEU OF FILING LEASE(S) AND OTHER CONTINUING CONTRACT(S)

Under the oath required to make the verification on page 1 of this Notice and Application, I depose and say that I am the person who signed the Notice and Application for the Applicant, and that –

- (1) the tract of land is the same tract described in this Application, partly or wholly depicted in the accompanying plat, and described in the Construction and Reclamation Plan;
- (2) the parties and recordation data (if recorded) for lease(s) or other continuing contract(s) by which the Applicant claims the right to extract, produce or market the oil or gas are as follows:

Grantor, lessor, etc.	Grantee, lessee, etc.	Royalty	Book/Page
<u>40: Dennis & Constance L. Swindall, Trustees for the Swindall Revocable Trust Lease</u>			
Dennis & Constance L. Swindall, Trustees for the Swindall Revocable Trust	Back Country Exploration LLC	1/8+	387/501
Back Country Exploration LLC	Triad Hunter, LLC	Conveyance	338/234
Triad Hunter, LLC	Antero Resources Corporation	Assignment	496/776
<u>39: David A. & Denise Gorby Lease</u>			
David A. & Denise Gorby	Antero Resources Corporation	1/8+	172/529
<u>38: Ridgetop Capital II, LP Lease</u>			
Ridgetop Capital II, LP	Antero Resources Corporation	1/8+	175/737
<u>37: Gregory V. Hart Lease</u>			
Gregory V. Hart	Antero Resources Corporation	1/8+	206/183
<u>36: Patsy D. Hoyt Lease</u>			
Patsy D. Hoyt	Antero Resources Corporation	1/8+	293A/679
<u>31: Edwin F. & Judy A. Probst, JTWROS Lease</u>			
Edwin F. & Judy A. Probst, JTWROS	Antero Resources Corporation	1/8+	286A/824
<u>35: Danny G. & Barbara A. Probst, JTWROS Lease</u>			
Danny G. & Barbara A. Probst, JTWROS	Antero Resources Corporation	1/8+	286A/140
<u>34: Jack R. & Linda J. Berisford Lease</u>			
Jack R. & Linda J. Berisford	Antero Resources Corporation	1/8+	367A/362
<u>33: Richard D. & Alicia L. Hissom, JTWROS Lease</u>			
Richard D. & Alicia L. Hissom, JTWROS	Antero Resources Corporation	1/8+	286A/828
<u>31: Edwin F. & Judy A. Probst, JTWROS Lease</u>			
Edwin F. & Judy A. Probst, JTWROS	Antero Resources Corporation	1/8+	286A/824
<u>32: Howard F. & Sandra Lee Estep, JTWROS Lease</u>			
Howard F. & Sandra Lee Estep, JTWROS	Antero Resources Corporation	1/8+	286A/137
<u>31: Edwin F. & Judy A. Probst, JTWROS Lease</u>			
Edwin F. & Judy A. Probst, JTWROS	Antero Resources Corporation	1/8+	286A/824
<u>29: Lawrence Grayson Walker III, et ux Lease</u>			
Lawrence Grayson Walker III, et ux	Antero Resources Corporation	1/8+	291A/646
<u>26: Walter Ray Jr. & Cathy Fouchs Lease</u>			
Walter Ray Jr. & Cathy Fouchs	Antero Resources Corporation	1/8+	291A/643

RECEIVED
Office of Oil and Gas

APR 23 2025

WV Department of
Environmental Protection

05/02/2025

INFORMATION SUPPLIED UNDER WEST VIRGINIA CODE
Chapter 22, Article 6A, Section 5(a)(5)
IN LIEU OF FILING LEASE(S) AND OTHER CONTINUING CONTRACT(S)

Under the oath required to make the verification on page 1 of this Notice and Application, I depose and say that I am the person who signed the Notice and Application for the Applicant, and that –

- (1) the tract of land is the same tract described in this Application, partly or wholly depicted in the accompanying plat, and described in the Construction and Reclamation Plan;
- (2) the parties and recordation data (if recorded) for lease(s) or other continuing contract(s) by which the Applicant claims the right to extract, produce or market the oil or gas are as follows:

Grantor, lessor, etc.	Grantee, lessee, etc.	Royalty	Book/Page
<u>27: Jeanne Konrad Lease</u> Jeanne Konrad	Antero Resources Corporation	1/8+	387A/143
<u>23: Larry D. Eddy Lease</u> Larry D. Eddy	Antero Resources Corporation	1/8+	374A/196
<u>19: Alexander Brast & Carol Thomas Revocable Trust Lease</u> Alexander Brast & Carol Thomas Revocable Trust	Antero Resources Corporation	1/8+	375A/227
<u>24: Alexander Brast & Carol Thomas Revocable Trust Lease</u> Alexander Brast & Carol Thomas Revocable Trust	Antero Resources Corporation	1/8+	375A/227
<u>19: Alexander Brast & Carol Thomas Revocable Trust Lease</u> Alexander Brast & Carol Thomas Revocable Trust	Antero Resources Corporation	1/8+	375A/227
<u>15: Mineral Acquisition Company I, LP Lease</u> Mineral Acquisition Company I, LP	Antero Resources Corporation	1/8+	380A/395
<u>14: Larry R. & Linda S. Sweeney Lease</u> Larry R. & Linda S. Sweeney TH Exploration, LLC	TH Exploration, LLC Antero Resources Corporation	1/8 Assignment	328A/115 Pooled Tract
<u>10: Carol A. Whitmer Lease</u> Carol A. Whitmer	Antero Resources Corporation	1/8+	398A/14
<u>9: The West Virginia Department of Transportation Lease</u> The West Virginia Department of Transportation	Antero Resources Corporation	1/8+	407A/317
<u>4: Jessie Thompson Lease</u> Jessie Thompson	Antero Resources Corporation	1/8+	390A/435

RECEIVED
Office of Oil and Gas

APR 23 2025

WV Department of
Environmental Protection

*Partial Assignments to Antero Resources Corporation include 100% rights to extract, produce and market the oil and gas from the Marcellus and any other formations completed with this well.

***Cotenancy Utilization** - Antero is utilizing the Co-tenancy Modernization and Majority Protection Act to proceed with development of certain royalty owners' interests in this tract.

****Pooling/Unitization** - Antero has filed a horizontal well unitization application with the West Virginia Oil and Gas Conservation Commission that seeks to pool certain owners in this tract

05/02/2025

**INFORMATION SUPPLIED UNDER WEST VIRGINIA CODE
Chapter 22, Article 6A, Section 5(a)(5)
IN LIEU OF FILING LEASE(S) AND OTHER CONTINUING CONTRACT(S)**

Under the oath required to make the verification on page 1 of this Notice and Application, I depose and say that I am the person who signed the Notice and Application for the Applicant, and that –

- (1) the tract of land is the same tract described in this Application, partly or wholly depicted in the accompanying plat, and described in the Construction and Reclamation Plan;
- (2) the parties and recordation data (if recorded) for lease(s) or other continuing contract(s) by which the Applicant claims the right to extract, produce or market the oil or gas are as follows:

Lease Name or Number	Grantor, Lessor, etc.	Grantee, Lessee, etc.	Royalty	Book/Page
<u>1: WV Department of Natural Resources Lease</u>	<u>WV Department of Natural Resources</u>	<u>Antero Resources Corporation</u>	<u>1/8+</u>	<u>Pooled Tract</u>

*Cotenancy Utilization - Antero is utilizing the Co-tenancy Modernization and Majority Protection Act to proceed with development of certain royalty owners' interests in this tract.

**Pooling/Unitization - Antero has filed a horizontal well unitization application with the West Virginia Oil and Gas Conservation Commission that seeks to pool certain owners in this tract

**Acknowledgement of Possible Permitting/Approval
In Addition to the Office of Oil and Gas**

The permit applicant for the proposed well work addressed in this application hereby acknowledges the possibility of the need for permits and/or approvals from local, state, or federal entities in addition to the DEP, Office of Oil and Gas, including but not limited to the following:

- WV Division of Water and Waste Management
- WV Division of Natural Resources WV Division of Highways
- U.S. Army Corps of Engineers
- U.S. Fish and Wildlife Service
- County Floodplain Coordinator

The applicant further acknowledges that any Office of Oil and Gas permit in no way overrides, replaces, or nullifies the need for other permits/approvals that may be necessary and further affirms that all needed permits/approvals should be acquired from the appropriate authority before the affected activity is initiated.

Well Operator: Antero Resources Corporation

By: Max Green

Its: Vice President of Land

RECEIVED
Office of Oil and Gas

Page 1 of 1

APR 23 2025

WV Department of
Environmental Protection

05/02/2025

Antero Resources
Well No. Gorby 1H
BHL_MOD
Antero Resources Corporation

Page 1 of 4

Well Location References
Not to Scale

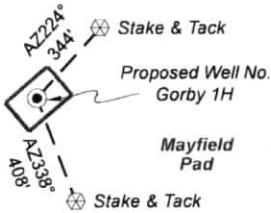

SEAL

I, the undersigned, hereby certify that this plat is correct to the best of my knowledge and belief and shows all the information required by law and the rules issued and prescribed by the Department of Environmental Protection.

Bradley D. Miller, P.S. 2167

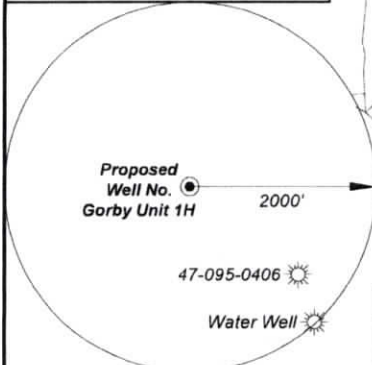

Note: 1 water well were found within 2000' of proposed well. No occupied dwellings or buildings 2,500 square feet or larger used to house or shelter dairy cattle or poultry husbandry are located within 625' of the center of the well pad.

Tag	Bearing	Dist.	Monument
L1	N 26°35' W	2,030.6'	Center of bridge
L2	N 50°14' W	1,459.4'	47-095-00406
L3	S 63°54' W	589.6'	Roof bolt on creek bank
L4	S 25°00' E	1,958.1'	5/8" Rebar
L5	S 64°08' E	1,208.6'	Point of Entry (POE)

FILE NO: 153-54-L-23

DRAWING NO: Gorby 1H Well Plat

SCALE: 1" = 2000'

MINIMUM DEGREE OF ACCURACY:
Submeter

PROVEN SOURCE OF ELEVATION:
WVDOT, Harrisville, WV

STATE OF WEST VIRGINIA
DEPARTMENT OF ENVIRONMENTAL PROTECTION
OIL AND GAS DIVISION

DATE: March 20 20 25

OPERATOR'S WELL NO. Gorby 1H

API WELL NO

47 - 095 - 02909
STATE COUNTY PERMIT

WELL TYPE: ☐ OIL ☒ GAS ☐ LIQUID INJECTION ☐ WASTE DISPOSAL
(IF GAS) PRODUCTION: ☐ STORAGE ☐ DEEP ☒ SHALLOW

LOCATION: ELEVATION: As-Built: 864'

WATERSHED: Outlet Middle Island Creek

QUADRANGLE: Paden City

DISTRICT: Lincoln / Magnolia

COUNTY: Tyler / Wetzel

SURFACE OWNER: Antero Resources Corp.

ACREAGE 05/02/2025

ROYALTY OWNER: Dennis Swindall & Constance Swindall Trustees for the Swindall Revocable Trust

LEASE NO: ACREAGE: 208

PROPOSED WORK: ☐ DRILL ☐ CONVERT ☒ DRILL DEEPER ☒ FRACTURE OR STIMULATE ☐ PLUG OFF OLD FORMATION
☐ PERFORATE NEW FORMATION ☒ OTHER PHYSICAL CHANGE IN WELL (SPECIFY) BHL-MOD 7,000' TVD

☐ PLUG AND ABANDON ☐ CLEAN OUT AND REPLUG TARGET FORMATION: Marcellus Shale ESTIMATED DEPTH: 24,900' MD

WELL OPERATOR: Antero Resources Corporation

DESIGNATED AGENT: Conrad Baston

ADDRESS: 1615 Wynkoop Street
Denver, CO 80202

ADDRESS: 535 White Oaks Blvd.
Bridgeport, WV 26330

7,370' to Top Hole
577' to Bottom Hole
TOP LATITUDE 39 - 35 - 00
BTM LATITUDE 39 - 37 - 30
TOP HOLE LONGITUDE 80 - 52 - 30
BTM HOLE LONGITUDE 80 - 55 - 00
Bottom Hole 7.5' Spot
2,449' to Bottom Hole
824' to Top Hole



Notes
West Virginia Coordinate System
of 1927, North Zone
based upon Differential GPS Measurements.
Well No. Gorby Unit 1H Top Hole coordinates are
N: 396,829.41' Latitude: 39°34'51.86"
E: 1,605,091.07' Longitude: 80°54'04.13"
Bottom Hole coordinates are
N: 410,456.00' Latitude: 39°37'05.79"
E: 1,600,353.95' Longitude: 80°55'07.38"
UTM Zone 17, NAD 1983
Top Hole Coordinates Bottom Hole Coordinates
N: 4,381,275.279m N: 4,385,402.582m
E: 508,504.336m E: 506,991.946m
Plat orientation and corner and well references
are based upon the grid north meridian.
Well location references are based upon the
magnetic meridian.

Notes:
Well No. Gorby Unit 1H
UTM Zone 17, NAD 1927
N: 14,373,519.61'
E: 1,668,269.64'
Point of Entry Coordinates
N: 14,373,010.70'
E: 1,669,365.47'
Bottom Hole Coordinates
N: 14,387,060.60'
E: 1,663,307.37'

Wellhead Layout (NTS)

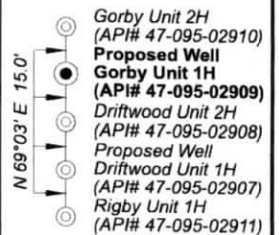

Page 4 of 4

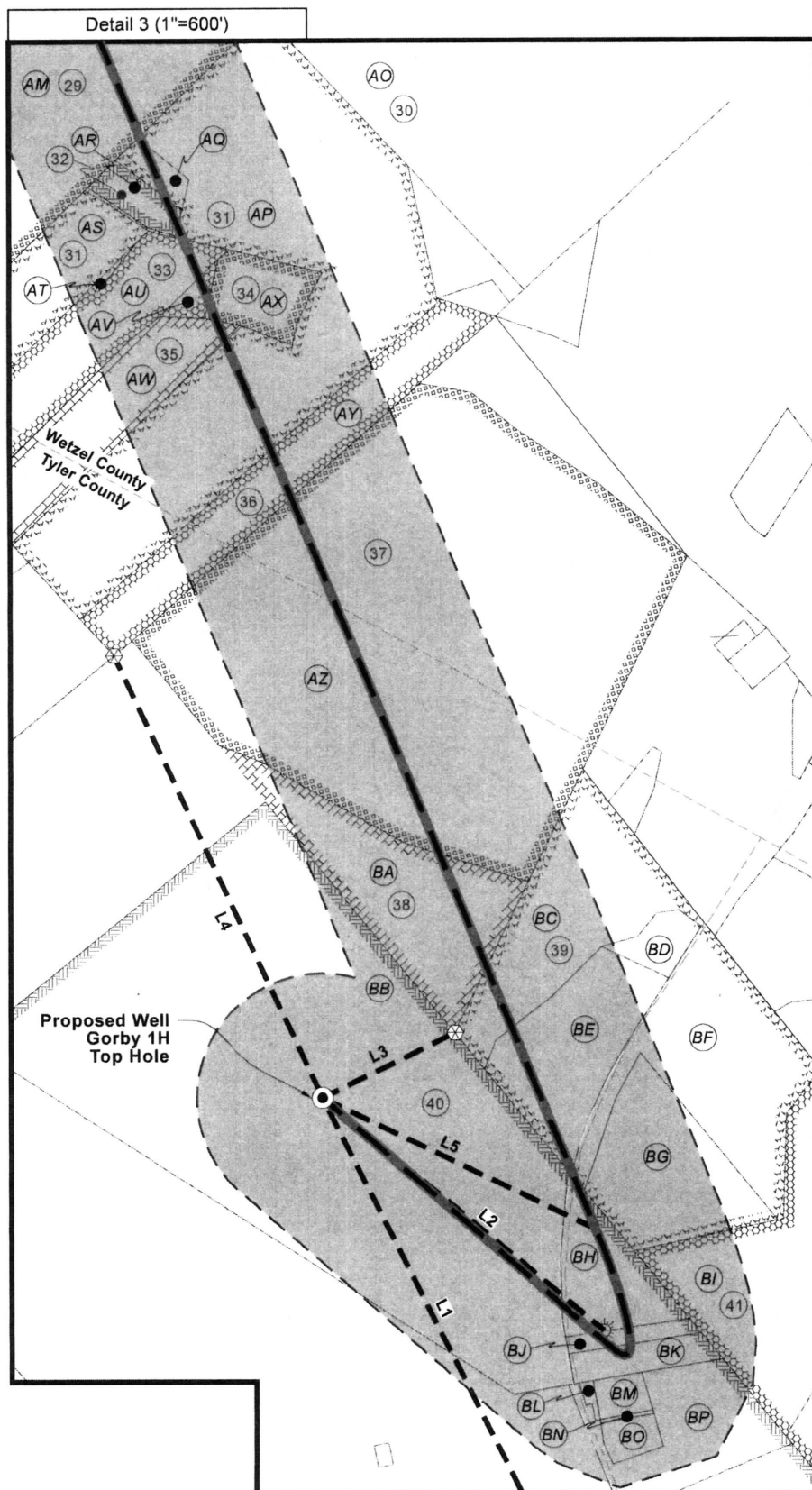

STATE OF WEST VIRGINIA
DEPARTMENT OF ENVIRONMENTAL PROTECTION
OIL AND GAS DIVISION

ADDRESS: 535 White Oaks Blvd.
Bridgeport, WV 26330

05/02/2025

Antero Resources
Well No. Gorby 1H
BHL_MOD
Antero Resources Corporation

Page 3 of 4

ID	Lease
1	WV Department of Natural Resources
2	Phillip W. Wiley
3	CSX Transportation, Inc.
4	Jessie Thompson
5	Myrtle Lorraine Wilson
6	Jessee A. Scarborough
7	Linda K. Warnock
8	Romey R. Greathouse, et ux
9	The West Virginia Department of Transportation
10	Carol A. Whitmer
11	Patterson, LLC
14	Larry R. & Linda S. Sweeney
15	Mineral Acquisition Company, I, LP
19	Alexander Brast & Carol Thomas Revocable Trust
21	Doris J. Koerber
23	Larry D. Eddy
24	Alexander Brast & Carol Thomas Revocable Trust
26	Walter Ray Jr. & Cathy Fouchs
27	Jeanne Konrad
28	Paul S. Cunningham
29	Lawrence Grayson Walker III, et ux
30	Margaret A. Kline
31	Edwin F. & Judy A. Probst, JTWROS
32	Howard F. & Sandra Lee Estep, JTWROS
33	Richard D. & Alicia L. Hissom, JTWROS
34	Jack R. & Linda J. Berisford
35	Danny G. & Barbara A. Probst, JTWROS
36	Patsy D. Hoyt
37	Gregory V. Hart
38	Ridgetop Capital II, LP
39	David A. & Denise Gorby
40	Dennis & Constance L. Swindall, Trustees for the Swindall Revocable Trust
41	Sherry Lynn Chehren



FILE NO: 153-54-L-23

DRAWING NO: Gorby 1H Well Plat

SCALE: 1" = 2000'

MINIMUM DEGREE OF ACCURACY:
Submeter

PROVEN SOURCE OF ELEVATION:
WVDOT, Harrisville, WV

STATE OF WEST VIRGINIA
DEPARTMENT OF ENVIRONMENTAL PROTECTION
OIL AND GAS DIVISION

DATE: March 20 20 25

OPERATOR'S WELL NO. Gorby 1H

API WELL NO

47 095 02909
STATE COUNTY PERMIT

WELL TYPE: ☐ OIL ☒ GAS ☐ LIQUID INJECTION ☐ WASTE DISPOSAL
(IF GAS) PRODUCTION: ☐ STORAGE ☐ DEEP ☒ SHALLOW

LOCATION: ELEVATION: As-Built: 864'

WATERSHED: Outlet Middle Island Creek

QUADRANGLE: Paden City

DISTRICT: Lincoln / Magnolia

COUNTY: Tyler / Wetzel

SURFACE OWNER: Antero Resources Corp.

ACREAGE: 208

ROYALTY OWNER: Dennis Swindall & Constance Swindall Trustees for the Swindall Revocable Trust

LEASE NO: ACREAGE: 208

PROPOSED WORK: ☐ DRILL ☐ CONVERT ☒ DRILL DEEPER ☒ FRACTURE OR STIMULATE ☐ PLUG OFF OLD FORMATION
☐ PERFORATE NEW FORMATION ☒ OTHER PHYSICAL CHANGE IN WELL (SPECIFY) BHL-MOD 7,000' TVD

☐ PLUG AND ABANDON ☐ CLEAN OUT AND REPLUG TARGET FORMATION: Marcellus Shale ESTIMATED DEPTH: 24,900' MD

WELL OPERATOR: Antero Resources Corporation

DESIGNATED AGENT: Conrad Baston

ADDRESS: 1615 Wynkoop Street
Denver, CO 80202

ADDRESS: 535 White Oaks Blvd.
Bridgeport, WV 26330

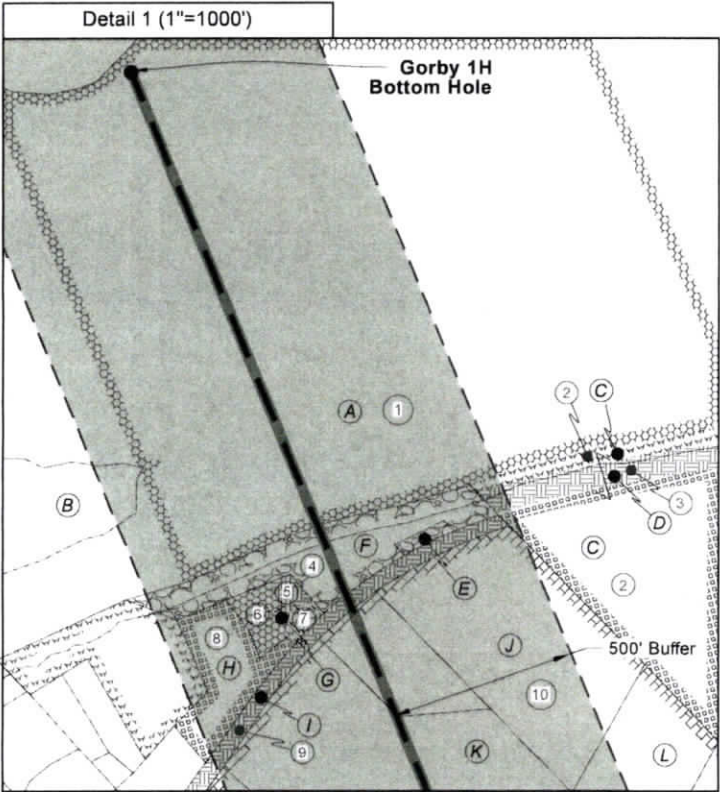

No.	TM / Par	Owner	Bk / Pg	Ac.
A	x / xx	xx	xx / xx	xx
B	10 / 1.1	United States of America	256 / 227	5.13
C	11 / 7	Phillip Wiley	365 / 313	44.38
D	x / xx	xx	xx / xx	xx
E	11 / 4	Jessie Thompson	409 / 24	0.14
F	11 / 3	Jessie Thompson	409 / 24	2.10
G	11 / 2	Stender Cemetery	xx / xx	1.00
H	10 / 1.1	Romey R. & Cathy S. Grethouse	417 / 67	1.75
I	x / xx	xx	xx / xx	xx
J	11 / 6	Gregory M. & Courtney L. Hohman	426 / 563	6.00
K	11 / 5	Gregory M. & Courtney L. Hohman	426 / 563	3.50
L	11 / 45	Gregory M. & Courtney L. Hohman	426 / 563	18.01
M	11 / 45.1	Bonita J. Smith	377 / 573	0.61
N	11 / 50	Anthony L. Littleton	463 / 56	1.65
O	11 / 50.1	Anthony L. Littleton	463 / 56	3.53
P	11 / 52	Gregory M. Hohman	426 / 563	2.00
Q	11 / 45	Gregory M. & Courtney L. Hohman	426 / 563	18.01
R	11 / 63.1	Joshua T. Neff	411 / 660	1.47
S	11 / 51	Anthony L. Littleton	463 / 56	6.50
T	11 / 62	TW Enterprises, LLC	465 / 115	20.11
U	11 / 106	Larry & Linda Sweeney	402 / 372	17.17
V	11 / 67	Carl L. Sweeney, et al	452 / 681	27.50
W	11 / 106	Larry & Linda Sweeney	402 / 372	17.17
X	11 / 70.1	Wanda Ferrebee	411 / 608	5.18
Y	11 / 69	Larry & Linda Sweeney	404 / 87	12.10
Z	11 / 84.4	Carl L. Sweeney, et al	388 / 312	30.73
AA	11 / 84.3	Carl Sweeney	388 / 312	2.74
AB	11 / 84	Carl L. Sweeney	402 / 12	1.50
AC	11 / 84.2	Carl Sweeney	362 / 476	0.95
AD	11 / 86.1	Charles A. & Patty K. Loy	303 / 569	2.58
AE	11 / 86	Brandon Cross	468 / 464	0.42
AF	11 / 85	Duane Mark Cross	406 / 283	2.70
AG	11 / 88	Evelyn M. Cross	242 / 252	31.09
AH	16 / 4	Evelyn M. Cross	242 / 252	12.26
AI	16 / 5.2	Donald W. & Karen S. Fouchs	454 / 73	4.89
AJ	16 / 5.1	Walter Ray Fouchs	330 / 352	32.61
AK	16 / 23.2	Joseph Jackson Weaver & Rebecca Lynn Weaver	501 / 791	14.42
AL	16 / 23	Walter Ray Fouchs Jr. & Cathy Fouchs	330 / 352	5.08
AM	16 / 25	Billy K. & Carolyn S. Goddard	502 / 370	32.57
AN	16 / 5	Walter Ray Fouchs Jr. & Cathy Fouchs	330 / 352	33.25
AO	16 / 33	Donna L. Kline, et al	453 / 174	103.32
AP	16 / 49	Edwin F. & Judy A. Probst L/E Pearl G. Probst	394 / 570	33.95
AQ	16 / 49.9	Howard F. & Sandra L. Estep	383 / 523	1.16
AR	16 / 32	Howard F. & Sandra L. Estep	383 / 523	2.00
AS	16 / 49.1	Edwin F. & Judy A. Probst	318 / 156	8.44
AT	16 / 49.6	Edwin F. & Judy A. Probst	393 / 564	0.10
AU	16 / 49.4	Richard D. & Alicia L. Hissom	387 / 644	7.89
AV	16 / 49.7	Richard D. & Alicia L. Hissom	409 / 331	0.49
AW	16 / 49.2	Danny G. & Barbra Probst	332 / 273	6.76
AX	16 / 49.8	Jack Randy Berisfod	411 / 640	2.51
AY	16 / 49.3	Patsy D. Hoyt	339 / 316	8.86
AZ	5 / 66	Gregory V. Hart	WB86 / 400	59.78
BA	5 / 64	Wesley Shriver	490 / 758	80.38
BB	5 / 63.1	Antero Resources Corp.	OR299 / 308	60.96
BC	5 / 64	Wesley Shriver	490 / 758	80.38
BD	5 / 64.1	Shawn M. Meckley	363 / 215	1.19
BE	5 / 64.2	Randy & Kimberly Dawson	OR210 / 575	6.90
BF	5 / 64	Wesley Shriver	490 / 758	80.38
BG	2 / 2	John William & Rhonda L. Burton	380 / 341	7.20
BH	2 / 3	Garnett C. Myers	WB20 / 436	0.75
BI	2 / 1	Donald E. Virden Jr.	421 / 281	30.84
BJ	2 / 3.2	Dawn Marie & Howard F. Myers Jr.	499 / 363	0.80
BK	2 / 3.1	Dawn Marie & Howard F. Myers Jr.	328 / 701	1.58
BL	5 / 63.3	Brenda K. & James David Kimble	219 / 186	0.13
BM	10 / 1.1	Brenda K. & James David Kimble	219 / 186	0.73
BN	10 / 1.1	Larry H. Kimble, Larry Daniel Kimble	364 / 161	0.79
BO	10 / 1.1	David J. Kimble	WB36 / 539	0.07
BP	10 / 1.1	Larry H. Kimble	WB36 / 539	5.87

FILE NO: 153-54-L-23
DRAWING NO: Gorby 1H Well Plat
SCALE: 1" = 2000'
MINIMUM DEGREE OF ACCURACY:
Submeter
PROVEN SOURCE OF ELEVATION:
WVDOT, Harrisville, WV

STATE OF WEST VIRGINIA
DEPARTMENT OF ENVIRONMENTAL PROTECTION
OIL AND GAS DIVISION

DATE: March 20 20 25
OPERATOR'S WELL NO: Gorby 1H
API WELL NO
47 - 095 - 02909
STATE COUNTY PERMIT

WELL TYPE: ☐ OIL ☒ GAS ☐ LIQUID INJECTION ☐ WASTE DISPOSAL
(IF GAS) PRODUCTION: ☐ STORAGE ☐ DEEP ☒ SHALLOW

LOCATION: ELEVATION: As-Built: 864' WATERSHED: Outlet Middle Island Creek QUADRANGLE: Paden City
DISTRICT: Lincoln / Magnolia COUNTY: Tyler / Wetzel
SURFACE OWNER: Antero Resources Corp. ACREAGE: 05/02/2025
ROYALTY OWNER: Dennis Swindall & Constance Swindall Trustees for the Swindall Revocable Trust LEASE NO: ACREAGE: 208
PROPOSED WORK: ☐ DRILL ☐ CONVERT ☒ DRILL DEEPER ☒ FRACTURE OR STIMULATE ☐ PLUG OFF OLD FORMATION
☐ PERFORATE NEW FORMATION ☒ OTHER PHYSICAL CHANGE IN WELL (SPECIFY) BHL-MOD 7,000' TVD
☐ PLUG AND ABANDON ☐ CLEAN OUT AND REPLUG TARGET FORMATION: Marcellus Shale ESTIMATED DEPTH: 24,900' MD

WELL OPERATOR: Antero Resources Corporation DESIGNATED AGENT: Conrad Baston
ADDRESS: 1615 Wynkoop Street ADDRESS: 535 White Oaks Blvd.
Denver, CO 80202 Bridgeport, WV 26330