



---

west virginia department of environmental protection

---

Office of Oil and Gas  
601 57<sup>th</sup> Street, S.E.  
Charleston, WV 25304  
(304) 926-0450  
fax: (304) 926-0452

Harold D. Ward, Cabinet Secretary  
[www.dep.wv.gov](http://www.dep.wv.gov)

Wednesday, April 30, 2025  
PERMIT MODIFICATION APPROVAL  
Horizontal 6A / New Drill

ANTERO RESOURCES CORPORATION  
1615 WYNKOOP STREET

DENVER, CO 80202

Re: Permit Modification Approval for Gorby Unit 2H  
47-095-02910-00-00

**Extended Lateral Length**

ANTERO RESOURCES CORPORATION

The Office of Oil and Gas has reviewed the attached permit modification for the above referenced permit. The attached modification has been approved and well work may begin. Please be reminded that the oil and gas inspector is to be notified twenty-four (24) hours before permitted well work is commenced.

If there are any questions, please feel free to contact me at (304) 926- 0450.

A blue ink signature of James A. Martin, written in a cursive style.

James A. Martin  
Chief

Operator's Well Number: Gorby Unit 2H  
Farm Name: Antero Resources Corporation  
U.S. WELL NUMBER: 47-095-02910-00-00  
Horizontal 6A New Drill  
Date Modification Issued: 4/30/2025

Promoting a healthy environment.

05/02/2025

STATE OF WEST VIRGINIA  
DEPARTMENT OF ENVIRONMENTAL PROTECTION, OFFICE OF OIL AND GAS  
WELL WORK PERMIT APPLICATION

1) Well Operator: Antero Resources Corporation 494507062 095 - Tyler Lincoln Paden City  
Operator ID County District Quadrangle

2) Operator's Well Number: Gorby Unit 2H MOD Well Pad Name: Mayfield Pad

3) Farm Name/Surface Owner: Antero Resources Corporation Public Road Access: Veterans Hwy

4) Elevation, current ground: 864' Elevation, proposed post-construction: \_\_\_\_\_

5) Well Type (a) Gas X Oil \_\_\_\_\_ Underground Storage \_\_\_\_\_

Other \_\_\_\_\_

(b) If Gas Shallow X Deep \_\_\_\_\_

Horizontal X \_\_\_\_\_

6) Existing Pad: Yes or No No

7) Proposed Target Formation(s), Depth(s), Anticipated Thickness and Expected Pressure(s):  
Marcellus Shale: 7000' TVD, Anticipated Thickness- 55 feet, Associated Pressure- 2800#

8) Proposed Total Vertical Depth: 7000' TVD

9) Formation at Total Vertical Depth: Marcellus

10) Proposed Total Measured Depth: 24900' MD

11) Proposed Horizontal Leg Length: 14807.2'

12) Approximate Fresh Water Strata Depths: 384'

13) Method to Determine Fresh Water Depths: 47-095-00277

14) Approximate Saltwater Depths: 1736'

15) Approximate Coal Seam Depths: N/A

16) Approximate Depth to Possible Void (coal mine, karst, other): None Anticipated

17) Does Proposed well location contain coal seams directly overlying or adjacent to an active mine? Yes \_\_\_\_\_ No X

(a) If Yes, provide Mine Info: Name: \_\_\_\_\_  
Depth: \_\_\_\_\_  
Seam: \_\_\_\_\_  
Owner: \_\_\_\_\_

RECEIVED  
Office of Oil and Gas

APR 23 2025

WV Department of  
Environmental Protection

WW-6B  
(04/15)

API NO. 47- 095 - 02910  
OPERATOR WELL NO. Gorby Unit 2H MOD  
Well Pad Name: Mayfield Pad

18)

**CASING AND TUBING PROGRAM**

TYPE	Size (in)	New or Used	Grade	Weight per ft. (lb/ft)	FOOTAGE: For Drilling (ft)	INTERVALS: Left in Well (ft)	CEMENT: Fill-up (Cu. Ft.)/CTS
Conductor	20"	New	H-40	94#	100	100	CTS, 96 Cu. Ft.
Fresh Water	13-3/8"	New	J-55	54.5#	434	434	CTS, 452 Cu. Ft.
Coal	9-5/8"	New	J-55	36#	2500	2500	CTS, 1018 Cu. Ft.
Intermediate							
Production	5-1/2"	New	P-110	23#	24900	24900	5347 Cu. Ft
Tubing	2-3/8"	New	N-80	4.7#			
Liners							

TYPE	Size (in)	Wellbore Diameter (in)	Wall Thickness (in)	Burst Pressure (psi)	Anticipated Max. Internal Pressure (psi)	Cement Type	Cement Yield (cu. ft./k)
Conductor	20"	24"	0.438"	1530	50	Class A/L	~1.18
Fresh Water	13-3/8"	17-1/2"	0.38"	2730	1000	Class A/L	~1.18
Coal	9-5/8"	12-1/4"	0.352"	3520	1500	Class A/L	~1.18
Intermediate							
Production	5-1/2"	8-3/4" & 8-1/2"	0.415"	12,630	2500	Land-H/POZ & T&E - H	H/POZ-1.44 & H-1.8
Tubing	2-3/8"	4.778"	0.19"	11,200			
Liners							

**PACKERS**

Kind:	N/A			
Sizes:	N/A			
Depths Set:	N/A			

RECEIVED  
Office of Oil and Gas

APR 23 2025

WV Department of  
Environmental Protection

05/02/2025

SMW  
4/17/25

19) Describe proposed well work, including the drilling and plugging back of any pilot hole:

Drill, perforate, fracture a new shallow well and complete Marcellus Shale.

20) Describe fracturing/stimulating methods in detail, including anticipated max pressure and max rate:

Antero plans to pump Slickwater into the Marcellus Shale formation in order to ready the well for production. The fluid will be comprised of approximately 99 percent water and sand, with less than 1 percent special-purpose additives as shown in the attached "List of Anticipated Additives Used for Fracturing or Stimulating Well."

Anticipated Max Pressure - 9300 lbs

Anticipated Max Rate - 80 bpm

21) Total Area to be disturbed, including roads, stockpile area, pits, etc., (acres): 18.77 acres

22) Area to be disturbed for well pad only, less access road (acres): 7.98 acres

23) Describe centralizer placement for each casing string:

Conductor: no centralizers

Surface Casing: one centralizer 10' above the float shoe, one on the insert float collar and one every 4th joint spaced up the hole to surface.

Intermediate Casing: one centralizer above float joint, one centralizer 5' above float collar and one every 4th collar to surface.

Production Casing: one centralizer at shoe joint and one every 3 joints to top of cement in intermediate casing.

24) Describe all cement additives associated with each cement type:

Conductor: no additives, Class A/L cement.

Surface: Class A/L cement with 2-3% calcium chloride and 1/4 lb of flake

Intermediate: Class A/L cement with 1/4 lb of flake, 5 gallons of clay treat

Production: Lead cement- 50/50 Class H/Poz + 1.5% salt + 1% C-45 + 0.5% C-16a + 0.2% C-12 + 0.45% C-20 + 0.05% C-51

Production: Tail cement- Class H + 45 PPS Calcium Carbonate + 1.0% FL-160 + 0.2% ACGB-47 + 0.05% ACSA-51 + 0.2% ACR-20

25) Proposed borehole conditioning procedures:

Conductor: blowhole clean with air, run casing, 10 bbls fresh water.

Surface: blowhole clean with air, trip to conductor shoe, trip to bottom, blowhole clean with air, trip out, run casing, circulate pipe capacity + 40 bbls fresh water followed by 25 bbls bentonite mud, 10 bbls fresh water spacer.

Intermediate: blowhole clean with air, trip to surface casing shoe, trip to bottom, blowhole clean with air, trip out, run casing, circulate 40 bbls brine water followed by 10 bbls fresh water and 25 bbls bentonite mud, pump 10 bbls fresh water.

Production: circulate with 14 lb/gal NaCl mud, trip to middle of lateral, circulate, pump high viscosity sweep, trip to base of curve, pump high viscosity sweep, trip to top of curve, trip to bottom, circulate, pump high viscosity sweep, trip out, run casing, circulate 10 bbls fresh water, pump 48 bbls barite pill, pump 10 bbls fresh water followed by 48 bbls mud flush and 10 bbls water.

RECEIVED  
Office of Oil and Gas

\*Note: Attach additional sheets as needed.

APR 23 2025



# LEGEND

- Proposed gas well
- ⊗ Existing Well, as noted
- ⊗ Digitized Well, as noted



The orientation of this survey is Grid North, and its coordinate base is the West Virginia Coordinate System of 1927, North Zone

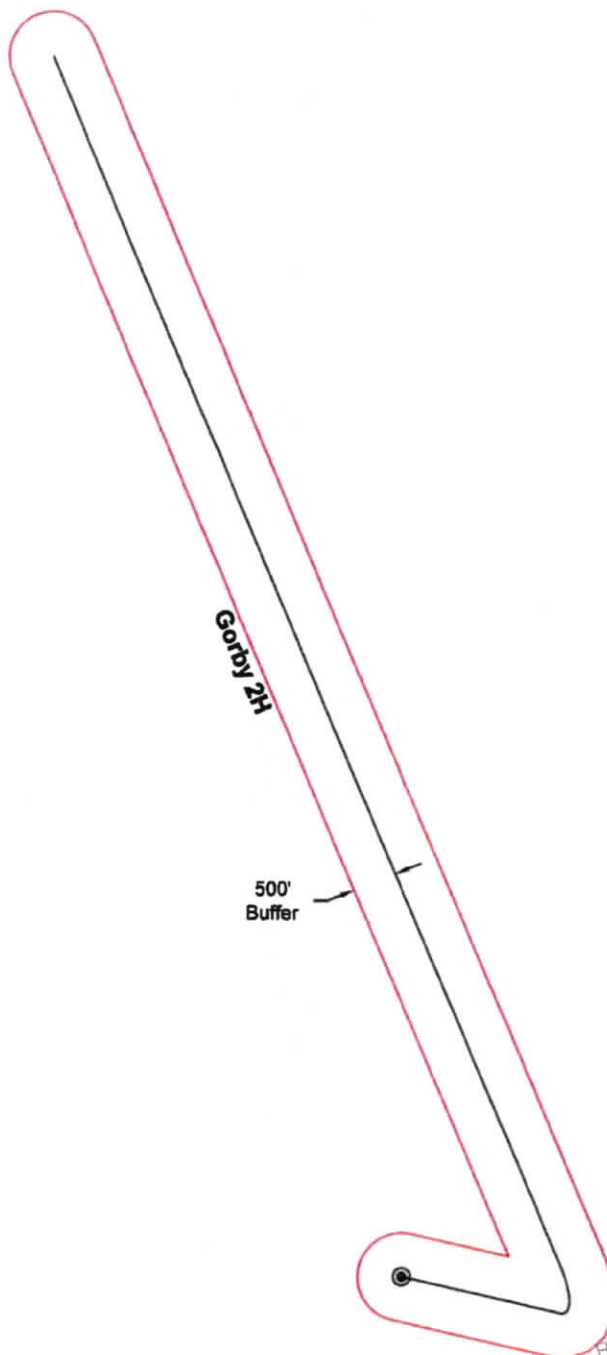

RECEIVED  
Office of Oil and Gas  
APR 23 2025  
WV Department of  
Environmental Protection



Bridgeport Office  
Phone: (304) 848-5035  
Fax: (304) 848-5037

172 Thompson Drive  
Bridgeport, WV 26330

PARTY CHIEF: C. Lynch	DRAWN BY: C. Robinson
RESEARCH: J. Miller	PREPARED: March 19, 2025
SURVEYED: Dec. 2016	PROJECT NO: 153-54-L-23
FIELD CREW: C.L., K.M.	DRAWING NO: Gorby 2H AOR

Sheet 1 of 1



Scale: 1 inch = 2000 feet

05/02/2025

INFORMATION SUPPLIED UNDER WEST VIRGINIA CODE  
Chapter 22, Article 6A, Section 5(a)(5)  
IN LIEU OF FILING LEASE(S) AND OTHER CONTINUING CONTRACT(S)

Under the oath required to make the verification on page 1 of this Notice and Application, I depose and say that I am the person who signed the Notice and Application for the Applicant, and that –

- (1) the tract of land is the same tract described in this Application, partly or wholly depicted in the accompanying plat, and described in the Construction and Reclamation Plan;
- (2) the parties and recordation data (if recorded) for lease(s) or other continuing contract(s) by which the Applicant claims the right to extract, produce or market the oil or gas are as follows:

Grantor, lessor, etc.	Grantee, lessee, etc.	Royalty	Book/Page
<b>47: Dennis &amp; Constance L. Swindall, Trustees for the Swindall Revocable Trust Lease</b>			
Dennis & Constance L. Swindall, Trustees for the Swindall Revocable Trust	Back Country Exploration LLC	1/8+	387/501
Back Country Exploration LLC	Triad Hunter, LLC	Conveyance	338/234
Triad Hunter, LLC	Antero Resources Corporation	Assignment	496/776
<b>46: David A. &amp; Denise Gorby Lease</b>			
David A. & Denise Gorby	Antero Resources Corporation	1/8+	172/529
<b>48: Sherry Lynn Chefren Lease</b>			
Sherry Lynn Chefren	Antero Resources Corporation	1/8+	429/527
<b>46: David A. &amp; Denise Gorby Lease</b>			
David A. & Denise Gorby	Antero Resources Corporation	1/8+	172/529
<b>42: Antero Minerals, LLC Lease</b>			
Antero Minerals, LLC	Antero Resources Corporation	1/8+	325A/641
<b>41: Gregory V Hart Lease</b>			
Gregory V Hart	Antero Resources Corporation	1/8+	206/183
<b>39: Gregory V Hart, And as Trustee of the Gregory V Hart Revocable Trust Lease</b>			
Gregory V Hart, And as Trustee of the Gregory V Hart Revocable Trust	SEP Appalachia, LLC	1/8	373A/92
SEP Appalachia, LLC	Antero Resources Corporation	Agreement	407A/700
<b>38: Patsy D. Hoyt Lease</b>			
Patsy D. Hoyt	Antero Resources Corporation	1/8+	293A/679
<b>31: Margaret A. Kline Lease</b>			
Margaret A. Kline	TH Exploration, LLC	1/8	328A/119
TH Exploration, LLC	Antero Resources Corporation	Assignment	Pooled Tract
<b>32: Edwin F. &amp; Judy A. Probst, JTWROS Lease</b>			
Edwin F. & Judy A. Probst, JTWROS	Antero Resources Corporation	1/8+	286A/824
<b>31: Margaret A. Kline Lease</b>			
Margaret A. Kline	TH Exploration, LLC	1/8	328A/119
TH Exploration, LLC	Antero Resources Corporation	Assignment	Pooled Tract
<b>26: Walter Ray Jr &amp; Cathy Fouchs Lease</b>			
Walter Ray Jr & Cathy Fouchs	Antero Resources Corporation	1/8+	291A/643
<b>23: Larry D. Eddy Lease</b>			
Larry D. Eddy	Antero Resources Corporation	1/8+	374A/196
<b>22: Billy K. &amp; Carolyn Goddard Lease</b>			
Billy K. & Carolyn Goddard	Antero Resources Corporation	1/8+	276A/920

RECEIVED  
Office of Oil and Gas

APR 23 2025

WV Department of  
Environmental Protection

05/02/2025

INFORMATION SUPPLIED UNDER WEST VIRGINIA CODE  
Chapter 22, Article 6A, Section 5(a)(5)  
IN LIEU OF FILING LEASE(S) AND OTHER CONTINUING CONTRACT(S)

Under the oath required to make the verification on page 1 of this Notice and Application, I depose and say that I am the person who signed the Notice and Application for the Applicant, and that –

- (1) the tract of land is the same tract described in this Application, partly or wholly depicted in the accompanying plat, and described in the Construction and Reclamation Plan;
- (2) the parties and recordation data (if recorded) for lease(s) or other continuing contract(s) by which the Applicant claims the right to extract, produce or market the oil or gas are as follows:

Grantor, lessor, etc.	Grantee, lessee, etc.	Royalty	Book/Page
<u>20: Doris J. Koerber Lease</u> Doris J. Koerber	Antero Resources Corporation	1/8+	383A/430
<u>18: Luke A. Martin Lease</u> Luke A. Martin	Antero Resources Corporation	1/8+	391A/434
<u>17: Edward L. &amp; Brenda K. Blatt Lease</u> Edward L. & Brenda K. Blatt TH Exploration, LLC	TH Exploration, LLC Antero Resources Corporation	1/8 Assignment	335A/388 Pooled Tract
<u>13: Ernest Lee &amp; Dorothy Blatt, Life Tenants &amp; Larry R. &amp; Linda S. Sweeney, Remainderman Lease</u> Ernest Lee & Dorothy Blatt, Life Tenants & Larry R. & Linda S. Sweeney, Remainderman TH Exploration, LLC	TH Exploration, LLC Antero Resources Corporation	1/8 Assignment	335A/386 Pooled Tract
<u>10: Carol A. Whitmer Lease</u> Carol A. Whitmer	Antero Resources Corporation	1/8+	398A/14
<u>2: Phillip W. Wiley Lease</u> Phillip W. Wiley	Antero Resources Corporation	1/8+	376A/95
<u>3: CSX Transportation, Inc Lease</u> CSX Transportation Inc	Antero Resources Corporation	1/8+	398A/904
<u>2: Phillip W. Wiley Lease</u> Phillip W. Wiley	Antero Resources Corporation	1/8+	376A/95

\*Partial Assignments to Antero Resources Corporation include 100% rights to extract, produce and market the oil and gas from the Marcellus and any other formations completed with this well.

**\*Cotenancy Utilization** - Antero is utilizing the Co-tenancy Modernization and Majority Protection Act to proceed with development of certain royalty owners' interests in this tract.

**\*\*Pooling/Unitization** – Antero has filed a horizontal well unitization application with the West Virginia Oil and Gas Conservation Commission that seeks to pool certain owners in this tract

RECEIVED  
Office of Oil and Gas

APR 23 2025

WV Department of  
Environmental Protection

05/02/2025



**INFORMATION SUPPLIED UNDER WEST VIRGINIA CODE**  
**Chapter 22, Article 6A, Section 5(a)(5)**  
**IN LIEU OF FILING LEASE(S) AND OTHER CONTINUING CONTRACT(S)**

Under the oath required to make the verification on page 1 of this Notice and Application, I depose and say that I am the person who signed the Notice and Application for the Applicant, and that –

- (1) the tract of land is the same tract described in this Application, partly or wholly depicted in the accompanying plat, and described in the Construction and Reclamation Plan;
- (2) the parties and recordation data (if recorded) for lease(s) or other continuing contract(s) by which the Applicant claims the right to extract, produce or market the oil or gas are as follows:

Lease Name or Number	Grantor, Lessor, etc.	Grantee, Lessee, etc.	Royalty	Book/Page
<b>1: WV Department of Natural Resources Lease</b>				
	<b>WV Department of Natural Resources</b>	<b>Antero Resources Corporation</b>	<b>1/8+</b>	<b>Pooled Tract</b>

**\*Cotenancy Utilization** - Antero is utilizing the Co-tenancy Modernization and Majority Protection Act to proceed with development of certain royalty owners' interests in this tract.

**\*\*Pooling/Unitization** - Antero has filed a horizontal well unitization application with the West Virginia Oil and Gas Conservation Commission that seeks to pool certain owners in this tract

**Acknowledgement of Possible Permitting/Approval**  
**In Addition to the Office of Oil and Gas**

The permit applicant for the proposed well work addressed in this application hereby acknowledges the possibility of the need for permits and/or approvals from local, state, or federal entities in addition to the DEP, Office of Oil and Gas, including but not limited to the following:

- WV Division of Water and Waste Management
- WV Division of Natural Resources WV Division of Highways
- U.S. Army Corps of Engineers
- U.S. Fish and Wildlife Service
- County Floodplain Coordinator

RECEIVED  
Office of Oil and Gas  
  
APR 23 2025  
  
WV Department of  
Environmental Protection

The applicant further acknowledges that any Office of Oil and Gas permit in no way overrides, replaces, or nullifies the need for other permits/approvals that may be necessary and further affirms that all needed permits/approvals should be acquired from the appropriate authority before the affected activity is initiated.

Well Operator: Antero Resources Corporation

By: Max Green

Its: Vice President of Land



TOP LATITUDE 39 - 35 - 00 30  
BTM LATITUDE 39 - 37 - 30 '

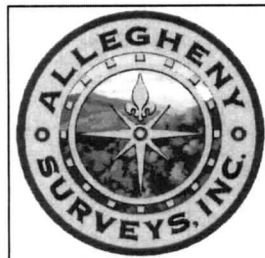

LONGITUDE

Bottom Hole

829' to Top Hole

**Well Location References  
Not to Scale**

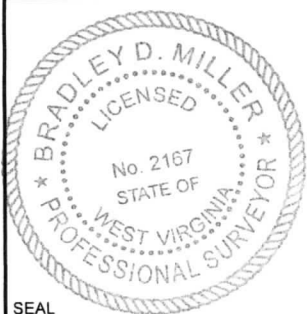
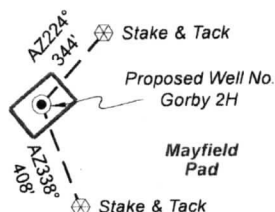

***I, the undersigned, hereby certify that this plat is correct to the best of my knowledge and belief and shows all the information required by law and the rules issued and prescribed by the Department of Environmental Protection.***

**Bradley D. Miller, P.S. 2167**

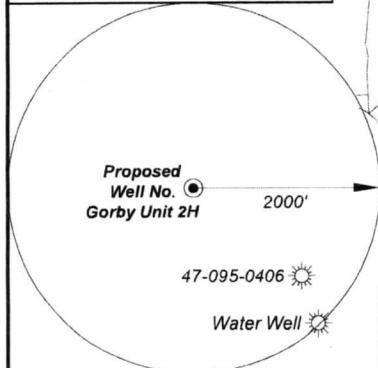

Note: 1 water well were found within 2000' of proposed well. No occupied dwellings or buildings 2,500 square feet or larger used to house or shelter dairy cattle or poultry husbandry are located within 625' of the center of the well pad.

Tag	Bearing	Dist.	Monument
L1	N 26°18' W	2,019.6'	Center of bridge
L2	N 50°03' W	1,445.2'	47-095-00406
L3	S 62°50' W	579.5'	Roof bolt on creek bank
L4	S 25°18' E	1,968.9'	5/8" Rebar
L5	N 85°50' E	1,806.6'	Point of Entry (POE)

**Notes**

West Virginia Coordinate System  
of 1927, North Zone  
based upon Differential GPS Measurements.

Well No. Gorbey Unit 2H Top Hole coordinates are  
N: 396,824.05'      Latitude: 39°34'51.81"  
E: 1,605,105.08'      Longitude: 80°54'03.95"  
Bottom Hole coordinates are  
N: 410,580.16'      Latitude: 39°37'07.14"  
E: 1,601,108.58'      Longitude: 80°54'57.76"  
UTM Zone 17, NAD 1983

Top Hole Coordinates      Bottom Hole Coordinates  
N: 4,381,273.717m      N: 4,385,444.253m  
E: 508,508.632m      E: 507,221.218m

Plat orientation and corner and well references  
are based upon the grid north meridian.  
Well location references are based upon the  
magnetic meridian.

**Notes:**  
Well No. Gorby Unit 2H  
UTM Zone 17, NAD 1927  
N: 14,373,514.48'  
E: 1,668,283.73'  
Point of Entry Coordinates  
N: 14,373,675.91'  
E: 1,670,082.46'  
Bottom Hole Coordinates  
N: 14,387,197.296'  
E: 1,664,059.56'

Wellhead Layout (NTS)

**Proposed Well  
Gorby Unit 2H  
(API# 47-095-02910)**

N 69°03' E 15.0'

Gorby Unit 1H  
(API# 47-095-02909)  
Driftwood Unit 2H  
(API# 47-095-02908)  
Proposed Well  
Driftwood Unit 1H  
(API# 47-095-02907)  
Rigby Unit 1H  
(API# 47-095-02911)

FILE NO: 153-54-L-23  
DRAWING NO: Gorby 2H Well Plat  
SCALE: 1" = 2000'  
MINIMUM DEGREE OF ACCURACY:  
Submeter  
PROVEN SOURCE OF ELEVATION:  
WVDOT, Harrisville, WV

**STATE OF WEST VIRGINIA**  
DEPARTMENT OF ENVIRONMENTAL PROTECTION  
**OIL AND GAS DIVISION**

DATE: March 20 2025  
 OPERATOR'S WELL NO. Gorby 2H  
 API WELL NO  
47 — 095 — 02910  
 STATE COUNTY PERMIT

WELL TYPE: ☐ OIL ☒ GAS ☐ LIQUID INJECTION ☐ WASTE DISPOSAL  
(IF GAS) PRODUCTION: ☐ STORAGE ☐ DEEP ☒ SHALLOW

LOCATION: ELEVATION: As-Built: 864'

WATERSHED: Outlet Middle Island Creek

QUADRANGLE: Paden City

DISTRICT: Lincoln / Magnolia

COUNTY: Tyler / Wetzel

SURFACE OWNER: *Antero Resources Corp.*

ACREAGE: 60.96

ROYALTY OWNER: *Dennis Swindall & Constance Swindall Trustees for the Swindall Revocable Trust*

LEASE NO:                      ACREAGE:      208

PROPOSED WORK: ☐ DRILL ☐ CONVERT ☒ DRILL DEEPER ☒ FRACTURE OR STIMULATE ☐ PLUG OFF OLD FORMATION  
☐ PERFORATE NEW FORMATION ☒ OTHER PHYSICAL CHANGE IN WELL (SPECIFY) \_\_\_\_\_ BHL-MOD \_\_\_\_\_

☐ PLUG AND ABANDON ☐ CLEAN OUT AND REPLUG TARGET FORMATION: Marcellus Shale ESTIMATED DEPTH: 24,900' MD

**WELL OPERATOR:** Antero Resources Corporation

DESIGNATED AGENT: Conrad Baston

ADDRESS: 1615 Wynkoop Street

ADDRESS: 535 White Oaks Blvd.

Denver, CO 80202

Bridgeport, WV 26330

SMW  
4/17/25



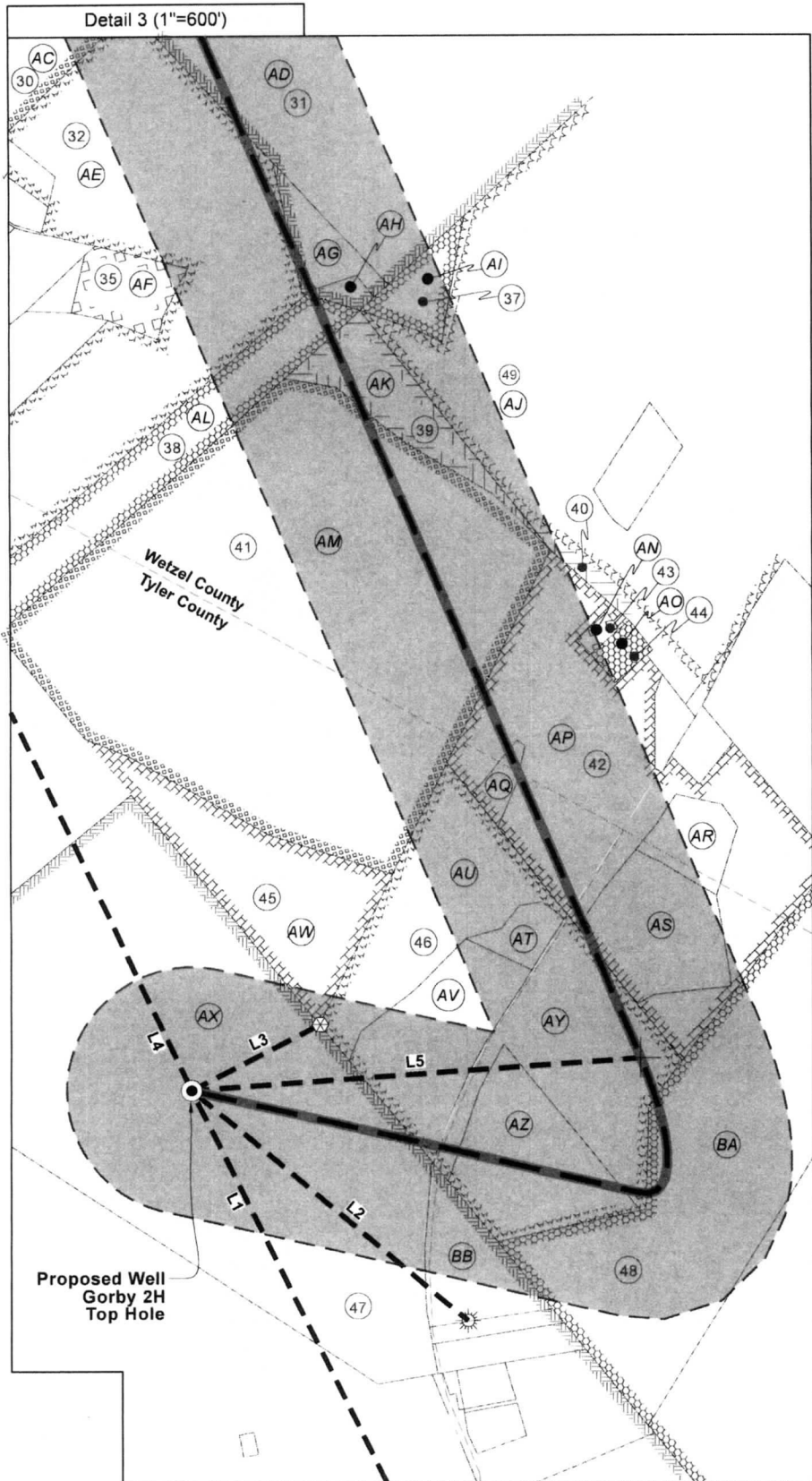

FILE NO: 153-54-L-23  
DRAWING NO: Gorby 2H Well Plat  
SCALE: 1" = 2000'  
MINIMUM DEGREE OF ACCURACY:  
Submeter  
PROVEN SOURCE OF ELEVATION:  
WVDOT, Harrisville, WV

STATE OF WEST VIRGINIA  
DEPARTMENT OF ENVIRONMENTAL PROTECTION  
OIL AND GAS DIVISION

DATE: March 20 20 25  
OPERATOR'S WELL NO. Gorby 2H  
API WELL NO  
47 — 095 — 02910  
STATE COUNTY PERMIT

WELL TYPE: ☐ OIL ☒ GAS ☐ LIQUID INJECTION ☐ WASTE DISPOSAL  
(IF GAS) PRODUCTION: ☐ STORAGE ☐ DEEP ☒ SHALLOW

LOCATION: ELEVATION: As-Built: 864'

WATERSHED: Outlet Middle Island Creek

QUADRANGLE: Paden City

DISTRICT: Lincoln / Magnolia

COUNTY: Tyler / Wetzel

SURFACE OWNER: Antero Resources Corp.

ROYALTY OWNER: Dennis Swindall & Constance Swindall Trustees for the Swindall Revocable Trust

LEASE NO:

ACREAGE: 60.96

ACREAGE: 208

PROPOSED WORK: ☐ DRILL ☐ CONVERT ☒ DRILL DEEPER ☒ FRACTURE OR STIMULATE ☐ PLUG OFF OLD FORMATION  
☐ PERFORATE NEW FORMATION ☒ OTHER PHYSICAL CHANGE IN WELL (SPECIFY) BHL-MOD 7,000' TVD

☐ PLUG AND ABANDON ☐ CLEAN OUT AND REPLUG TARGET FORMATION: Marcellus Shale ESTIMATED DEPTH: 24,900' MD

WELL OPERATOR: Antero Resources Corporation

DESIGNATED AGENT: Conrad Baston

ADDRESS: 1615 Wynkoop Street

ADDRESS: 535 White Oaks Blvd.

Denver, CO 80202

Bridgeport, WV 26330



Antero Resources  
Well No. Gorby 2H  
BHL MOD  
Antero Resources Corporation

Page 3 of 4

ID	Lease
1	WV Department of Natural Resources
2	Phillip W. Wiley
3	CSX Transportation, Inc.
4	Jessie Thompson
9	WV Department of Transportation
10	Carol A. Whitmer
12	Randy E. Goddard
13	Ernest Lee & Dorothy Blatt, Life Tenants & Larry R. & Linda S. Sweeney, Remainderman
14	Larry R. & Linda S. Sweeney
16	Barbara S. Coombs
17	Edward L. & Brenda K. Blatt
18	Luke A. Martin
19	Alexander Brast & Carol Thomas Revocable Trust
20	Doris J. Koerber
21	Doris J. Koerber
22	Billy K. & Carolyn Goddard
23	Larry D. Eddy
25	Emma Fuchs
26	Walter Ray Jr. & Cathy Fouchs
30	Billy K. Goddard
31	Margaret A. Kline
32	Edwin F. & Judy A. Probst, JTWROS
35	Jack R. & Linda J. Berisford
37	Randall L. Kemp, Sr.
38	Patsy D. Hoyt
39	Gregory V. Hart, And As Trustee of the Gregory V. Hart Revocable Trust
40	Gregory V. Hart, And As Trustee of the Gregory V. Hart Revocable Trust
41	Gregory V. Hart
42	Antero Minerals, LLC
43	Charles M. & Ashley L. Moore
44	Brittany Kay Clegg
45	Ridgetop Capital II, LP
46	David A. & Denise Gorby
47	Dennis & Constance L. Swindall, Trustees for the Swindall Revocable Trust
48	Sherry Lynn Chefren
49	Gregory V. Hart, And As Trustee of the Gregory V. Hart Revocable Trust
50	Alan L. Potter

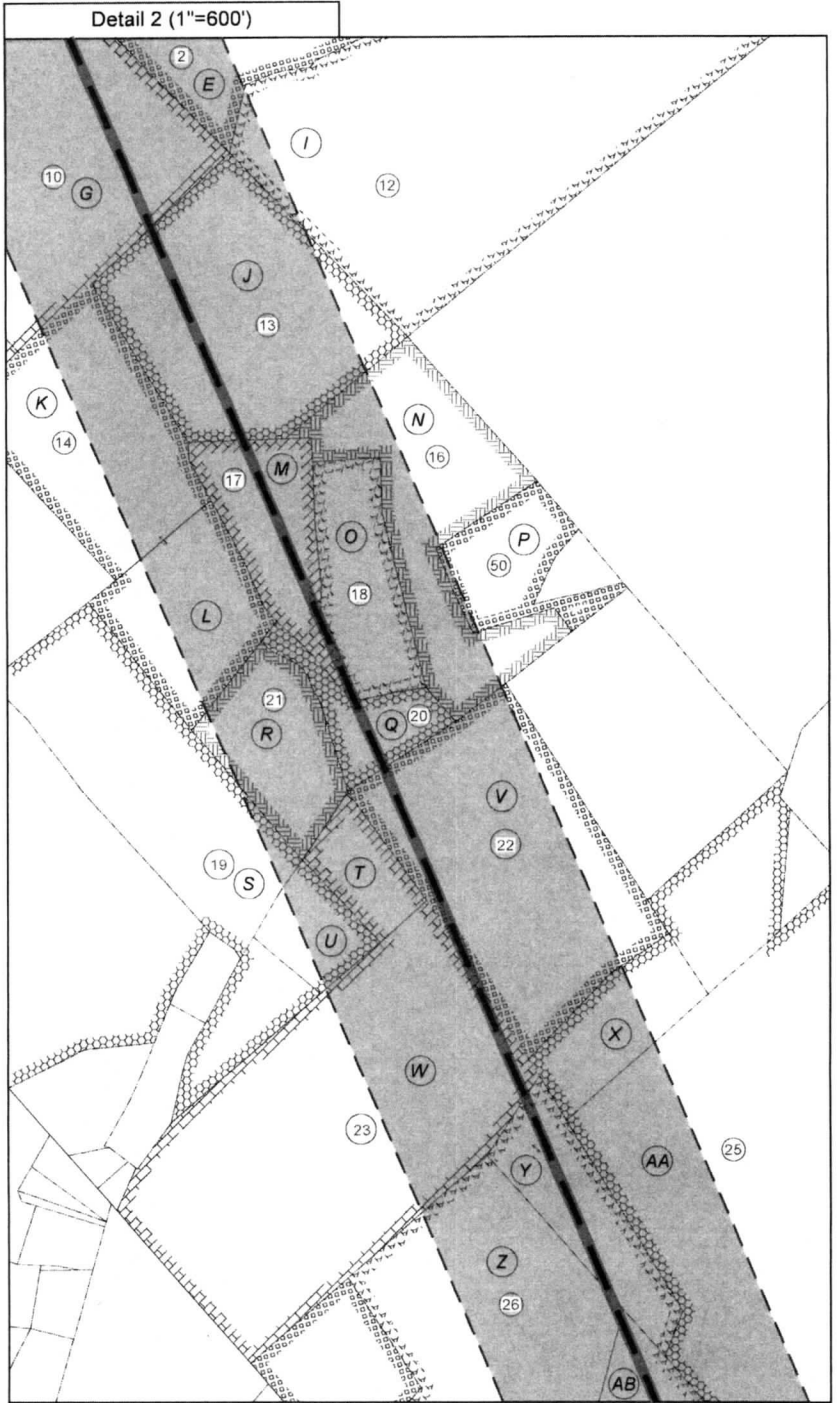

DRAWING NO: Gorby 2H Well Plat

SCALE: 1" = 2000'

MINIMUM DEGREE OF ACCURACY:  
Submeter

PROVEN SOURCE OF ELEVATION:  
WVDOT, Harrisville, WV

STATE OF WEST VIRGINIA  
DEPARTMENT OF ENVIRONMENTAL PROTECTION  
OIL AND GAS DIVISION

DATE: March 20 20 25

OPERATOR'S WELL NO. Gorby 2H

API WELL NO

47 — 095 — 02910  
STATE COUNTY PERMIT

WELL TYPE: ☐ OIL ☒ GAS ☐ LIQUID INJECTION ☐ WASTE DISPOSAL  
(IF GAS) PRODUCTION: ☐ STORAGE ☐ DEEP ☒ SHALLOW

LOCATION: ELEVATION: As-Built: 864'

WATERSHED: Outlet Middle Island Creek

QUADRANGLE: Paden City

DISTRICT: Lincoln / Magnolia

COUNTY: Tyler / Wetzel

SURFACE OWNER: Antero Resources Corp.

ACREAGE: 86.36

ROYALTY OWNER: Dennis Swindall & Constance Swindall Trustees for the Swindall Revocable Trust

LEASE NO: ACREAGE: 208

PROPOSED WORK: ☐ DRILL ☐ CONVERT ☒ DRILL DEEPER ☒ FRACTURE OR STIMULATE ☐ PLUG OFF OLD FORMATION  
☐ PERFORATE NEW FORMATION ☒ OTHER PHYSICAL CHANGE IN WELL (SPECIFY) BHL-MOD

☐ PLUG AND ABANDON ☐ CLEAN OUT AND REPLUG TARGET FORMATION: Marcellus Shale ESTIMATED DEPTH: 7,000' TVD 24,900' MD

WELL OPERATOR: Antero Resources Corporation

DESIGNATED AGENT: Conrad Baston

ADDRESS: 1615 Wynkoop Street  
Denver, CO 80202

ADDRESS: 535 White Oaks Blvd.  
Bridgeport, WV 26330



Antero Resources  
Well No. Gorby 2H  
BHL\_MOD  
Antero Resources Corporation

Page 2 of 4

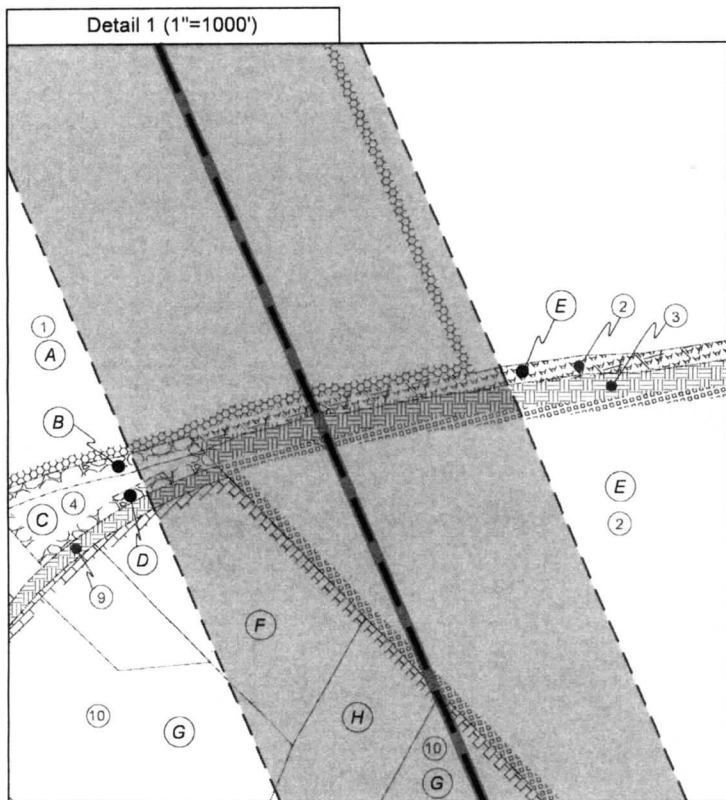

No.	TM / Par	Owner	Bk / Pg	Ac.
A	x / xx	xx	xx / xx	xx
B	x / xx	xx	xx / xx	xx
C	11 / 3	Jessie Thompson	409 / 24	2.10
D	11 / 4	Jessie Thompson	409 / 24	0.14
E	11 / 7	Phillip Wiley	365 / 313	44.38
F	11 / 6	Gregory M. & Courtney L. Hohman	426 / 563	6.00
G	11 / 5	Gregory M. & Courtney L. Hohman	426 / 563	3.50
H	11 / 45	Gregory M. & Courtney L. Hohman	426 / 563	18.01
I	11 / 53	Jeffery Henthorn	359 / 526	25.00
J	11 / 64	Larry & Linda Sweeney	445 / 72	14.12
K	11 / 106	Larry & Linda Sweeney	402 / 372	17.17
L	11 / 106	Larry & Linda Sweeney	402 / 372	17.17
M	11 / 71.3	Edward L. & Brenda K. Blatt	433 / 126	5.18
N	11 / 71	Michael D. & Patricia A. Jobes	445 / 56	13.57
O	11 / 71.2	Teresa M. Martin	421 / 519	5.17
P	11 / 71.1	Michael D. & Patricia A. Jobes	300 / 461	3.95
Q	11 / 70	Dorothy M. Blatt	WB111 / 15	3.36
R	11 / 70.1	Wanda Ferrebee	411 / 608	5.18
S	11 / 69	Larry & Linda Sweeney	404 / 87	12.10
T	11 / 85	Duane Mark Cross	406 / 283	2.70
U	11 / 86	Brandon Cross	468 / 464	0.42
V	11 / 89	Billy K. & Carolyn S. Goddard	MS103 / 326	16.00
W	11 / 88	Evelyn M. Cross	242 / 252	31.09
X	11 / 91	Emma Fuchs	280 / 109	3.70
Y	11 / 90	Cathy & Walter Ray Fouchs Jr.	330 / 352	5.36
Z	16 / 5.1	Walter Ray Fouchs	330 / 352	32.61
AA	16 / 6	Emma Fuchs	280 / 109	96.11
AB	16 / 5	Walter Ray Fouchs Jr. & Cathy Fouchs	330 / 352	33.25
AC	16 / 31	Billy K. & Carolyn S. Goddard	502 / 370	32.57
AD	16 / 33	Donna L. Kline, et al	453 / 174	103.32
AE	16 / 49	Edwin F. & Judy A. Probst L/E Pearl G. Probst	394 / 570	33.95
AF	16 / 49.8	Jack Randy Berisfod	411 / 640	2.51
AG	16 / 35	Donna L. Kline, et al	453 / 174	4.00
AH	16 / 34	Donna L. Kline, et al	453 / 174	0.57
AI	16 / 52.3	Brenda Lee & Randall L. Kemp Sr.	420 / 425	1.99
AJ	16 / 52	Gregory V. Hart	WB69 / 785	34.39
AK	16 / 53	Gregory V. Hart	WB69 / 785	0.75
AL	16 / 49.3	Patsy D. Hoyt	339 / 316	8.86
AM	5 / 66	Gregory V. Hart	WB86 / 400	59.78
AN	16 / 54.6	Charles M. & Ashley L. Moore	428 / 358	0.30
AO	16 / 54.3	Brittney Kay Clegg	409 / 17	0.70
AP	16 / 54	Mary Kay Virdin	WB96 / 614	22.18
AQ	16 / 54.1	Mary Kay Virdin	WB96 / 614	0.73
AR	16 / 54.5	Donald J. & Debby J. Powell	302 / 16	2.30
AS	16 / 54.2	Kevin Lawrence	WB106 / 535	5.50
AT	5 / 64.1	Shawn M. Meckley	363 / 215	1.19
AU	5 / 64	Wesley Shriver	490 / 758	80.38
AV	5 / 64.2	Randy & Kimberly Dawson	OR210 / 575	6.90
AW	5 / 64	Wesley Shriver	490 / 758	80.38
AX	5 / 63.1	Antero Resources Corp.	OR299 / 308	60.96
AY	5 / 64	Wesley Shriver	490 / 758	80.38
AZ	2 / 2	John William & Rhonda L. Burton	380 / 341	7.20
BA	2 / 1	Donald E. Virden Jr.	421 / 281	30.84
BB	2 / 3	Garnett C. Myers	WB20 / 436	0.75

Legend

- Proposed gas well
- Well Reference, as noted
- Monument, as noted
- Existing Well, as noted
- Existing Plugged Well, as noted
- Digitized Well, as noted
- Creek or Drain
- Existing Road
- Surface boundary (approx.)
- Railroad Tracks (approx.)
- State / County line

FILE NO: 153-54-L-23

DRAWING NO: Gorby 2H Well Plat

SCALE: 1" = 2000'

MINIMUM DEGREE OF ACCURACY:  
Submeter

PROVEN SOURCE OF ELEVATION:  
WVDOT, Harrisville, WV

STATE OF WEST VIRGINIA  
DEPARTMENT OF ENVIRONMENTAL PROTECTION  
OIL AND GAS DIVISION

DATE: March 20 20 25

OPERATOR'S WELL NO. Gorby 2H

API WELL NO

47 — 095 — 02910  
STATE COUNTY PERMIT

WELL TYPE: ☐ OIL ☒ GAS ☐ LIQUID INJECTION ☐ WASTE DISPOSAL  
(IF GAS) PRODUCTION: ☐ STORAGE ☐ DEEP ☒ SHALLOW

LOCATION: ELEVATION: As-Built: 864'

WATERSHED: Outlet Middle Island Creek

QUADRANGLE: Paden City

DISTRICT: Lincoln / Magnolia

COUNTY: Tyler / Wetzel

SURFACE OWNER: Antero Resources Corp.

ACREAGE: 60.26

ROYALTY OWNER: Dennis Swindall & Constance Swindall Trustees for the Swindall Revocable Trust

LEASE NO: ACREAGE: 208

PROPOSED WORK: ☐ DRILL ☐ CONVERT ☒ DRILL DEEPER ☒ FRACTURE OR STIMULATE ☐ PLUG OFF OLD FORMATION  
☐ PERFORATE NEW FORMATION ☒ OTHER PHYSICAL CHANGE IN WELL (SPECIFY) BHL-MOD 7,000' TVD

☐ PLUG AND ABANDON ☐ CLEAN OUT AND REPLUG TARGET FORMATION: Marcellus Shale ESTIMATED DEPTH: 24,900' MD

WELL OPERATOR: Antero Resources Corporation

DESIGNATED AGENT: Conrad Baston

ADDRESS: 1615 Wynkoop Street  
Denver, CO 80202

ADDRESS: 535 White Oaks Blvd.  
Bridgeport, WV 26330