

Company Rock Oil & Gas Co
 Address Sistersville W. Va
 Farm Andrew H
 Tract 1 Acres ±5 Lease No. _____
 Well (Farm) No. 2 Serial No. Hope (2042)
 Elevation (Spirit Level) 771'
 Quadrangle New Martinsville W
 County 1 District Lincoln
 Engineer J. B. McCoy
 Engineer's Registration No. _____
 File No. _____ Drawing No. _____
 Date 3-20-10 Scale 1" = 40'

STATE OF WEST VIRGINIA
 DEPARTMENT OF MINES
 OIL AND GAS DIVISION
 CHARLESTON

WELL LOCATION MAP
 FILE NO. TYL-241A

+ Denotes location of well on United States Topographic Maps, scale 1 to 62,500. latitude and longitude lines being represented by border lines as shown.

- Denotes one inch spaces on border line of original tracing.

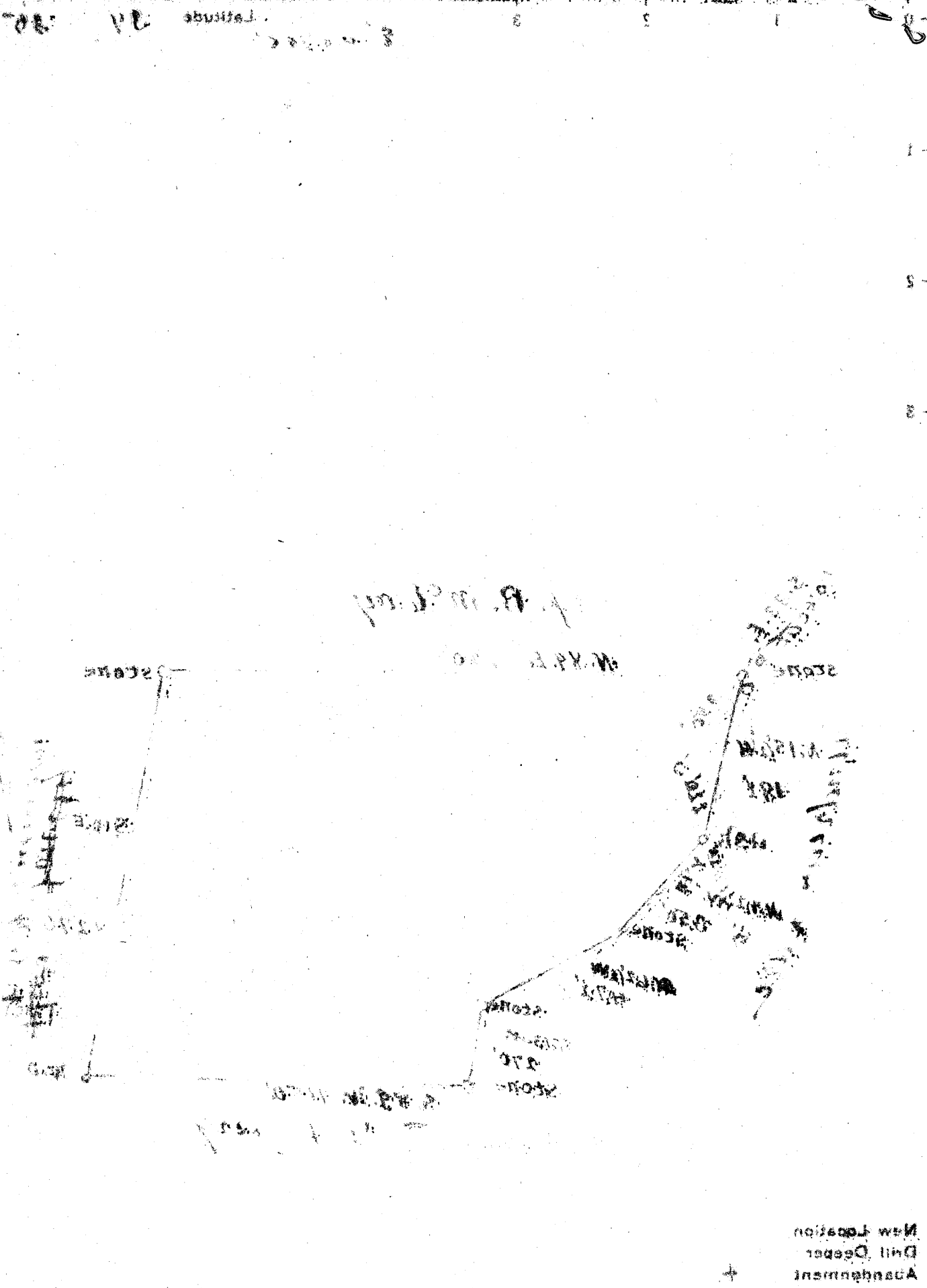

New Location
 Drill Depart
 Assignment

STATE OF WEST VIRGINIA
 DEPARTMENT OF MINES
 OIL AND GAS DIVISION
 CHARLESTON

WELL LOCATION MAP
 FILE NO. TYL-241A

+ Denotes location of well on United States
 Topographic Map scale 1 to 62,500 lat-
 tude and longitude lines being represented
 by border lines as shown
 - Denotes one inch spaces on border line
 of original tracing

Date	3-30-14
File No.	
Engineer's Registration No.	
Engineer	
County	
Quadrangle	
Section	
Well	
Tract	
Address	
Company	

241A

Lincoln District, Tyler County, W. Va.

By Reno Oil Co., Sistersville, W. Va.

On 45 acres.

Surface owned by John M. Strouss et al., Pittsburgh, Pa., and
minerals by same.Elevation.. ~~771.6~~

4" tubing, 1480'.

Abandoned under permit Tyl-241-A.

Shot in 1894; no record of depth of shot.

Oil well. Abandonment reported to Dept. of Mines March 26, 1940.

Record to RCT from Mrs. Griffith July 15, 1940.

	Top.	Bottom.
Sand	1543	-
Total depth		1607