

Latitude

39 37 30

80 57 30

Longitude

→ 7.5' loc
Kla
813195

Topo Location

| | | | |
|-----------|--------------|----------|--------------|
| 7.5' Loc. | <u>2.795</u> | 15' Loc. | <u>5.675</u> |
| | <u>0.33W</u> | (calc.) | <u>2.55W</u> |

Company Hope Cons. & Ref.

Farm J. Russell 24 (2062)

15' Quad New Martinsville Wc
(sec.)

7.5' Quad Paden City

District Lincoln

WELL LOCATION PLAT

County 095 Permit 30254

(2061) Latitude 39 35

| | | |
|-------|--------|--------|
| #1229 | 5.11 | |
| 266-A | 2.58 W | |
| #2282 | 5.76 S | 39°40' |
| #268A | 2.67 W | |
| #3360 | 0.29 S | |
| #273A | 2.72 W | |
| #2068 | 0.19 S | |
| #277A | 2.60 W | |
| #2026 | 0.11 S | |
| #286A | 2.98 W | |

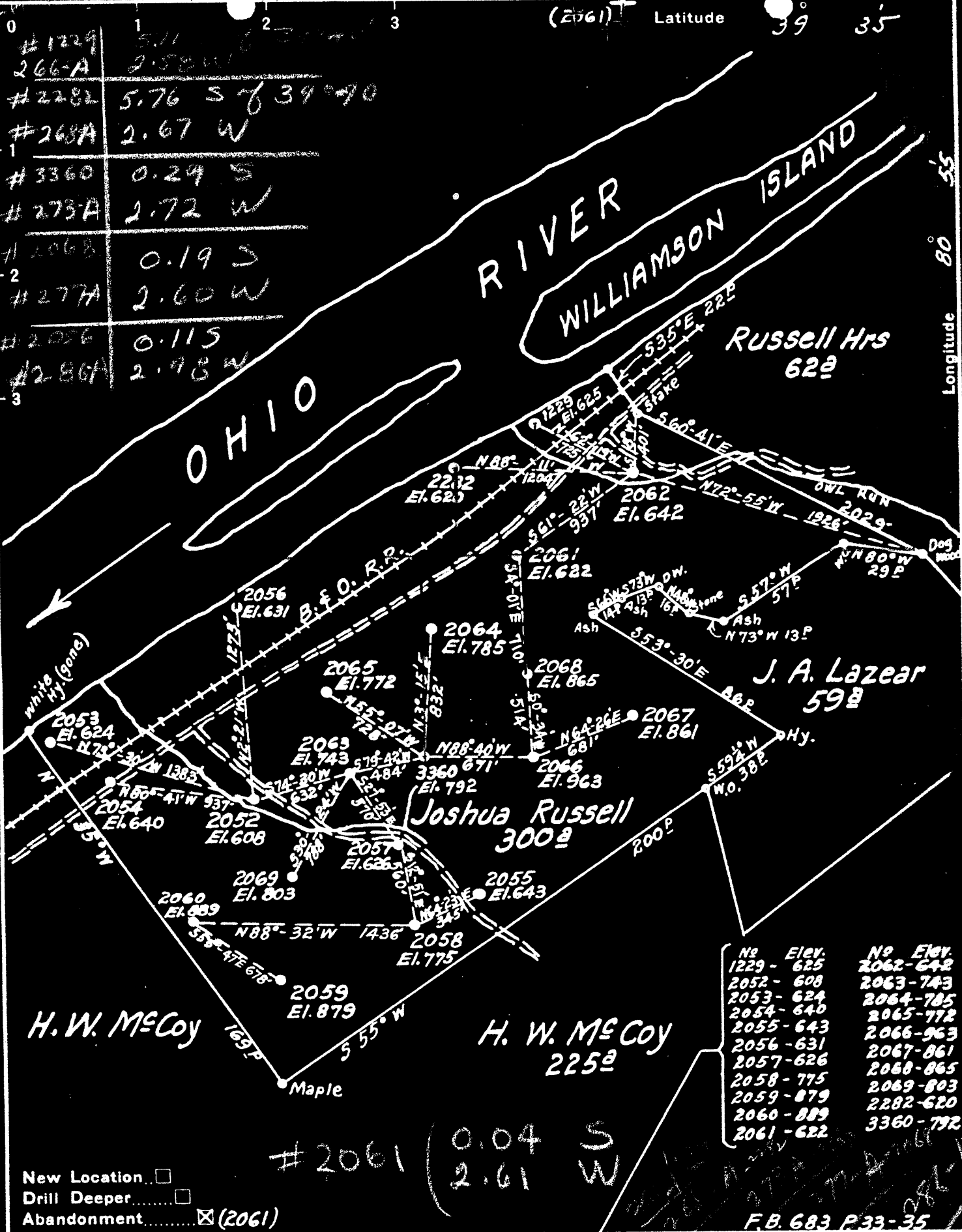

Company Hope Const. & Refining Co.
 Address Clarksburg, W.Va.
 Farm Joshua Russell
 Tract Acres 300 Lease No. 6092
 Well (Farm) No. _____ Serial No. _____
 Elevation (Spirit Level) _____
 Quadrangle New Martinsville
 County Tyler District Lincoln
 Engineer W.M. Bowers
 Engineer's Registration No. 900
 File No. _____ Drawing No. _____
 Date May 29, 1940 Scale 1" = 50'

STATE OF WEST VIRGINIA
 DEPARTMENT OF MINES
 OIL AND GAS DIVISION
 CHARLESTON

WELL LOCATION MAP
 FILE NO. TYL-248A/254A
 2062

+ Denotes location of well on United States Topographic Maps, scale 1 to 62,500, latitude and longitude lines being represented by border lines as shown.

- Denotes one inch spaces on border line of original tracing.

STATE OF WEST VIRGINIA
DEPARTMENT OF MINES
OIL AND GAS DIVISION

308

AP 254-A (Sept 24/8)
Permit No. 248A

WELL RECORD

Oil or Gas Well Oil
(KIND)

Company Hope Construction & Refining Company
Address Clarksburg, W. Va.
Farm Joshua Russell Acres 300
Location (waters).....
Well No. 2062 Elev. 642
District Lincoln County Tyler
The surface of tract is owned in fee by.....
Address.....
Mineral rights are owned by.....
Address.....
Drilling commenced 2-16-1894
Drilling completed 3-11-1894
Date shot 1-22-1897 Depth of shot 1440
Open Flow /10ths Water in..... Inch
/10ths Merc. in..... Inch
Volume..... Cu. Ft.
Rock Pressure..... lbs..... hrs.
Oil..... bbls., 1st 24 hrs.
Fresh water None recorded feet..... feet
Salt water None recorded feet..... feet

| Casing and Tubing | Used in Drilling | Left in Well | Packers |
|---------------------|------------------|--------------|---------------------|
| Size | | | |
| 16..... | | | Kind of Packer..... |
| 13..... | | | |
| 10..... | 68 | 68 | Size of..... |
| 7 5-5/8" | 1085 | 1085 | |
| 4 4 1/2" | 1331 | 1331 | Depth set..... |
| 5 3/16..... | | | |
| 3..... | | | Perf. top..... |
| 2..... | 1490 | 1490 | Perf. bottom..... |
| Liners Used..... | | | Perf. top..... |
| | | | Perf. bottom..... |

CASING CEMENTED..... SIZE..... No. Ft..... Date
Not cemented

COAL WAS ENCOUNTERED AT..... FEET..... INCHES
No coal
..... FEET..... INCHES..... FEET..... INCHES
..... FEET..... INCHES..... FEET..... INCHES

| Formation | Color | Hard or Soft | Top | Bottom | Oil, Gas or Water | Depth Found | Remarks |
|-----------------|-------|--------------|------|-----------|-------------------|-------------|---------|
| First Salt Sand | | | 830 | No record | | | |
| Big Lime | | | 1300 | No record | | | |
| Big Injun Sand | | | 1435 | | Oil | 1440 | |
| Total Depth | | | | 1503 | | | |

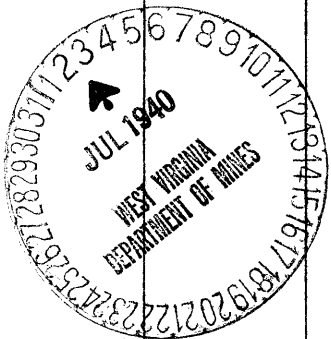

| Formation | Color | Hard or Soft | Top | Bottom | Oil, Gas or Water | Depth Found | Remarks |
|-----------|-------|--------------|-----|--------|-------------------|-------------|---------|
| | | | | | | | |

Date **July 1,** 194**0**

APPROVED **Hope Construction & Refining Co.**, Owner

By *AK Red* **General Supt.**
(Title) *M*

Lincoln District, Tyler County, W. Va.
Hope Cons. & Ref. Co.
Elevation, 615' B. (Barometer approx. 5' high).
Oil and gas well.

?

New Martinsville