

Latitude 37° 35'

Longitude 81° 00'

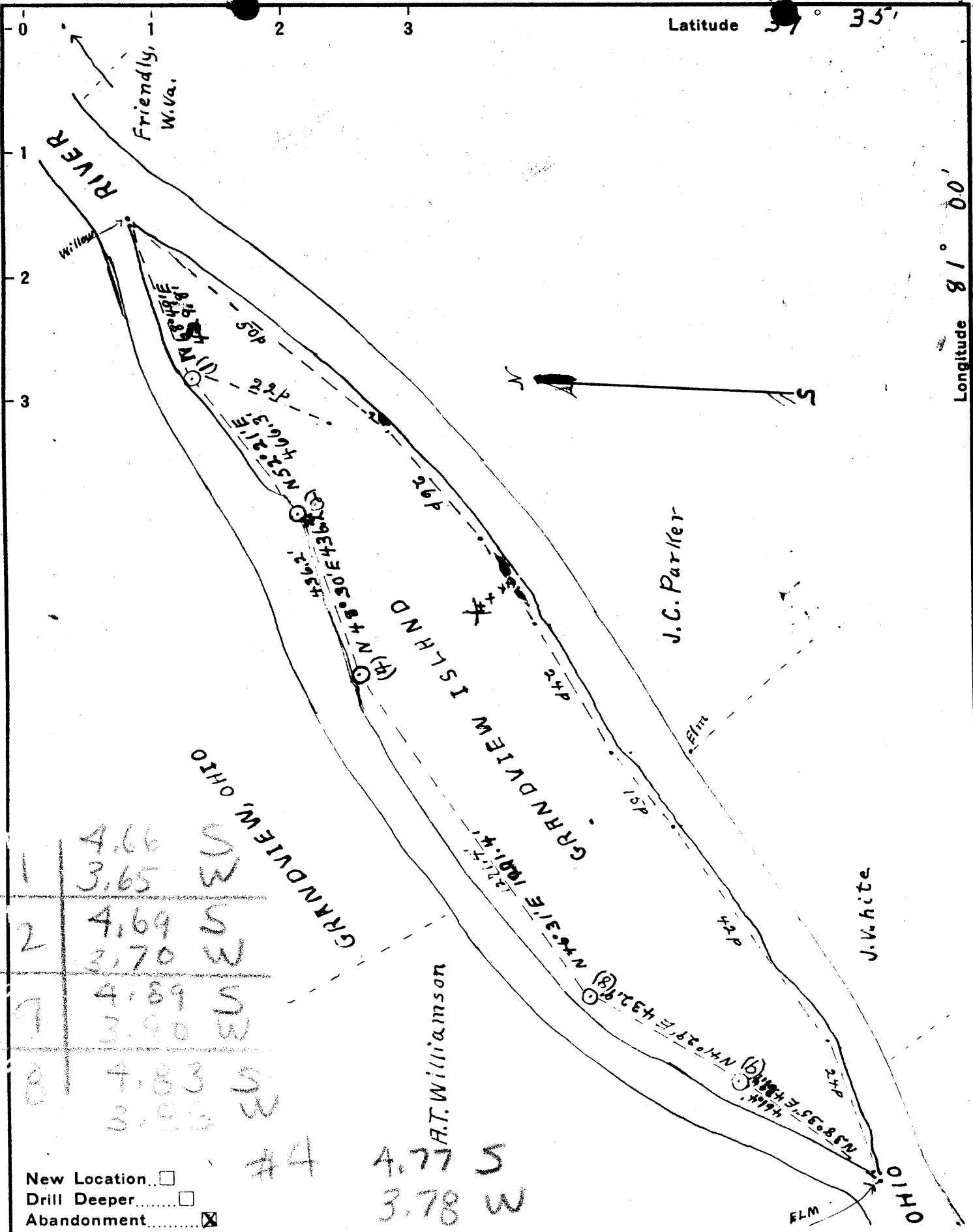

# 1	4.66 S	3.65 W
# 2	4.69 S	3.70 W
# 7	4.89 S	3.90 W
# 8	4.83 S	3.85 W

#4 4.77 S
3.78 W

New Location
 Drill Deeper
 Abandonment

Company Sutton Bros.
 Address Sistersville, W.Va.
 Farm Grandview Island
 Tract 1 Acres 24 Lease No. _____
 Wells (Farm) No's 1-2-4-8-9 Serial No. _____
 Elevation (Spirit Level) No. 1 - 610.1' No. 2 - 613.6' No. 4 - 620.86' No. 8 - 624.88' No. 9 - 20.9'
 Quadrangle New Matamoras
 County Tyler District Union
 Engineer Don L. Riggle, Eng'r.
 Engineer's Registration No. _____
 File No. 1 Drawing No. 19C759
 Date Nov. 17, 1942 Scale 1-in = 340'

STATE OF WEST VIRGINIA
 DEPARTMENT OF MINES
 OIL AND GAS DIVISION
 CHARLESTON JYL-294-A-
#7 JYL-295-A-
WELL LOCATION MAP

FILE NO. JYL-328-#9
JYL-329-#8

+ Denotes location of well on United States Topographic Maps, scale 1 to 62,500, latitude and longitude lines being represented by border lines as shown.

- Denotes one inch spaces on border line of original tracing.