

Longitude 81

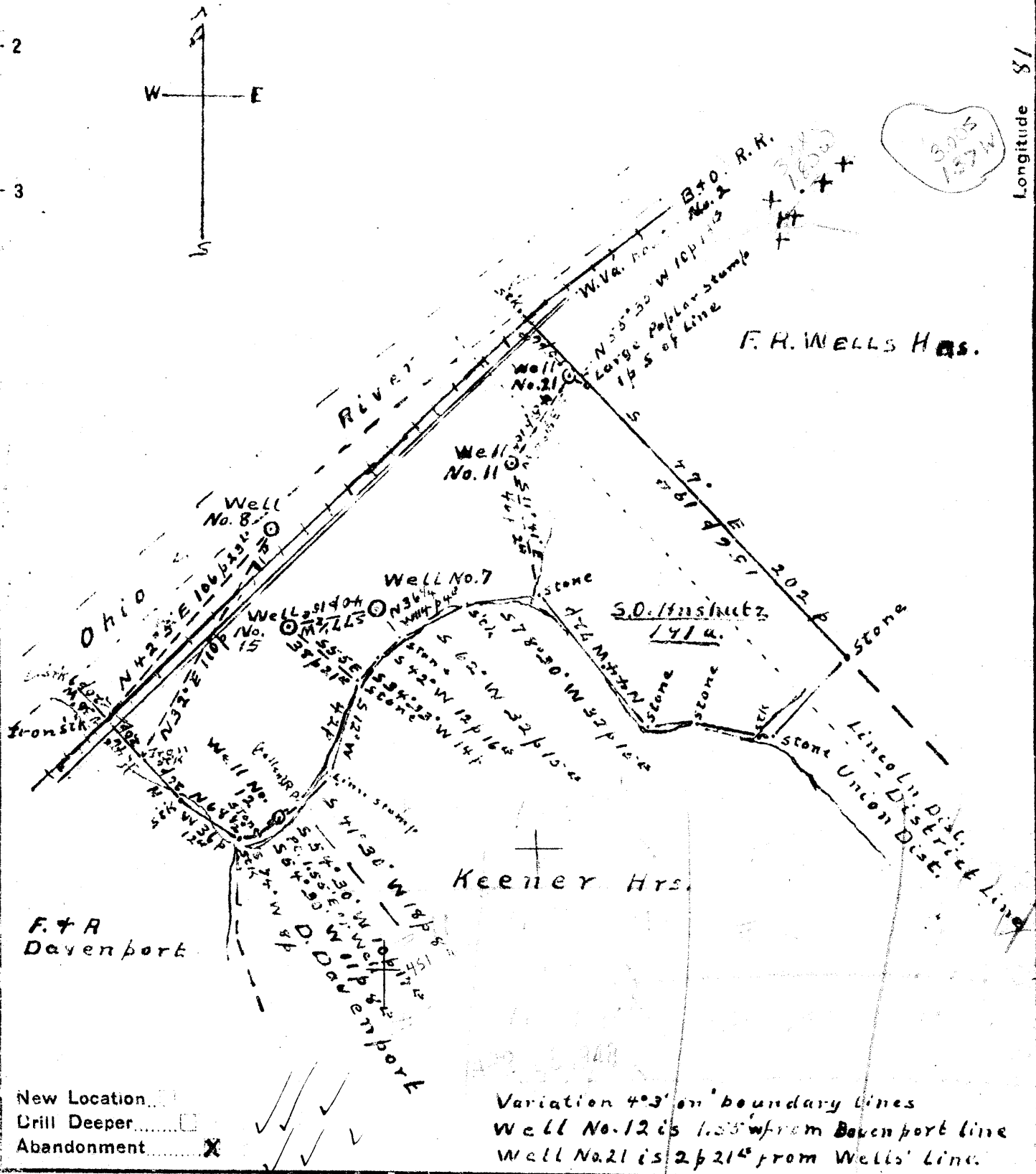

Company Frank Lando
 Address Box 356, Bellaire, Ohio
 Farm S.O. Hnschutz
 Tract 1 Acres 191 Lease No. _____
 Well (Farm) No. 7-8-11-12 Serial No. 15-21
 Elevation (Spirit Level) 7-811' 11-911' 15-821'
8-627' 12-651' 21-896'
 Quadrangle New Matamoras
 County Tyler District Balance in Union
 Engineer Don't Riggle
 Engineer's Registration No. _____
 File No. 046-1 Drawing No. 1099
 Date July 29, 47 Scale 1" = 60'

STATE OF WEST VIRGINIA
 DEPARTMENT OF MINES
 OIL AND GAS DIVISION
 #7 CHARLESTON
 WELLS: JYL-452-A, JYL-448-A-#8, JYL-466-A-#11, JYL-450-A-#12
WELL LOCATION MAP
 FILE NO. JYL-451-A-#15
JYL-477-A-#21
 + Denotes location of well on United States Topographic Maps, scale 1 to 62,500, latitude and longitude lines being represented by border lines as shown.
 - Denotes one inch spaces on border line of original tracing.



STATE OF WEST VIRGINIA
DEPARTMENT OF MINES
OIL AND GAS DIVISION

468

WELL RECORD

Permit No. 477-A

Oil or Gas Well Oil
(KIND)

Company Frank Lando
Address Box 356 - Bellaire, Ohio
Farm S. O. Anshutz Acres 191
Location (waters) Ohio River
Well No. 21 Twenty One Elev. 896'
District Lincoln County Tyler
The surface of tract is owned in fee by Grace E. Lockwood
612 Penna. Ave. Address San Diego, Calif.
Mineral rights are owned by Grace E. Lockwood
612 Penna. Ave. Address San Diego, Calif.
Drilling commenced May 23, 1895
Drilling completed June 17, 1895
Date Shot 1/9/19 From No Record
With 10 Quarts

Casing and Tubing	Used in Drilling	Left in Well	Packers
Size			
16			Kind of Packer
13			<u>Larkin</u>
10	<u>27'</u>	<u>None</u>	Size of
8 1/4	<u>800'</u>	<u>None</u>	<u>6 1/2" x 4-7/8"</u>
6 5/8	<u>1300'</u>	<u>1300'</u>	Depth set
<u>4-7/8"</u>	<u>1574'</u>	<u>1574'</u>	<u>1574'</u>
3			Perf. top
2 Tbg.		<u>1703'</u>	Perf. bottom
Liners Used			Perf. top
			Perf. bottom

Open Flow /10ths Water in _____ Inch
/10ths Merc. in _____ Inch
Volume _____ Cu. Ft.
Rock Pressure _____ lbs. _____ hrs.
Oil 35 bbls., 1st 24 hrs.
Fresh water _____ feet _____ feet
Salt water _____ feet _____ feet

CASING CEMENTED _____ SIZE _____ No. Ft. _____ Date _____
COAL WAS ENCOUNTERED AT _____ FEET _____ INCHES
_____ FEET _____ INCHES FEET _____ INCHES
_____ FEET _____ INCHES FEET _____ INCHES

Formation	Color	Hard or Soft	Top	Bottom	Oil, Gas or Water	Depth Found	Remarks
<u>Cow Run</u>			<u>880'</u>	<u>920'</u>			
<u>First Salt</u>			<u>1000'</u>	<u>1075'</u>			
<u>Big Lime</u>			<u>1550'</u>	<u>1622'</u>			
<u>Oil</u>			<u>1655'</u>	<u>1677'</u>			
<u>Total Depth</u>				<u>1728'</u>			

Formation	Color	Hard or Soft	Top	Bottom	Oil, Gas or Water	Depth Found	Remarks

Date _____, 19____

APPROVED *[Signature]*, Owner

By _____ (Title)

