

Latitude 37° 35'

Longitude 80° 55'

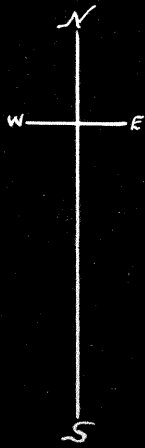

+ 3.96 N
1.905

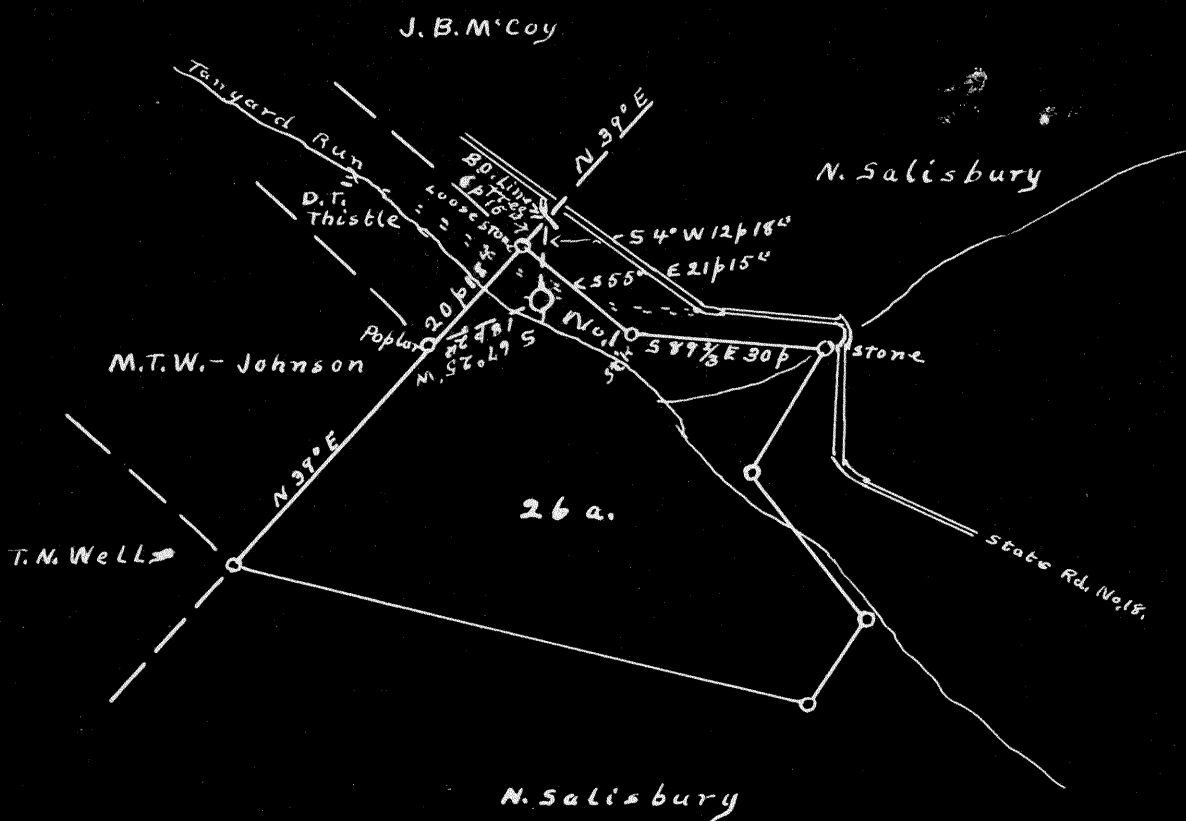

1.93 S
4.01 W

- New Location...
- Drill Deeper...
- Abandonment...

Company J.R. Bull
 Address Sistersville, W.V.a.
 Farm Thistle-Guffey
 Tract 1 Acres 26 Lease No. 6081
 Well (Farm) No. 1 Serial No. _____
 Elevation (Spirit Level) 716
 Quadrangle New Martinsville
 County Tyler District Lincoln
 Engineer Don L. Riggle
 Approved by George R. Clarke
 Engineer's Registration No. 102
 File No. 046-S.R. 11 Drawing No. 1387
 Date May 5, '48 Scale 1" = 30 p

STATE OF WEST VIRGINIA
 DEPARTMENT OF MINES
 OIL AND GAS DIVISION
 CHARLESTON

WELL LOCATION MAP
 FILE NO. JYL-547-A

+ Denotes location of well on United States Topographic Maps, scale 1 to 62,500, latitude and longitude lines being represented by border lines as shown.

- Denotes one inch spaces on border line of original tracing.



STATE OF WEST VIRGINIA
DEPARTMENT OF MINES
OIL AND GAS DIVISION

WELL RECORD

497

Permit No. 547-A

Oil or Gas Well _____ (KIND)

Company J. R. Bull
Address Sistersville, W. Va.
Farm Guffey Thistle Acres _____
Location (waters) _____
Well No. 1 Elev. 716
District Lincoln County Tyler
The surface of tract is owned in fee by _____
Address _____
Mineral rights are owned by _____
Address _____

Drilling commenced _____
Drilling completed _____
Date Shot 11/7/94 From _____ To _____
With 20 gts.
Open Flow _____ /10ths Water in _____ Inch
_____ /10ths Merc. in _____ Inch
Volume _____ Cu. Ft.
Rock Pressure _____ lbs. _____ hrs.
Oil _____ bbls., 1st 24 hrs.
Fresh water _____ feet _____ feet
Salt water _____ feet _____ feet

Casing and Tubing	Used in Drilling	Left in Well	Packers
Size			Kind of Packer
16			
13			
10	125'	125'	Size of
8 1/4			
6 1/2	1000'	1000'	Depth set
5 3/16 4-7/8"	1358'	1358'	
3			Perf. top
2			Perf. bottom
Liners Used			Perf. top
			Perf. bottom

CASING CEMENTED _____ SIZE _____ No. Ft. _____ Date _____

COAL WAS ENCOUNTERED AT _____ FEET _____ INCHES
_____ FEET _____ INCHES _____ FEET _____ INCHES
_____ FEET _____ INCHES _____ FEET _____ INCHES

Formation	Color	Hard or Soft	Top	Bottom	Oil, Gas or Water	Depth Found	Remarks
Big Injun			1483'		Oil Oil	1483' 1507'	
Total depth				1546'			

Ⓞ

GUFFEY THISTLE NO. 1 WELL.

Lincoln District, Tyler County, W. Va.
By J. R. Bull, Sistersville, W. Va.
Abandoned under permit Tyl-.....-A?
On.....acres.

Elevation, 716' L.

Shot Nov. 7, 1894, with 20 qts.

10" casing, 125'; 6 $\frac{1}{4}$ " , 1000'; 4-7/8" , 1358'; all left in.

Oil well. Record to Dept. of Mines not dated or stamped.

Record to RGT from Mrs. Griffith April 18, 1949. Old File No. 497.

Big Injun Sand (oil, 1483 and 1507')
Total depth

547R

Top.	Bottom.
1483	-
	1546