

Latitude 39° 35'

Longitude 80° 55'

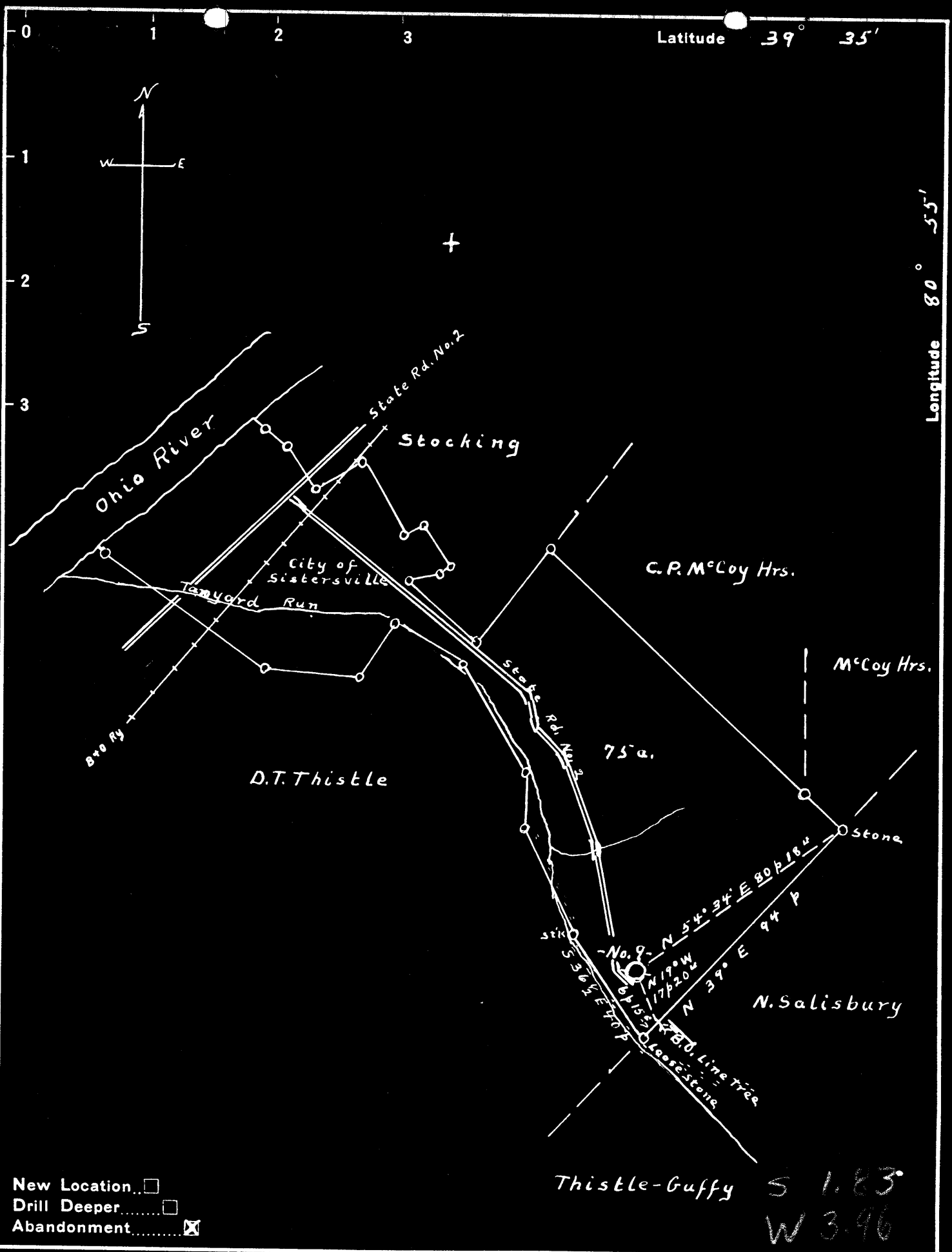

- New Location..
- Drill Deeper.....
- Abandonment.....

Thistle-Guffy S 1.83  
W 3.96

Company J.R. Bull  
 Address Sistersville, W. Va.  
 Farm J.B. McCoy  
 Tract 1 Acres 75 Lease No. 6064  
 Well (Farm) No. 9 Serial No. \_\_\_\_\_  
 Elevation (Spirit Level) 804'  
 Quadrangle New Martinsville  
 County Tyler District Lincoln  
 Engineer Don L. Riggle  
 Approved by George R. Clarke  
 Engineer's Registration No. 102  
 File No. 046-S.P.11 Drawing No. 1388  
 Date May 5, '48 Scale 1" = 40'

STATE OF WEST VIRGINIA  
 DEPARTMENT OF MINES  
 OIL AND GAS DIVISION  
 CHARLESTON

**WELL LOCATION MAP**  
 FILE NO. JYL-654-A

+ Denotes location of well on United States Topographic Maps, scale 1 to 62,500, latitude and longitude lines being represented by border lines as shown.

- Denotes one inch spaces on border line of original tracing.

J. B. McCOY NO. 9 WELL.

654A

Lincoln District, Tyler County, W. Va.  
By Mourice Horewitz, 310 N. McKean St., Butler, Pa.  
Abandoned under permit Tyl-.....-A?  
On.....acres.  
Elevation, .....' L.  
Date of completion, etc., not given.  
6 $\frac{1}{4}$ " casing, 1200'.  
Oil well. Record to Dept. of Mines stamped Aug. 26, 1950.  
Record to RCT from Mrs. Griffith Nov. 18, 1950. Old File No. 572.

	Top.	Bottom.
Big Injun Sand (oil)		1570 - 1624

("All given on record.")



STATE OF WEST VIRGINIA  
DEPARTMENT OF MINES  
OIL AND GAS DIVISION

572

Permit No. TYL-654-A

WELL RECORD

Oil or Gas Well (KIND)

Company Mourice Horowitz  
 Address 310 N. McKean St. Butler Penna.  
 Farm J.B. McCoy Acres \_\_\_\_\_  
 Location (waters) \_\_\_\_\_  
 Well No. #9 Elev. \_\_\_\_\_  
 District Lincoln County Tyler  
 The surface of tract is owned in fee by \_\_\_\_\_  
 Address \_\_\_\_\_  
 Mineral rights are owned by \_\_\_\_\_  
 Address \_\_\_\_\_  
 Drilling commenced \_\_\_\_\_  
 Drilling completed \_\_\_\_\_  
 Date Shot \_\_\_\_\_ From \_\_\_\_\_ To \_\_\_\_\_  
 With \_\_\_\_\_  
 Open Flow \_\_\_\_\_ /10ths Water in \_\_\_\_\_ Inch  
 \_\_\_\_\_ /10ths Merc. in \_\_\_\_\_ Inch  
 Volume \_\_\_\_\_ Cu. Ft.  
 Rock Pressure \_\_\_\_\_ lbs. \_\_\_\_\_ hrs.  
 Oil \_\_\_\_\_ bbls., 1st 24 hrs.  
 Fresh water \_\_\_\_\_ feet \_\_\_\_\_ feet  
 Salt water \_\_\_\_\_ feet \_\_\_\_\_ feet

Casing and Tubing	Used in Drilling	Left in Well	Packers
Size			
16			Kind of Packer
13			
10			Size of
8 1/4			
6 3/4	1200	1200	Depth set
5 3/16			
3			Perf. top
2			Perf. bottom
Liners Used			Perf. top
			Perf. bottom

CASING CEMENTED \_\_\_\_\_ SIZE \_\_\_\_\_ No. Ft. \_\_\_\_\_ Date \_\_\_\_\_

COAL WAS ENCOUNTERED AT \_\_\_\_\_ FEET \_\_\_\_\_ INCHES  
 \_\_\_\_\_ FEET \_\_\_\_\_ INCHES FEET \_\_\_\_\_ INCHES  
 \_\_\_\_\_ FEET \_\_\_\_\_ INCHES FEET \_\_\_\_\_ INCHES

Formation	Color	Hard or Soft	Top	Bottom	Oil, Gas or Water	Depth Found	Remarks
Injun			1570	1624	oil		All given on record

