

WW-7  
8-30-06



West Virginia Department of Environmental Protection  
Office of Oil and Gas  
WELL LOCATION FORM: GPS

API: 47-097-02693 WELL NO.: 534  
FARM NAME: WOODY, DON J. LBR. CO.  
RESPONSIBLE PARTY NAME: CONSOL Gas Company  
COUNTY: Upshur DISTRICT: Washington  
QUADRANGLE: Alton  
SURFACE OWNER: See WW-4A WOODY BROTHERS PARTNERSHIP  
ROYALTY OWNER: See Attachment TO WW-4A  
UTM GPS NORTHING: 4295690.298  
UTM GPS EASTING: 572022.344 GPS ELEVATION: 2134

The Responsible Party named above has chosen to submit GPS coordinates in lieu of preparing a new well location plat for a plugging permit or assigned API number on the above well. The Office of Oil and Gas will not accept GPS coordinates that do not meet the following requirements:

- 1. Datum: NAD 1983, Zone: 17 North, Coordinate Units: meters, Altitude: height above mean sea level (MSL) – meters.
- 2. Accuracy to Datum – 3.05 meters
- 3. Data Collection Method:

Survey grade GPS  : Post Processed Differential \_\_\_\_\_  
Real-Time Differential

Mapping Grade GPS \_\_\_\_\_ : Post Processed Differential \_\_\_\_\_  
Real-Time Differential \_\_\_\_\_

4. Letter size copy of the topography map showing the well location.

I the undersigned, hereby certify this data is correct to the best of my knowledge and belief and shows all the information required by law and the regulations issued and prescribed by the Office of Oil and Gas.

RECEIVED  
Office of Oil and Gas

APR 04 2017

WV Department of  
Environmental Protection

[Signature] Manager Gas Permitting 3/31/2017  
Signature Title Date

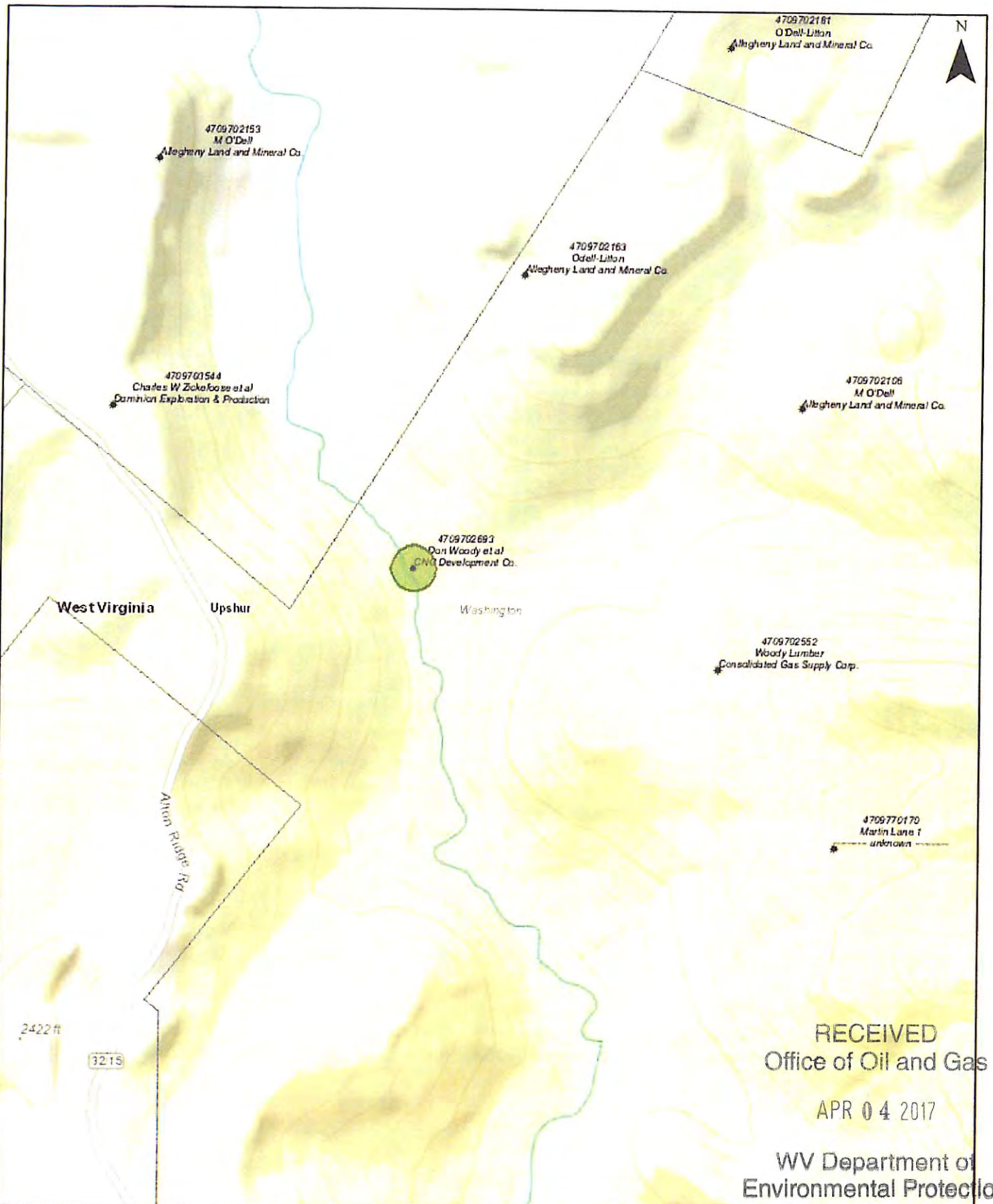

RECEIVED  
Office of Oil and Gas  
APR 04 2017

WV Department of  
Environmental Protection

<b>Legend</b> * WhiteStar Wells WhiteStar Wells Labels <input type="checkbox"/> Surface Tax Parcels	0 0.1 0.2 mi Date: 3/31/2017 Prepared By: Harley, Matt	 534 Topo
	This product was generated by CONSOL Energy's WEB Map Intended for Internal Use Only.	