

NORTH

LONGITUDE 80°17'30"

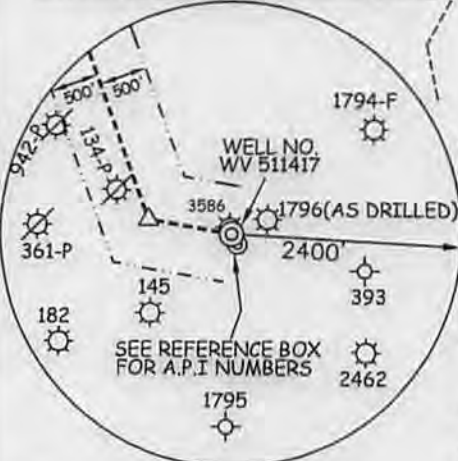

NOTES ON SURVEY

1. TIES TO WELLS AND CORNERS ARE BASED ON GRID NORTH FOR THE WV STATE PLANE COORDINATE SYSTEM SOUTH ZONE NAD '27.
2. TIES TO REFERENCES ARE BASED ON MAGNETIC NORTH 06/18/10.
3. LEASE BOUNDARY SHOWN HEREON TAKEN FROM A DEED RECORDED IN DEED BOOK 399 AT PAGE 785.
4. SURFACE OWNER AND ADJOINER INFORMATION TAKEN FROM THE ASSESSOR AND COUNTY CLERK RECORDS OF UPSHUR COUNTY IN JULY, 2011. PARCELS AFFECTED BY CURRENT CHANGES CHECKED JULY, 2013.
5. WELL LAT./LONG. (NAD'27) ESTABLISHED BY DGPS(SUBMETER MAPPING GRADE).
6. ORIGINAL PLAT DATED 11/10/11 REVISED 07/29/11 TO UPDATE SPOT CIRCLE & ADJOINER INFORMATION & 11/13/13 TO EXTEND LEG & UPDATE, ETC.
7. NO WATER WELLS WERE FOUND WITHIN 250 FEET OF PROPOSED GAS WELL. NO AGRICULTURAL BUILDINGS (GREATER THAN 2500 SQUARE FEET) OR DWELLINGS WERE FOUND WITHIN 625 FEET OF CENTER OF PROPOSED WELL PAD.

REFERENCES

- ADR-125 WELLS
- H1-WV 511416
- H2-WV 511415
- H3-WV 511417**
- H4-WV 513450
- H5-WV 513451



I THE UNDERSIGNED, HEREBY CERTIFY THAT THIS PLAT IS CORRECT TO THE BEST OF MY KNOWLEDGE AND BELIEF AND SHOWS ALL THE INFORMATION REQUIRED BY LAW AND THE REGULATIONS ISSUED AND PRESCRIBED BY THE DIVISION OF ENVIRONMENTAL PROTECTION.

P.S. 849 *C. Victor Moyers*



(+) DENOTES LOCATION OF WELL ON UNITED STATES TOPOGRAPHIC MAPS.
 DATE NOVEMBER 13 , 20 13
 OPERATORS WELL NO. WV 511417
 API WELL NO. 47-097-03814 MOD H6A
 STATE COUNTY PERMIT

MINIMUM DEGREE OF ACCURACY 1 / 2500 FILE NO. 6282P511417R3
 PROVEN SOURCE OF ELEVATION DGPS (SURVEY GRADE TIE TO CORS NETWORK) SCALE 1" = 2000'

STATE OF WEST VIRGINIA
 DIVISION OF ENVIRONMENTAL PROTECTION
 OFFICE OF OIL AND GAS

WELL TYPE: OIL GAS INJECTION WASTE DISPOSAL IF "GAS" PRODUCTION STORAGE DEEP SHALLOW

LOCATION: ELEVATION 1,572(ACTUAL PAD) WATERSHED TRIBUTARY OF SPRUCE FORK
 DISTRICT BUCKHANNON COUNTY UPSHUR QUADRANGLE ADRIAN 7.5'

SURFACE OWNER CHARLES R. BELL, SR. ACREAGE 357.639±
 ROYALTY OWNER BISHOP OF THE PROTESTANT EPISCOPAL CHURCH OF THE DIOCESE OF W.V. (500 AC.±) / WINDAMAR, INC. ET AL (151.12 AC.±)

PROPOSED WORK: LEASE NO. 121717 / 991894
 DRILL CONVERT DRILL DEEPER REDRILL FRACTURE OR STIMULATE PLUG OFF OLD
 FORMATION PERFORATE NEW FORMATION PLUG AND ABANDON CLEAN OUT AND REPLUG OTHER
 PHYSICAL CHANGE IN WELL (SPECIFY) _____ TARGET FORMATION MARCELLUS
 ESTIMATED DEPTH _____

WELL OPERATOR EQT PRODUCTION COMPANY DESIGNATED AGENT REX C. RAY
 ADDRESS 115 PROFESSIONAL PLACE P.O. BOX 280 BRIDGEPORT, WV 26330 ADDRESS 115 PROFESSIONAL PLACE P.O. BOX 280 BRIDGEPORT, WV 26330

03/28/2014

MARY F. HIGGINBOTHAM ET AL LEASE WELL NO. WV 511417



**PROPOSED GAS WELL
NO. WV 511417**

TO WELL WV
510852 A.P.I.
#47-097-3370

**PREVIOUSLY APPROVED
(2007) ACCESS FOR
A.P.I. #47-097-3370
TO BE RECLAIMED &
MAINTAINED TO STATE
SPECS.**

1427 Spruce Fork
Ch

Detail Sketch for Proposed Well WV 511417

NOT TO SCALE

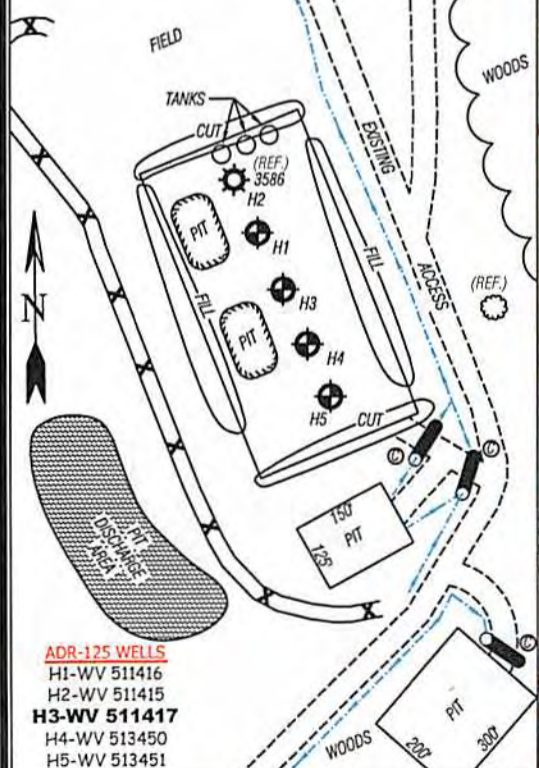

ADR-125 WELLS
H1-WV 511416
H2-WV 511415
H3-WV 511417
H4-WV 513450
H5-WV 513451

ALL ROADS SHOWN HEREON ARE EXISTING UNLESS OTHERWISE NOTED AND SHALL BE MAINTAINED IN ACCORDANCE WITH WV D.E.P. OIL AND GAS BMP MANUAL ENTRANCES AT COUNTY/STATE ROADS SHALL BE MAINTAINED IN ACCORDANCE WITH WV D.O.T. REGULATION. SEPARATE PERMITS MAY BE REQUIRED BY THE D.O.T.

SEDIMENT BASINS (TRAPS) AND APPROPRIATE EROSION CONTROL BARRIERS ARE TO BE CONSTRUCTED AT ALL CULVERT AND CROSS DRAIN INLETS AND OUTLETS AS REQUIRED IN THE WV D.E.P. OIL AND GAS BMP MANUAL. FIELD CONDITIONS (ROCK OUTCROPS AND BEDROCK) MAY PROHIBIT INLET TRAPS BEING INSTALLED. WHEN THESE CONDITIONS EXIST ADDITIONAL EROSION CONTROL MEASURES SHALL BE EVALUATED AND UTILIZED AS NEEDED.

EARTHWORK CONTRACTORS ARE RESPONSIBLE FOR NOTIFICATION TO THE OPERATOR AND INSPECTOR PRIOR TO ANY DEVIATION FROM THIS PLAN.

TEMPORARY SEED & MULCH ALL SLOPES AFTER CONSTRUCTION OF LOCATION.

CUT & STACK ALL MARKETABLE TIMBER.

STACKED BRUSH MAY BE USED FOR SEDIMENT CONTROL.

APPLICATIONS FOR SEPARATE PLC PERMITS ON THE ACCESS ROAD STREAM CROSSINGS HAVE BEEN PREPARED (IF APPLIES).

SCALE: 1"=500'



EXISTING CULVERT (line with cross-ticks) PROPOSED CULVERT 12" MIN. UNLESS OTHERWISE NOTED (line with circle)

PROPOSED STREAM CROSSING (if applies) (line with circle and cross-ticks) *SEE TABLE FOR CULVERT DETAIL



SMITH LAND SURVEYING, INC.
P.O. BOX 150 GLENVILLE, WV, 26351

PH: (304)462-5634 FAX: (304)462-5656 E-MAIL: sls@sls-surveys.com

DRAWN BY: C.J.P. FILE NO.: 6282 DATE: 04/28/11 CADD FILE: 6282REC\WV511417R3.DWG

TOPO SECTION OF
USGS ADRIAN 7.5' QUADRANGLE

03/28/2014